



CAFF45GM

Caple 4 door Freestanding Fridge Freezer



Technical Manual



CAFF45GM

Caple 4 door Freestanding Fridge Freezer

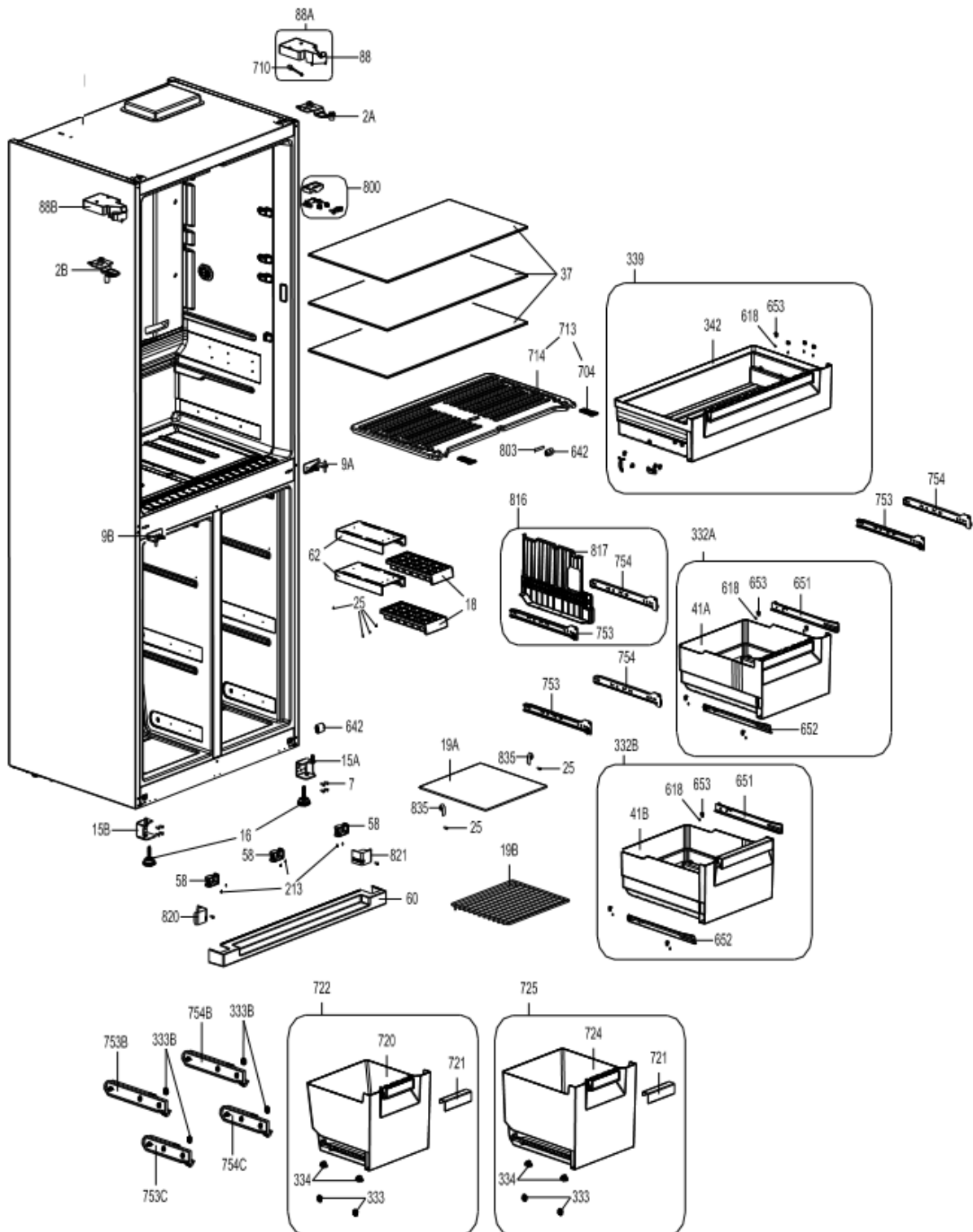



CAFF45GM

Caple 4 door Freestanding Fridge Freezer

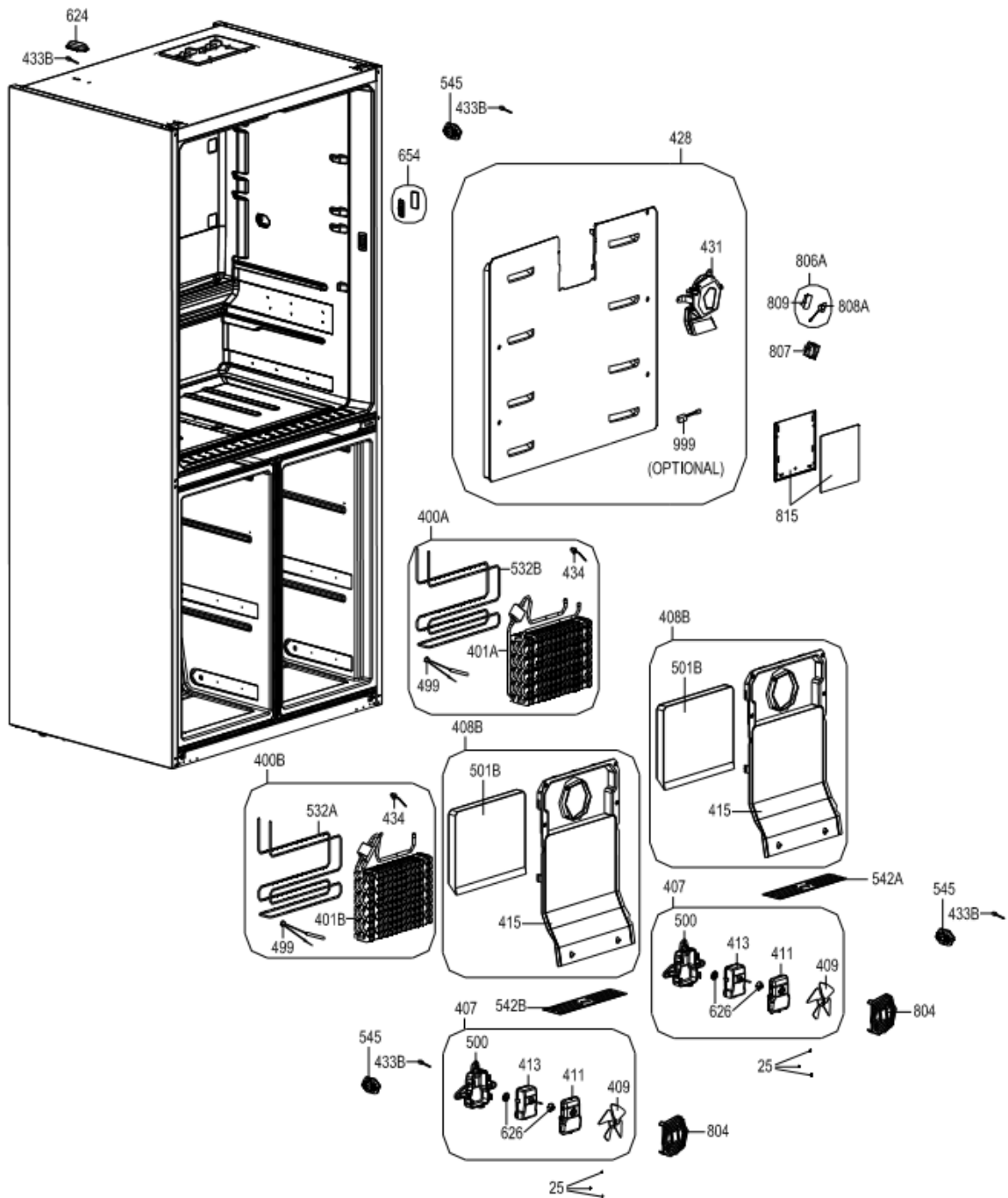



CAFF45GM

Caple 4 door Freestanding Fridge Freezer

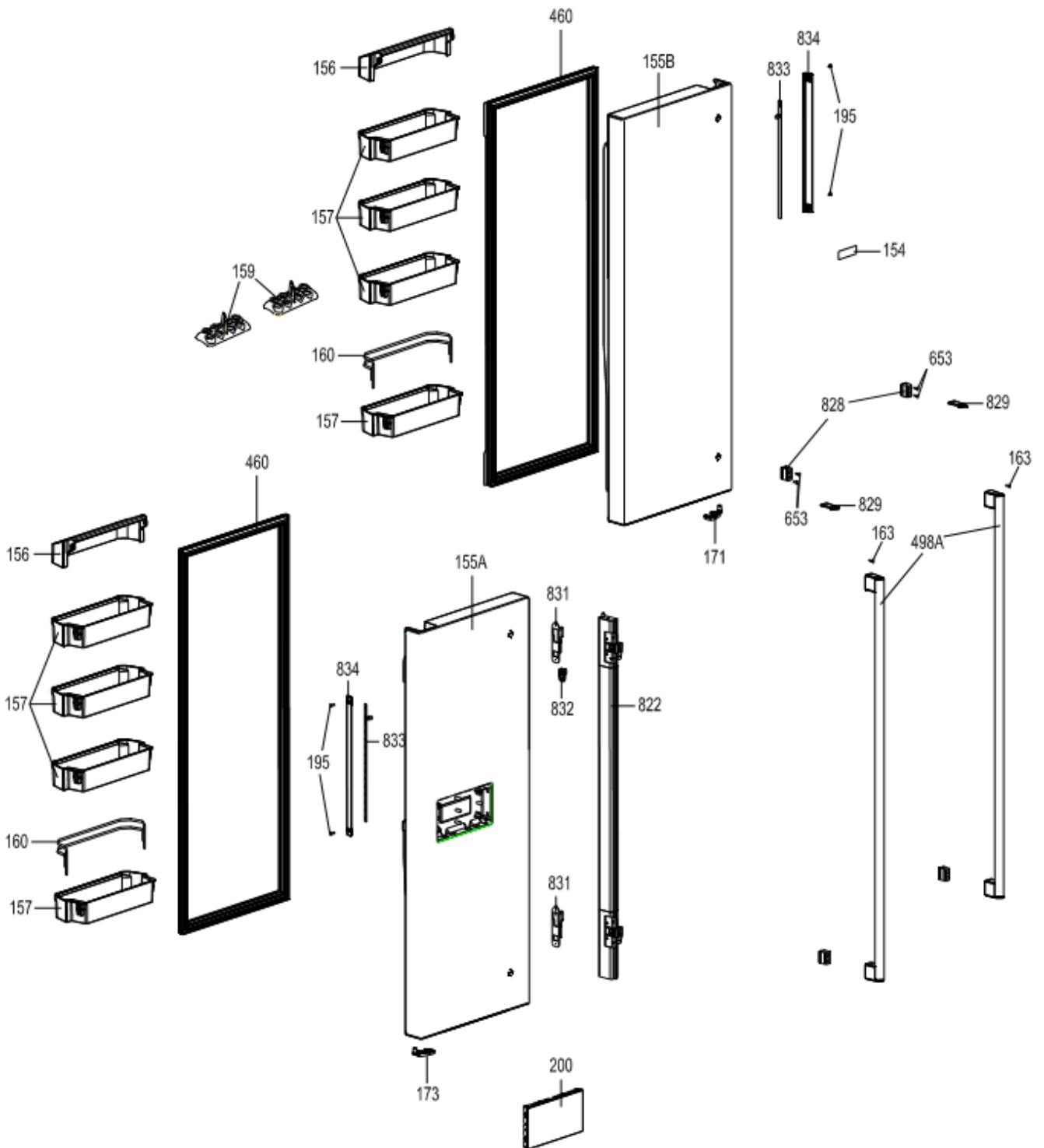



CAFF45GM

Caple 4 door Freestanding Fridge Freezer

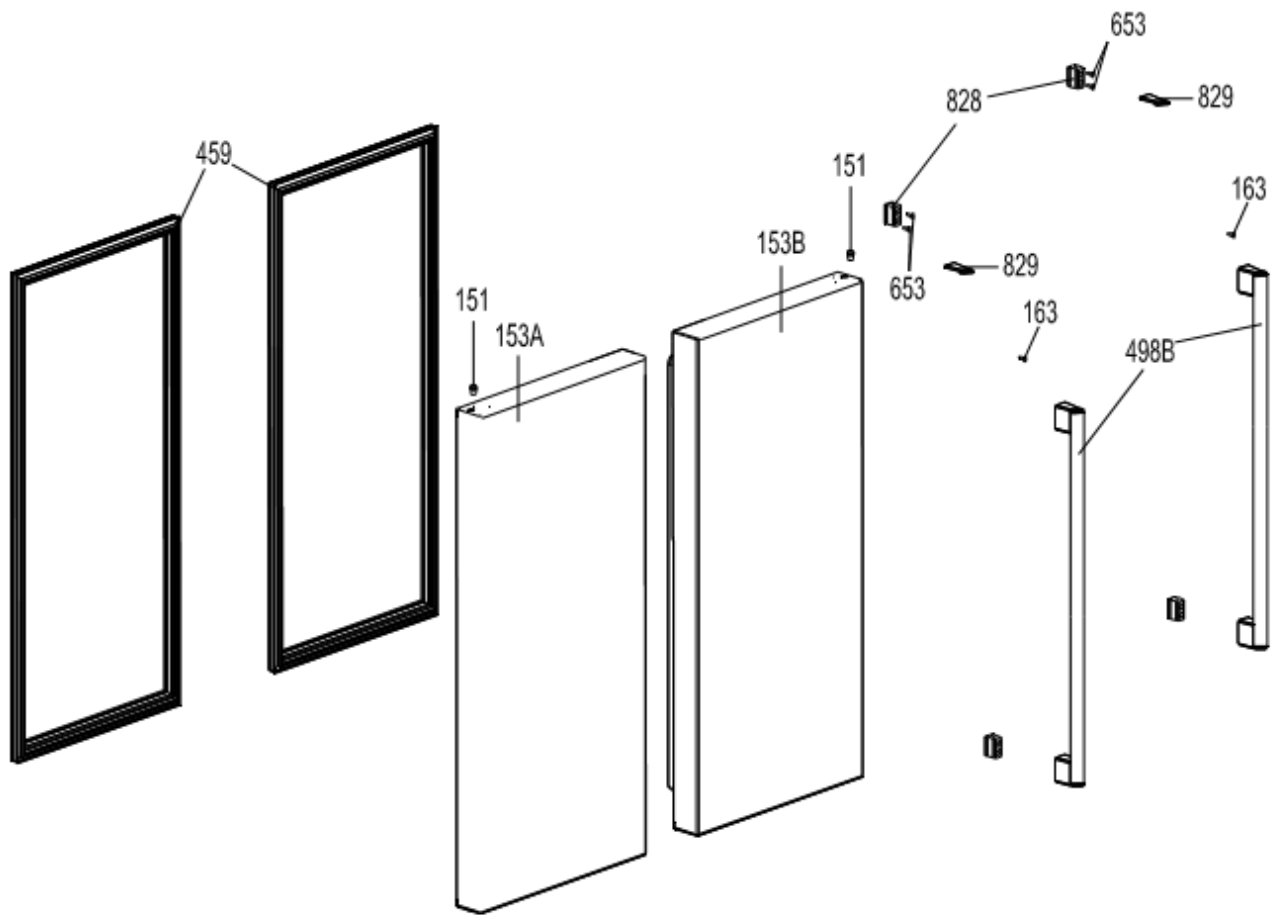



CAFF45GM

Caple 4 door Freestanding Fridge Freezer

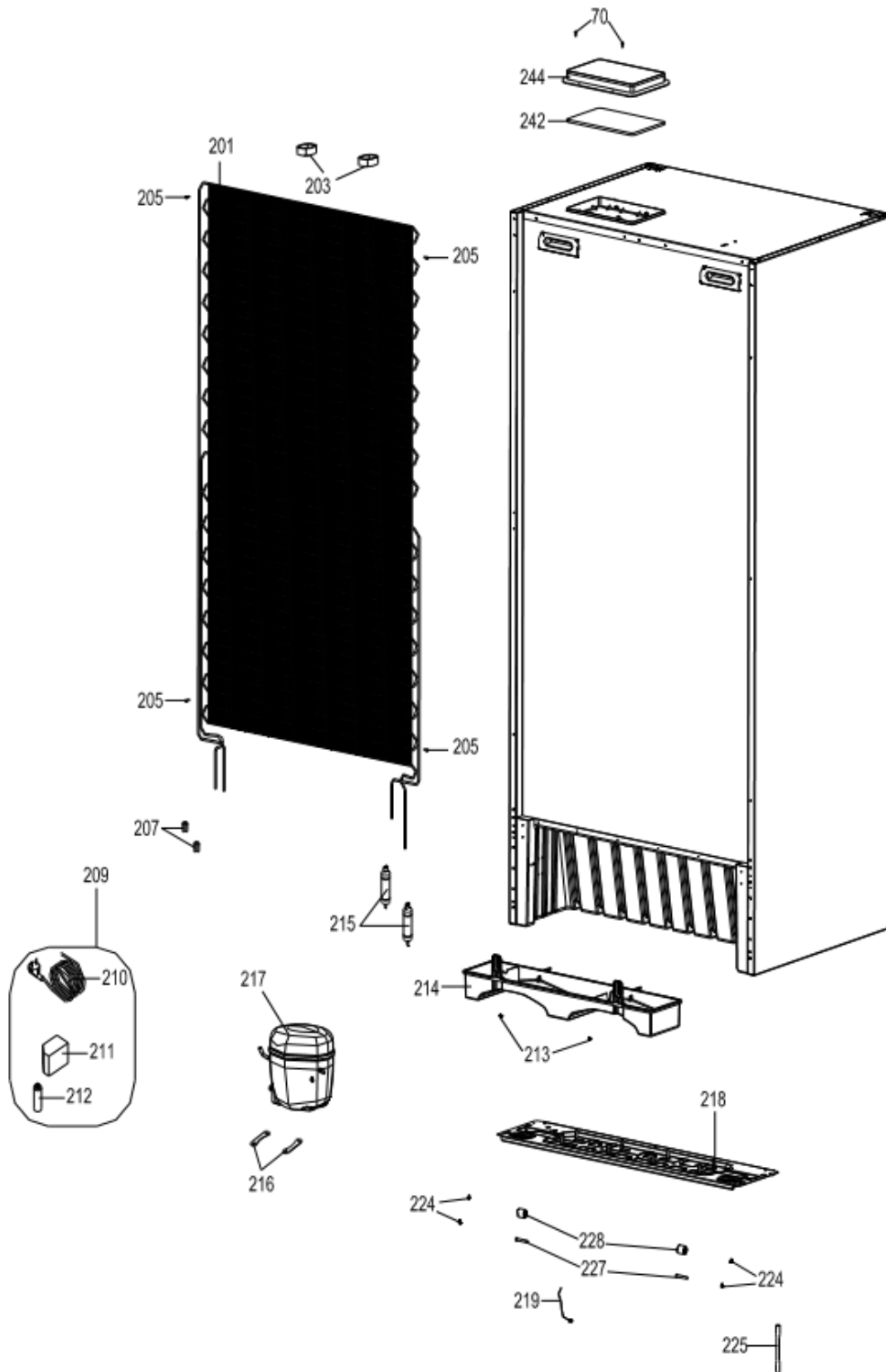



CAFF45GM

Caple 4 door Freestanding Fridge Freezer

Item	Part Number	Description
2A	37026056	TOP HINGE RIGHT 910 SERVICE RV2
2B	37026055	TOP HINGE LEFT 910 SERVICE RV2
7	37024764	SCREW TT M5*16 YSB-F
9A	37022373	MIDDLE HINGE RIGHT 910 RV1
9B	37022374	MIDDLE HINGE LEFT 910 RV1
11	42170935	MIDDLE/HINGE SREW CAP(SMALL)VSG.GRAY
15A	37022462	BOTTOM HINGE RIGHT GR/910 RV1
15B	37022464	BOTTOM HINGE LEFT GR/910 RV1
16	47010443	ADJUSTABLE FOOT M10X40(GRAY)
18	42125774	ICE TRAY COMMON
19A	47008961	F GLASS SHELF/910
19B	47010779	FREEZER BOTTOM WIRE SHELF/910(ALKALZINK)
20	42166059	F.GLASS SHELF PRF/910(EXT)DRKHOT 333
25	35003482	SCREW 40*13 YSB-R-C-INOX
32	35000744	SCREW KA 40*18 YSB-C-INOX
37	47015238	COOLER GLASS SHELF AQUASAFE SRGF/910 RV2
41A	42111087	CRISPER 910-RIGHT(TRANS-WH-GRAY)
41B	42111088	CRISPER 910-LEFT(TRANS-WH-GRAY)
42	37029727	CRISPER PRF SRGF/910 DARKINX
58	42052644	KICK PLATE HOLDER GK(S.W.)
60	42166054	KICK PLATE/910 DARK
62	42130996	ICE TRAY COVER/366 RV1(S.W.)
70	35001678	SCREW KA 40*14 YSB-R-F-INOX
87	35003056	FRONT WHEEL GR.
88	42126562	TOP HINGE C./910 RIGHT(DARKGRAMATVER)RV3
88A	42126561	TOP HINGE C./910GR RIG(DARKGRAMATVER)RV3
88B	42126564	TOP HINGE C./910 LEFT(DARKGRAMATVER)RV3
131	35001721	SCREW KA 40*14 YSB-C-INOX
151	42073883	BURÅ† ÅœST 910(ELUXGRAY)
151	42128088	BUSHING/345P(LXG) RV1
153A	22037405	F DOOR ASSY/910-FD-LEFT-(DARKGRAY)
153B	22037404	F DOOR ASSY/910-FD-FLX(DARKGRAY)
154	47013813	LOGO CAPLE YENI TIP-4
155A	22037402	R DOOR ASSY/910-FD-FLX-SOL(DIFIX-KGRAY)
155B	22037403	R DOOR ASSY/910-FD-FLX-RIGHT(DIFIX-DGRAY)
156	42111073	SHELF COVER/910
157	42166055	DOOR SHELF/910 GR.(TRA.-DARKINXPRF)
157	42191819	DOOR SHELF/910 GR.(TRA.-DARKINXPRF)



CAFF45GM

Caple 4 door Freestanding Fridge Freezer

Item	Part Number	Description
159	42163485	EGG HOLDER (TRANS.-NAT) RV1
160	47010425	DOOR SHELF 910
163	37012110	SCREW M4*10 YHB-F
164	42183204	DOOR HANDLE SCREW CAP(BND.GRAY)
171	42116228	DOOR CATCHER RIGHT GR/910 (NAT)
173	42116229	DOOR CATCHER LEFT GR/910 (NAT)
174	37014382	BOTTOM STOPPER/HC
187	42073916	BUSHING BOTTOM/910(LXG)
195	35007969	SCREW ST 3.5*13 OZEL1-C
200	32028959	DISP.PAN.GR/916(BLACK)EN HOTST 11-4
201	22061608	MAIN CONDANSER GR.915A+
201	37022210	CONDANSER COMPLETE/915A+
203	42118033	SPACER(NAT)
205	35009792	SCREW ST 4.8*13 YSB-T-C
207	42155463	RUBBER CONDANSER MUTUAL ANTIVIBRASYON
208	40017915	CONDANSER HOLDER(2)
209	32027387	SUP.CAB.GR.ZBH1122CY/5UF/2,5M/UK
210	32007439	POWER CORD(2.5m-ENG)
211	32020696	OVER L.GR.ZBH1122CY/B68-120/QP3-12A
211B	42177882	COMP.COVER/JIAXIPERA/24.01.59
212	32010690	CAPACITOR 5UF/400V P2-TIRNAK(6,3*0,8)
213	37022312	TRUSS ST 4*12 SPECIAL14-C
214	42099227	EVAPORATING TRAY GR/915(KAR)
215	37029010	DRYER(XH9,0.40MM,10GR,I.C.=3,1)
216	20020023	COMP FIXING BRACKET
217	32019159	COMP.ZBH1122CY/5MF/B68-120/QP3-12A/JIAX
218	37018198	COMP BASEMENT /910
218A	32032716	VALVE GR BI-STABLE I.C.=2,15(R600A)/520T
219	32027294	EARTH WIRE/WASHER
222	37023688	SCREW TT M4*6 YSB-T-F
225	35002664	SERVICE TUBE(105*6*0,7)TYPE B
226	35000752	DRYER VACUUM TUBE
227	42157011	FRONT/BACK WHEEL PP40KA
228	35000738	REAR WHELL PIN
232	35002921	SCREW M4*10 YSB-F
242	32029410	MB/BDA10-9/916/R207/V19-23335288
244	42164516	MAINBOARD COVER GR 910/FR(GRAY)
332A	42111078	CRISPER GR 910-RIGHT(TRANS-GRAY)



CAFF45GM

Caple 4 door Freestanding Fridge Freezer

Item	Part Number	Description
332B	42111079	CRISPER GR 910-LEFT(TRANS-GRAY)
333	42033005	CRISPER ROLLER/540(S.W.)
333B	42087619	CRISPER ROLLER/910(NAT)
334	42033070	CRISPER ROLLER HOLDER/540(NAT)
339	42173932	CHILLER SHELF GR/910(TRANS-WH-GRI)RV2
342	42111084	CHILLER SHELF /910(TRANS-WH-GRI)
400A	22031575	FINEVAPGR/915A+-CORDE(2ROWFEWFINTHER
401A	37025584	FIN EVAPORATOR/915A+AKUSZ(2SIRASEYFI.REZ
401B	37025585	FIN EVAPO/915A+AKUSZ(2SISEYFI.REZS-T1/RV
407	20676833	F FAN MOTOR GR/590UHS(NAT)
408B	42074178	F MULTIFLOW LEFT GR/910 (S.W)
409	42030263	PROPELLER/590(F.FAN MOTOR)BLACK
411	42031847	F FAN MOTOR COVER/590UHS(NAT)
413	32006707	EVAP FAN MOTOR/391-321-590
415	42074176	F MULTI FLOW COVER/910 (S.W)
428	42162194	R MULTI FLOW GR.916 NEW MI
429	42108053	R MULTI FLOW 916 NEW
431	32028874	TUR.FAN MOT.DC(92*92*25)T92T12MS5A7-5NDC
432	47011757	MOTOR FAN KAU.916-NEW
433B	32010909	SENSOR/STANDARD/R6K/70MM/SINGLE
449	42033244	R MULTIFLOW CAP/ 640(S.W.)
459	42077845	F DOOR GASKET/910(VFGRI)
460	42077799	R DOOR GASKET/910(VF GRAY)
498A	42148857	D.HANDLE FLX GR TOP-S(868)CLSIX
498B	42148858	D.HANDLE FLX GR BTM-S(413)CLSIX
499	32028176	TERMAL FUSE SINGLE
500	42031850	F FAN MOTOR BOX
501B	52064812	F MULTI FLOW INSULATION 2ROWS/910
510	37003078	SCREW M,YHB,5x14,F,ST,A3K,TT
532B	32026886	FIN EVAP RES/2ROWS 80W 910/SHORT
542A	32017168	CASE RESISTANCE F LEFT/20W 910
542B	32017167	CASE RESISTANCE F RIGHT/20W 910
545	42053050	SENSOR COVER/566(S.W.)
588	37022711	SCREW ST 4.2*14 SPECIAL 17-C
618	37010180	SCREW 30*8 YSB-F-INOX
624	42163920	EMK SENSOR COVER GRAY RV
626	42030205	FREEZER FAN MOTOR RUBBER/590UHS
639	37014368	SCREW ST 4.2*12 OZEL8-C



CAFF45GM

Caple 4 door Freestanding Fridge Freezer

Item	Part Number	Description
642	42052437	WHEEL /GK
643	37014537	SCREW TT M5*25 YSB-F
651	37017354	CHILLER RAIL INTERNAL 350 910
652	37017355	CHILLER RAIL INTERNAL 350 910
653	37010281	SCREEW M4*15 YSB-F
653B	42040299	STORAGE BOX RAIL DUBEL/465
654	22033972	REED SWITCH GR/590UHS(WHITE) RV1
704	42074085	CRISPER UPPER SHELF CLAMP 910 (S.W.)
710	32013579	NIGHT SENSOR
713	42111074	CRISPER-CHILLER SHELF GR/910
714	42111085	CRISPER-CHILLER SHELF BOTTOM/910
718	37029729	CHILLER PRF SRGF/910 DARKINX
720	42111082	BOTTOM BASK./910
721	42166057	CRISPER TRIM 910GR.(EXT)DARKPRF
722	42166056	BOTTOM BASK.GR/910(TRANS-WH-GRAY)DARK
724	42111089	TOP CRISPER/910 (TRANS-GRAY)
725	42166058	TOP CRISPER GR/910 (TRANS-WH-GRAY)DARK
753	37017352	CRIS.RAIL OUT (RIGHT)910
753B	42074180	FRZ.BASKET ROLLER RAIL/TOP-RIGHT(910)
753C	42074190	FRZ.BASKET ROLLER RAIL/BOTTOM-RIGHT(910)
754	37017353	CRIS.RAIL OUT (LEFT)910
754B	42074186	FRZ.BASKET ROLLER RAIL/TOP-LEFT(910)
754C	42074188	FRZ.BASKET ROLLER RAIL/BOTTOM-LEFT(910)
800	42110561	TRIZ BAR CABINET GR.910(S.W.)RV1
801	37021419	CHILLER RAIL ASSEMBLY SHEET/FRONT
802	37017960	CHILLER RAIL ASSEMBLY SHEET/BACK
803	37018662	ABOVE CRISPER SHELF PIN 910
804	37021374	FREEZER AIR DUCT GRILLE(AC)910(ALKAZINK)
806A	42163013	SOG. LED CAP GR/485 PP SPIKED/2835
808A	32030848	LED STRIP/2835*3/R42MM/12V/485E
807	42148693	R LED OUT COVER /485(S.W) SNAP FIT
809	42148692	REF LED COVER/485 PP SNAP FIT
816	42074076	CRISPER MIDWALL GR.910 (S.W)
817	42074077	CRISPER MIDWALL 910 (S.W)
818	37021279	TELESCOPIC RAIL/RIGHT
819	37021280	TELESCOPIC RAIL/LEFT
820	42097727	BOTTOM HINGE COVER/910 LEFT MATVER
821	42097728	BOTTOM HINGE COVER/910 RIGHT MATVER



CAFF45GM

Caple 4 door Freestanding Fridge Freezer

Item	Part Number	Description
822	32023118	TRIZ BAR GR.910(S.W PLSBND.GRAYSAC)RV1
826B	32016728	LED STRIP/3528*15/9*295MM/12V/910/COOLDI
828	37026946	DOOR HANDLE SUPPORT PART 910 GLXY(SHEET)
829	42146858	DOOR HANDLE FLX CAP(CLS)
831	42074039	HINGE SOCKET HOUSING 910(S.W)
832	42081639	HINGE HOUSING COVER/910 (S.W)
833	32017147	LED STRIP/R INSIDE DOOR GR/910
834	42132624	INSIDE DOOR LED COVER 910 (MILKY) PS
835	42137248	F GLASS SHELF STOPPER RV1/910
1026	40007341	COMP.RUBBER-DANFOSS
	47008408	DOOR MAGNET

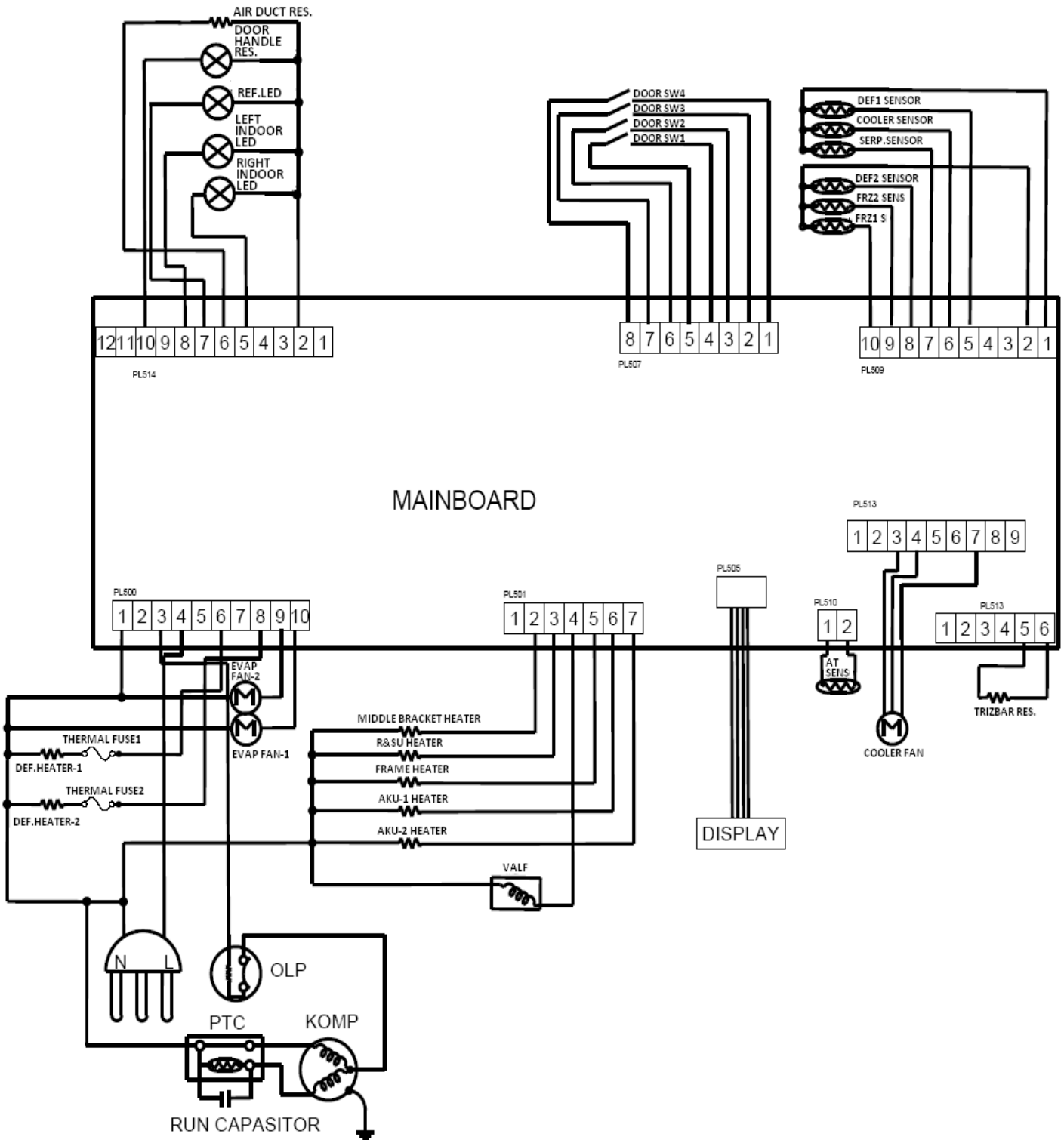



## CAFF45GM Service Manual



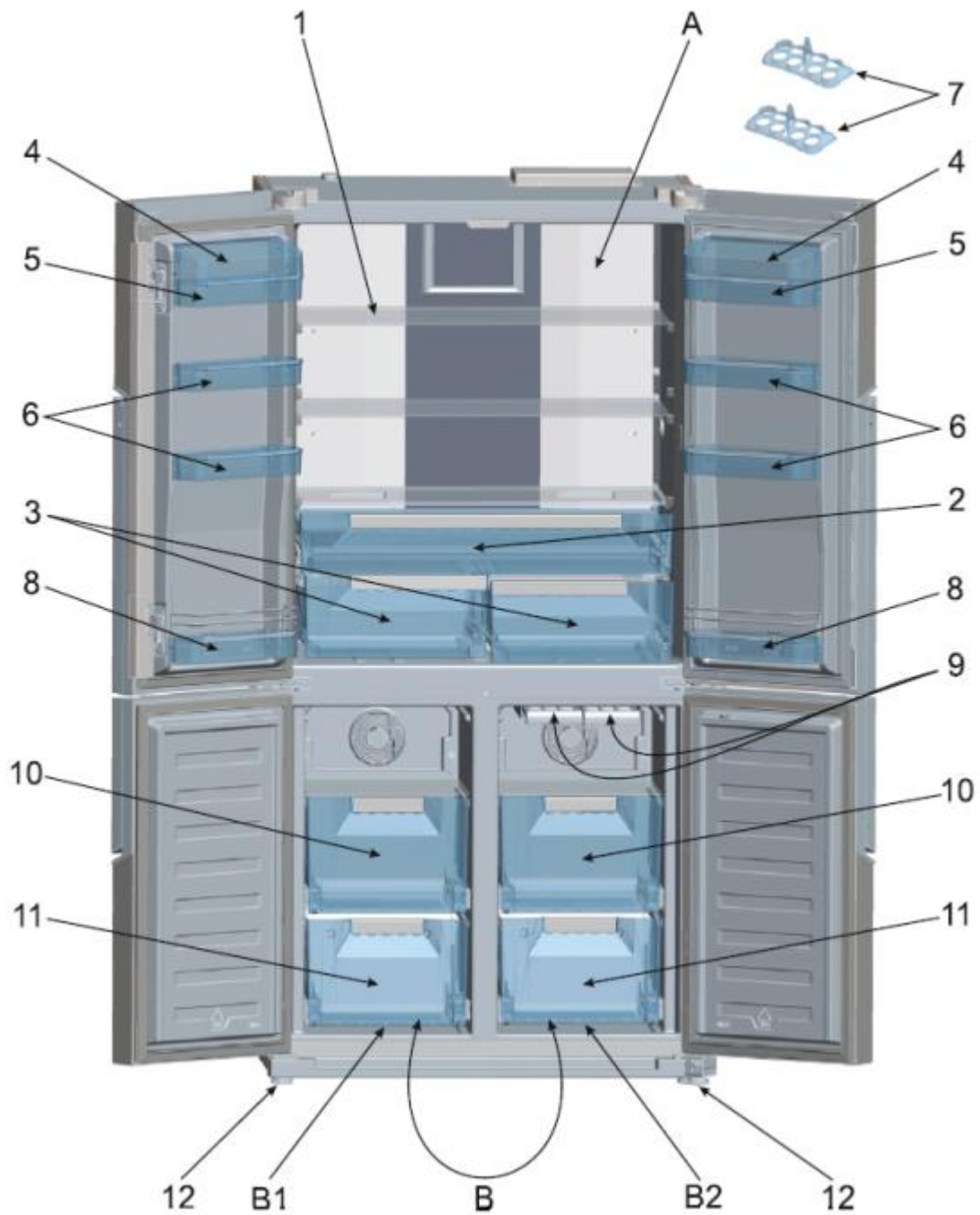

**A) Cooler Compartment**

**B) Fridge / Freezer Compartment**

B1. Zone-1 / B2. Zone-2

- 1) Fridge compartment shelves
- 2) Chiller (breakfast) compartment
- 3) Crispers
- 4) Cheese-Butter shelf covers
- 5) Cheese, butter shelf

- 6) Door shelves
- 7) Eggcups
- 8) Door bottle shelves
- 9) Iceboxes
- 10) Freezer / Cooler top baskets
- 11) Freezer / Cooler bottom baskets
- 12) Adjustable feet

## Display and control panel

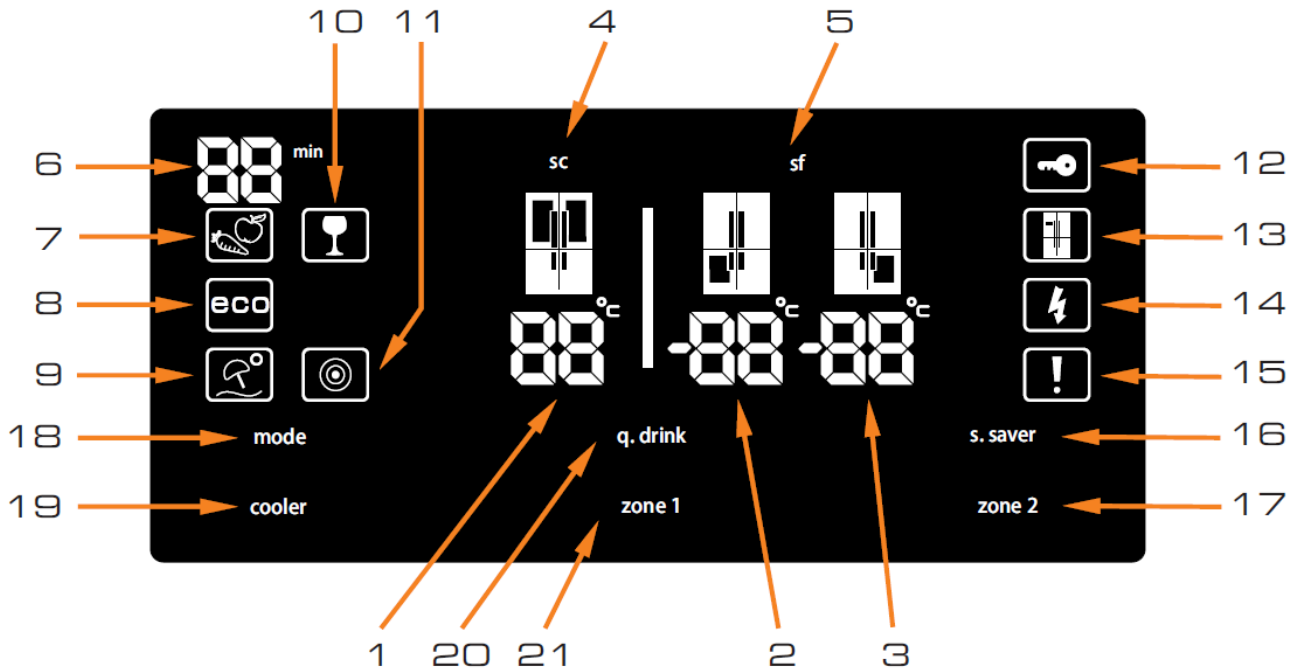

1. Fridge Compartment Temperature indicator
2. Left Freezer Compartment Temperature indicator
3. Right Freezer Compartment Temperature indicator
4. Super cooling light
5. Super freezing light
6. Qdrink alarm counter
7. Vita Store mode
8. Economy mode
9. Holiday mode
10. Qdrink light
11. Night sensor

12. Child lock
13. Dealer-Demo mode
14. Low voltage warning
15. Alarm – Service Recall (SR)
16. Screensaver button
17. Zone 2 (Right freezer) button
18. Mode button
19. Cooler button
20. Qdrink mode button
21. Zone 1 (Left freezer)button

The values on the screen indicate temperature values specified by the consumer.

Standby display is protected against faulty contact. Therefore, you must touch any key on the display before you take any action. After 2 seconds, as in this case, beep-beep tone will be open to display for use. If you wait 20 seconds at the end of the process, display will go back to the same protection case.

## Previous Displays

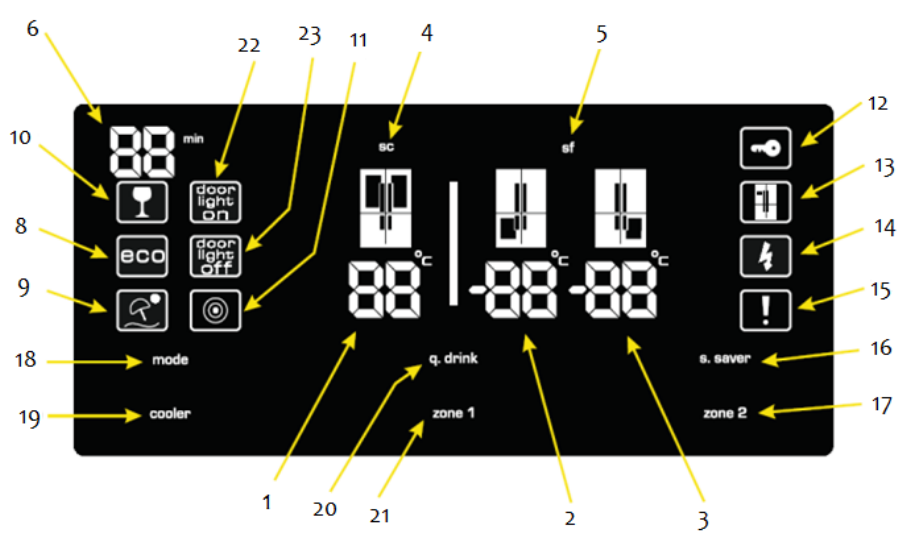
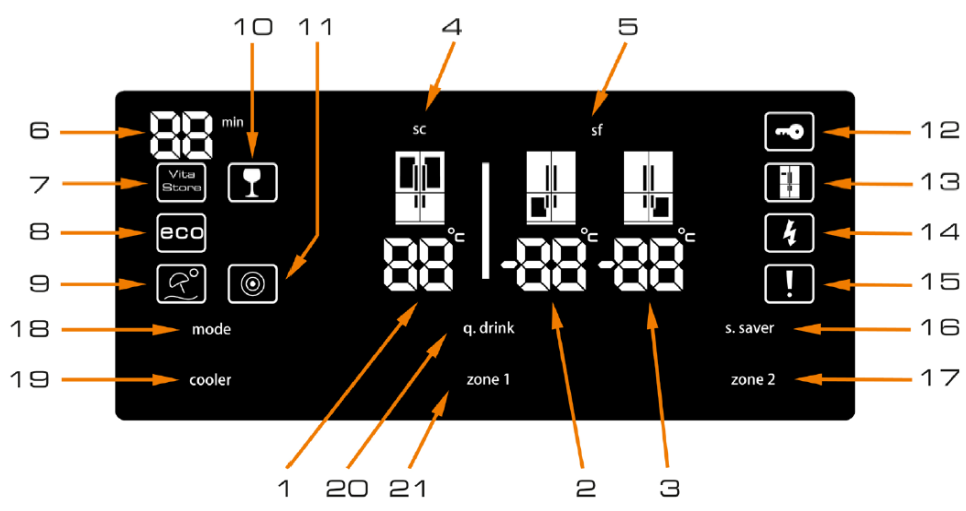

- |  |                                   |
|--|-----------------------------------|
| 1. Fridge Compartment Temperature indicator        | 14. Low voltage warning           |
| 2. Left Freezer Compartment Temperature indicator  | 15. Alarm                         |
| 3. Right Freezer Compartment Temperature indicator | 16. Screensaver button            |
| 4. Super cooling light                             | 17. Zone 2 (Right freezer) button |
| 5. Super freezing light                            | 18. Mode button                   |
| 6. Qdrink alarm counter                            | 19. Cooler button                 |
| 7. Vita Store mode                                 | 20. Qdrink mode button            |
| 8. Economy mode                                    | 21. Zone 1 (Left freezer) button  |
| 9. Holiday mode                                    | 22. Door Light On                 |
| 10. Qdrink light                                   | 23. Door Light Off                |
| 11. Night sensor                                   |                                   |
| 12. Child lock                                     |                                   |
| 13. Dealer-Demo mode                               |                                   |

## Beverage cooling (QDRINK)

[q.drink] button should be pressed to activate beverage cooling mode. Each press will increase the time for 5 minutes up to 30 minutes, and then it returns to zero.

You can view the time zone you want to set on "Qdrink alarm counter" section. Qdrink mode only lets the refrigerator release an audible alert after a specific period.



**Important: It should not be confused with cooling.**

You must adjust the time according to the temperature of the bottles before you put them in zone1 and/or zone2 compartments. For example, you can set the time as "5 minutes" in the beginning. After this time, if the cooling is insufficient, you might set another 5 or 10 minutes. While using this mode, you must check the temperature of the bottles regularly. When the bottles are cool enough, you must take them out of the appliance. If you forget bottles in Q.DRINK mode, bottles may explode.

## Economic mode (ECO)

It ensures that your refrigerator runs within ideal temperatures. In order to activate ECO mode, you should just press [mode] button until "eco " and " e" light is on.

## Holiday mode (H)

It is represented by an umbrella and sun. If you will go to holiday for a long time and during this time if you will not use cooler compartment, you may activate this mode. To switch the appliance to holiday mode, you should just press [mode] button until "holiday symbol and H" light comes on.

## Quick freezing (SF SUPERFREEZE)

You should press on [zone1] or [zone2] buttons until "sf" letters are displayed on the display. Once "sf" letters are viewed, a beep sound will be released if you press no button and the mode will be selected. You can use this mode to freeze prepared meals or freeze large amounts of food quickly. Quick freezing mode will automatically be deactivated after 24 hours or once the freezer compartment temperature sensor feels sufficient temperature.



***For quick freezing, zone1 compartment should be selected preferably.***

## Quick cooling (SC SUPERCOOL)

Press cooler button until "sc" letters are viewed on the display. Once "sc" letters are viewed, a beep sound will be released if you press no button and the mode will be selected. You can use this mode to cool prepared meals or cool large amounts of food quickly. Quick cooling mode will be automatically cancelled after 4 or 6 hours depending on the environmental temperature or when the cooler compartment reaches a sufficiently low temperature.

### **Door Lights On/Off (DOOR LIGHT ON/OFF)**

Illumination system hidden in the door handles of the product should be used based on demand. In order to activate illumination system on the door handles, you need to press [mode] button for 3 seconds. For deactivation, press [mode] button for 3 seconds again. In case of "ON" position, door illuminations will always be on. Door light on/off is an optional feature which applies to the refrigerators having the feature.

### **Cooler (COOLER)**

It is used for temperature setting of cooler compartment. By pressing [cooler] button, you can set the values of cooler part to 2, 3, 4, 5, 6, 7, 8 Celsius temperature values.

### **Freezer / Cooler 1 (ZONE 1)**

It is temperature setting button for bottom-left compartment. By pressing [zone 1] button freezing value of bottom-left part can be set as -16, -17, -18, -19, -20, -21, -22, -23, -24 Celsius temperature values. If you do not want to use bottom-left part as cooler, press [zone1] button for 3 seconds to switch to this mode, and set to 2, 3, 4, 5, 6, 7, 8 Celsius temperature values.

### **Freezer / Cooler 2 (ZONE 2)**

It is temperature setting button for bottom-right compartment. By pressing [zone 2] button freezing value of bottom-right part can be set as -16, -17, -18, -19, -20, -21, -22, -23, -24 Celsius temperature values. If you do not want to use bottom-right part as cooler, press [zone 2] button for 3 seconds to switch to this mode, and set to 2, 3, 4, 5, 6, 7, 8 Celsius temperature values.

### **Child lock (KEY SYMBOL)**

In order to activate child lock, you need to press [cooler]+[zone 2] buttons simultaneously for 5 seconds. When the child lock is active, other buttons will be deactivated, and therefore changing the settings you have made will be prevented. In order to deactivate child lock, you, again, need to press [cooler]+[zone 2] buttons simultaneously for 5 seconds.

### **Screensaver (SCREEN SAVER)**

When you press [s.saver] button for 3 seconds, you save energy by utilizing digital indicator panel with its lights off. In order to deactivate the mode, repress [s.saver] button for 3 seconds.

### **Night sensor**

When you press night sensor [mode] and [s.saver] buttons for 3 seconds, your refrigerator's lights will be OFF in case of sufficient illumination, therefore you will save energy.

## Alarm - Service Recall

-  • Once an alarm light comes on, you should contact a service.
- If you press [s.saver] button when there is an alarm and an exclamation mark on the display, the alarm sound will turn off, however the exclamation mark will stay on the digital indicator panel until error is fixed.

## Compartment On-Off mode

- You can wholly cancel compartments you do not need nor want by checking through indicator panel.
- In order to turn off Zone 2 and cooler at the same time, hold [mode] and [zone 2] buttons pressed simultaneously for 5 seconds, and all figures indicating the part turned off will disappear on the digital indicator panel.
- In order to turn off Zone 1 compartment, hold [mode] and [zone 1] buttons pressed simultaneously for 5 seconds, and all figures indicating the part turned off will disappear on the digital indicator panel.
- In order to turn off just the cooler, hold [mode] and [cooler] buttons pressed simultaneously for 5 seconds, and all figures indicating the part turned off will disappear on the digital indicator panel.
- In order to reactivate the turned-off compartment, use the same combination of buttons.

## Using a Freezer Compartment as Cooler Compartment Based On Demand

- The bottom-right and -left compartments on the appliance can be used either as freezer and cooler.
- Preferably, you need to press [zone 1] button for 3 seconds to use bottom-left part as cooler or [zone 2] button for 3 seconds to use bottom-right part as cooler.

-  **Important : If Zone1/Zone2 compartment will be converted from freezer to cooler:**
  - You should empty the food in the related compartment and leave the door open for 4 hours. Then, food will be placed in the relevant compartment.
  - Baskets and/or shelves removed from the compartment should be re-fitted.

Similarly, in order to utilize any of bottom compartments used as cooler as freezers again, you need to press the related compartment button for 3 seconds.

-  **Important : If Zone1/Zone2 compartment will be converted from cooler to freezer:**
  - You should empty the food in the related compartment and leave the door open for 2 hours. Then, food will be placed in the relevant compartment.
  - When zone 1 and zone 2 compartments used as cooler are switched to Holiday or Economic setting value, it will keep on running as cooler.

-  **Important**
  - If you want to use one of zone compartments as cooler, please give priority to Zone 1 compartment for energy saving.
  - Do not use Zone 2 compartment as cooler at ambient temperatures over 38°C.

## VITASTORE mode

VITASTORE works to protect the flavor, texture, and appearance of food. By maintaining ideal temperature and humidity levels, pre-set to optimize the freshness of fruits and vegetables, we create the conditions for longer shelf-life. To select VITASTORE mode, Zone1 section should be cooler. To switch the appliance to VitaStore mode, you should just press [mode] button until “VitaStore symbol” light comes on. Zone 1 button will be off and user can not change Zone1 compartment temperature.

If Zone 1 was used as freezer, user should observe below rules before usage of VitaStore mode.



**Important:** If Zone1/Zone2 compartment will be converted from freezer to cooler:

- You should empty the food in the related compartment and clean the compartment. You should leave the door close for 4 hours. Then, food will be placed in the relevant compartment.
- Baskets and/or shelves removed from the compartment should be re-fitted.

### Note:

- VitaStore mode shouldn't be activated if Zone 1 is used as freezer.
- Foods should not be put in front of the fan.
- VitaStore keeps fruits and vegetables fresh and helps vitamin and nutritional values of fruits and vegetables to protect by maintaining ideal humidity and temperature conditions.

### Maximum storage conditions of some fruits and vegetables

FRUITS & VEGETABLES	STORAGE TIME
Lettuce	10 days
Green leaves	10 days
Tomato	7 days
Cucumber	7 days
Lemon	15 days
Cherry	15 days
Orange	20 days
Strawberry	5 days
Carrot	20 days
Broccoli	10 days
Spinach	10 days
Squash	15 days
Apple	25 days
Grapes	20 days
Artichoke	15 days

### Note:

- These conditions illustrate an maximum rate of decay of some fruits and vegetables stored properly with VitaStore mode. All storage times are suggestion. Storage times of fruits and vegetables depend on the quality of the food, postharvest conditions and uninterrupted refrigeration from harvest until storage in a VitaStore appliance. Individual cases may vary.
- Packaged fruits and vegetables are consumed until expire dates of produces.

## Warnings about Temperature Adjustments

- Your temperature adjustments will not be deleted when an energy breakdown occurs.
- It is not recommended that you operate your fridge in environments colder than 10°C in terms of its efficiency.
- Temperature adjustments should be made according to the frequency of door openings, the quantity of food kept inside the fridge and ambient temperature of the place of your fridge.
- Your fridge should be operated up to 24 hours according to the ambient temperature without interruption after being plugged in to be completely cooled. Do not open doors of your fridge frequently and do not place much food inside it in this period.
- 5 minute delaying function is applied to prevent damage to the compressor of your fridge, when you take the plug off and then plug it on again to operate it or when an energy breakdown occurs. Your fridge will start to operate normally after 5 minutes.
- Your fridge is designed to operate in the ambient temperature intervals stated in the standards, according to the climate class stated in the information label. We do not recommend operating your fridge out of stated temperatures value limits in terms of cooling effectiveness.

Climate Class	Ambient temperature oC
T	16 to 43°C
ST	16 to 38°C
N	16 to 32°C
SN	10 to 32°C



*If the ambient temperature is higher than 38°C, the compartment temperature cannot be set to -22°C, -23°C or -24°C.*

*It can only be set to -16°C, -17°C, -18°C, -19°C, -20°C or -21°C.*

## Demo mode

This mode will be use for only sales points by salesman to show functions & modes to customer without operating components as a compressor, fan, etc.

### Entering Demo mode :

Firstly the power is on , secondly the starting program is waited for 85 seconds and then push q.drink button continuously within 3 minute , During this time, open and close Zone-2 door for 3 times. Then, appliance will go on “demo function” and Door light open Symbol will light during the mode.

### Canceling Demo mode :

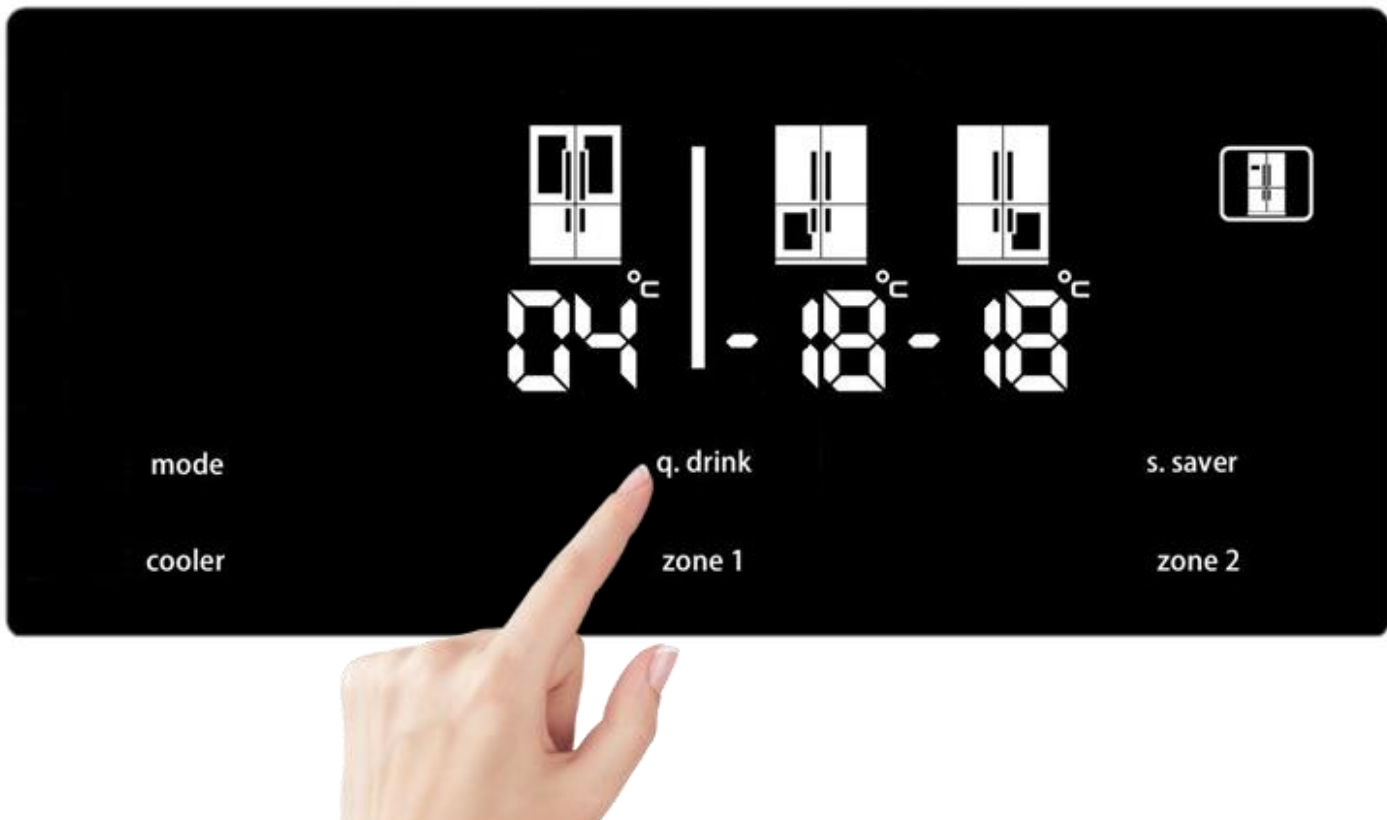

For cancelling; Same operation will be used. If user will push q.drink button continuously, During this time, open and close Zone-2 door for 3 times, demo function will be cancelled.

When appliance is Demo mode; if plug is removed or there is an electricity breakdown; demo mode will continue with current settings after user plug into or electricity breakdown finish.

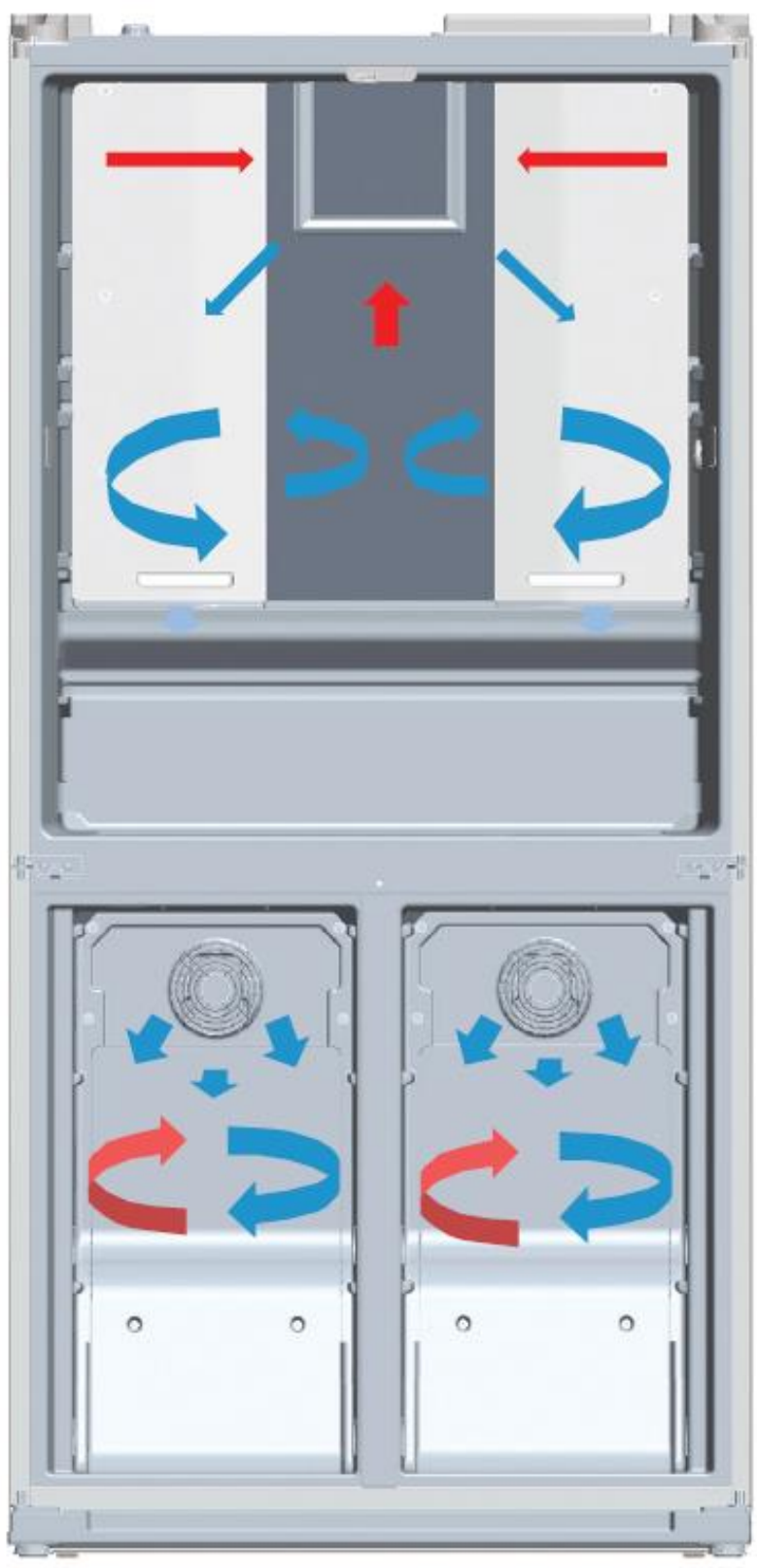

### Flow of Air



-  Blow cold air
-  Returning hot air

## ZONE-1

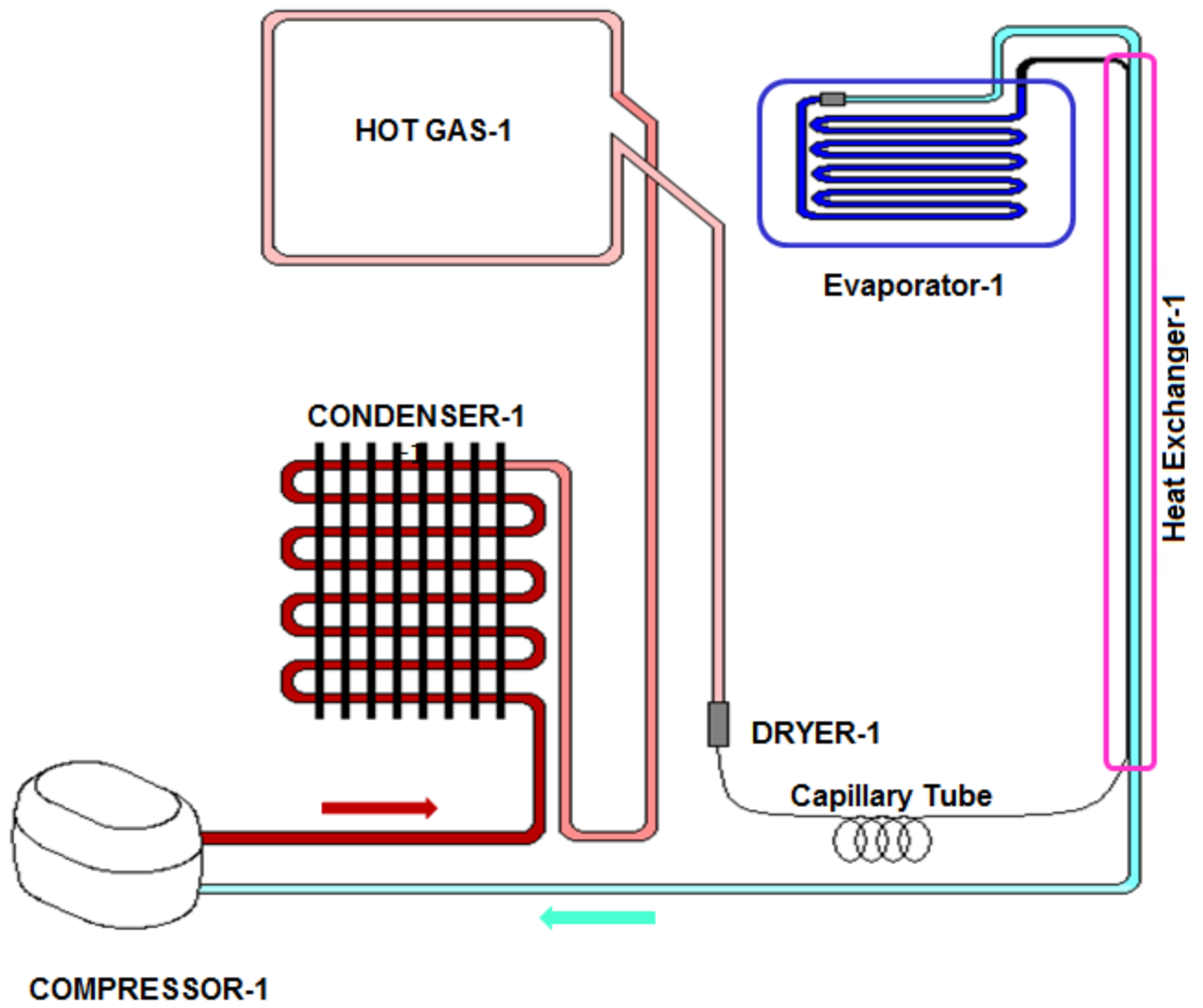

### COOLER Compartment and ZONE-2

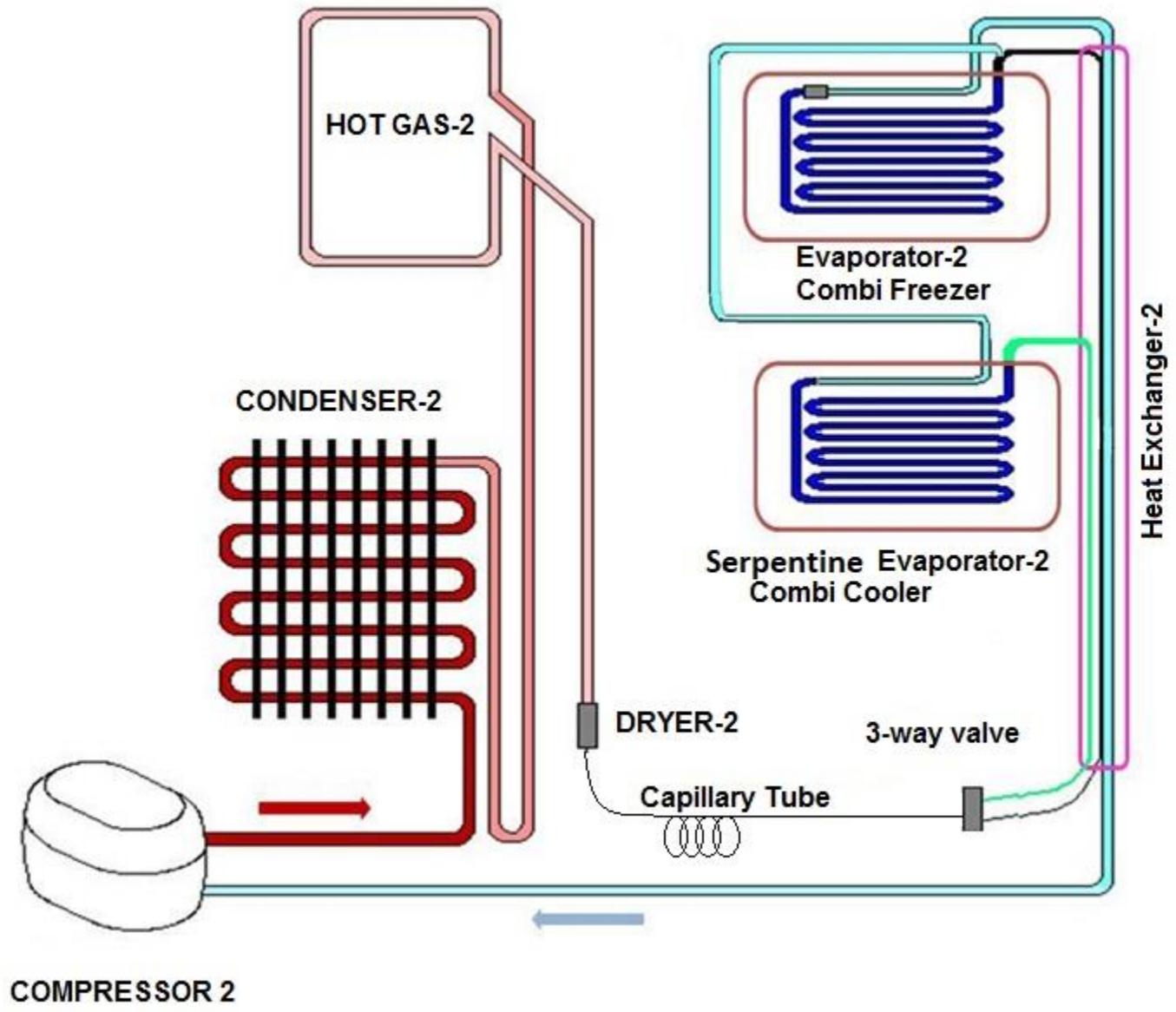

## SERVICE MODE

### Entering service mode :

Push cooler button continuously. During this time, open and close Zone-2 Door 3 times for a short time. Please make sure the door to close exactly. Otherwise, it would not be activate.

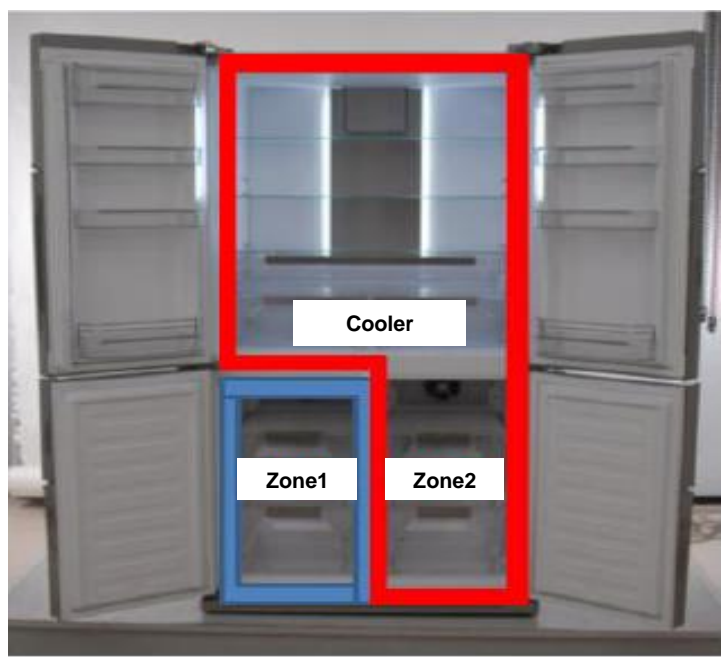

### During service mode :

Buzzer will sound beep for 0.1 sec. each 5 sec. during service mode.  
 Temp. segments will show error codes, (service mode reaction). Symbols will be OFF.  
 Only Alarm symbol will blink during Service Mode.  
 If there is no error , segments will show nothing except of Alarm symbol.  
 If service man pushes Quick Drink button he will be able to choose functions listed next page.  
 Functions will be set if service man does not push any other button for 1 sec.  
 Service man has 4 functions to select. First 4 push of Quick Drink button will activate symbols.  
 Service man will cancel mode selection if he stops pushing button on the 5th push.

The ERROR Codes are shown in page 19-20.

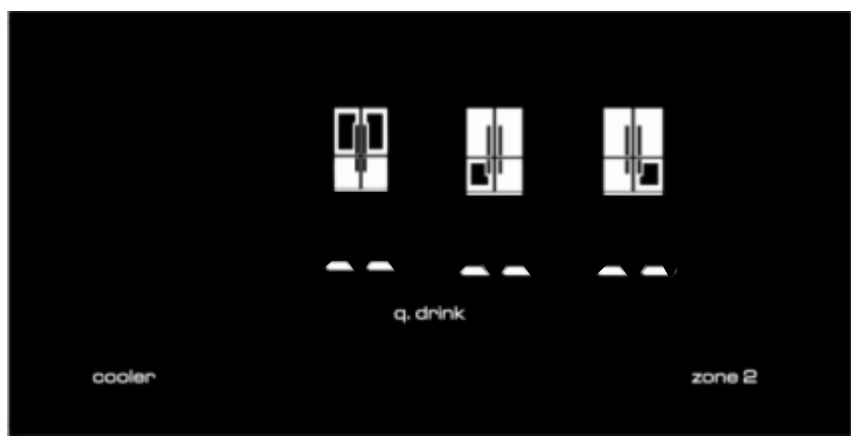

## 1. When push «q.drink» once; Starting program



NOTE: It is necessary to wait for 85 seconds until the end of the process. It can not be canceled.

Economy symbol in display will blink during mode. Multizone\_2 segment will show as components are checked. During this step, please use an electricity usage monitor to check the energy consumption of components.

- “01” will light when Refrigerator fan is ON
- “02” will light when Multi Zone1 fan motor is ON
- “03” will light when Multi Zone2 fan motor is ON
- “04” will light when Compressor\_2 is ON
- “05” will light when Compressor\_1 is ON
- “06” will light when Refrigerator Defrost Resistance is ON
- “07” will light when R&Su Heater is ON
- “08” will light when Trizbar Heater is ON
- “09” will light when Refrigerator Frame Heater is ON
- “10” will light when Aku\_1 Heater is ON
- “11” will light when Balance\_1&2 Heater is ON
- “12” will light empty
- “13” will light when Refrigerator Air Duct Heater is ON
- “14” will light when multizone\_2 Fin Evap Heater is ON
- “15” will light when Aku\_2 Heater is ON
- “16” will light when Multizone\_1 Fin Evap Heater is ON
- “17” will light when Middle Bracket Heater is ON



As starting program finishes, first symbol will be OFF. Appliance will return to initial service mode reaction.

## 2. When push «q.drink» twice; Forced defrost and forced canceling of defrost

Holiday symbol will blink during mode. Defrosting mode will start from Step 3. Mode can be canceled manually or automatically.

Manual canceling will be done by pushing cooler button. Symbol will be OFF if defrost is canceled manually. Appliance will return to initial Service mode reaction.

If manual canceling of this function is not performed in 30 min.

Service mode will be canceled. Appliance will check if defrost is finished in this 30min. If YES, appliance will go on from previous set values. But if defrost is not finished, appliance will go on defrost till it finishes and then go on from previous set values.



q. drink

cooler

zone 2

### 3. When push «q.drink» thrice Forced opening and closing of valve

[q.drink] symbol will blink during this mode.

Only the icon of compartment which valve gives the way ON, will blink.

If the service man push zone\_2 button, the valve will change to other side way and part icon which valve gives the way ON, will blink.

Compressor will run during this mode.

Manual canceling will be done by pushing cooler button. Symbol will be OFF and valve return to initial condition. Appliance will return to initial service mode reaction.



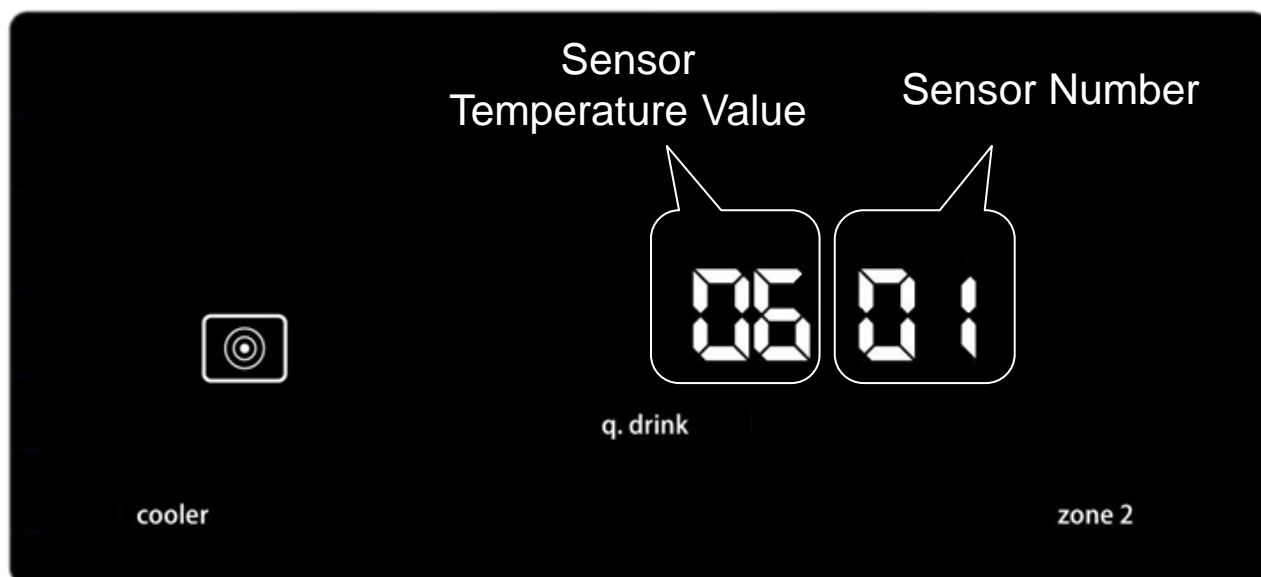

#### 4. When push «q.drink» for four times; Displaying actual temperatures in compartments

Sensor symbol will blink during mode. Service man could change the sensor number by pushing zone2 button



If service man pushes cooler button again, function will be canceled.  
Appliance will return to initial service mode reaction

Sensor Temperature Value (Zone 1)	Sensor Number (Zone 2)
	
Cooler compartment sensor temp. °C	"Sensor 1"
Zone-2 sensor temp. °C	"Sensor 2"
Zone-1 sensor temp. °C	"Sensor 3"
Zone-2 defrost sensor temp. °C	"Sensor 4"
Zone-1 defrost sensor temp. °C	"Sensor 5"
(RDS)cooler serpantine evap. sensor temp. °C	"Sensor 6"
Ambient sensor temp. °C	"Sensor 7"

5. Push Empty. No function is set

# USER AND SERVICE MODE ERROR MESSAGES

## Alarm symbols on display

After the service mode is activated, the display show the error codes as follows if there is any failure.

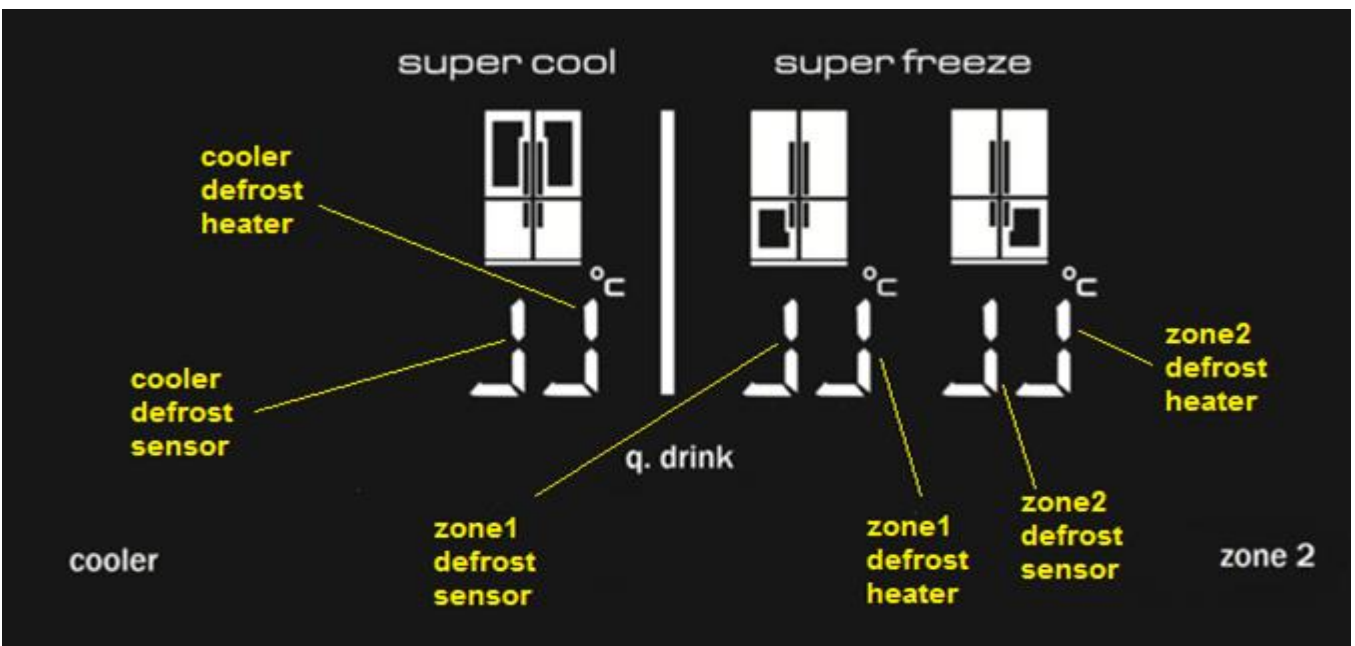
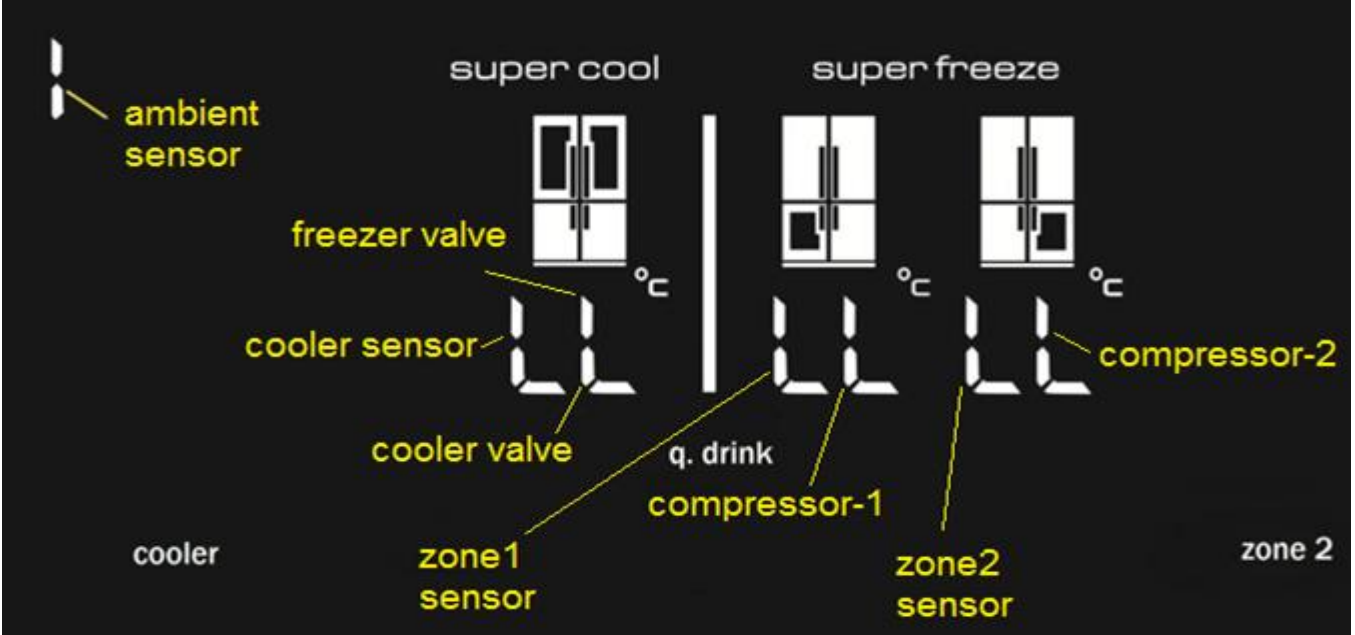

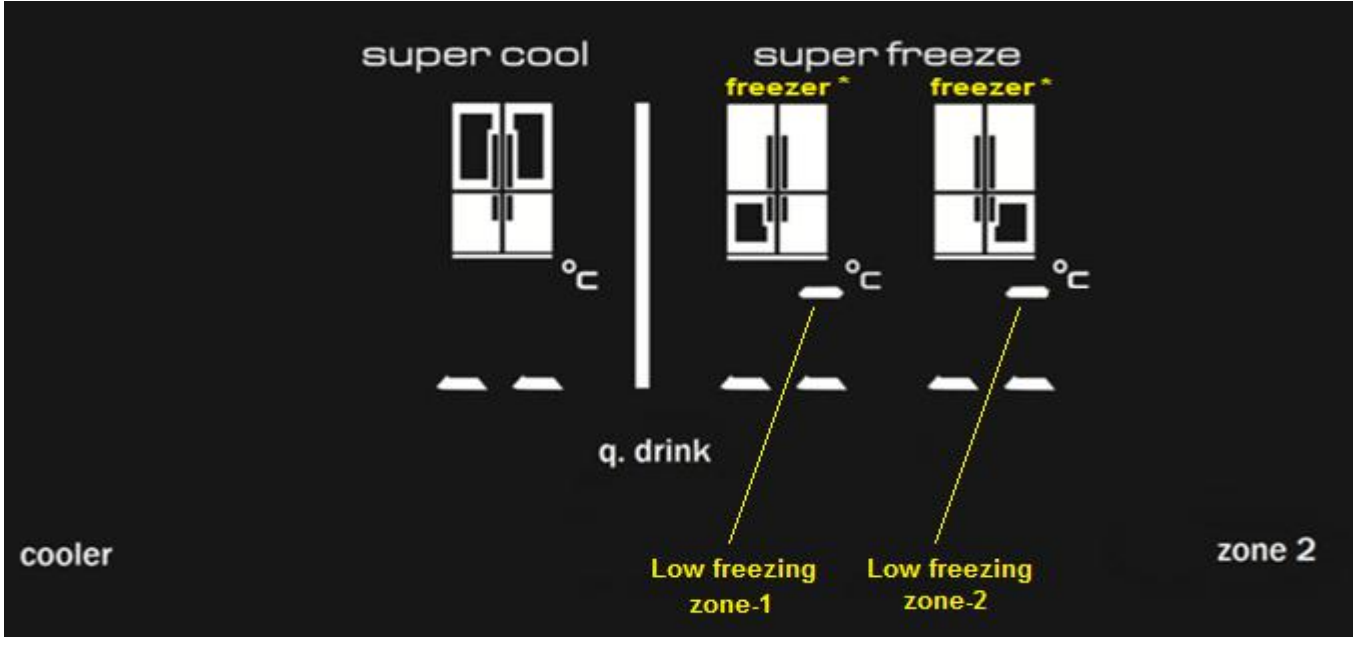
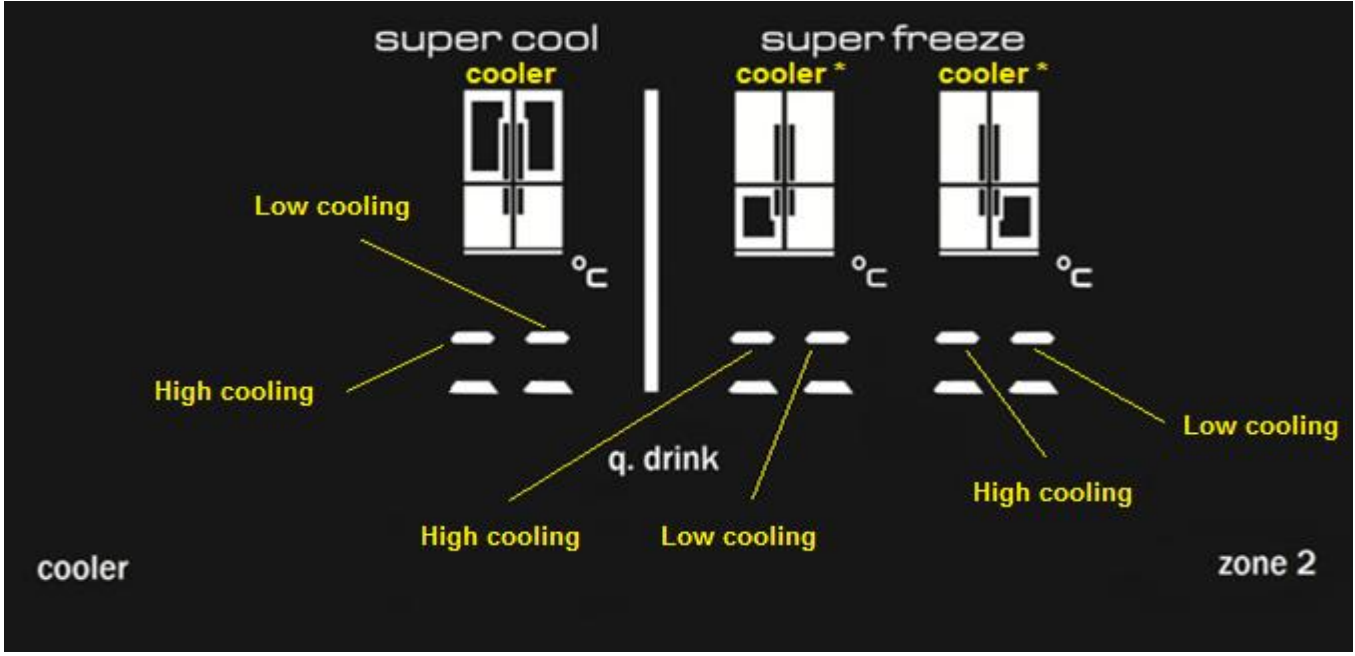

## Component defect

ERROR	DETAILS
Compressor 1 Defect	D sensor 1 temp $>-8^{\circ}\text{C}$ (D sensor temp. unchanged for 10 min. continuous compressor run)
Compressor 2 Defect	D sensor 2 temp $>-8^{\circ}\text{C}$ (D sensor temp. unchanged for 10 min. continuous compressor run and valve position is outlet – 2)
Defrost Heater 1 Defect	If D sensor1 $<0^{\circ}\text{C}$ after 90 min defrost started
Defrost Heater 2 Defect	If D sensor2 $<0^{\circ}\text{C}$ after 90 min defrost started
Serpentine Defect / Ref. Defrost Heater Defect	RDS $>-2^{\circ}\text{C}$ ( RDS temp. unchanged for 10 min. continuous compressor run and valve position is outlet-1)

## Low voltage error on display

DEFECT TYPE	DETAILS
Low voltage	Power supply $< 170$

## Cooling error :

### If Zone - 1 and Zone - 2 is used as Freezer compartment :

**NOTE:** To prevent the wrong alarms, this alarm status is disabled on following conditions:

- During the first 6 hours after the product was firstly connected.
- During the defrost period
- During the first two hours after a defrost
- During the first 2 hours that one of the doors was open.

ERROR	DETAILS
F sensor $> -8^{\circ}\text{C}$	Freezer compartment is not cool enough
R sensor $>25^{\circ}\text{C}$ and if Holiday mode is not active	Refrigerator compartment is warm
R sensör $< -8^{\circ}\text{C}$	Refrigerator compartment is so cool
F sensor $> -8^{\circ}\text{C}$ and R sensor $>25^{\circ}\text{C}$ and if Holiday mode is not active	Freezer and Refrigerator compartment both are not cool enough

**If Zone - 1 and Zone - 2 is used as Refrigerator compartment :**

**NOTE:** To prevent the wrong alarms, this alarm status is disabled on following conditions:

- During the first 6 hours after the product was firstly connected.
- During the defrost period
- During the first two hours after a defrost
- During the first 2 hours that one of the doors was open.

ERROR	DETAILS
F sensor > 30° C	Freezer M.zone compartment is warm
R sensor >25° C and if Holiday mode is not active	Refrigerator compartment is warm
R sensor <-8° C	Refrigerator compartment is so cold
F sensor < -20° C	Freezer M.zone compartment is so cold
F sensor > 30° C and R sensor >25° C and if Holiday mode is not active	Freezer M.zone compartment and Refrigerator compartment both are not cool enough

**For Refrigerator compartment**

ERROR	DETAILS
F sensor > -8° C	Freezer compartment is not cool enough
R sensor >25° C and if Holiday mode is not active	Refrigerator compartment is warm
R sensor <-8° C	Refrigerator compartment is so cool
F sensor > -8° C and R sensor >25° C and if Holiday mode is not active	Freezer and Refrigerator compartment both are not cool enough

## NORMAL DEFROST FUNCTION

### Calculating defrost starting time

**a) If  $AT < 23^{\circ}C$**

fix the defrost cycle to 16 hours (running + stopping)

**b) If  $23^{\circ}C < AT < 30^{\circ}C$**

**If door is not opened;**

First Defrost cycle time will be fixed to 20 hours.

Second defrost cycle time will be fixed to 26 hours.

Third and following defrost cycle times will be fixed to 55 hours.

**If door is opened at first defrost cycle;**

Complete the defrost cycle time to 20hours and Next defrost cycle time will start from 20 hours again (from the beginning).

**If door is opened at second or following defrost cycle time, two case can be happen;**

If door opened **BEFORE** 20 hours in this cycle;

Complete the defrost cycle time to 20hours and Next defrost cycle time will start from 20 hours again (from the beginning).

If door opened **AFTER** 20 hours in this cycle ;

Immediately start defrost and next defrost cycle time will start from 20 hours again(from the beginning).

**c) If  $30^{\circ}C < AT \leq 35^{\circ}C$  ;**

Defrost cycle is max. 8 hours of compressor running accumulated time.

**Minimum defrost cycle time will be 16 hours (running+stopping)**

**d)  $AT \geq 35^{\circ}C$  ;**

Defrost cycle is max. 12 hours of compressor running accumulated time.

## Replacement of Upper Doors

1. Unscrew the screws fixing the left and right top hinge cover. (Fig-1.1 / Fig1.2)  
Open the door (about 30°) and remove the hinge covers.



**Figure-1.1**



**Figure-1.2**

2. Disconnect the socket connections. (Fig-2.1 / Fig-2.2)



**Figure-2.1**



**Figure-2.2**

3. Unscrew the screws fixing the top hinges and remove it. (Fig-3.1 / Fig-3.2)



**Figure-3.1**



**Figure-3.2**

4. Remove the refrigerator doors by lifting them up. (Fig-4.1 / Fig-4.2)



**Figure-4.1**

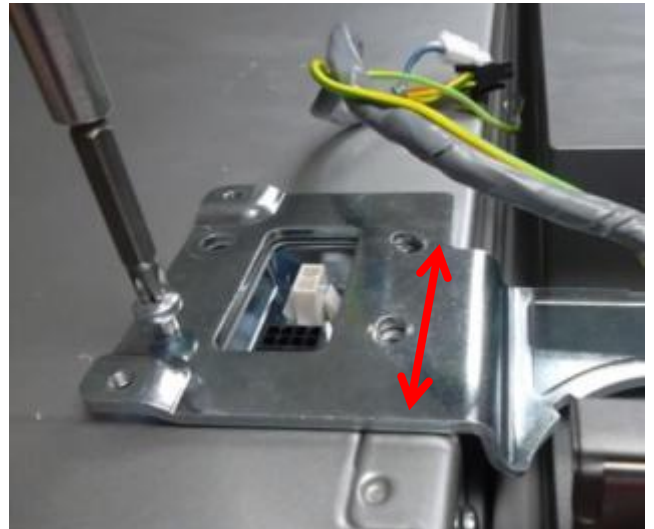

**Figure-4.2**

**Note-1:** To re-assembly the doors basically repeat the previous steps backwards. (Steps:4-3-2-1).

**Note-2:** After installing the upper doors , carefully connect the sockets around hinge area.

**Note-3:** Three out of Four screw sockets are slotted to let door adjustment.



## Replacement of Kick Plate

1. To not damage the paint use some piece of tape to cover left, right and middle of the bottom sheet as shown at below pictures.



**Figure-1.1**



**Figure-1.2**

2. To remove the kick plate start from the right side and gently release the plastic holder tab. Then again gently release the middle tab.



**Figure-2.1**



**Figure-2.2**

3. Gently release the left tab. To remove the kick plate pull it towards to yourself.



**Figure-3.1**



**Figure-3.2**

## Assembly of the Kick plate

1. Check the kick plate holders, if damaged replace them with new ones.



2. Start mounting from the left side and make sure the tabs on the kick plate are matching with the holders.



## Removing the Bottom Doors

1. Remove the right & left bottom door hinge covers with a Phillips screw driver.



2. Remove the bottom door handle led sockets .



3. Remove the middle hinge fixing screws with Phillips screw driver.



4. Remove the freezer doors by lifting them up.

**\*\*\* Make sure that the led sockets are not tripping anywhere.**



5. Remove the bottom hinge screws and take out the bottom hinges.



**Note-1:** To re-assembly the doors basically repeat the previous steps backwards. (Steps:5-4-3-2-1).

**Note-2:** Carefully connect the bottom door led sockets. If the sockets wont connect carefully or connected upside down the led will not operate.



## Replacement of Refrigerator Fan Motor

1. Remove the upper glass shelf.
2. Pull towards the fan motor cover placed on the air duct as shown below.



3. Then shift and remove the cover.



4. Remove the fan motor fixing screw and takeout the fan motor.

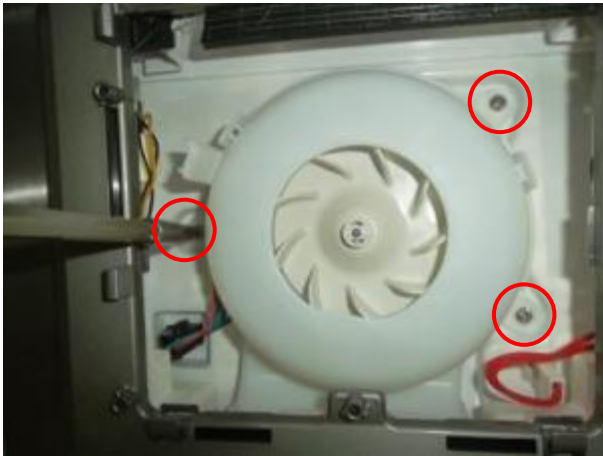

5. Hold and pull the fan motor socket as shown in the below picture.



**\*\*\* There is a radial type fan used in this product which works with DC 12 Volts.**

**Cables;**

**Red Cable (+)  
Blue Cable (-)  
Black Cable (for signal)**

## Replacement of Refrigerator Multiflow

1. Take out the glass shelves
2. Remove the fan motor cover and fan motor as described at previous sections.



3. Remove the led lightning sockets located at the left and right side as shown at the below pictures.



4. Hold and pull the air duct resistance socket.



5. Airduct is fixed with holders from both left & right side. To remove the airduct start to pull from the upper side and release the airduct from the holders.



6. Remove the airduct

7. Inner view of the air duct is below.



**\*\*\* In case of any fault at resistance, leds or plastic holders; replace the whole airduct with grouped code.**

8. Remove the left air duct cover screw caps with the help of a thin tipped tool.



9. Unscrew the fixing screws at the left side.



10. Remove the left air duct cover.



11. Remove the right air duct cover screw caps with the help of a thin tipped tool



12. Unscrew the fixing screws at the right side.



13. Remove the right air duct cover.



**Note:** To re-assembly basically repeat the previous steps backwards.

## Replacement of Freezer Multiflow

1. Remove the fixing screws of drawer rails.



2. Takeout the rails.



3. Unscrew the air duct fixing screws.



4. Remove the fan protection wire with the help of a screwdriver



5. Pull and take out the air duct cover.



**Note:** To re-assembly basically repeat the previous steps backwards.

## Replacement of ZONE-1 Fin Evaporator Assy

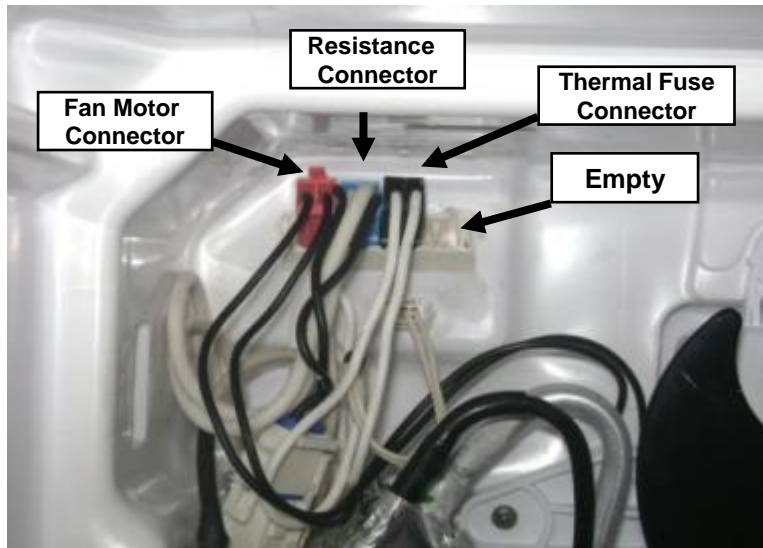

### Zone 1 Multi socket connections

1. Take out the putty on the socket.



2. Take out the thermal fuse connector (**Black** connector)

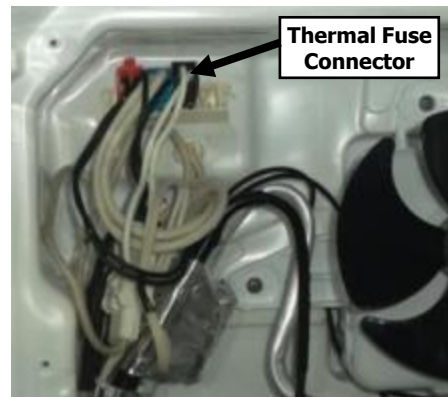

3. Cut off the thermal fuse fixing cable holder.



4. Take out the thermal fuse.



5. Remove the defrost sensor socket.

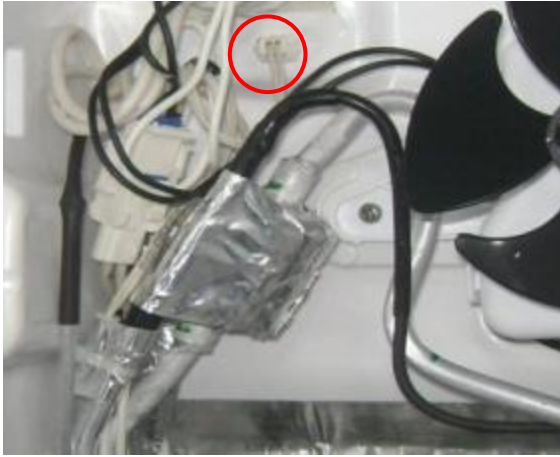

6. Cut off the cable holder and remove the sensor.



7. Unscrew the fan motor fixing screws



8. Remove the fan motor connector (pink connector)



9. Take out the fan motor



10. Fan motor parts are below

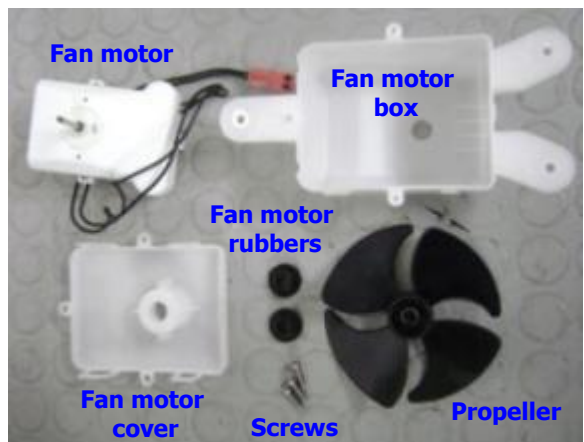

## Replacement of ZONE-2 Fin Evaporator Assy

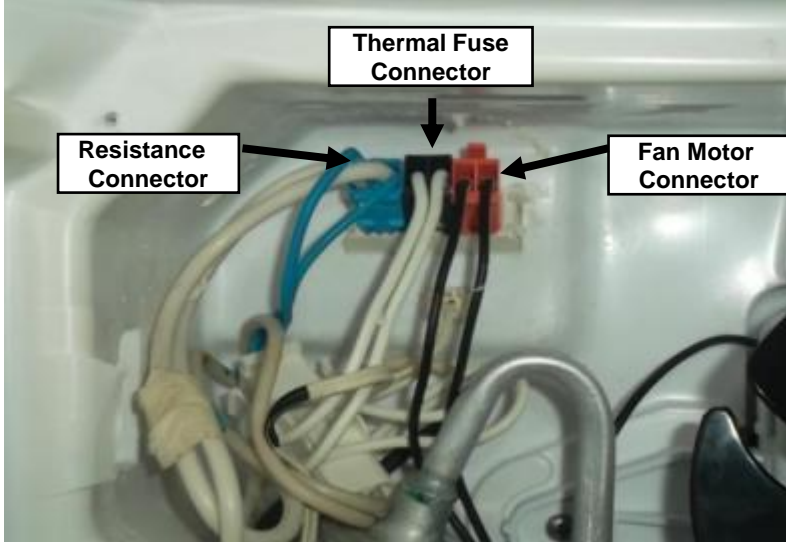

### Zone 1 Multi socket connections

- 1. Take out the putty on the socket.
- 2. Take out the thermal fuse connector (**Black** connector)

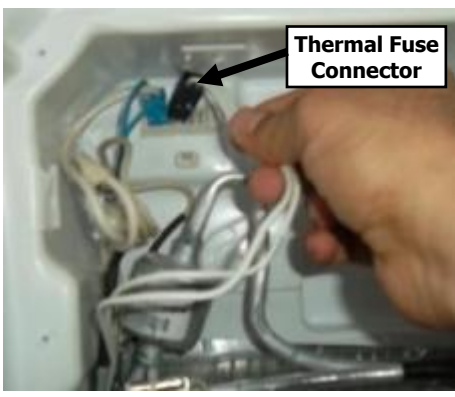

- 3. Cut off the thermal fuse fixing cable holder.
- 4. Take out the thermal fuse.



5. Remove the defrost sensor socket.



6. Cut off the cable holder and remove the sensor.



7. Unscrew the fan motor fixing screws



8. Remove the fan motor connector (pink connector)



9. Take out the fan motor



10. Fan motor parts are below

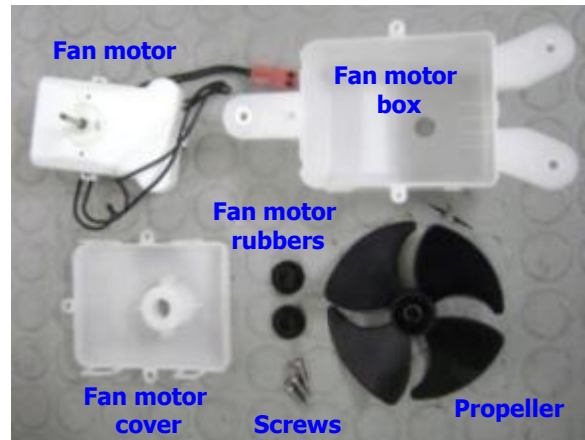

## Replacement of Fin Evaporator Tray Resistance

1. Disconnect the tray resistance connection



2. Pull the evaporator to release it from the holders.



3. Carefully flip the evaporator to the left side.



4. Slowly pull the tray resistance.



**Not: Resistance used at the Zone 1 and Zone 2 are different in terms of power and design, they are not interchangeable.**

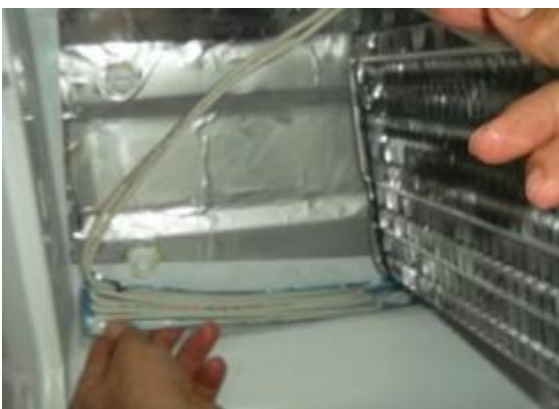

## Replacement of Main Board

**Warning: Make sure the unit is unplugged**

1. Remove the mainboard cover screws placed at the top of the unit and take the



2. Mainboard socket connections are described as below.

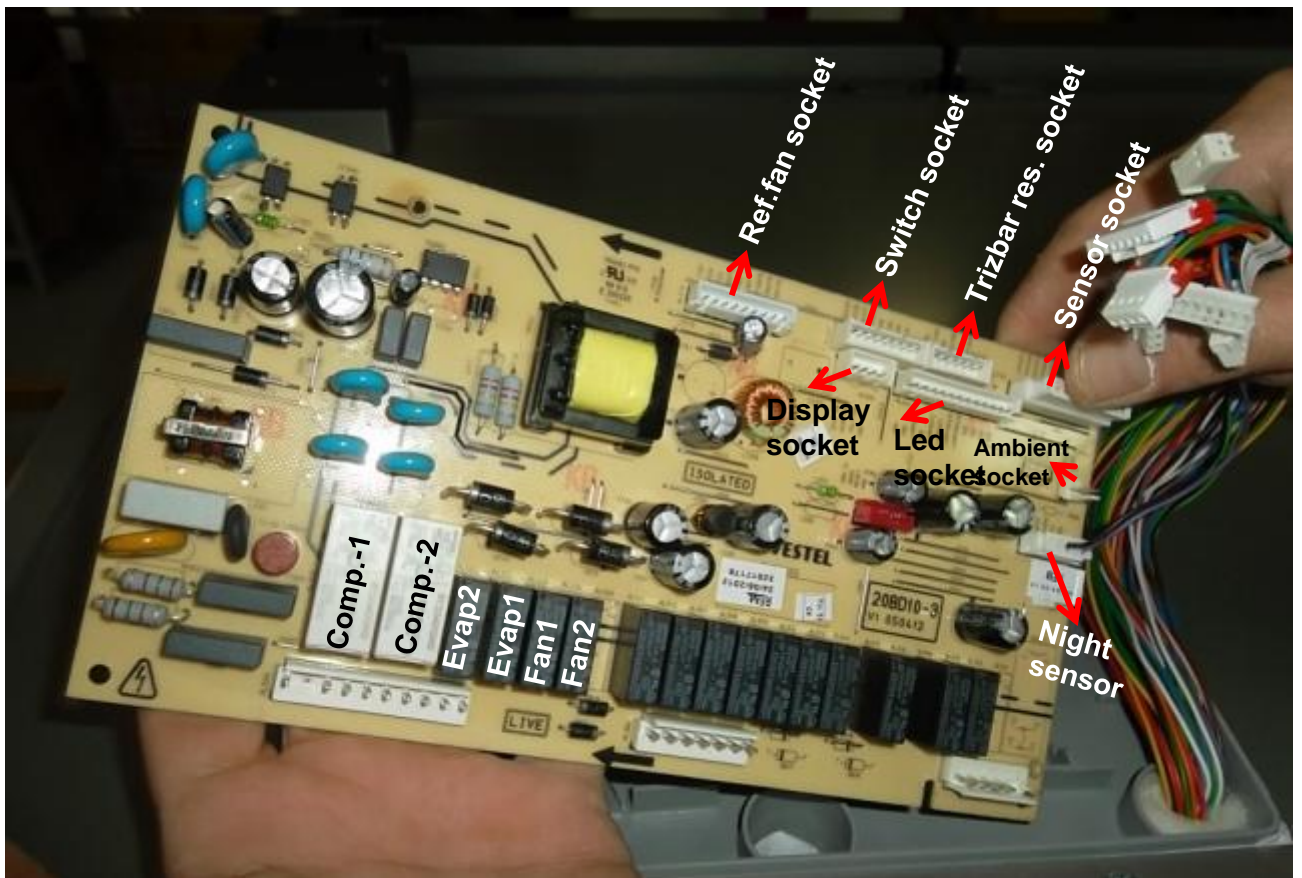

3. Remove the connection sockets carefully and remove the mainboard.



**Not:** All sockets are different on the main board .They are not interchangeable.

4. Replace the main board.



5. Connect the sockets

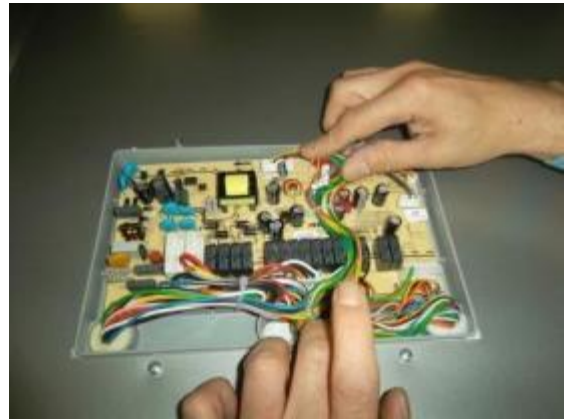

6. Tidy up the cables, place the cover and fix the screws.



## Replacement of Display

**Warning: Make sure the unit is unplugged**

1. Display can be removed with the disassembly tool. Do not use any sharp objects to remove the display.
2. Disassembly tool code is 42082456



3. Place and fix the disassembly tool on to display and pull to take out the display.



4. Take out the display cable socket.



5. Back view of the display card



6. Connect the display cable, place and fit the display card and push until the holders are placed.



6. Check if there any elevation around the corner.



## Replacement of Door Handle

1. Disassembly the snapfits on the door handle cover with flat-blade screwdriver.



2. There are tipplings for flat-blade screwdriver inside of door handle.



3. Disassembly the door handle cover.



4. Disassembly the connector of LED.



5. Disassembly the screws on door handle.



6. Disassembly the door handle.    7. Apply the same method for the other door handles.



8. Assembly the door handle cover as shown below.

9. Assembly snapfits as shown below.



**Note: Carefully connect the bottom door led sockets. If the sockets wont connect carefully or connected upside down the led will not operate.**

## Replacement of Led Strip (inside of the door)

1. Led lightning at the inner side of the door plastics are shown at below picture.



2. Remove the screws



3. LEDs at the inner side of the doors are fixed with double sided tape.



4. Remove the led strip sticker with a sharp tool.



5. Take out the socket and remove the led strip.



**Note: Carefully connect the bottom door led sockets. If the sockets wont connect carefully or connected upside down the led will not operate.**

## Replacement of Trizbar

Trizbar is placed on the upper left door. There are two sliding connection point at the top and bottom of the trizbar. There is a DC 12V resistance inside the trizbar. Trizbar should have replaced as a group.

1. Hold the trizbar as showed and lift with both hands for dismantling.



2. Resistance socket is at the upper connection point.

3. Trizbar pin fits to the mechanism at the upper side of the refrigerator cabinet.



4. Remove the fixing screws of the mechanism and take out from the body for replacement.



## Replacement of Door Reed Switch

There are two switches at the upper section , one at the left side other at the right side.

1. Remove the switch and holder with the help of a thin tipped screwdriver as showed below.



2. After removing the switch , take out the cable sockets for replacing.



**Note:** While placing the switch black part should have been at the outer side.

There are two switches at the lower sections , one at the upper side of the Zone 1 other at upper side of the Zone 2. Replacement method is the same with others.



## Replacement of Sensors

**Ambient Sensor is placed at the left top of the unit.**

1- Remove the refrigerator sensor cover by pulling forward.



2- Remove the sensor by hand and remove the sensor connector.



**Refrigerator Sensor is placed at the inner left side of the refrigerator section.**

1 - Remove the refrigerator sensor cover by pulling forward.



2- Remove the sensor by hand and remove the sensor connector.



**Note: Make sure that cover holder details not broken while removing/placing.**

**Zone -1 sensor is placed at the inner right back side of Zone -1.**

1- Remove the refrigerator sensor cover by pulling forward.



2- Remove the sensor by hand and remove the sensor connector.



**Zone -2 sensor is placed at the inner left back side of Zone -2.**

1- Remove the refrigerator sensor cover by pulling forward.



2- Remove the sensor by hand and remove the sensor connector.



**Note: Make sure that cover holder details not broken while removing/placing.**

## Chiller dismantling

1 - Open the refrigerator doors and pull the chiller towards.



2 - Push the chiller upwards while pushing the telescopic rail downwards to release the holder.



3 - Push the chiller upwards while pushing the telescopic rail downwards to release the holder.

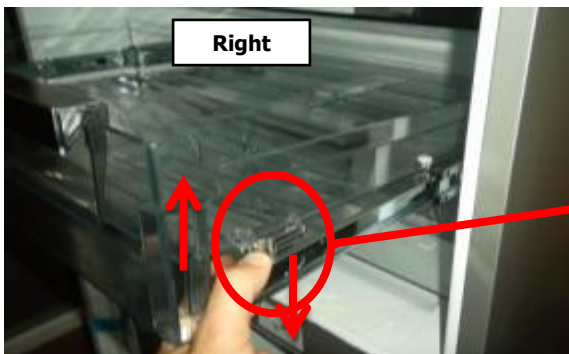

4 - After releasing the chiller from the front holders pull the chiller.



5- Release the chiller from the rail holders by pulling it towards.



### Details of front & back holders

