



CR9206SS

Culina 90cm Range Stainless Steel



TECHNICAL INFORMATION



CR9206SS - Culina 90cm Range Stainless Steel

New product information sheet

Product name: CR9206SS

Description: Dual fuel double cavity range cooker

Product code: CR9206SS

Width 900mm
Stainless steel

Main oven features

8 Functions:

- *light*
- *conventional heat*
- *fan heat*
- *turbo base heat*
- *full grill*
- *eco grill*
- *turbo grill*
- *turbo defrost*

51 litre capacity

Programmable electronic timer

Small oven features

4 Functions:

- *light*
- *top heat*
- *base heat*
- *rotisserie grill*

31 litre capacity

Hob features

5 Gas burners:

- *1 triple ring wok burner*
- *1 rapid burner*
- *2 semi-rapid burners*
- *1 simmer burner*

Cast iron pan supports





CR9206SS - Culina 90cm Range Stainless Steel

New product information sheet

Product name: CR9206SS

Description: Dual fuel double cavity range cooker

Product code: CR9206SS

Auto electronic ignition

General features

Dual fuel

Flame safety device

Triple glazed doors with heat reflective glass

Full width sealed inner door glass

Tangential cooling fan

Closed door grilling

Full width storage drawer

Height adjustable stainless steel legs

LPG jets included

Accessories

2 Shelves with support racks in main oven

1 Shelf with support racks in small oven

2 Grill pans with handle

2 Enamelled baking trays

1 Rotisserie rack

Electronic connection

Rated load 3.80kW

Fuse rating 25A

Optional extras

Cast iron griddle CAPGRID1

Telescopic shelf runners CAPRACK3

CR9206SS

Culina 90cm Range Stainless Steel

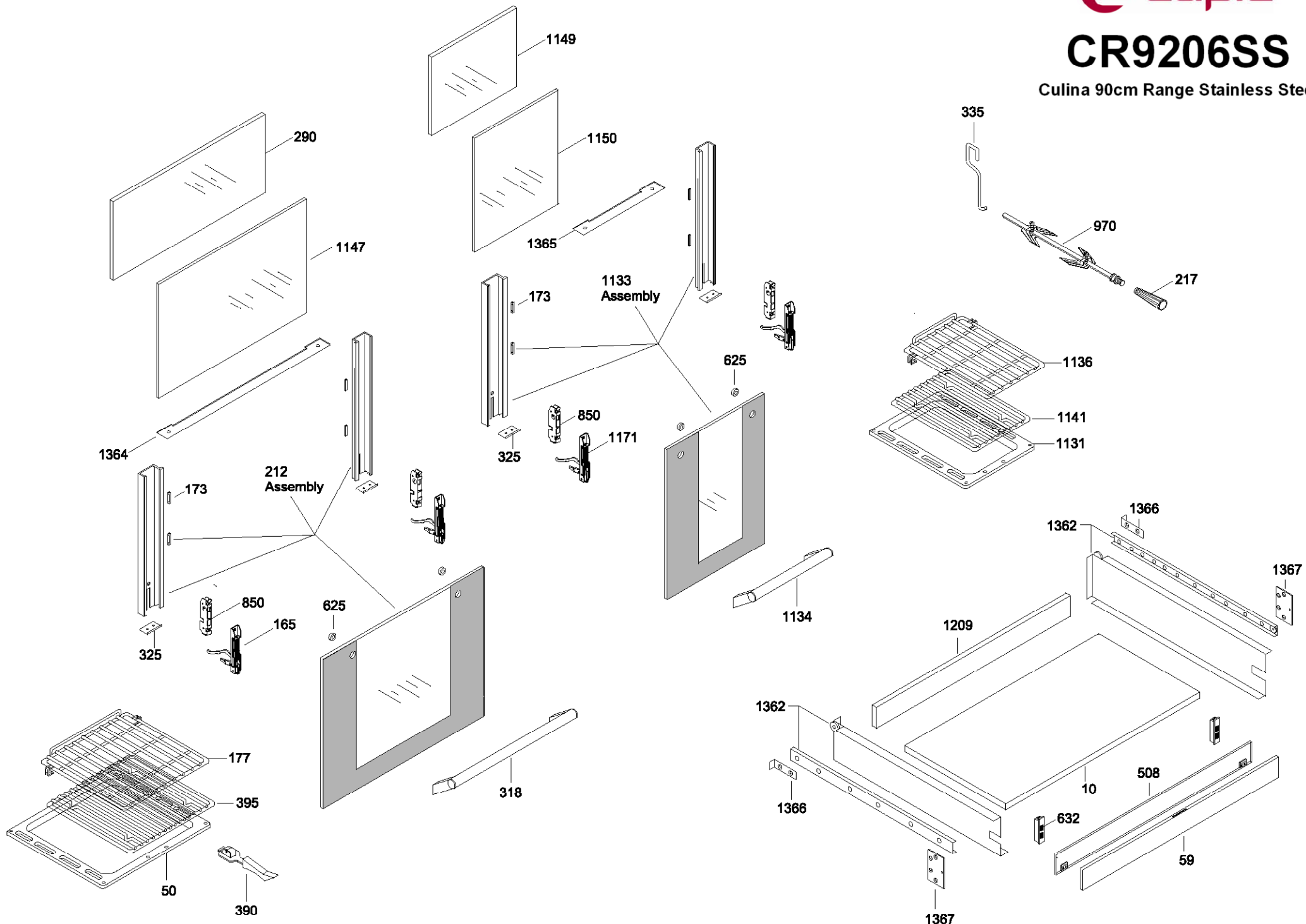



CR9206SS

Culina 90cm Range Stainless Steel

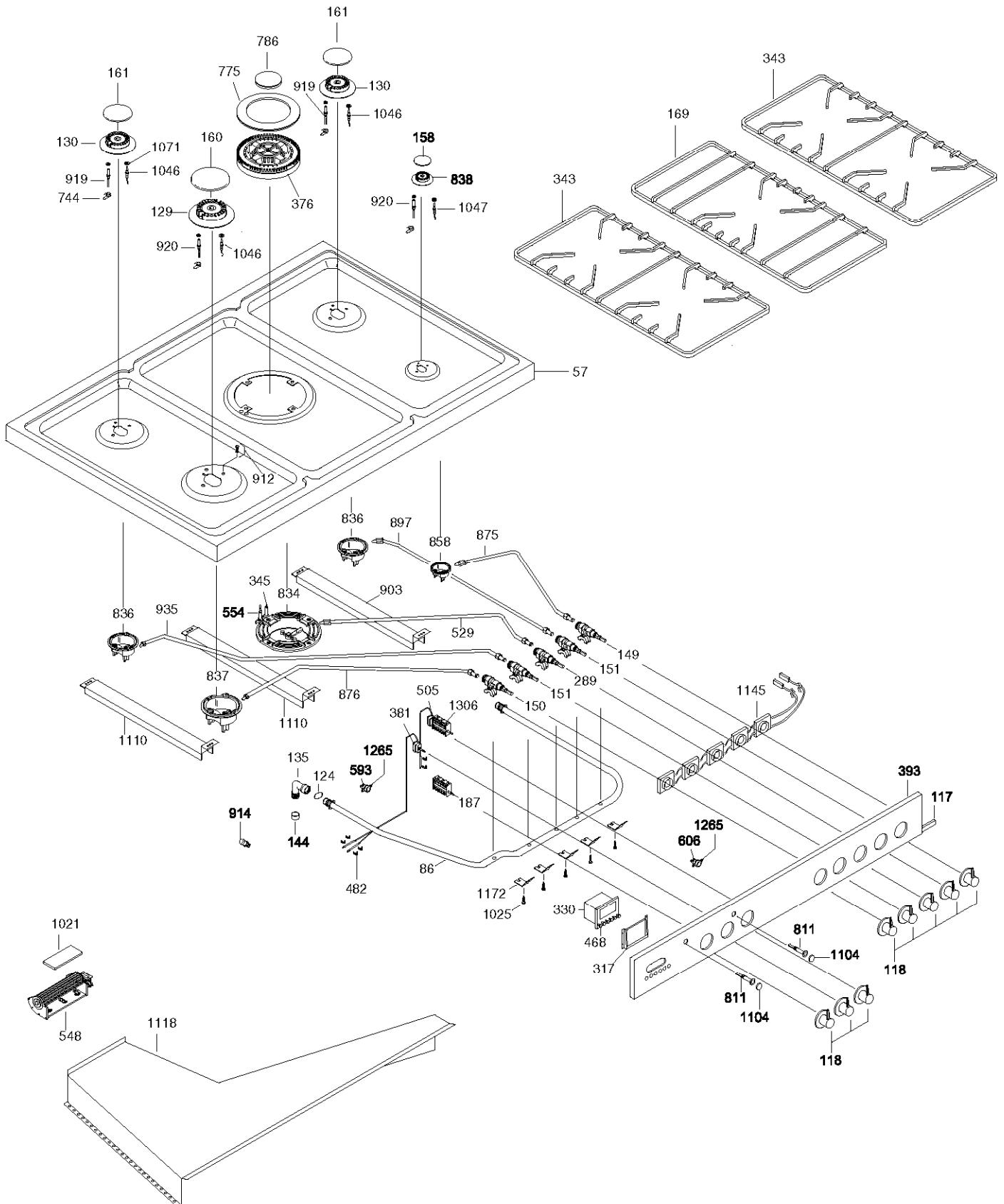



CR9206SS - Culina 90cm Range Stainless Steel

| Item | CODE | DESCRIPTION | Quantity |
|-------|--------|------------------------------------|----------|
| 00010 | 601414 | DRAWER BOTTOM | 1 |
| 00013 | 505171 | BLACK ZINC-PL.UNDER-SCREW SV53 | 8 |
| 00023 | 072877 | EXTERNAL REAR WALL | 1 |
| 00028 | 071126 | UPPER/GRILL HEAT.ELEMENT SUPPORT | 2 |
| 00044 | 112979 | BIG OVEN UPPER WALL-BLACK- | 1 |
| 00047 | 112676 | COOKER FACE -BLACK- | 1 |
| 00048 | 113471 | SIDE | 4 |
| 00049 | 113421 | BIG OVEN BOTTOM -BLACK- | 1 |
| 00050 | 113752 | BIG OVEN DRIP-TRAY | 1 |
| 00051 | 113738 | OVEN REAR WALL | 1 |
| 00055 | 275548 | RIGHT/LEFT SIDE -STAINLESS STEEL- | 2 |
| 00057 | 276040 | HOB | 1 |
| 00059 | 274297 | DRAWER DOOR | 1 |
| 00086 | 372001 | MANIFOLD | 1 |
| 00117 | 400334 | FACIA-PANEL GASKET | 1 |
| 00118 | 404902 | GAS KNOB | 8 |
| 00123 | 404194 | LEG | 4 |
| 00124 | 400688 | ELBOW WASHER | 2 |
| 00129 | 414135 | SABAF RAPID BURNER CUP | 1 |
| 00130 | 414134 | SABAF SEMI-RAPID BURNER CUP | 2 |
| 00135 | 424079 | 1/2 CONICAL ELBOW | 1 |
| 00144 | 410823 | PLUG FOR ELBOW | 1 |
| 00149 | 424814 | TAP | 1 |
| 00150 | 424811 | TAP | 1 |
| 00151 | 424806 | TAP | 2 |
| 00158 | 440405 | AUXILIARY BURNER FLAME-SPREADER | 1 |
| 00160 | 440403 | RAPID BURNER FLAME-SPREADER | 1 |
| 00161 | 440404 | S.RAPID BURNER FLAME-SPREADER | 2 |
| 00165 | 431163 | OVEN DOOR HINGE | 2 |
| 00169 | 440438 | CENT.HOB GRID TC190CAST IRON STEEL | 1 |
| 00173 | 500458 | DOUBLE CLIP | 6 |
| 00173 | 601395 | SPRING FOR DOUBLE GLASS | 4 |
| 00173 | 601395 | SPRING FOR DOUBLE GLASS | 4 |
| 00173 | 601395 | SPRING FOR DOUBLE GLASS | 4 |
| 00173 | 601395 | SPRING FOR DOUBLE GLASS | 4 |
| 00177 | 451402 | BIG OVEN WIRE GRID | 2 |
| 00180 | 451391 | LATERAL SUPPORTS FOR GRIDS | 4 |
| 00183 | 471128 | WHITE GLASS WOOL (BIG OVEN) | 1 |
| 00187 | 481733 | MULTIFUNCTIONAL COMMUTATOR | 1 |
| 00191 | 482500 | IGNITER | 1 |
| 00197 | 482808 | LAMP+LAMP-HOLDER | 2 |
| 00201 | 481913 | OVEN TERMINAL BOARD | 1 |
| 00201 | 780124 | TERMINAL BOX+CABLE GROUP | 1 |
| 00212 | 655536 | FRAME+BIG DOOR GLASS GROUP | 1 |
| 00217 | 521042 | SPIT HANDLE | 1 |
| 00218 | 521054 | TURNSPIT MOTOR | 1 |
| 00289 | 424807 | TAP | 1 |
| 00290 | 494148 | DOUBLE GLASS | 1 |
| 00309 | 072878 | TERMINAL BOX SUPPORT | 1 |
| 00312 | 113363 | OVEN FAN COVER | 1 |
| 00317 | 072285 | SUPPORT FOR CLOCK | 1 |
| 00318 | 361483 | BIG DOOR HANDLE | 1 |
| 00322 | 411213 | FIX.ELEMENT FOR LATERAL OVEN GRIDS | 12 |
| 00325 | 113851 | LOWER CLOSING FOR LATERAL SUPPORTS | 2 |



CR9206SS - Culina 90cm Range Stainless Steel

| Item | CODE | DESCRIPTION | Quantity |
|-------|--------|-------------------------------------|----------|
| 00325 | 113851 | LOWER CLOSING FOR LATERAL SUPPORTS | 2 |
| 00326 | 482757 | CIRCULAR HEATING ELEMENT 2100W | 1 |
| 00329 | 521073 | FAN MOTOR | 1 |
| 00330 | 601308 | ELECTRONIC TIMER | 1 |
| 00331 | 072334 | REAR WALL FOR MOTORS SUPP.-BIG OVEN | 1 |
| 00335 | 451143 | TURNSPIT ROD SUPPORT | 1 |
| 00337 | 482756 | LOWER HEATING ELEMENT | 1 |
| 00338 | 482738 | UPPER/GRILL HEATING ELEMENT | 1 |
| 00343 | 440439 | HOB GRID190RIG./LEF(CAST IRON)STEEL | 2 |
| 00345 | 482077 | TR.CROWN BURNER SPARK PLUG (L=900) | 1 |
| 00376 | 414211 | TRIPLE CROWN BURNER CUP | 1 |
| 00381 | 482119 | THERMOSTAT | 1 |
| 00390 | 401764 | DRIP-TRAY HANDLE | 1 |
| 00393 | 274448 | CONTROL PANEL | 1 |
| 00395 | 451257 | WIRE GRID | 1 |
| 00449 | 401520 | COVERING RING FOR FACIA-PANEL HOLE | 2 |
| 00468 | 405542 | ELECTR.PROGRAMMER KNOB | 6 |
| 00482 | 601152 | OVEN SAFETY DEV.LOCKING SPRING | 6 |
| 00484 | 073038 | LEFT/RIGHT REAR BODY SUPPORT | 1 |
| 00505 | 482120 | THERMOSTAT | 1 |
| 00508 | 073474 | DRAWER COUNTERDOOR | 1 |
| 00529 | 332664 | TC BURNER CONNECTING TUBE | 1 |
| 00536 | 505047 | WASHER FOR OVEN DOOR REINFORC. | 6 |
| 00548 | 482544 | COOLING FAN | 1 |
| 00554 | 424322 | SAFETY VALVE FOR TRIPLE CROWN BUR. | 1 |
| 00593 | 482362 | THERMO SWITCH 70 | 2 |
| 00606 | 482438 | THERMO SWITCH 10-16A | 2 |
| 00625 | 401800 | SPACER FOR GLASS/TUBULAR HANDLE | 2 |
| 00625 | 401800 | SPACER FOR GLASS/TUBULAR HANDLE | 2 |
| 00632 | 601251 | MAGNET FOR DRAWER | 2 |
| 00633 | 271198 | STEEL CABLE LOCK | 1 |
| 00662 | 405736 | MAIN OVEN GASKET | 1 |
| 00744 | 601229 | CLAMP.SPRING FOR TC IGN.SPARK PLUG | 5 |
| 00775 | 440400 | TR.CROWN BURNER FLAME-SPREADER(EXT) | 1 |
| 00783 | 481593 | STRIP FOR WIRE LOCK | 1 |
| 00786 | 440401 | TR.CROWN BURNER FLAME-SPREADER(CEN) | 1 |
| 00811 | 482326 | WARNING LIGHT | 2 |
| 00834 | 414210 | TRIPLE CROWN BURNER BODY (NAT.)1,28 | 1 |
| 00836 | 414121 | SABAF S.RAPID BURNER BODY (NATURAL) | 1 |
| 00836 | 414121 | SABAF S.RAPID BURNER BODY (NATURAL) | 1 |
| 00837 | 414212 | RAPID BURNER BODY (NAT.) 1,15 | 1 |
| 00838 | 414136 | SABAF AUXILIARY BURNER CUP | 1 |
| 00850 | 431113 | HINGE ROLLER | 4 |
| 00858 | 414123 | SABAF AUXILIARY BURNER BODY (NAT.) | 1 |
| 00875 | 332534 | AUXILIARY BURNER CONN.TUBE | 1 |
| 00876 | 332575 | FRONT LEFT BURNER CONN.TUBE | 1 |
| 00897 | 332533 | REAR RIGHT BURNER CONN.TUBE | 1 |
| 00903 | 072774 | LATERAL SUPPORT FOR RIGHT AUX/SR B. | 1 |
| 00914 | 423411 | CHECK POINT | 1 |
| 00919 | 481972 | IGNITION SPARK PLUG FOR SABAF BURN. | 2 |
| 00920 | 482078 | LEFT BURNER IGN.SPARK PLUG (L=900) | 2 |
| 00935 | 332532 | REAR LEFT BURNER CONN.TUBE | 1 |
| 00970 | 521048 | SPIT 154 NF | 1 |
| 01021 | 402922 | GASKET FOR TANGENTIAL FAN | 1 |



CR9206SS - Culina 90cm Range Stainless Steel

| Item | CODE | DESCRIPTION | Quantity |
|-------|--------|-------------------------------------|----------|
| 01025 | 506244 | ZINC-PLATED SCREW M4 X 16 | 5 |
| 01046 | 424006 | REAR SAFETY DEVICE FOR S.RAPID BUR. | 2 |
| 01046 | 424101 | RIGHT/LEFT REAR SAFETY VALVE | 1 |
| 01047 | 424007 | FRONT SAFETY DEV.FOR RAP/AUX BURNER | 1 |
| 01071 | 424008 | SCREW NUT FOR SAFETY DEVICE CLAMP | 5 |
| 01104 | 482057 | ORANGE WARNING LIGHT CAP 27299904OT | 2 |
| 01108 | 072438 | SUPP.FOR BIG OVEN REFLECT.ELEMENT | 1 |
| 01109 | 072433 | SUPP.FOR LITTLE OVEN REFLEC.ELEMENT | 1 |
| 01110 | 072310 | RIGHT/TC CENTRAL BURNER SUPPORT | 1 |
| 01110 | 072311 | LEFT/FISH CENTR.BURNER SUPPORT | 1 |
| 01111 | 073430 | COOKER BOTTOM | 1 |
| 01111 | 113994 | BLACK COOKER BOTTOM | 1 |
| 01112 | 072983 | DRAWER CABINET CLOSING | 1 |
| 01113 | 072823 | SIDES SUPPORT | 1 |
| 01115 | 371874 | HOB LEFT LOCK | 1 |
| 01116 | 371875 | HOB RIGHT LOCK | 1 |
| 01118 | 072435 | AIR CONVEYOR | 1 |
| 01119 | 072270 | COVERING FOR LATERAL GLASS WOOL | 4 |
| 01120 | 072337 | GLASS WOOL COVER FOR BIG OVEN | 1 |
| 01121 | 072336 | GLASS WOOL COVER FOR LITTLE OVEN | 1 |
| 01124 | 072169 | TURNSPIT CLAMPING SUPPORT | 1 |
| 01125 | 072335 | REAR WALL FOR MOTORS SUP.-LITTLE O. | 1 |
| 01127 | 072833 | TANGENTIAL AIR DEFLECTOR | 1 |
| 01129 | 112980 | LITTLE OVEN UPPER WALL-BLACK- | 1 |
| 01130 | 113422 | LITTLE OVEN BOTTOM -BLACK- | 1 |
| 01131 | 113757 | LITTLE OVEN DRIP-TRAY | 1 |
| 01133 | 655537 | FRAME+LITTLE DOOR GLASS GROUP | 1 |
| 01134 | 361484 | LITTLE OVEN HANDLE | 1 |
| 01135 | 405737 | LITTLE OVEN GASKET | 1 |
| 01136 | 451407 | LITTLE OVEN WIRE GRID | 1 |
| 01137 | 471129 | WHITE GLASS WOOL (LITTLE OVEN) | 1 |
| 01138 | 471094 | DRAWER WHITE GLASS WOOL (BIG OVEN) | 1 |
| 01139 | 471095 | DRAWER WHITE GLASS WOOL(SMALL OVEN) | 1 |
| 01141 | 451276 | TRIVET FOR SMALL DRIP-TRAY | 1 |
| 01143 | 482750 | LOWER HEATING ELEM.FOR SMALL OVEN | 1 |
| 01144 | 482595 | UPPER/GRILL HEATING ELEMENT | 1 |
| 01145 | 482751 | MICRO SWITCH GROUP FOR IGNITER | 1 |
| 01147 | 494149 | TRIPLE GLASS | 1 |
| 01149 | 494151 | DOUBLE GLASS | 1 |
| 01150 | 494152 | TRIPLE GLASS | 1 |
| 01171 | 431164 | OVEN DOOR HINGE | 2 |
| 01172 | 425047 | TAPS LOCKING BRIDLE | 5 |
| 01196 | 072296 | LEGS SUPPORT | 4 |
| 01209 | 601415 | DRAWER REAR CLOSING | 1 |
| 01226 | 072379 | MANIFOLD REAR LOCK | 1 |
| 01244 | 471130 | GLASS WOOL FOR REAR WALL | 1 |
| 01245 | 471131 | GLASS WOOL FOR REAR WALL | 1 |
| 01265 | 482363 | SUPPORTING PLATE FOR THERMO SWITCH | 4 |
| 01306 | 481408 | OVEN COMMUTATOR 4623866640 | 1 |
| 01362 | 601436 | COUPLE OF SLIDES FOR DRAWER | 1 |
| 01364 | 113822 | UPPER CLOSING FOR LATERAL SUPPORT | 1 |
| 01365 | 113823 | UPPER CLOSING FOR LATERAL SUPPORT | 1 |
| 01366 | 073072 | PLATE FOR DRAWER REAR LOCK | 2 |
| 01367 | 073073 | PLATE FOR DRAWER FRONT LOCK | 2 |