

# Instruction manual for external motor

Model code: DDMEXT5





## Environmental protection



The symbol on the product or on its packaging indicates that this product may not be treated as household waste. Instead it shall be handed over to the applicable collection point for the recycling of electrical and electronic equipment. By ensuring this product is disposed of correctly, you will help prevent potential negative consequences for the environment and human health, which could otherwise be caused by inappropriate waste handling of this product. For more detailed information about recycling of this product, please contact your local city office, your household waste disposal service or the shop where you purchased the product. This appliance is marked according to the European directive 2002/96/EC on waste electrical and electronic equipment (WEEE).

## CE Declarations of Conformity



This appliance has been manufactured to the strictest standards and complies with all applicable legislation, Low Voltage Directive (LVD) and Electromagnetic Compatibility Directive (EMC).

## Warnings

The air outlet of the appliance must not be connected to a flue which is used for exhausting other fumes from appliances, such as a central heating, boilers etc..

For the external exhausting of the fumes, you must comply with the regulations in force.

Ventilate the room suitably according to the laws in force when the appliance is working together with gas, oil or coal burning appliances, at the same time.

The motor of the peripheral exhausting group is powered by the cooker hood located in the kitchen.

Before connecting the cooker hood to the mains supply, make sure that the voltage indicated in the rating plate corresponds to the mains voltage in the home.

Before carrying out any sort of maintenance or cleaning operation, make sure that the appliance is disconnected from the electrical mains.

Correct maintenance ensures good working order and a optimal performance. Our external motors are built in class I, therefore they must be earthed.

## Useful warnings

- For best results use an air outlet ducting pipe with a maximum length not more than 7 meters.
- Limit the number of bends in the exhausting pipe, as every bend reduces the performance up to one linear meter. (If you use 2 x 90° bends, then the length of the pipe should not be more than 5 meters).
- Only use rigid ducting.
- The material for the ducting has to be approved by an authorised company.
- It is important to avoid changes in the diameter (we recommend a diameter of 150mm).
- Read carefully the manual of instructions and installation of the unit.
- Caple will not be responsible for problems of capacity and/or noise level due to the warnings included in this manual not being followed.

The electric box cable should not be cut or joined together with other cables, since it could compromise the correct working and the safety conditions of the appliance. Furthermore, this will invalidate the manufacturer's warranty.

## CAUTION

In order to know the exact power input in (WATT) of the motor being used, the technician should tick the box corresponding to the motor unit used on the label placed next to the rating label, as shown in the figure below.

Motor	
DDMEXT2 - 275W	<input type="checkbox"/> Motor group downdraft
DDMEXT3 - 190W	<input type="checkbox"/> 275W
DDMEXT4 - 280W	<input type="checkbox"/>
DDMEXT2/5 - 500W	<input type="checkbox"/>
DDMEXT5 - 170W	<input type="checkbox"/>
	<input type="checkbox"/>

## Warning

The DDMEXT5 external motor can be connected to any other extractor from the Caple range if they can be used with an external motor version. Please contact Caple to confirm this.

The manufacturer cannot be held responsible for damage caused by a different use. No guarantee or indemnity will be due.

## DDMEXT5 details and installation

The appliance is designed to exhaust fumes and odours very quietly and efficiently. It is designed to be installed on the building roof and connected to the cooker hood, which is in the kitchen (fig. 1) or to the SCET control unit 1.

### Roof installation

Make a square opening in the roof for the square flue section with dimensions 180x180mm. Taking care to alter the roof correctly.

Hold the two brackets as shown in (fig 2) and mark the holes you are going to drill

Insert the stainless steel flue section trying to match the opening made (fig. 3) making sure that the flue comes out of the roof just enough to enable the installation of the DDMEXT5 (fig. 4). Should you need both the flue sections, take into account that they are telescopic and fix them through the 8 screws supplied (fig. 5). Make sure that the stainless steel flue is in a vertical position. Then make the holes matching the holes in the brackets (fig. 6), Fix the pipe to the roof using the 6 screws supplied (fig. 6).

Use a round ducting pipe at least 10cm longer than the stainless steel pipe and fix it to the flange of the DDMEXT5 through a hose clamp (fig. 7).

Insert the DDMEXT5 with the round pipe inside the stainless steel previously fixed to the roof, taking care to ensure the electrical cable passes inside the stainless steel flue (fig. 8). Fix the motor to the pipe through the 8 screws supplied (fig. 9).

Ensure the roof is correctly finished/sealed as required depending on the type to make it water tight. Consult a roofing professional if required.

Connect the round tube to the pipe of the kitchen.

### Electrical connection

Connect the electrical cable of the motor to the extractor installed in the kitchen (fig. 10) or to the SCET – 1 control unit if supplied.

# SCET - 1 control unit

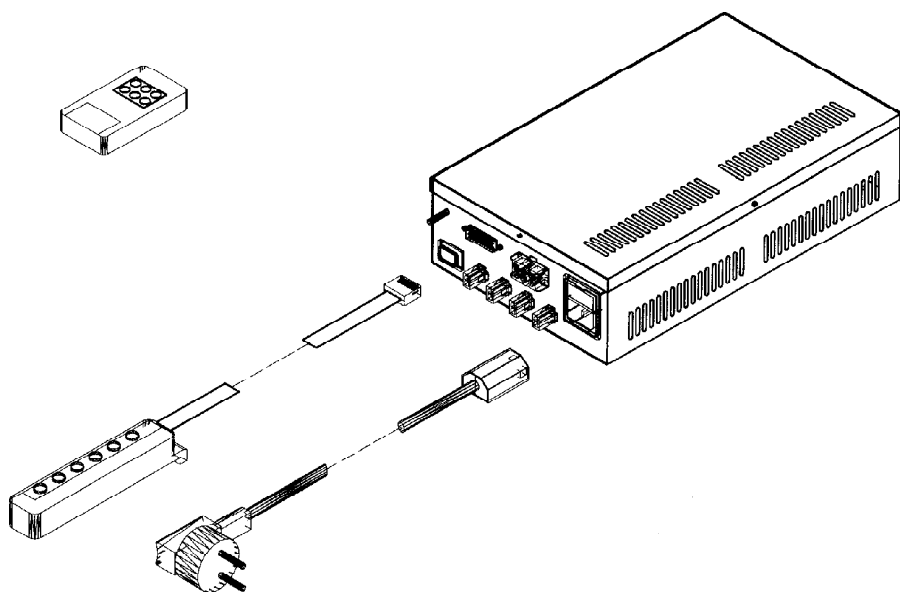
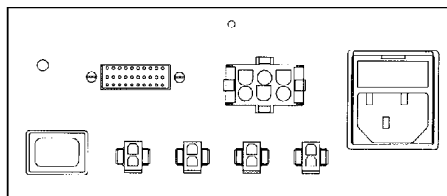

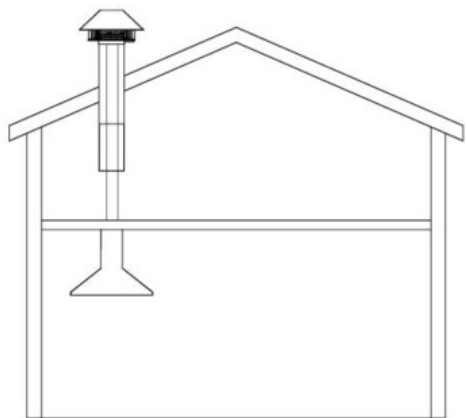

1

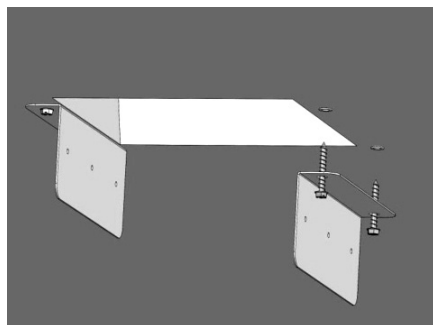

2

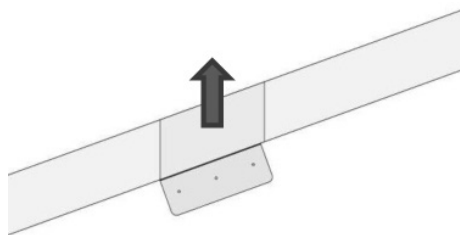

3

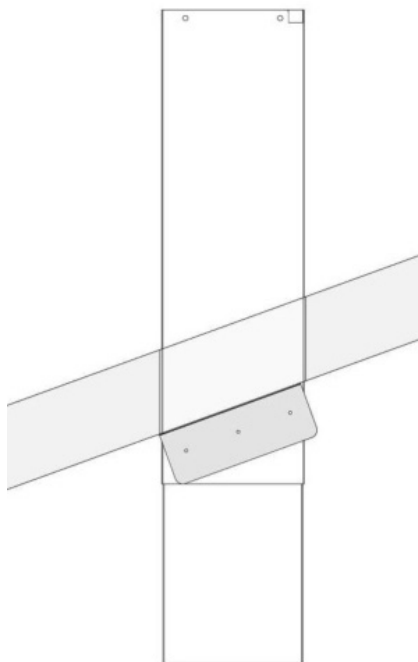

4

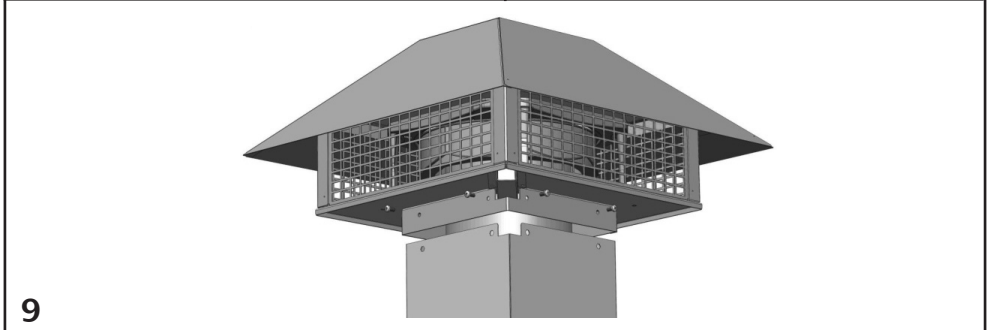
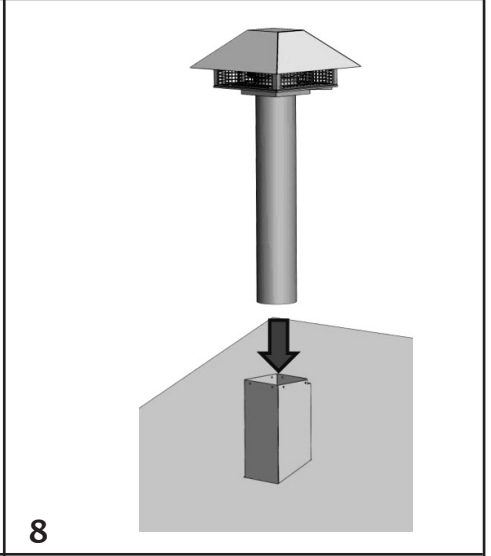
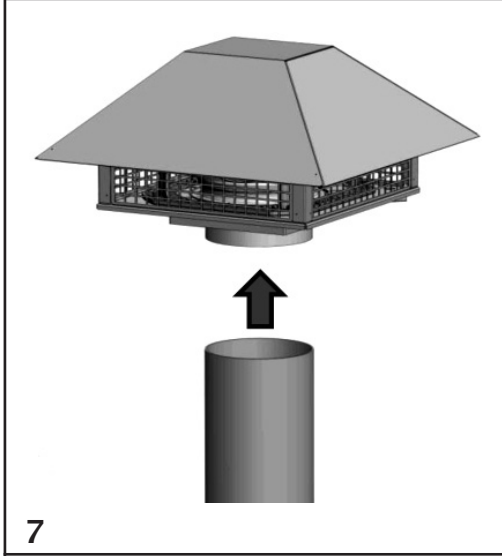
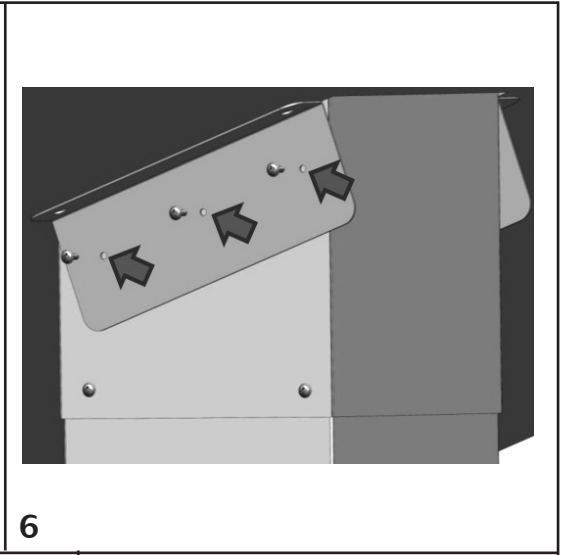
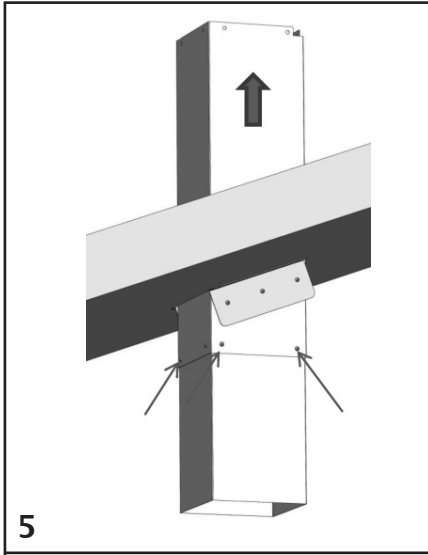

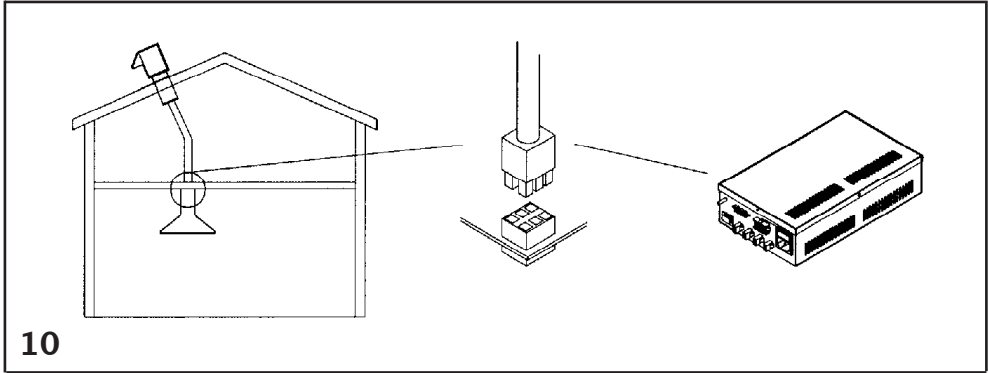

### **Aftersales and customer service**

Caple service can be contacted by telephone on 0844 800 3830 or by email [service@caple.co.uk](mailto:service@caple.co.uk)





Caple  
Fourth Way  
Avonmouth  
Bristol  
BS11 8DW

[www.caple.co.uk](http://www.caple.co.uk)