



# WI6131

Caple wine cabinet



## Technical information

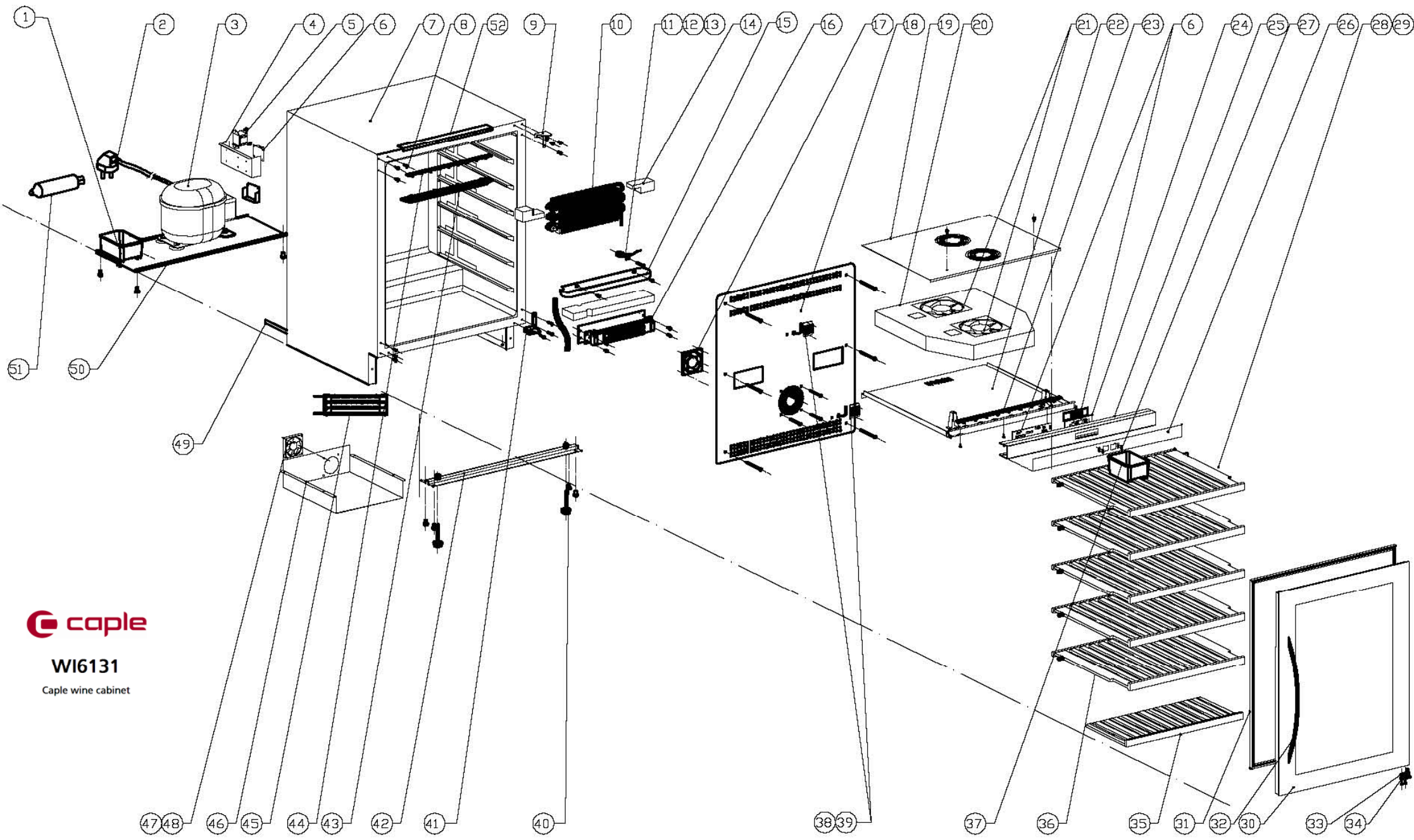

WI6131

Cable wine cabinet



## WI6131 - Caple wine cabinet

Item	Part Code	Description	Qty
1	DG13-1	Water box	1
2	DG2-14	Power cord	1
3	DG1-93	Compressor	1
4	DG13-272-1	PCB board cover	1
5	DG6-16	Transformer	1
6	DG3-100-9	PCB board	1
7	DG26-192	Cabinet	1
8	DG13-268	Decorative nail	6
9	DG14-190-SR	Top hinge module (Right)	1
10a	DG12-50-1	Evaporator (until 18/05/15)	1
10b	DG12-1-2	Evaporator (from 18/05/15)	1
11	DG13-7	Shelf support	1
12	DG20-1	Wire clamp	1
13	DG8-8	Senser	1
14	DG18-93	Foam	2
15	DG13-458	Water tank	1
16	DG11-18	PTC heater	1
17	DG7-41-BH	PTC heater fan	1
18	DG22-422	Air duct board	1
19	DG22-421	Upper panel for middle airway-board	1
20	DG18-76	Foam	1
21	DG7-48	Evaporator fan	2
22	DG22-303	Lower panel for middle airway-board	1
23	DG3-18-W	LED LIGHT	1
24	DG13-32-1		1
25	DG13-33	Display board support	1
26	DG20-386	Display panel	1
27	DG13-130-S		4
28	DG15-211-1		2
29	DG15-23	Wooden shelf trim	5
30	DG23-171	door	1
31	M160-050	Gasket	1
32	DG22-3064		1
33	DG22-3057	door aixs	1
34	DG13-3155		1
35	DG15-33	Wooden shelves NEW G2	1
36	DG15-211		3
37	DG13-1.2	Humid box	1
38	DG13-198	Cover of sensor	2
39	DG8-8	Senser	2
40	DG13-3146	Cabinet leg, type BC50N	4
41	DG14-212-SR	Lower hinge module (Right)	1
42	DG22-330	Support bracket of front legs	1
43	DG13-129	LED Light cover	1



## WI6131 - Caple wine cabinet

Item	Part Code	Description	Qty
44	DG3-14-W	LED LIGHT	1
45	DG12-91	Condenser	1
46	DG19-9	Condenser cover	1
47a	DG7-47	Condenser fan	1
47b	DG17-145-2		1
48	DG19-3	Fan cover	1
49	DG12-6.1	Air-circulating pipe	1
50	DG22-331	Compressor bracket	1
51	DG11-45	Drier	1
52	DG13-3149		1
-	DG14-190-SL	Upper hinge-left	1
--	DG14-212-SL		1
---	DG22-3021		1
----	DG22-3302		1
-----	DG22-3303		2
-----	DG13-3154		2
-----	DG13-3152		1



WI6131

Caple wine cabinet

