



# WF331

## Caple Freestanding Wine Cellar



### Technical information

Model:  
WF331

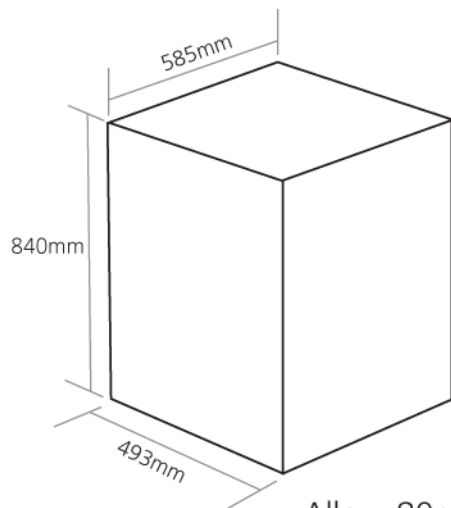

Allow 80mm either side and above for ventilation



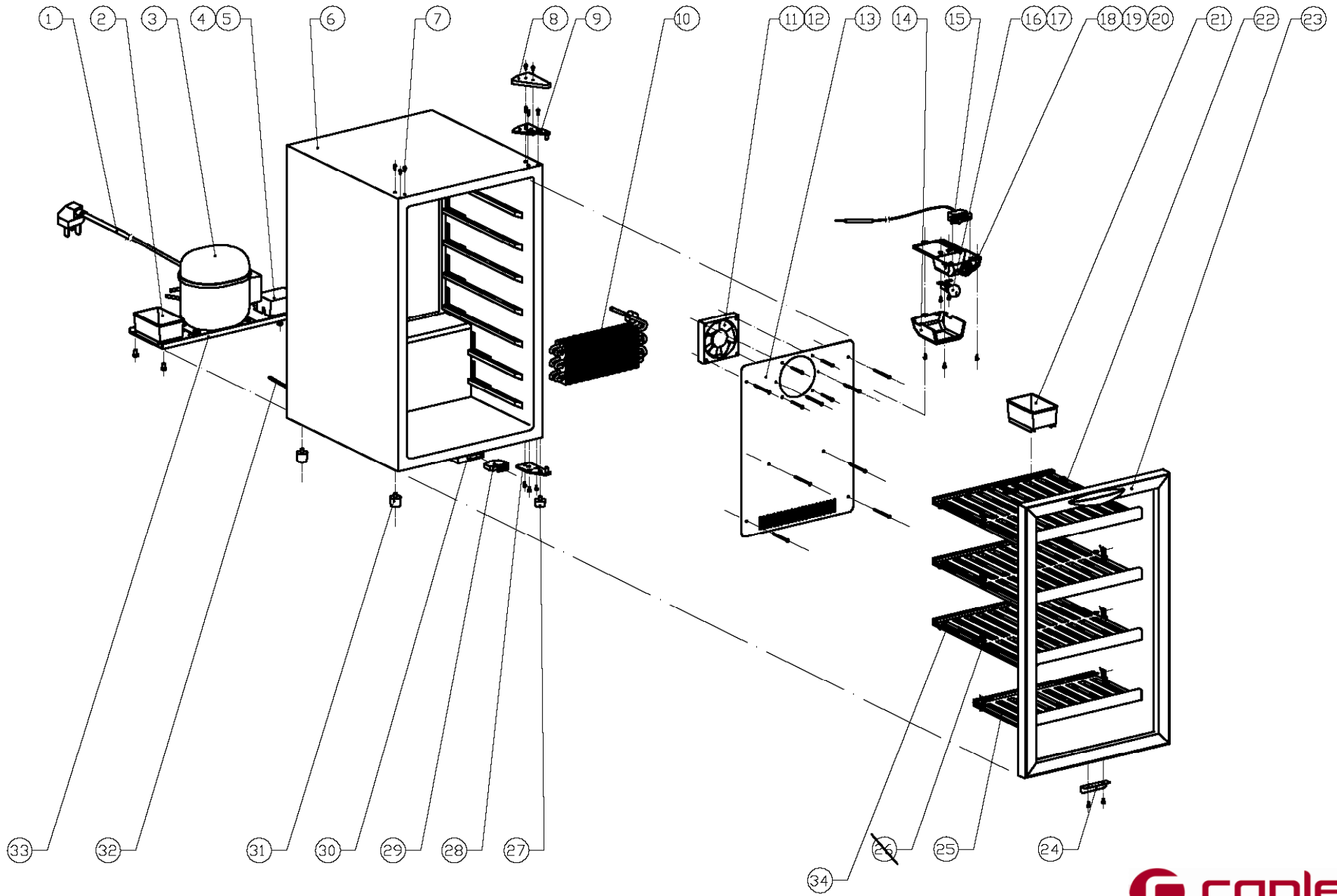

**WF331**

Caple Wine Cellar ( Revision C )



## WF331 - Caple Freestanding Wine Cellar ( Revision B)

Item	Part Code	Description	Qty
1	DG2-3	Power cord	1
2	DG13-1	Water tank	1
3	DG1-13	Compressor	1
4	DG13-2	Electrical box cover	1
5	DG11-2	Junction block	1
6	DG22-17	Cabinet	1
7	DG13-8	Decorative nail	7
8	DG13-12	Decorative cover	1
9	DG14-1.2	Top hinge module	1
10	DG12-1	Evaporator	1
11	DG7-1.6	Evaporator fan	1
12	DG19-1	Fan cover	1
13	DG22-54	Air duct board	1
14	DG13-3.3	Lamp cover	1
15	DG10-3	Temperature controller	1
16	DG5-2	Bulb	1
17	DG4-2	Lamp-holder	1
18	DG13-3.2	Lamp-stand	1
19	DG13-22	Knob	1
20	DG13-23	Dial	1
21	DG13-1.1	Humid box	1
22	DG15-36	B2A wooden shelves	1
23	DG23-6.1	Door	1
24	DG14-3	Extrusion-board of lamp switch	1
25	DG15-37	C2 wooden shelves	1
26	DG13-7.1	Shelf support, shape L	8
27	DG13-6.2	Small cabinet leg, BC50N-12	1
28	DG14-2.2	Lower hinge module	1
29	DG9-1	Door switch	1
30	DG14-26	Switch box of door lamp	1
31	DG13-6.1	Cabinet leg, BC50	3
32	DG12-6.1	Air-circulating pipe	1
33	DG22-89	Compressor bracket	1
34	DG15-35	B2 wooden shelves	2



## WF331 - Caple Freestanding Wine Cellar ( Revision C)

Item	Part Code	Description	Qty
1	DG2-3	Power cord	1
2	DG13-1	Water tank	1
3	DG1-37	Compressor	1
4	DG13-2	Electrical box cover	1
5	DG11-2	Junction block	1
6	DG22-17	Cabinet	1
7	DG13-8	Decorative nail	7
8	DG13-12	Decorative cover	1
9	DG14-1.2	Top hinge module	1
10	DG12-1	Evaporator	1
11	DG7-1.6-H	Evaporator fan	1
12	DG19-1	Fan cover	1
13	DG22-54	Air duct board	1
14	DG13-3.3	Lamp cover	1
15	DG10-1	Temperature controller	1
16	DG5-2	Bulb	1
17	DG4-2	Lamp-holder	1
18	DG13-3.2	Lamp-stand	1
19	DG13-22	Knob	1
20	DG13-23	Dial	1
21	DG13-1.1	Humid box	1
22	DG15-36	B2A wooden shelves	1
23	DG23-6.1	Door	1
24	DG14-3	Extrusion-board of lamp switch	1
25	DG15-37	C2 wooden shelves	1
26	DG13-7.1	Shelf support, shape L	8
27	DG13-6.2	Small cabinet leg, BC50N-12	1
28	DG14-2.2-R	Lower hinge module	1
29	DG9-9	Door switch	1
30	DG14-26.1	Switch box of door lamp	1
31	DG13-6.1	Cabinet leg, BC50	3
32	DG12-6.1	Air-circulating pipe	1
33	DG22-89	Compressor bracket	1
34	DG15-35	B2 wooden shelves	2