

# Integrated Washer Dryer instruction manual

## WDI3300



# CONTENTS

<b>WARNINGS</b>	<b>3</b>
<b>INSTALLATION WARNINGS</b>	<b>6</b>
<b>RISK OF DAMAGING APPLIANCE</b>	<b>7</b>
<b>SAFETY INSTRUCTIONS</b>	<b>8</b>
<b>ENVIRONMENTAL PROTECTION</b>	<b>10</b>
<b>INSTALLATION</b>	<b>11</b>
<b>UNPACKING THE WASHING MACHINE</b>	<b>11</b>
<b>REMOVE TRANSPORT BOLTS</b>	<b>12</b>
<b>ADJUST LEGS</b>	<b>13</b>
<b>CONNECT INLET PIPE</b>	<b>13</b>
<b>INSTALL INLET PIPE</b>	<b>13</b>
<b>HOLE PLUG</b>	<b>14</b>
<b>PLACE OUTLET HOSE</b>	<b>14</b>
<b>ELECTRICAL CONNECTION</b>	<b>16</b>
<b>OPERATION</b>	<b>17</b>
<b>QUICK START</b>	<b>18</b>
<b>DETERGENT DISPENSER</b>	<b>19</b>
<b>CONTROL PANEL</b>	<b>20</b>
<b>OPTION</b>	<b>21</b>
<b>OTHER FUNCTIONS</b>	<b>22</b>
<b>PROGRAMMES</b>	<b>25</b>
<b>WASHING PROGRAMMES TABLE</b>	<b>26</b>
<b>CLEANING AND CARE</b>	<b>27</b>
<b>TROUBLESHOOTING</b>	<b>30</b>
<b>TECHNICAL SPECIFICATIONS</b>	<b>31</b>
<b>PRODUCT FICHE</b>	<b>32</b>
<b>BUILT-IN INSTALLATION</b>	<b>32</b>

Please keep this instruction manual for future reference

## WARNINGS

- Keep these instructions for use with the appliance. If the appliance should be sold or passed on to others, make sure that the instructions are passed on with it. We thank you for taking note of these suggestions before installing and using the appliance. They have been written for your personal safety and the safety of others.
- This appliance is not intended for use by persons (including children) with reduced physical, sensory or mental capabilities, or lack of experience and knowledge, unless they have been given supervision or instruction concerning use of the appliance by a person responsible for their safety.
- This washer dryer is intended for **NORMAL DOMESTIC USE ONLY**

## SAFETY INSTRUCTIONS

- If the supply cord is damaged, it must be replaced by the manufacturer, its service agent or similarly qualified persons in order to avoid a hazard.
- The new hose-sets supplied with the appliance are to be used and old hose-sets must not be reused.
- Before any maintenance is performed, unplug the appliance from the mains.

- Always unplug the machine and turn off the water supply after use.
- To ensure your safety, the power plug must be inserted into an earthed three-pole socket. Check carefully and make sure that your socket is properly and reliably earthed.
- The water and electrical devices must be connected by a qualified technician in accordance with the manufacturer's instructions and local safety regulations. Pull out its plug from the power socket before cleaning or maintenance.
- Do not use any socket with rated current less than that of appliance. Never pull out the power plug with wet hands.
- The appliance can be used by children aged from 8 years and above and persons with reduced physical, sensory or mental capabilities or lack of experience and knowledge if they have been given supervision or instruction concerning use of the appliance in a safe way and understand the hazards involved. Children shall not play with the appliance. Cleaning and user maintenance shall not be made by children without supervision.
- Children of less than 3 years should be supervised to ensure that they do not play with appliance.

- Animals and children may climb into the machine. Check the machine before every operation.
- The door may become very hot during operation. Keep children and pets far away from the machine during operation.
- Remove all packaging and transport bolts before using the appliance. Otherwise, serious damage may result.
- Do not wash or dry articles that have been cleaned in, washed in, soaked in, or dabbed with combustible or explosive substances (such as wax, oil, paint, gasoline, degreasers, drycleaning solvents, kerosene, etc.) This may result in fire or explosion.
- The washer dryer is not to be used if industrial chemicals have been used for cleaning.
- The exhaust air must not be discharged into a flue which is for exhausting fumes from appliances burning gas or other fuels.
- Beforehand, thoroughly rinse heavily soiled items of washing by hand.

## **INSTALLATION WARNINGS**

- This appliance is for indoor use only.
- The openings must not be obstructed by a carpet.
- The appliance shall not be installed in bathrooms or wet rooms as well as in rooms with explosive or caustic gases.
  
- This product is not designed for commercial use, it is a household appliance only. It is not intended to be used in:
  - Staff kitchen areas in shops, offices and other working environments.
  - Bed and breakfast type environments.
  - By clients in hotels, motels and other residential type environments.

## **INSTALLATION WARNINGS**

- The plug must be accessible after installation.
- The appliance must not be installed behind a lockable door, a sliding door or a door with a hinge on the opposite side to that of the washer dryer.
- The appliance shall not be installed in a humid place.

## **RISK OF DAMAGING APPLIANCE!**

- The product is only for home use and is only designed for the textiles suitable for machine washing and drying.
- Do not climb up and sit on top cover of the machine.
- Do not lean against machine door.
- Cautions during Handling Machine:
  1. Transport bolts shall be reinstalled to the machine by a specialized person.
  2. The accumulated water shall be drained out of the machine.
  3. Handle the machine carefully. Never hold each protruded part on the machine while lifting. Machine door can not be used as the handle during the conveyance.
  4. This appliance is heavy. Transport with care.
  5. That the hands shall not be inserted into running water extracting tub.
- Please do not close the door with excessive forces. If it is found difficult to close the door, please check if the clothes are put in or distributed well.
- It is forbidden to wash carpets.

## SAFETY INSTRUCTIONS

- Items such as foam rubber (latex foam), shower caps, water proof textiles, rubber backed articles and clothes or pillows fitted with foam rubber pads should not be dried in the machine.
- Fabric softeners, or similar products, should be used as specified by the fabric softener instructions.
- The final part of a washer dryer cycle occurs without heat (cool down cycle) to ensure that the items are left at a temperature that ensures that the items will not be damaged.
- **WARNING:** Never stop a washer dryer before the end of the drying cycle unless all items are quickly removed and spread out so that the heat is dissipated.

## **OPERATING THE APPLIANCE!**

- Before using the machine for the first time, the product shall be operated in one round of all the programmes without the clothes inside.
- Flammable and explosive or toxic solvents are forbidden. Gasoline and alcohol etc. shall not be used as detergents. Please only select the detergents suitable for machine washing.
- Make sure that all pockets are emptied. Sharp and rigid items such as coins, nails, screws or stones etc. may cause serious damages to this machine.
- Please check whether the water inside the drum has been drained before opening its door. Please do not open the door if there is any water visible.
- Be careful of burning when the product drains hot washing water.
- After the program is completed, Please wait for two minutes to open the door.
- Never refill the water by hand during washing.
- If it is unavoidable that fabrics that contain vegetable or cooking oil or have been contaminated by hair care products. If placed in a tumble dryer they should first be washed in hot water with extra detergent, this will reduce, but not eliminate the hazard.
- Adequate ventilation has to be provided to avoid the back flow of gases into the room from appliances burning other fuels, including open fires.
- Do not dry unwashed items in the appliance.
- Items that have been soiled with substances such as cooking oil, acetone, alcohol, petrol, kerosene, spot removers, turpentine, waxes and wax removers should be washed in hot water with an extra amount of detergent before being dried in the appliance.

Please keep this instruction manual for future reference



## ENVIRONMENTAL PROTECTION

Waste electrical products should not be disposed of with household waste. Please recycle where facilities exist. Check with your Local Authority or retailer for recycling advice. This appliance is marked according to the European directive 2012/19/EU on Waste Electrical and Electronic Equipment (WEEE).

By ensuring this product is disposed of correctly, you will help prevent potential negative consequences for the environment and human health, which could otherwise be caused by inappropriate waste handling of this product. The symbol on the product indicates that this product may not be treated as household waste. Instead it shall be handed over to the applicable collection point for the recycling of electrical and electronic equipment. Disposal must be carried out in accordance with local environmental regulations for waste disposal.

For more detailed information about treatment, recovery and recycling of this product, please contact your local council, your household waste disposal service or the retailer where you purchased the product

## CE DECLARATIONS OF CONFORMITY

This appliance has been manufactured to the strictest standards and complies with all applicable legislation, Low Voltage Directive (LVD) and Electromagnetic Compatibility (EMC)

# INSTALLATION

## Overview of washer dryer

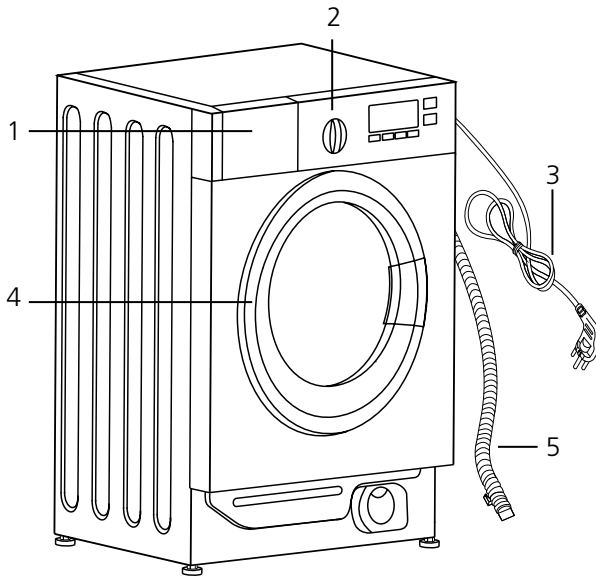

1. Detergent Drawer
2. Control Panel
3. Power Plug
4. Door
5. Drain hose

### Accessories

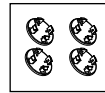

Transport hole plug

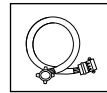

Supply hose cold water

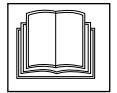

Instruction manual

## UNPACKING THE WASHER DRYER

Unpack your washer dryer and check if there is any damage during the transportation. Also make sure that all the items are received. If there is any damage to the washer dryer during the transportation, or any items are missing, please contact your retailer immediately.

## DISPOSE OF THE PACKING MATERIALS

The packing materials of this machine may be dangerous to children. Please dispose of them properly. Please dispose the related packing materials according to the relevant local regulations. Please do not throw the packing materials away together with the other daily living disposals.

Please keep this instruction manual for future reference

## REMOVE TRANSPORT BOLTS

Before using this washer dryer, transport bolts must be removed from the backside of this machine. Please take the following steps to remove the bolts:

1. Loosen all bolts with spanner and then remove them.
2. Fill the holes with transport hole plugs.
3. Keep the transport bolts stored away safely for future use.

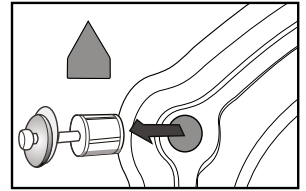

## SELECT THE LOCATION

Before installing the washer dryer, the location characterised as follows shall be selected:

- Rigid, dry, and level surface (if not level, please make it level with reference to the following figure "Adjust Legs")
- Avoid direct sunlight
- Sufficient ventilation
- Room temperature is above 0°C
- Keep far away from heat resources.
- Make sure that the washer dryer does not stand on the power cord.

## ADJUST LEGS

1. When positioning the washer dryer, please first check if the legs are closely attached to the washer dryer. If not, please turn them to their original positions with hand or spanner and tighten the nuts with spanner.
2. After positioning the washer dryer, press four corners on top cover of washer dryer in sequence. If the washer dryer is not stable when being pressed, this leg shall be adjusted.
3. Ensure the positioning status of washer dryer. Loosen the lock nut with spanner and turn the leg with hand until it closely contacts with the floor. Press the leg with one hand and fasten the nut closely to the washer dryer with the other hand.
4. After being locked properly, press four corners again to make sure that they have been adjusted suitably. If it is still unstable, repeat Steps 2 and 3 until stable.
5. Put a solid cylinder horizontally on the top cover of the washer dryer from the left, right, front and back directions. If the cylinder keeps stable, the appliance is positioned level. If it rolls, the appliance is not level. The rolling direction is the direction of lower ground surface. Then, the two legs in this direction shall be raised at the same time until the washer dryer is level. Steps 1~3 are repeated to make the bottom legs closely against the ground and the nuts shall be locked tightly.

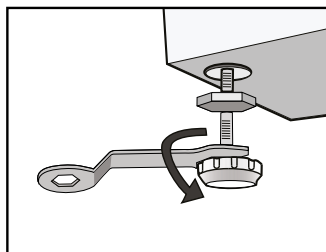

## CONNECT INLET PIPE

Connect the inlet pipe as indicated in the figure.

## INSTALL INLET PIPE

1. Connect the elbow to tap and fasten it clockwise.
2. Connect the other end of inlet pipe to the inlet valve at the backside of washer dryer and fasten the pipe tightly clockwise.

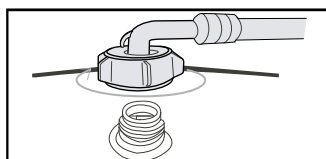
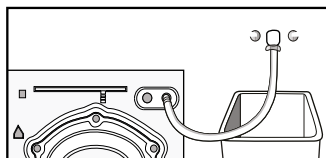

Please keep this instruction manual for future reference

## NOTES:

After connection, if there is any leakage with hose, then repeat the steps to connect inlet pipe. The most common type of tap shall be used to supply water. If tap is square or too big, then standard tap shall be changed.

## HOLE PLUG

This Hole plug is used to block the hole on the back of the washing machine.

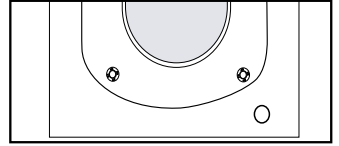

## PLACE OUTLET HOSE

There are two ways to place the end of outlet hose:

1. Put it inside the sink bowl as shown.
2. Connect it to the drain outlet on the sinks waste pipe.

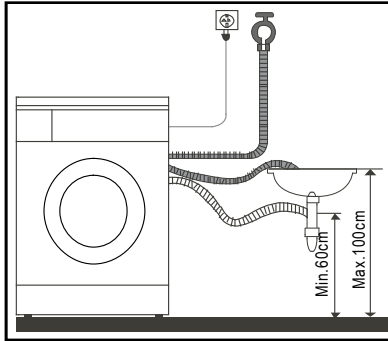
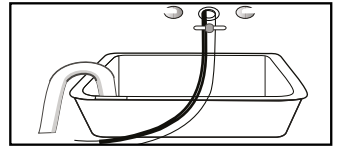

It can drain the water up and down, outlet hose shall not be installed at a height beyond 100cm and its end shall not be immersed in water.

Position outlet hose properly so that the floor will not be damaged by water leakage.

**NOTES:**

If the machine has outlet hose support, please install it like the following pictures.

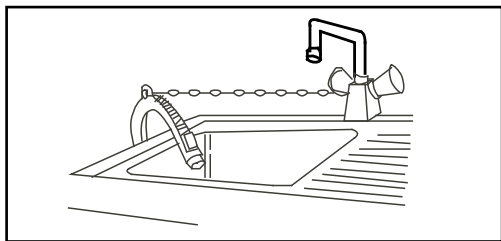

When installing outlet hose, fix it properly with a rope. Position outlet hose properly so that the floor will not be damaged by water leakage.

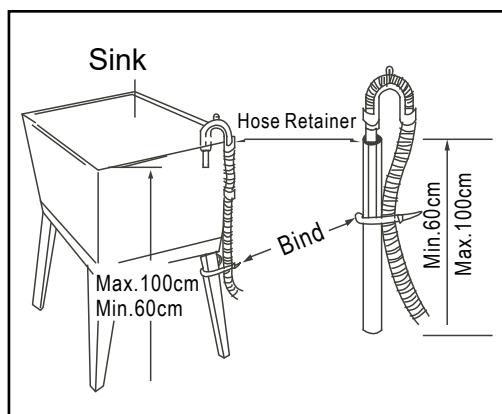

If the outlet hose is too long, do not force it into the washer dryer as it will cause abnormal noises.

## ELECTRICAL CONNECTION

- As the maximum current through the unit is 10A when you are using its heating function, please make sure the power supply system (current, power voltage and wire) at your home can meet the normal loading requirements of the electrical appliances.
- Please connect the power to a socket which is correctly installed and properly earthed.
- Make sure the power voltage at your place is same to that in the machine's rating label.
- Power plug must match the socket and cabinet must be properly and effectively earthed.
- Do not use multi-purpose plug or socket as extension cord.
- Do not connect and pull out plug with wet hand. When connecting and pulling out the plug, hold the plug tightly and then pull it out. Do not pull power cord forcibly.
- If power cord is damaged or has any sign of being broken, special power cord must be selected or purchased from its manufacturer or service center for replacement.

## WARNING

This machine must be earthed properly. If there is any short circuit, earthing can reduce the danger of electrical shock.

This machine is equipped with power cord, which includes plug, earthing wire at earthing terminal.

The washer dryer shall be operated in a circuit separate from other electrical appliances. Otherwise, power protector may be tripped or fuse may be burned out.

## OPERATION

### EMPTY ALL POCKETS

Foreign objects (e.g. nails, coins, paper, clips etc) can cause damage to garments and to the components in the machine.

Check the laundry before washing and remove foreign objects.

### SORT THE LAUNDRY

Sort the laundry by colour and care label. Most garments have a textile care label in the collar or side seam.

#### Tip:

Dark textiles often contain excess dye and should be washed separately several times before being included in a mixed load. Always wash whites and coloured separately.

### PRE-TREAT STAINS

Badly soiled areas, stains etc. should be cleaned as soon as possible, preferably whilst still fresh. Spillages should be carefully dabbed off using a soft, colour fast cloth. Do not rub.

#### Tip:

Badly soiled areas can be pretreated with a liquid detergent, stain removers etc. first, following the manufacturer's instructions. With particularly stubborn stains ask your dry cleaner for advice.

Solvent-based cleaners (e.g. benzine) can damage plastic parts. When pre-treating garments, make sure that any plastic parts (e.g. buttons) are protected from cleaning agent.

Chemical (solvent-based) cleaning agents can cause severe damage to the washer dryer. Do not use solvent-based cleaning agents in the machine.

## QUICK START

1. Install the washer dryer
2. Open the door and Load the laundry
3. Measure out the detergent
4. Close the door
5. Put down (hang up) the drain pipe (if not connected to sink plumbing)
6. Turn on the water tap (if not connected to mains water supply)
7. Plug the power supply
8. Press the On/Off
9. Select the desired programme
10. Press the [start/pause]

### AFTER WASHING NOTES:

- After washing, the washer dryer will make a sound to signify the end of a cycle.
- Close the water tap.
- Press the On/Off and pull out the power plug.

## DETERGENT DISPENSER

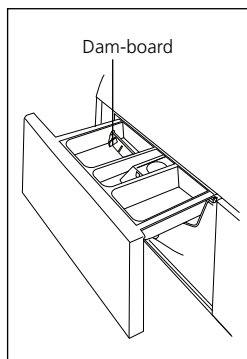

Liquid detergent

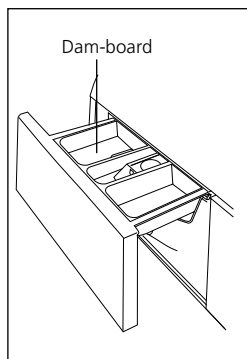

Powder detergent

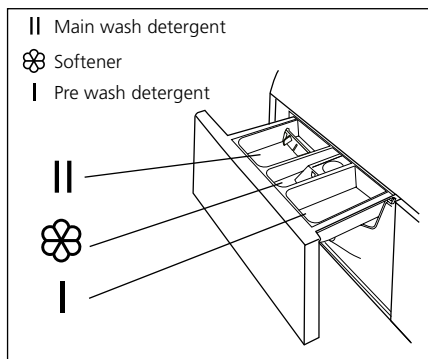

Pull out the dispenser

### CAUTION!

Detergent only needs to be added in "case I" after selecting pre-washing for machines with this function.

Programme	I	II	☼
Cotton		●	○
Cotton Eco		●	○
1 Hour W/D		●	○
Jeans		●	○
Colours		●	○
Mix		●	○
Wool		●	○
Rinse&Spin			○

Programme	I	II	☼
Dry Only			
Spin Only			
Delicate		●	○
Quick		●	○
Sports Wear		●	○
Baby Care		●	○
Synthetic		●	○

● Required    ○ Optional

Please keep this instruction manual for future reference

## CONTROL PANEL

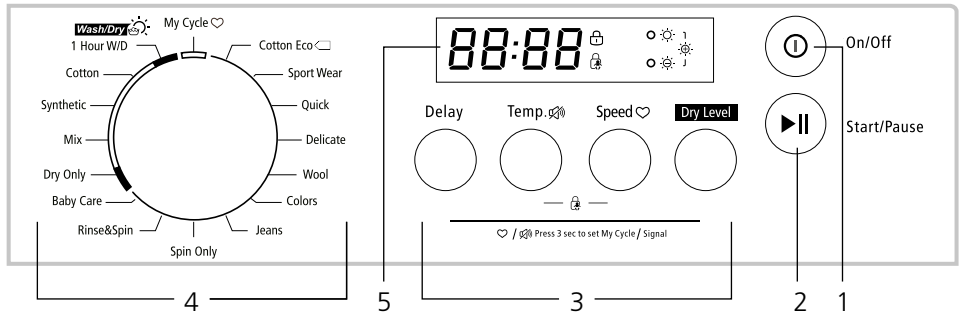

### 1. On/Off

Product is switched on or off.

### 2. Start/Pause

Press the button to start or pause the washing cycle.

### 3. Option

This allows you to select an additional function and will light when selected.

### 4. Programmes

Available programmes to select.

### 5. Display

The display shows the settings, estimated time remaining, options, and status messages for your washer dryer. The display will remain on through the cycle.

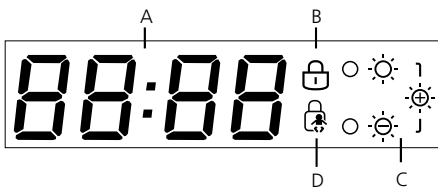

A Wash Time 1:25 Delay Time 2h Speed Error End 1200 E20 End

B Door Lock

C Dry level (Gentle -Normal-Extra )

D Child Lock

## OPTION



### Delay

Set the Delay function:

1. Select a programme
2. Press the Delay button to choose the time (the delaying time is 0-24 H.)
3. Press [Start/Pause] to commence the delay operation.



On/Off



Choose the Programme



Setting time



Start

Cancel the Delay function:

Press the [Delay] button until the display be 0H. It should be pressed before starting the programme. If the programme already started, should press the [On/Off] button to reset the programme.

### CAUTION!

If there is any break in the power supply while the machine is operating, a special memory stores the selected programme and when the power is restarted, press the [On/Off] button the program will continue.

## OTHER FUNCTIONS



### My Cycle

This lets you save your favourite and most frequently used programme. Press [ ♥ ] for 3seconds to memorize and save the running programme. The default is cotton.



### Child Lock

To lock the controls and avoid interruption by children.

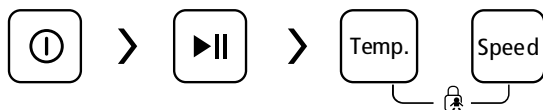

On/Off

Start/Pause

Press and hold [Temp.] and [Speed]  
for 3 secs. until buzzer sounds.

## NOTE

- Press the [Temp.] and [Speed] buttons for 3secs again to unlock the child lock.
- The "Child Lock" will lock all buttons except [On/Off].
- The child lock will remain effective when the power is resumed.



### Speed

Press this button to change the spin speed.

Programme	Default Speed(rpm)
	1400
Cotton Eco	800
Sport Wear	800
Quick	800
Delicate	600
Wool	400
Colors	800
Jeans	800
Spin Only	800

Programme	Default Speed(rpm)
	1400
Rinse & Spin	800
Dry Only	1400
Mix	1000
Baby Care	1000
Synthetic	1200
Cotton	1400
1 Hour W/D	1400

## CAUTION!

When the speed lights are off means the spin speed is 0.



### Temp.

Press this button to regulate the temperature  
Cold, 20°C, 30°C, 40°C, 60°C, 90°C



### Mute



On/Off



Start/Pause



Press the [Temp.]button for 3sec.  
The buzzer will be turned off.



To turn the buzzer back on, press the [Temp.] button again for 3 seconds.

## CAUTION!

After Muting the buzzer function, the sounds will not be activated any more.



## Dry Level

Press the Dry Level button continuously to choose the dry level:  
Extra Dry / Normal Dry/ Gentle Dry.

 Extra Dry

 Normal Dry

 Gentle Dry

## NOTE

### DRYING HINTS

- Clothes can be dried after spinning
- To ensure a quality dry, ensure the loads are sorted by type of material, and use the correct drying temperature.
- If you want to iron the clothes after drying, use a longer dry cycle.

### CLOTHES NOT SUITABLE FOR DRYING

- Particularly delicate items such as synthetic curtains,woolen and silk, clothes with metal inserts, nylon stockings, bulky clothes such as coats, bed covers, sleeping bags and duvets must not be dried.
- Clothes padded with foam-rubber or materials similar to foam-rubber must not be machine dried.
- Fabrics containing residues of setting lotions or hair sprays, nail solvents or similar solutions must not be machine dried in order to avoid the formation of harmful vapours.

## PROGRAMMES

Cotton	Used to wash every day clothes.
Cotton Eco	For lightly soiled every day clothes. A shorter & more energy saving wash
Synthetic	You can select this programme to wash the delicate clothes. The programme is shorter compared with that for cottons and the washing intensity is gentler. It is recommended to wash synthetic articles, for example: shirts, coats, blending. As for curtains and laced textiles, the procedure "Synthetic " shall be selected. While washing the knitting textiles, detergent quantity shall be reduced due to its loose string construction and the easy formation of bubbles.
Baby Care	You can select this programme to wash your baby's clothes, it can make the clothes cleaner and make the rinse performance better to protect the baby's skin.
Jeans	Select this programme to specifically wash jeans.
Mix	Mixed load consisting of textiles made of cotton and synthetics.
Colours	Washing brightly coloured clothes, it can protect the colours better.
Sport Wear	You can select this programme to wash sportswear.
Quick	This programme is suitable for washing few and very lightly soiled clothes in 15 minutes.
Delicate	You can select this programme to wash your delicate clothes. Its washing intensity is gentler and revolution speed is less compared with other programmes. It is recommended for the articles that need to be washed softly.
Wool	Machine-washable wool. Especially gentle wash programme to prevent shrinkage and has longer programme pauses.
Spin Only	Extra spin with selectable spin speed.
Rinse & Spin	Extra rinse with spin.
Dry Only	Select to dry clothes. The drying temperature can be set, however the drying time sets according to the load.
1Hour W/D	For small synthetic clothes or shirts, load limitation is 1 kg (about 4 shirts). Suitable programme for when you are trying to clean and prepare clothes quickly. Time duration is only 1 hour including wash and dry. Remark: Big towels or jeans is not suitable for this program, they will enlarge the time duration and affect the moisture content.

Please keep this instruction manual for future reference

## WASHING PROGRAMMES TABLE

Programme	Washing / Drying Load (kg)	Temp.(°C)	Default Time (H)
	8.0	Default	8.0
			1400
Cotton ECO	8.0	30	1:07
Sport Wear	4.0	40	1:19
Quick	2.0	Cold	0:15
Delicate	2.5	30	1:00
Wool	2.0	40	1:07
Colors	8.0	Cold	1:00
Jeans	8.0	40	1:48
Spin Only	8.0	-	0:12
Rinse&Spin	8.0	-	0:31
Baby Care	4.0	60	1:45
☼ Dry Only	- / 6.0	-	4:28
☼ Mix	8.0 / 6.0	40	1:13
☼ Synthetic	8.0 / 4.0	40	2:20
☼ Cotton	8.0 / 6.0	40	2:40
☼ 1 Hour W/D	1.0 / 1.0	Cold	1:00

The programmes with a ☼ symbol include a dry function.

The energy class is A Energy test program: Cotton Eco 60°C

Speed: the highest speed; Other as the default.

Half load for 8.0Kg machine:4.0Kg.

“Cotton Eco 60°C” is the standard washing program and “Dry only” is the standard drying programs to which the information in the Energy label and the fiche relates, and they are suitable to clean normally soiled cotton laundry and that they are the most efficient programmes in terms of combined energy and water consumptions for washing that type of cotton laundry. The actual water temperature may differ from the declared cycle temperature.

Please keep this instruction manual for future reference

## **CLEANING AND CARE**

### **WARNING!**

Before starting any maintenance, please unplug the machine and close the tap.

### **CLEANING THE CABINET**

Proper maintenance on the washing machine can extend its working life. The surface can be cleaned with diluted non-abrasive neutral detergents when necessary. If there is any water overflow, use the wet cloth to wipe it off immediately. No sharp items are allowed.

### **NOTE**

Formic acid and its diluted solvents or equivalent are forbidden, such as alcohol, solvents or chemical products, etc.

### **CLEANING THE DRUM**

The rusts left inside the drum by the metal articles shall be removed immediately with chlorine-free detergents. Never use steel wool.

### **NOTE**

Don't put laundry in the washing machine during the drum cleaning

### **CLEANING THE DOOR SEAL AND GLASS**

Wipe the glass and seal after each wash to remove lint and stains. If lint builds up it can cause leaks. Remove any coins, buttons and other objects from the seal after each wash.

## CLEANING THE INLET FILTER

### NOTE

Inlet filter must be cleaned if there is less water.

Washing the filter in the tap

1. Close the tap.
2. Remove the water supply hose from the tap.
3. Clean the filter.
4. Reconnect the water supply hose.

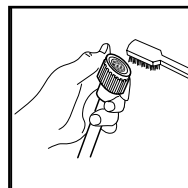
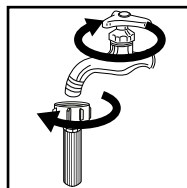

Washing the filter in washer dryer:

1. Screw off the inlet pipe from the backside of the machine.
2. Pull out the filter with long nose pliers and reinstall it back after being washed.
3. Use the brush to clean the filter.
4. Reconnect the inlet pipe.

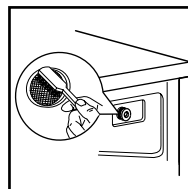
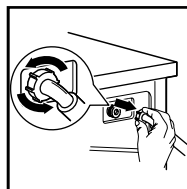

## CLEAN DETERGENT DISPENSER

1. Press down the arrow location on softener cover inside the dispenser drawer.
2. Lift the clip up and take out softener cover and wash all grooves with water.
3. Restore the softener cover and push the drawer into position.

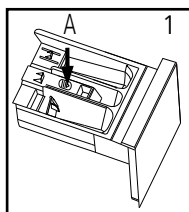

Pull out the dispenser drawer with press the A

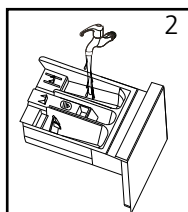

Clean the dispenser drawer under water

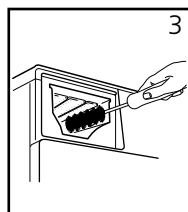

Clean inside the recess with an old toothbrush

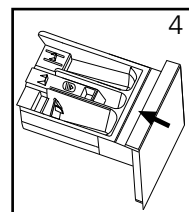

Insert the dispenser drawer

### NOTE

Do not use alcohol, solvents or chemical products to clean the machine.

Please keep this instruction manual for future reference

# CLEANING DRAIN PUMP FILTER

## WARNING

- Be careful of the hot water!
- Allow detergent solution to cool down.
- Unplug the machine to avoid electrical shock before washing.
- Drain pump filter can filter the yarns and small foreign matters from the washing.
- Clean the filter periodically to ensure the normal operation of washing machine.

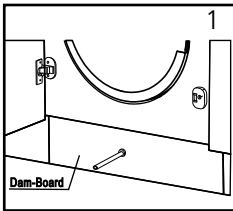

After the power is disconnected, pull out the Dam-Board.

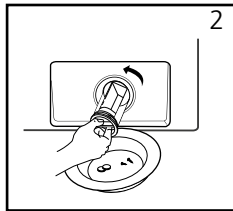

Turn the filter down as shown with the figure and take out sundries matters.

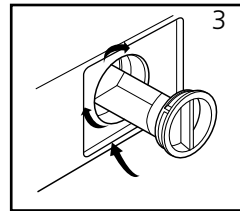

Reinstall each part back after sundries matters are removed.

## CAUTION

- Make sure that valve cap and emergency drain hose are reinstalled properly, cap plates should be inserted aligning to hole plates otherwise water may leak;
- When the appliance is in use and depending on the programme selected there can be hot water in the pump. Never remove the pump cover during a wash cycle, always wait until the appliance has finished the cycle, and is empty. When replacing the cover, ensure it is securely re-tightened.

## TROUBLESHOOTING

If the appliance does not work or it stops during operation, first try to find a solution to the problem, If not, contact Caple service.

Problem	Possible cause	Solution
Washer dryer cannot start up	Door is not closed properly	Restart after the door is closed Check if the clothes is stuck
Door can't be opened	Washer's safety protection design is working	Disconnect the power, restart the product
Water leakage	The connection between inlet pipe or outlet hose is not tight	Check and fasten water pipes Clean up outlet hose
Detergent residues in the box	Detergent is dampened or agglomerated	Clean and wipe the detergent box
Indicator or display does not light	Disconnect the power PC board or harness has connection problem	Check if the power is shut down and the power plug is connected correctly
Abnormal noise		Check if the fixing (bolts) have been removed. Check it's installed on a solid and level floor
E30	Door is not closed properly	Restart after the door is closed Check if the clothes is stuck
E10	Water injecting problem while washing	Check if the water pressure is too low Straighten the water pipe. Check if the inlet valve filter is blocked
E21	Overtime water draining	Check if the drain hose is blocked
E12	Water overflow	Restart the washer
EXX	Others	Please try again first, call up service line if there are still troubles

### NOTE

After the checks have been made, activate the appliance. If the problem still occurs or the display shows other alarm codes again, contact Caple service

E - [service@caple.co.uk](mailto:service@caple.co.uk)

T - 0117 938 7420

## TECHNICAL SPECIFICATIONS

Model	WDI3300
Power Supply	220-240V~,50Hz
Washing Capacity	8.0kg
Drying Capacity	6.0kg
Weight	64kg
Rated Power	1900W
Drying Power	1300W
Standard Water Pressure	0.05MPa~1MPa
MAX.Current	10A

Please keep this instruction manual for future reference

## PRODUCT FICHE

Model	WDI3300
Washing Capacity	8kg
Drying Capacity	6kg
Spin Speed	1400 rpm
Energy efficiency class	A
Energy consumption of per cycle (to wash and dry a full capacity wash load at 60°C)	5.44kwh/Cycle
Water consumption of per cycle (Total)	152L/cycle
Annual energy consumption (Using the dryer)	1088kWh /annual
Annual water consumption (Using the dryer)	30400L /annual
Annual energy consumption (Never Using the dryer)	192kWh /annua
Annual water consumption (Never Using the dryer)	12800L /annual
Washing performance class	A
Spin-drying efficiency class	A
Standard washing cycle	Cotton ECO
Energy consumption of the Cotton ECO 60°C at full load (Washing)	0.94kwh /cycle
Water consumption of the Cotton ECO 60° C at full load (Washing)	64L/cycle
Remaining moisture content of the Cotton ECO 60°C at full load (Washing)	44%
Programme duration of Cotton ECO 60° C at full load (Washing)	310min
Energy consumption of the Dry at full load (Drying)	4.50kwh /cycle
Water consumption of the Dry at full load (Drying)	88L/cycle
Remaining moisture content of the Dry at full load (Drying)	0%
Programme duration of Dry at full load (Drying)	340min
Power consumption of off - mode	0.5W
Power consumption of Left on -mode	1.0W
Noise level of washing	54dB (A)
Noise level of spinning	78dB (A)
Noise level of drying	62dB (A)

Please keep this instruction manual for future reference

# BUILT-IN INSTALLATION

## Appendix

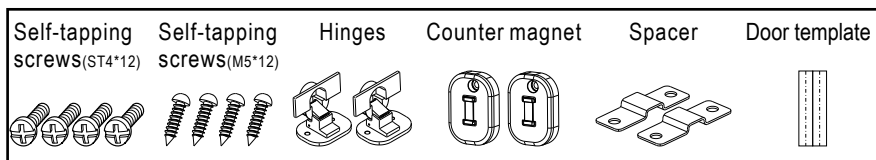

## Tool

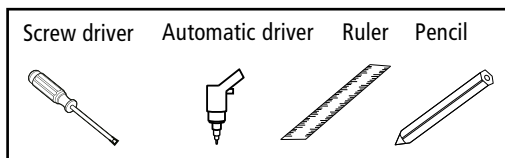

## Install Steps

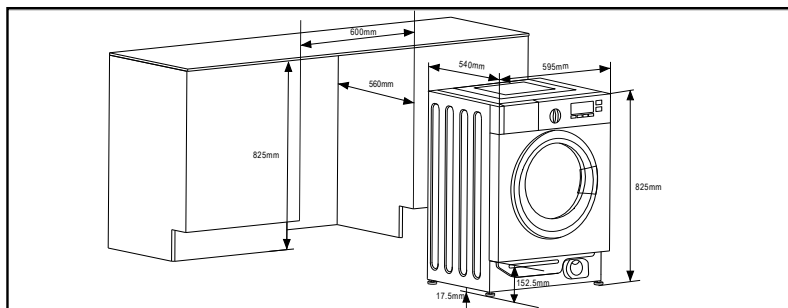

## Overview

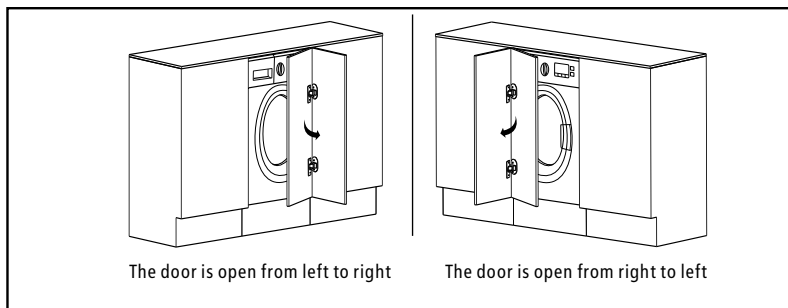

## Preparation and assembly of the door

Please keep this instruction manual for future reference

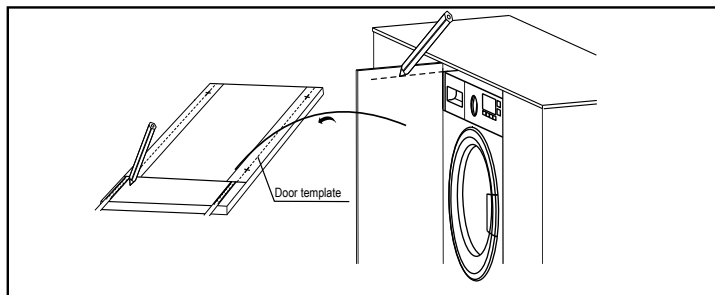

Make the mark on the door

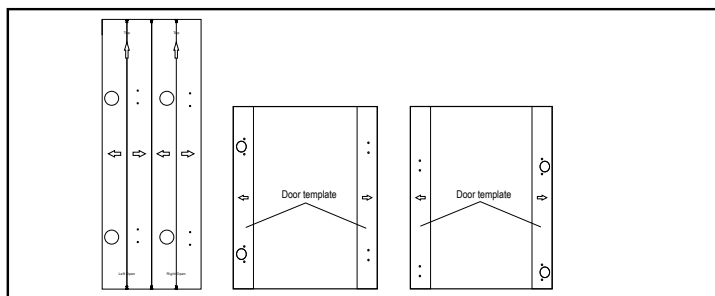

Fix door template paper onto the door.

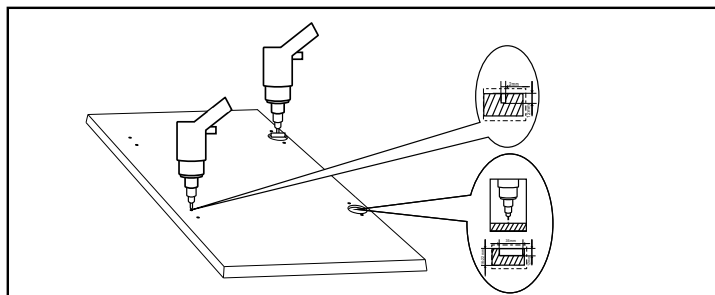

Drill hole on the door.

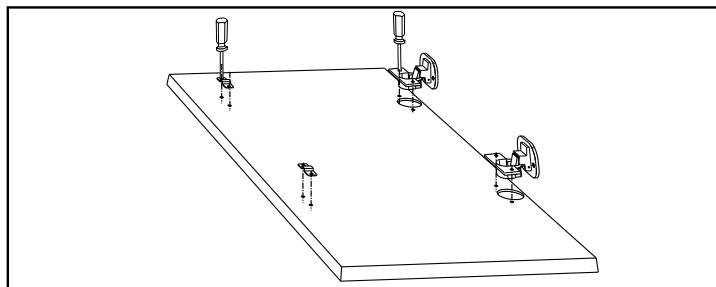

Install the hinges and spacer.

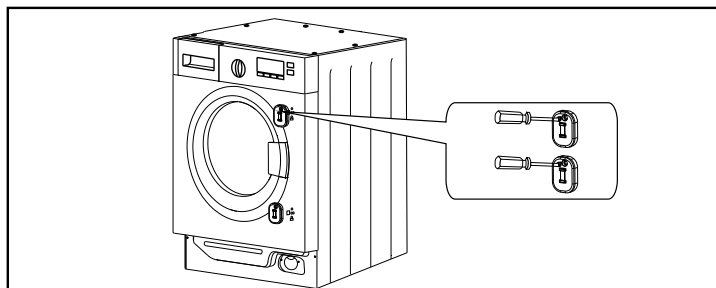

Install the counter magnet.

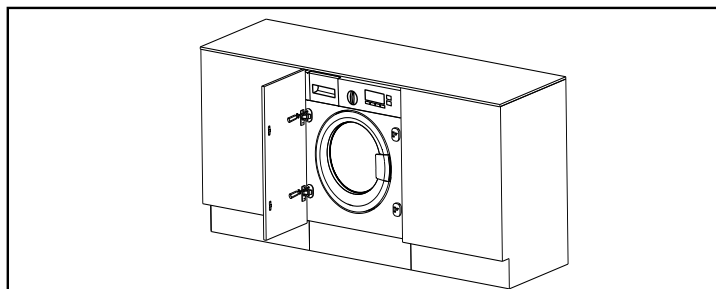

Install the door

## WARNING

When installing the appliance into the kitchen furniture, if possible, the hoses are placed in either of the two recesses on the back of the appliance. This will help to prevent the hoses from becoming kinked or trapped.

Please keep this instruction manual for future reference

Caple Service  
Fourth Way  
Avonmouth  
Bristol  
BS11 8DW

t: 0117 938 7420  
e: [service@caple.co.uk](mailto:service@caple.co.uk)  
[www.caple.co.uk](http://www.caple.co.uk)

Please keep this instruction manual for future reference