

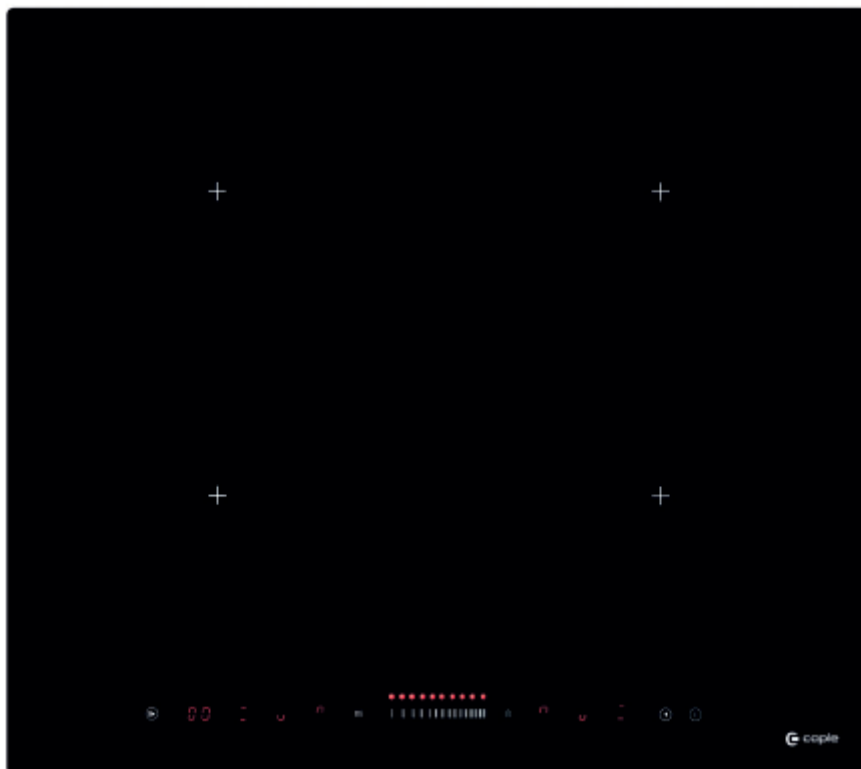

C858I

Caple Induction Hob Bridgeable Black, Frameless



Technical Manual



C858I

Cable Induction Hob Bridgeable Black, Frameless

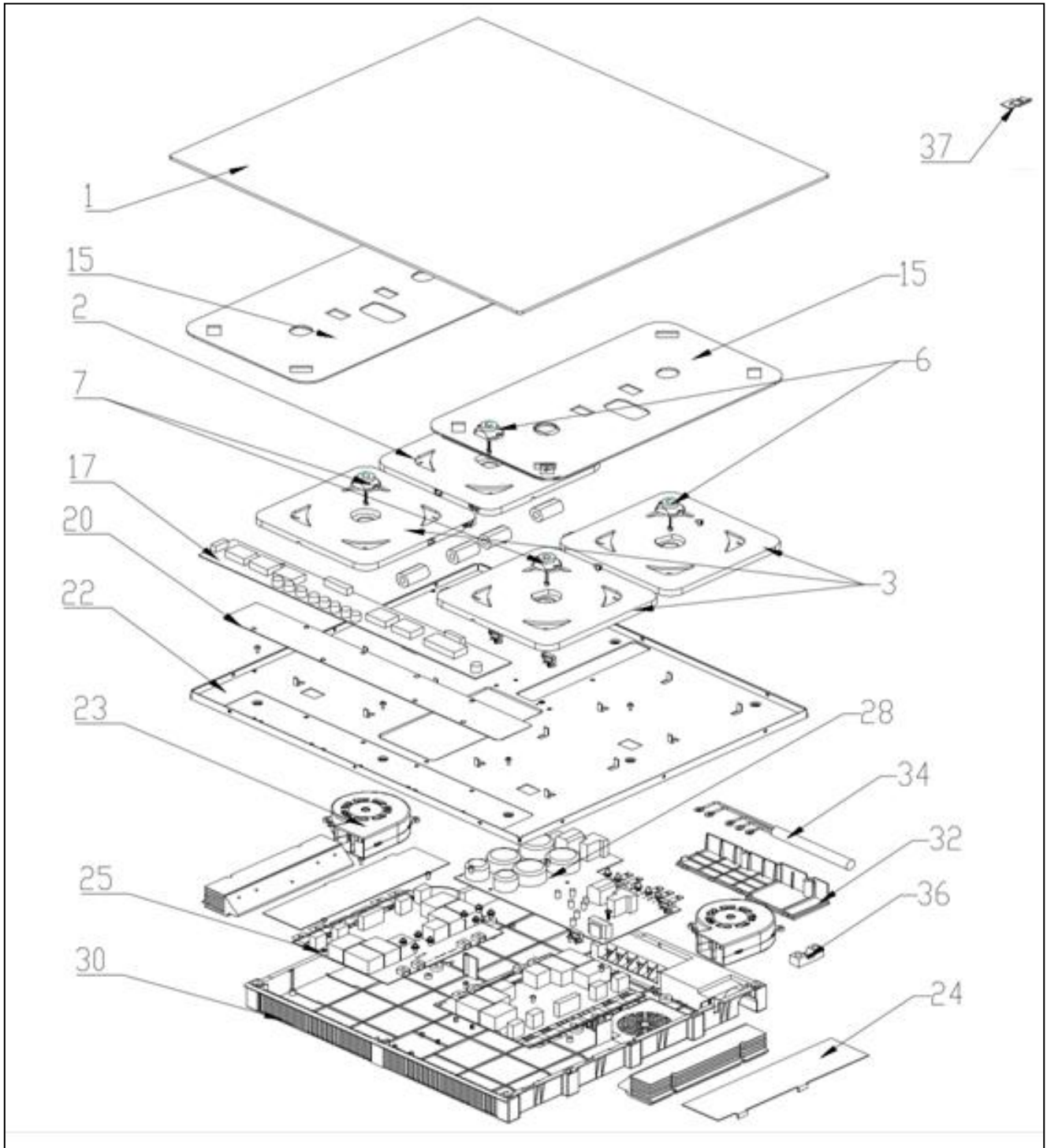



C858I

Caple Induction Hob Bridgeable Black, Frameless

| Item | Part Number | Description | Quantity |
|------|-----------------|------------------------------|----------|
| 1 | 12966000000244 | Glass Assembly | 1 |
| 2 | 17466000000074 | Coil Plate Assembly | 1 |
| 3 | 17466000000086 | Coil Plate Assembly | 3 |
| 6 | 17466000000178 | Temperature Sensing Assembly | 2 |
| 7 | 17466000000176 | Temperature Sensing Assembly | 2 |
| 15 | 12666000000015 | Heat Insulation Cotton | 2 |
| 17 | 17166000000007 | Display panel | 1 |
| 20 | 12766000000002 | Display Board Mica Sheet | 1 |
| 22 | 12266000000065 | Support Aluminium Plate | 1 |
| 23 | 17466000000040 | Fan Assembly | 2 |
| 24 | 12166000000021 | Insulation Patch | 2 |
| 25 | 17166000000287 | Main control panel | 2 |
| 28 | 17166000000580 | Power Panel | 1 |
| 30 | 121660000006833 | Bottom Base | 1 |
| 32 | 12166000000037 | Power Cord Box Lid | 1 |
| 34 | 17466000002634 | Power Cord | 1 |
| 36 | 12166000000039 | Wire Fastener | 1 |
| 37 | 12966000000009 | Hanging Plate Fitting | 1 |