



RFZ70

Caple 60cm freestanding Freezer



Technical information



New product information sheet

Product name: RFZ70
Description: Caple 60cm freestanding Freezer
Product code: RFZ70

Compressor	NE1112Y
Climate Class	SN/T
Protection Against Electric Shock	I
Rated Voltage/Frequency	~ 220-240V/50Hz
Rated Power(W)	75
Rated Defrost Power(W)	250
Lamp Rated Power(W)	1.1
Rated Current(A)	1.2
Foaming Agent	Cyclopentane
Energy Consumption(kW•h/24h)	0.677
Energy Efficiency Class	A++
Total Gross Volume(L)	261
Gross Freezer Volume(L)	/
Total Storage Volume(L)	260
Freezer Storage Volume(L)	260
Refrigerator Storage Volume(L)	/
Refrigerant,Amount	R600a,62g
Freezing Capacity(kg/24h)	16
temperature rise value	900min
Net Weight(kg)	81
Gross Weight(kg)	89
Noise	45
High Side(Psi)	120
Low Side(Psi)	8
Product Dimensions(mm)(wxdxh)	Include handles : 595X695X1855 Exclude handles : 595X645X1855
Carton Dimensions(mm)(WxDxH)	740x655x1905
Packing Dimensions(mm)(WxDxH1)	745x660x1925
Stacking layers	2

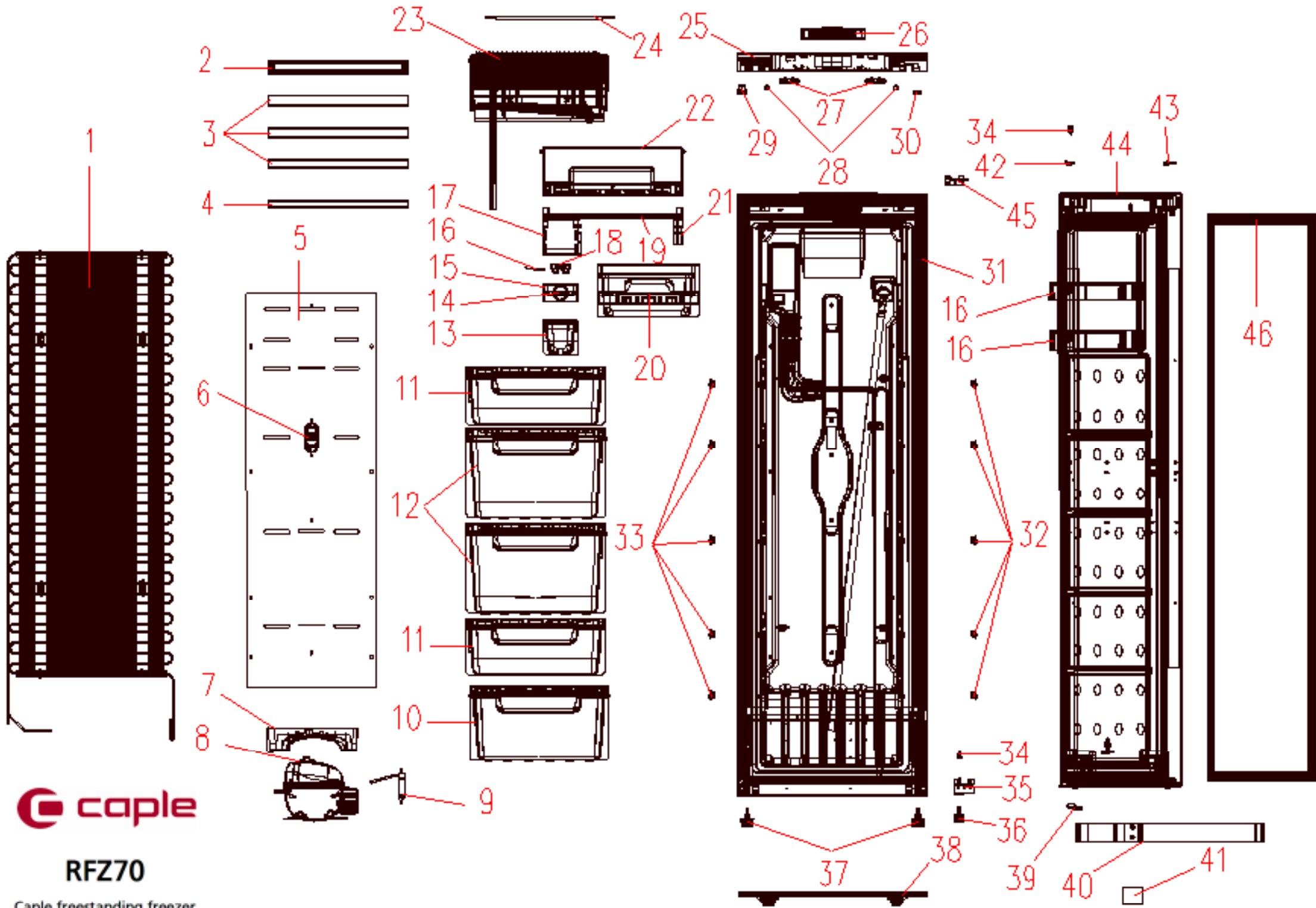

caple

RFZ70

Caple freestanding freezer



RFZ70 - Caple 60cm freestanding freezer

Item	Part Code	Description	Qty
1	501726030001	wire tube condenser assembly	1
2	503602030006	glass shelf assembly	1
3	503602030008	glass shelf	3
4	503602030009	glass shelf	1
5	501126030013	air duct cover	1
6	501125810006	sensor box cover	1
7	50113001000R	drain tray	1
8	501440430001	compressor assembly	1
9	501602000045	filter	1
10	50112603001B	F bottom drawer assembly	1
11	50112603001C	F top drawer assembly	2
12	50112603001A	F middle drawer assembly	2
13	50112603001N	ice box	1
14	5011320102AL	ice tray desmodium	1
15	50113201029A	rotation ice tray bracket	1
16	502502300003	spring	1
17	50112603000X	ice-maker vertical shelf	1
18	501132010299	ice tray	1
19	50112603000W	I/M shelf main body	1
20	50112603000K	I/M drawer assembly	1
21	50112603001L	I/M frame	1
22	50112603000S	flip	1
23	501526030004	f upper air channel assembly	1
24	502101030002	air duct aluminum foil	1
25	503326030001	control board assembly	1
26	501126000001	main control PCB mounting-box cover	1
27	50112601000E	LED cover	2
28	501129210021	screw cap	2
29	50112601000J	right top hinge cover	1
30	50112601000K	left top hinge cover	1
31	50370503000E	cabinet assembly foamed	1
32	501154510007	drawer right stopper	5
33	501154510008	drawer left stopper	5
34	501123110005	hinge shaft sleeve	2
35	50290504000B	bottom hinge assembly	1
36	501119210059	adjustable foot	1
37	501121000010	adjustable foot	2
38	500728010040	compressor mounting panel	1
40	501226030009	door handle assembly	1
41	50112603001H	door handle cover	1
42	500726030005	door block	1
43	500726030006	door block	1



RFZ70 - Caple 60cm freestanding freezer

Item	Part Code	Description	Qty
44	50370013013C	F door assembly	1
45	50290504000A	top hinge assembly	1
46	50113504000G	R door seal assembly	1
-	501526030006	Evaporator Assembly	
--	502404010007	Fan motor	

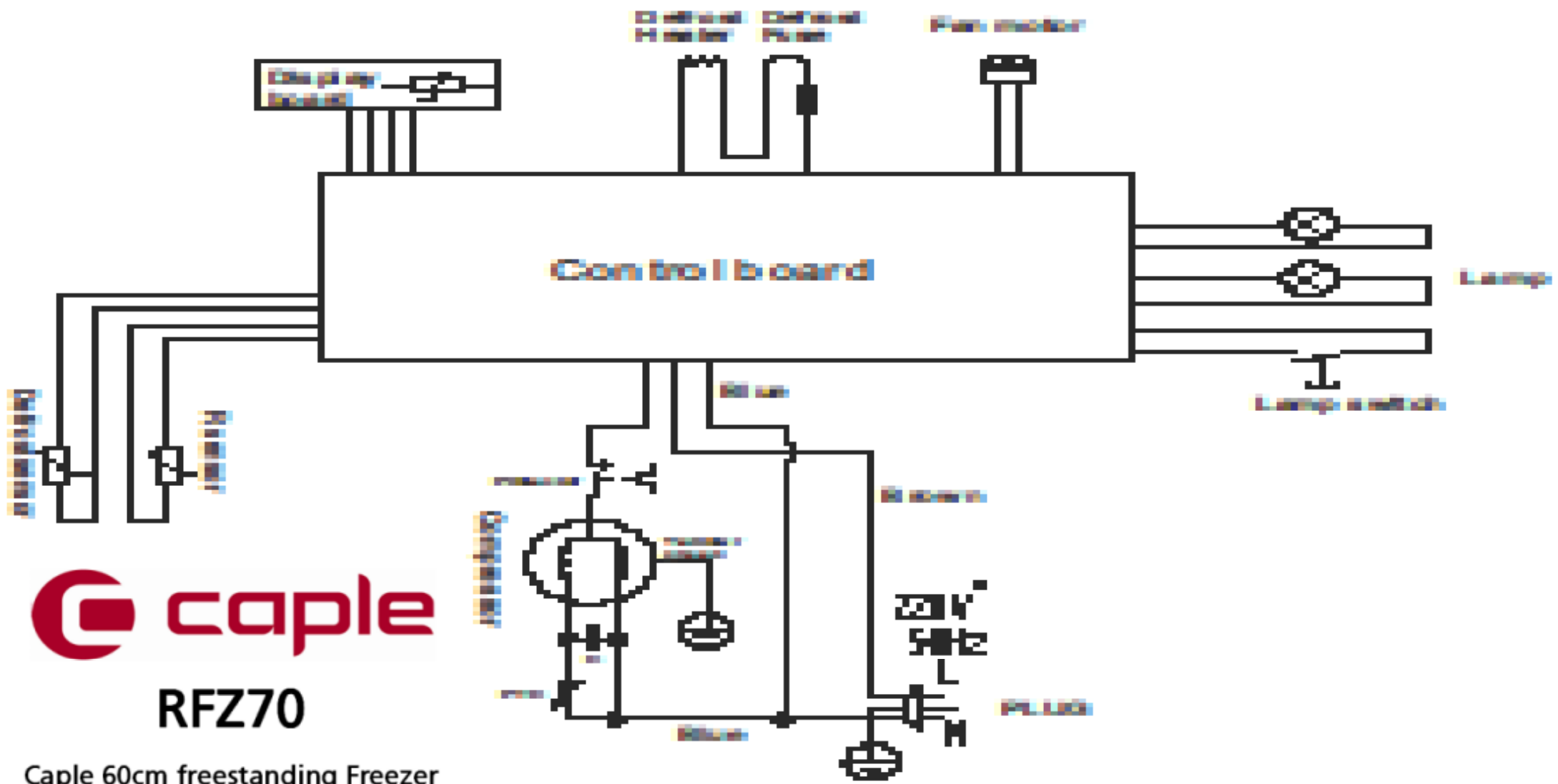

caple

RFZ70

Caple 60cm freestanding Freezer

RFZ70

Error Code	Corresponding circuit	Code visibility
E2	Freezer chamber temperature detection circuit	Yes
E5	Freezer defrosting temperature sensor fault	Yes
E6	Communication fault	Yes
E7	Ambient temperature sensor fault	Yes
E9	Freezer chamber high-temp alarm.	Yes