



C895IBK

Caple induction/GAS hob 90cm

Technical information

41718006 NERO
41718007 BIANCO

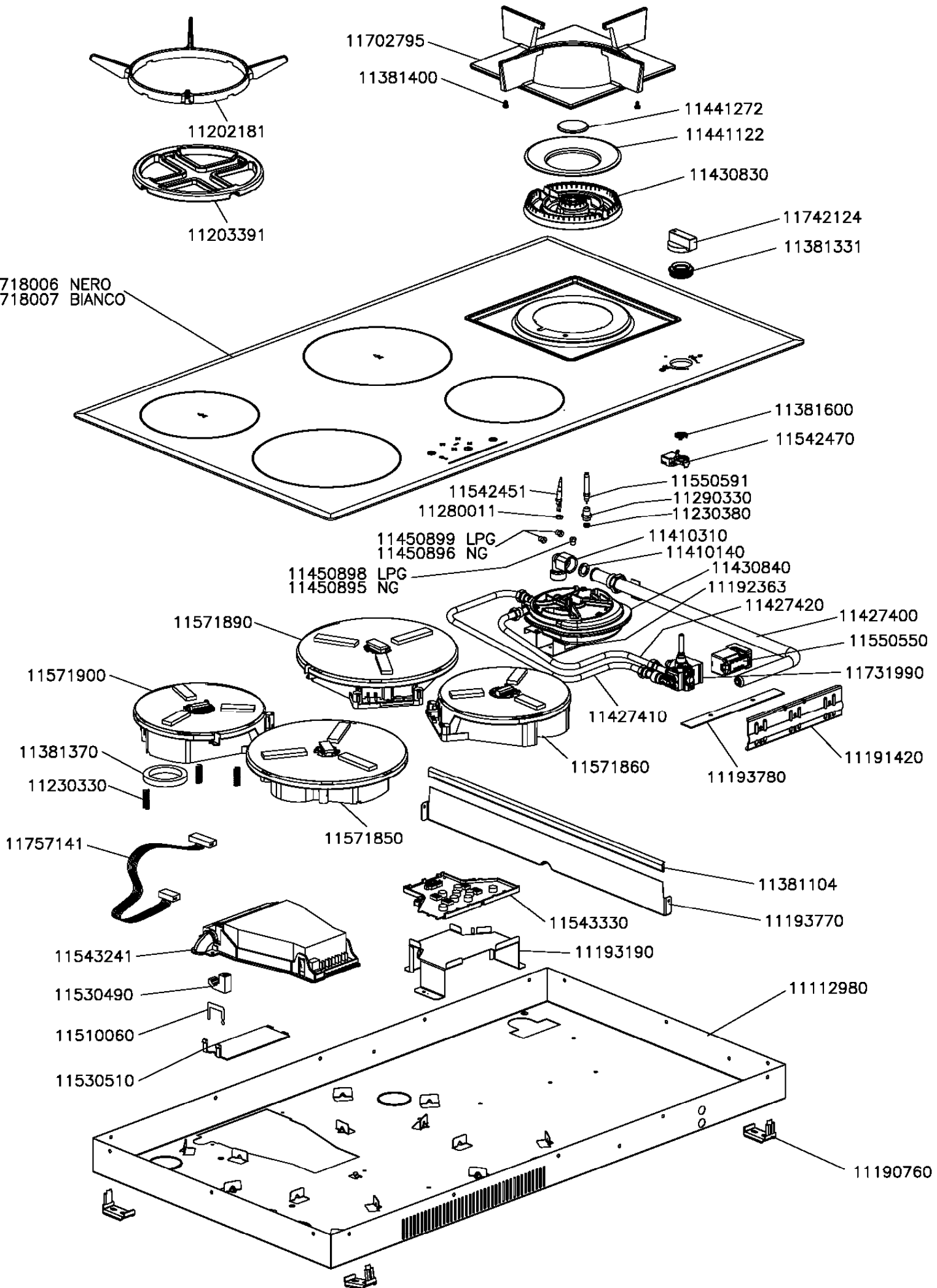



C895IBK - Capele induction/GAS hob 90cm

PartCode	Description
11112980	VCR TC90 BOTTOM
11190760	FIXING BRACKET HOB
11191420	2/3F CRY.ASJA FIX BRACKET GAS TAP
11192363	CRY. SM70 C3 SX H25,5 BRAZIER BOLT
11193190	TCTRL EGO BOARD SUPPORT BAS.IND.
11193770	TC90 DIVIDING BAR
11193780	TC90 GAS TAP FIXING BRACKET
11202181	WK AUXILIARY CAST IRON PAN SUPPORT
11203391	CAST IRON REDUCTION MOKA PAN SUPPORT
11230330	COMPRESSION SPRING INDUCTION
11230380	SPRING FOR DUAL GAS IGNIT.BULB
11280011	THERMOC.DUAL/C3 NUT M6X0,5
11290330	RING NUT DUAL GAS IGNIT.BULB
11381104	TOUCH C. L460mm PROT.SEAL
11381331	H=7,75 BLACK EPDM STUD
11381370	FAN GASKET
11381400	CAST IRON RUBBER GRILL
11381600	DEFENDI IGNITION SWITCH RING
11410140	GASKET
11410310	½ G CONICAL UNION ELBOW
11427400	GAS TAP HOLD PIPE
11427410	BURNER GAS CONNECTION
11427420	BURNER GAS CONNECTION
11430830	FLAME DIFFUSER DUAL BURNER
11430840	DUAL BURNER CAP
11441122	C3 DEF.BLK MAT.EXT.BURNER CAP
11441272	INTERNAL DUAL BURNER CAP BLACK MATT
11450895	INJECTOR TP2 GN/DUAL I 0,71
11450896	INJECTOR TP2 GN/DUAL E 0,95
11450898	INJECTOR TP4 GPL/DUAL I 0,46
11450899	INJECTOR TP4 GPL/DUAL E 0,65
11510060	BASIC EG IND.TERM.BLOCK JUMPER
11530490	CABLE CLIP TERM.BLOCK INDUCT.
11530510	BASIC IIç IND.TERM.BLOCK COVER
11542451	DUAL THERMOCOUPLE
11542470	IGNITION SWITCH
11543241	BASIC IND POWER BOARD
11543330	TOUCH CONTROL EGO IND.BASIC C/BOOSTER C/TIMER
11550550	GENERATOR AT 2U 220/40V MONT.SCATTO 3SC/sec
11550591	DUAL GAS IGNITION BULB



C895IBK - Caple induction/GAS hob 90cm

PartCode	Description
11571850	D.200 2300W I.BASIC S/ PLATE
11571860	D.160 1400W I.BASIC S/ PLATE
11571890	D200 2300/3000W I C/B. PLATE
11571900	D160 1400/1850W I C/B. PLATE
11702795	ON77/90 C3/TCD BLK CAST IR.PAN SUP
11731990	GAS TAP ASSEMBLY BY PASS 0,29
11742124	NICH.SAT.CUISINA KNOB
11757141	FLAT CABLE BOARD IND.BASIC L260
41718006	GLASS CERAMIC TC90 BEVELLED

11. Error and status codes

The list contains the heating specific errors, which are usually displayed by EGO Touch Controls. Error messages of the Touch Control are listed in the respective Touch Control document.

The error codes are specified in the User Interface description. Specific failures of IHEs or bus communication are normally indicated as follow:

E / x means that “E” blinks with the failure number “x”.

Error message	Description	Possible root cause	Trouble shooting
E / 4	non-configured IHE or no communication between UI and IHE	<ol style="list-style-type: none">1. IHE not configured.2. Two or more IHE's have the same configuration.3. IHE not connected to supply voltage, filter board does not release voltage (mains separation relay).	<ol style="list-style-type: none">1. assign IHE via configuration menu or configure IHE via IR programming2. delete total configuration and execute configuration.3. check voltages or correct connection filter and IHE and realize, if required.4. If all executed points should not lead to a solution, replace IHE.
C	A standing C indicated that this cookplace may be configured	no failure, user is in configuration menu.	put appropriate pot on IHE
C/-	<p>A blinking “C” shows that this cooktop is currently being configured.</p> <p>“—” is displayed in case of successful configuration.</p> <p>Should the “—“-symbol not appear, the possible root causes of E/4 have to be checked and removed, if required.</p>	no failure, user is in configuration menu.	Wait for - , or abortion of the configuration with respective selection key, C ceases to blink.
E	A blinking E in all cooktop displays means that currently all IHE configurations are deleted	no failure, user is in configuration menu.	Manual re-configuration

Error message	Description	Possible root cause	Trouble shooting
E / 2 (error code may differ for some TC)	overheating on IHE	1. pot / glass temperature too high 2. NTC → electronics temperature too high.	IHE has to cool down
E / 3	1. inappropriate pot, e.g. loss of magnetic properties due to temperature of pot bottom 2. HW Error: voltage too high to switch on IGBT, current measuring is not valid	pot generates inadmissible work point on IHE, which may lead to destruction of components on the IHE (e.g. IGBT).	1. This error is reset after 8s, the hotplate may be used again. Should the failure occur again, the pot has to be removed. 2. If the error occurs without a pot, or with a 100% working pot you have to Replace IHE
E / 5	Irreparable IHE error	Controller data faulty IHE Electronics defective	Replace IHE
E / 6	Irreparable IHE error	IHE Electronics defective	Replace IHE
E / 9	coil sensor PT1000 defect	Sensor delivers implausible values, a defect is obvious.	Replace IHE
no display, no function	overvoltage at the switching power unit (-> no function after putting into operation)	wrong connection to 400 V	Remove from mains and reconnect

Please note that some failures can't be indicated on the user interface e.g. power supply is damaged.

3.1.1. Manual configuration (TC Lite)

- Within 2 minutes after voltage application (reset of μ P) the configuration can be initiated. The user interface remains switched off. All displays remain black.
- Press the ~~minus key~~ and hold it.
- P Press all the selection keys available starting anti-clockwise with the cooking zone *front right*. Every action is acknowledged by a signal tone.
- The cooking zone displays indicate a „C“ for non-configured cooking zones and „-“ for configured ones.
- The cooking zone to be configured can be selected via the cooking zone select key. The symbol „C“ starts flashing on the corresponding display when carried out.
- Now a pan must be placed on the relevant cooking zone within 20 sec to enable the IHE to detect the correct position. If the position is detected correctly, the display indicates „-“.
- This procedure is applied to every cooking zone until the configuration menu is ended automatically after the last cooking zone has been configured. The configuration menu can also be ended by pressing the power key. If no key is pressed, the menu ends within 2 min.
- Ready configured cooking zones cannot be configured again in case an error has occurred, e.g. if the pan had been placed on the wrong cooking zone, the entire configuration can be cancelled. This requires pressing the minus key for at least 2 sec which results in the symbol „E“ to appear on all cooking zone displays. The „E“ on the cooking zone displays continues flashing until all IHEs have restored the initial state and changes into „C“ right afterwards. The cooking zones may now be configured anew.

3.1.2. Automatic configuration

Another comfortable and fast method of configuration is realized by IR diodes at the bottom side of the hob. Therefor are adequate IR receivers on every IHE which are reachable by holes at the bottom side of the IHE. To use this alternative configuration, adequate holes must designed at the bottom of the hob.

The IR transmitting diodes must be placed on a template in a way, that they hit the holes in the hub. This means that it's necessary to produce a template for every hob configuration.

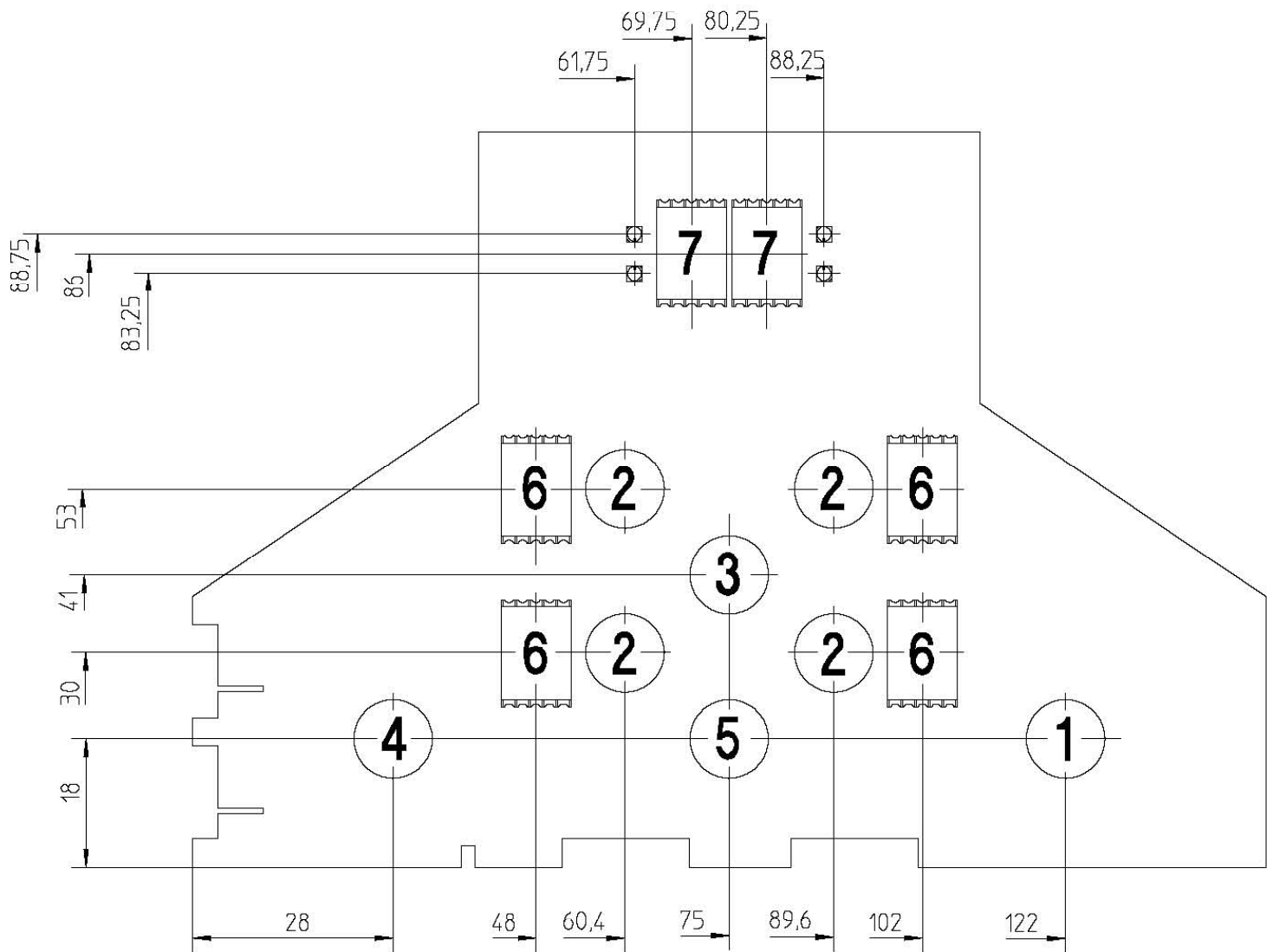

- 1 Hauptschalter-Taste / Power on Key
- 2 Plus-Taste mit Kochstellenselektion /
Power level increment with cooking zone selection key
- 3 Minus-Taste / Power level decrement
- 4 Booster-Taste / Booster key
- 5 Timerselektions-Taste / Timer selection key
- 6 Kochstufen-Anzeige / Power level display
- 7 Timer-Anzeige mit LED für Kochstellenzuordnung /
Timer display with LED assign to cooking zone

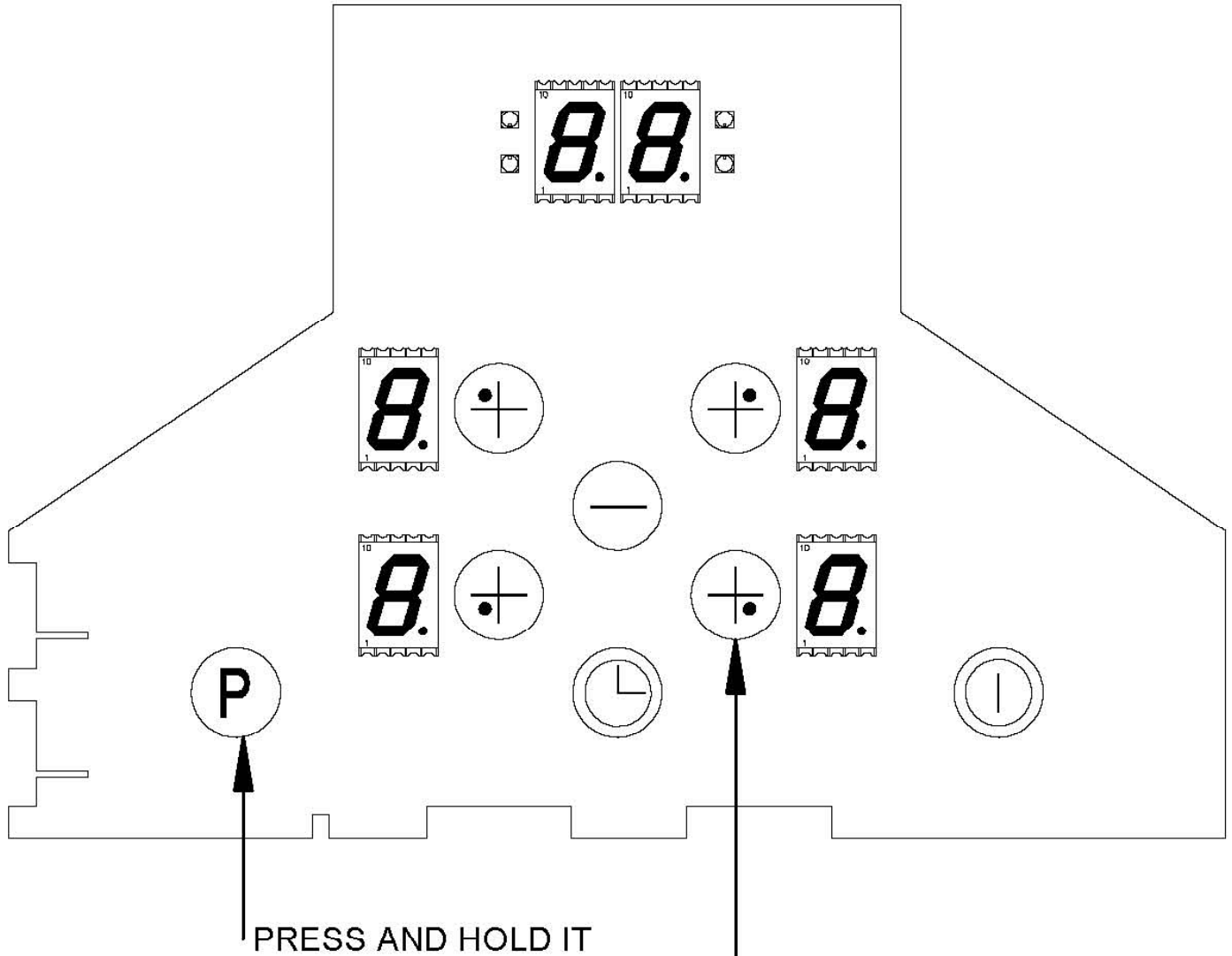

PRESS AND HOLD IT

Press all the selection keys available starting anti-clockwise with the cooking zone front right