

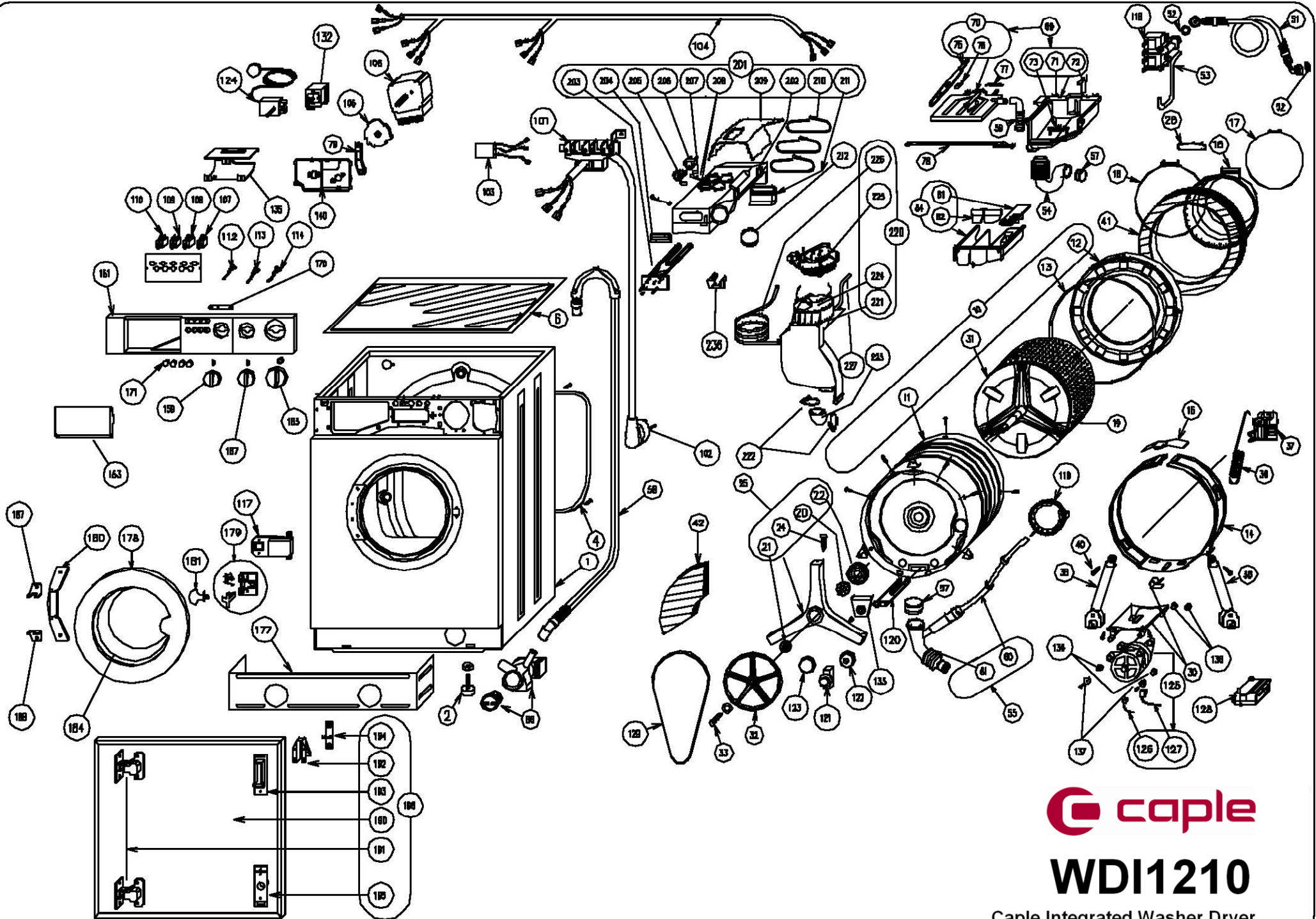

WDI1210

Caple Integrated Washer Dryer

TECHNICAL INFORMATION



 **caple**

WDI1210

Caple Integrated Washer Dryer

 caple	Part Ref	Key	Description
WDi1210	36201900R	1	CABINET (INTEGREE)
WDi1210	35930100	2	FOOT
WDi1210	36209100SL	6	COVER
WDi1210	36344500	10	TUB (SERVICE) WD 54/1200
WDi1210	36200300SL	11	TUB WD
WDi1210	36053200SL	12	TUB FRONT DISC
WDi1210	36053300	13	RING GASKET
WDi1210	36053400SL	14	TANK BLANK
WDi1210	36053500	15	TUB BLANK CLOSURE
WDi1210	36219700	16	PORTHOLE GASKET WD
WDi1210	36160200	17	RING GASKET
WDi1210	36013500	18	DRUM GASKET FIXING RING
WDi1210	36040700	19	COUNTERSHAFT CROSS
WDi1210	29169890	20	BEARING SL
WDi1210	29169790	21	BEARING SL
WDi1210	36047700	22	SEAL RING
WDi1210	36054100	23	SMALL PLATE FOR PACKING SPACER
WDi1210	36238800	23	SMALL PLATE FOR PACKING SPACER
WDi1210	38811600	24	SCREW TE M10X26
WDi1210	36084100	25	BEARING SUPPORT
WDi1210	36240900	26	DUCT FIXING WRAPPER
WDi1210	36053800	30	MOTOR HOUSING
WDi1210	36064700SL	31	DRUM 1200 54 CM
WDi1210	36051500	32	DRIVEN PULLEY
WDi1210	38811400	33	SCREW TE M8X25
WDi1210	36164400	36	AIRSPRING
WDi1210	36291600	37	SPRING SUPPORT
WDi1210	36427800	38	TUB SHOCK ABSORBER
WDi1210	38811500	40	SCREW TE M8X45
WDi1210	36501700	41	FRONT COUNTER WEIGHT WD
WDi1210	36222200	42	REAR COUNTER WEIGHT KIT
WDi1210	35389500	51	WATER INLET HOSE
WDi1210	35472500	51	WATER INLET HOSE
WDi1210	38815900	52	WATER INLET HOSE GASKET
WDi1210	36064900	53	WATER INLET PIPE
WDi1210	36054800	54	SOAP DRAWER SLEEVE
WDi1210	36255400	55	AIR PRESSURE BELL TUBE
WDi1210	36464700	55.01	AIR PRESSURE BELL TUBE
WDi1210	36055000	57	RING NUT FOR SLEEVE FIXING
WDi1210	36059800	58	DRAIN TUBE
WDi1210	36051700	59	STEAM SLEEVE
WDi1210	36162900	60	AIR PRESSURE BELL
WDi1210	36452700	60.01	AIR PRESSURE BELL
WDi1210	36192500	61	DRUM/PUMP DRAIN TUBE
WDi1210	36255400	61.01	AIR PRESSURE BELL TUBE
WDi1210	49569900	66	SELF-CLEANING DRAIN PUMP
WDi1210	36661200	69	SOAP DISP.COMPARTMENT
WDi1210	35887700	70	PROTECTION FOR SOAP DISP.COMP.
WDi1210	36805200	70	SOAP DRAWER COVER
WDi1210	36004300	77	BALANCING SPRING
WDi1210	36228300	78	DISTRIBUTING STAF NOZZLE DX
WDi1210	36228400	78	DISTRIBUTING STAF NOZZLE SX
WDi1210	36059300	79	TRACER POINT

 cable	Part Ref	Key	Description
WDi1210	36629400	84	SOAP DRAWER
WDi1210	30429100	99.01	EXPLODED VIEW
WDi1210	36660800	99.02	CIRCUIT DIAGRAM
WDi1210	36660900	99.03	TOPOGRAPHIC DIAGRAM
WDi1210	36475400	99.04	TIMER DIAGRAM
WDi1210	35695000	99.05	ABBREVIATE SCHEME CHART
WDi1210	36252801	99.08	INSTRUCTION MANUAL
WDi1210	29329950	99.99	TEARING RIVET
WDi1210	29343750	99.99	RIVETS D.8
WDi1210	36133800	99.99	MAGNET KIT FOR PORTHOLE
WDi1210	38808600	99.99	WIRING PROTECTION SCREW
WDi1210	49569600	101	TERMINAL BOARD
WDi1210	49557701	102	MAIN CABLE UK
WDi1210	49569500	103	ANTIJAMMING FILTER
WDi1210	49569001	105	TIMER
WDi1210	49578000	105.01	TIMER 0667/7/0.12
WDi1210	36060700	106	SOAP DRAWER CAM
WDi1210	49548800	107	MODULAR BUTTON SET 2 CONT.
WDi1210	49548400	108	MODULE BUTTON SET 1 CONT.
WDi1210	49549600	109	MODULAR SWITCH 2 CONT.
WDi1210	49549600	110	MODULAR SWITCH 2 CONT.
WDi1210	29356390	112	WARNING LIGHT
WDi1210	29356490	113	WARNING LIGHT
WDi1210	29356490	114	WARNING LIGHT
WDi1210	49538100	117	PORTHOLE SAFETY DEVICE
WDi1210	49564300	118	2 WAYS SOLENOID VALVE
WDi1210	49572500	118	1 WAY SOLENOID VALVE
WDi1210	49573200	119	PRESSURE SWITCH
WDi1210	49560400	120	HEATING ELEMENT 2500W 240V
WDi1210	49561000	121	THERMOSTAT CAP
WDi1210	35000300	122	THERMOSTAT CAP GASKET
WDi1210	49572900	124	THERMOSTAT
WDi1210	49558800	125	UNIVERSAL MOTOR
WDi1210	49527000	126	SLIDING CONTACT
WDi1210	49527100	126	SLIDING CONTACT
WDi1210	49528800	127	TACHO GENERATOR
WDi1210	49528900	127	TACHO GENERATOR
WDi1210	49569800	128	DIGITAL MODULE
WDi1210	36060900	129	U-BELT
WDi1210	49564600	132	TIMER
WDi1210	36297300	133	HEATING ELEMENT PROTECTION
WDi1210	36063700	135	PROTECTION FOR PUSH BUTTON SET
WDi1210	36055100	136	BUSH FOR MOTOR FIXING
WDi1210	36095600	137	WASHER FOR MOTOR FIXING
WDi1210	36228100	140	TIMER/THERMOSTAT SUPPORT
WDi1210	36663000	151	BOARD PANEL
WDi1210	36660100	153	SOAP DRAWER HANDLE
WDi1210	36228500	159	TIMER/THERMOSTAT KNOB
WDi1210	35892900	163	TIMER KNOB
WDi1210	36228500	167	TIMER/THERMOSTAT KNOB
WDi1210	36241300	170	WARNING LIGHTS GLASS COVER
WDi1210	35916300	171	PUSH BUTTON
WDi1210	35587400SL	177	MOLDING PANEL

 caple	Part Ref	Key	Description
WDi1210	36344300	178	PORTHOLE KIT WITH HANDLE
WDi1210	36015900	179	PORTHOLE HOOK KIT (5 PIECES)
WDi1210	36000800	180	PORTHOLE HINGE
WDi1210	36001200	181	PORTHOLE HANDLE
WDi1210	36001201	181.01	PORTHOLE HANDLE
WDi1210	36227100	184	PORTHOLE GLASS PROTECTION
WDi1210	36004800	187	HINGE FIXING UPPER PLATE
WDi1210	36004900	188	HINGE FIXING LOWER PLATE
WDi1210	35932300	191	DOOR HINGE
WDi1210	36640000	201	ASSEMBLED AIR DUCT
WDi1210	49574700	203	AIR DUCT HEATING ELEMENT
WDi1210	36227500	204	AIR DUCT HEAT.ELEMENT GASKET
WDi1210	49564400	205	THERMOSTAT CAPSULE
WDi1210	49564500	206	THERMOSTAT CAPSULE
WDi1210	29187980	207	OR GASKET
WDi1210	36296200	208	AIR CONDENSER CABLE FIX.SPRING
WDi1210	36227600	209	AIR DUCT COVERING
WDi1210	36283200	210	AIR DUCT INSULATING WRAPPER
WDi1210	36227200	211	GASKET (AIR DUCT-BELLOWS)
WDi1210	36226900	212	TRUNK GASKET
WDi1210	36240702	220	ASSEMBLED AIR CONDENSER
WDi1210	49564200	221	FAN MOTOR CONDENSER
WDi1210	36241000	222	TUB SLEEVE FIXING WRAPPER
WDi1210	36226800	223	SLEEVE (AIR DUCT-TUB)
WDi1210	36453100	224	FAN MOTOR GASKET (SERVICE)
WDi1210	18600000	224.01	CONDENSER COVER GASKET
WDi1210	36454000	225	FAN MOTOR KIT (SERVICE)
WDi1210	36240702	225.01	ASSEMBLED AIR CONDENSER
WDi1210	36453900	226	CONDENSER WD WATER INLET HOSE
WDi1210	36603000	227	VAPOUR ESCAPE TUBE (WD)
WDi1210	36338300	236	DUCT CONDENSER SMALL PLATE
WDi1210	36252802	9,908.01	INSTRUCTION MANUAL