



DI605DL

**Caple Deluxe 60cm
Integrated Dishwasher**



TECHNICAL INFORMATION



DI605DL

Caple Deluxe 60cm
Integrated Dishwasher

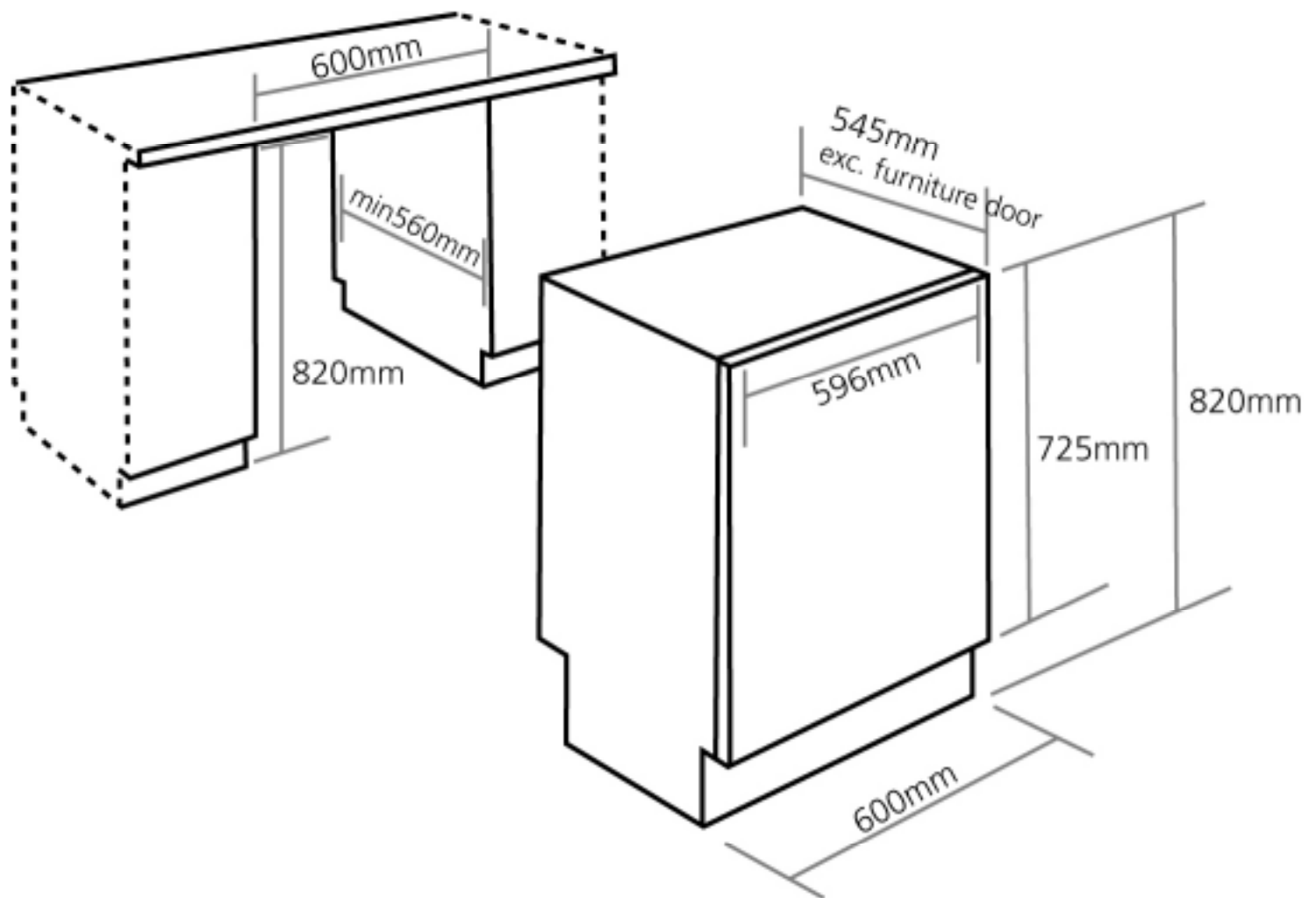



Model : Di605DL (DW12-CBE7) (PCB code: 0124000629)

Progam	Washing time(mins)
Intensive wash	122
Intensive+1/2 washing	104
Normal wash	102
Normal+1/2 washing	90
Light wash	162
Light wash+1/2 washing	144
Glass wash	92
Glass wash+1/2 washing	82
Rapid wash	31
Rapid+1/2 washing	29
Soak	12
Soak+1/2 washing	12

Model : Di605DL (DW12-CBE7) (PCB code: 0124000629B)

Progam	Washing time(mins)
Intensive wash	112
Intensive wash+1/2 washing	94
Normal wash	102
Normal+1/2 washing	90
Light wash	162
Light wash+1/2 washing	140
Glass wash	92
Glass wash+1/2 washing	82
Rapid wash	32
Rapid+1/2 washing	28
Heat wash	54
Heat wash+1/2 washing	48
Soak	12
Soak+1/2 washing	12

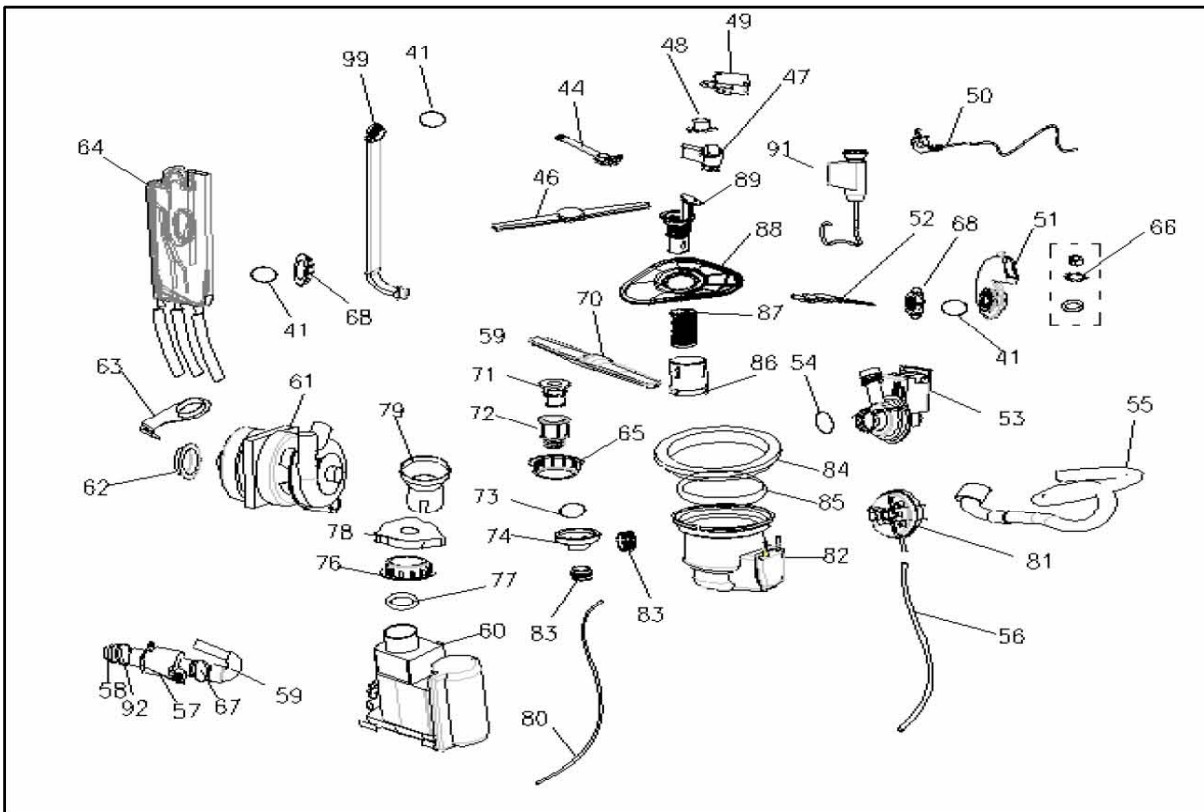
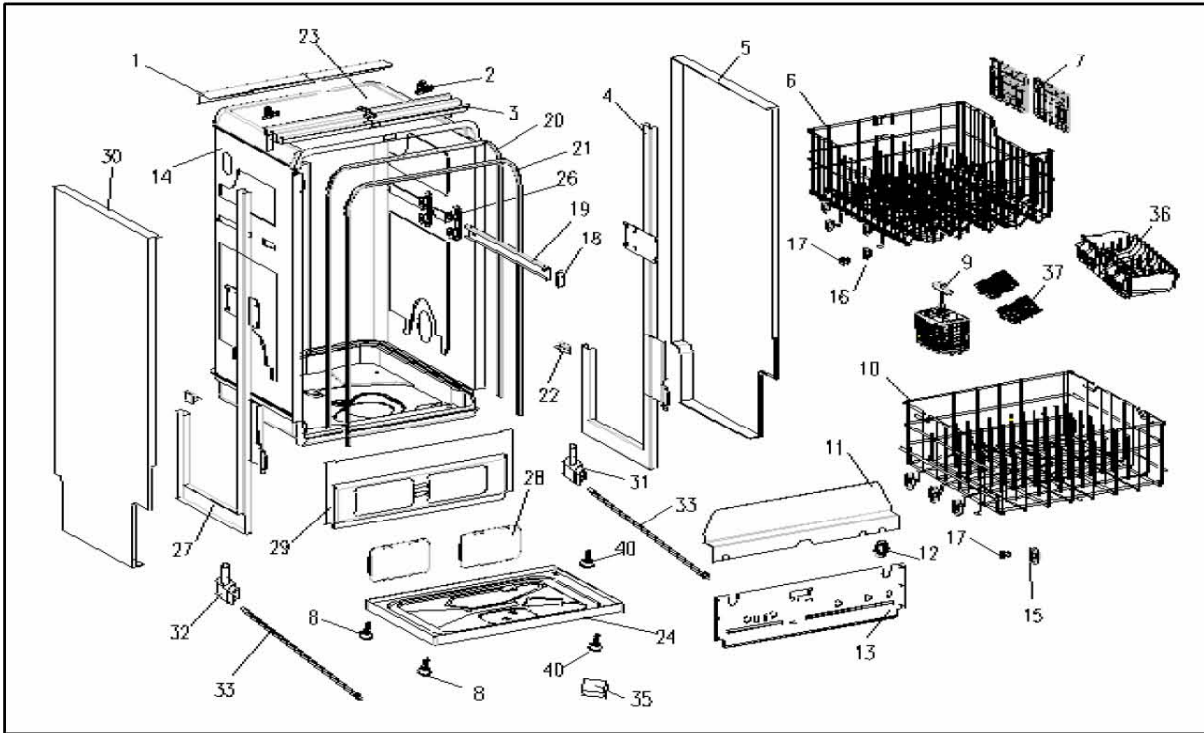

Exploded View

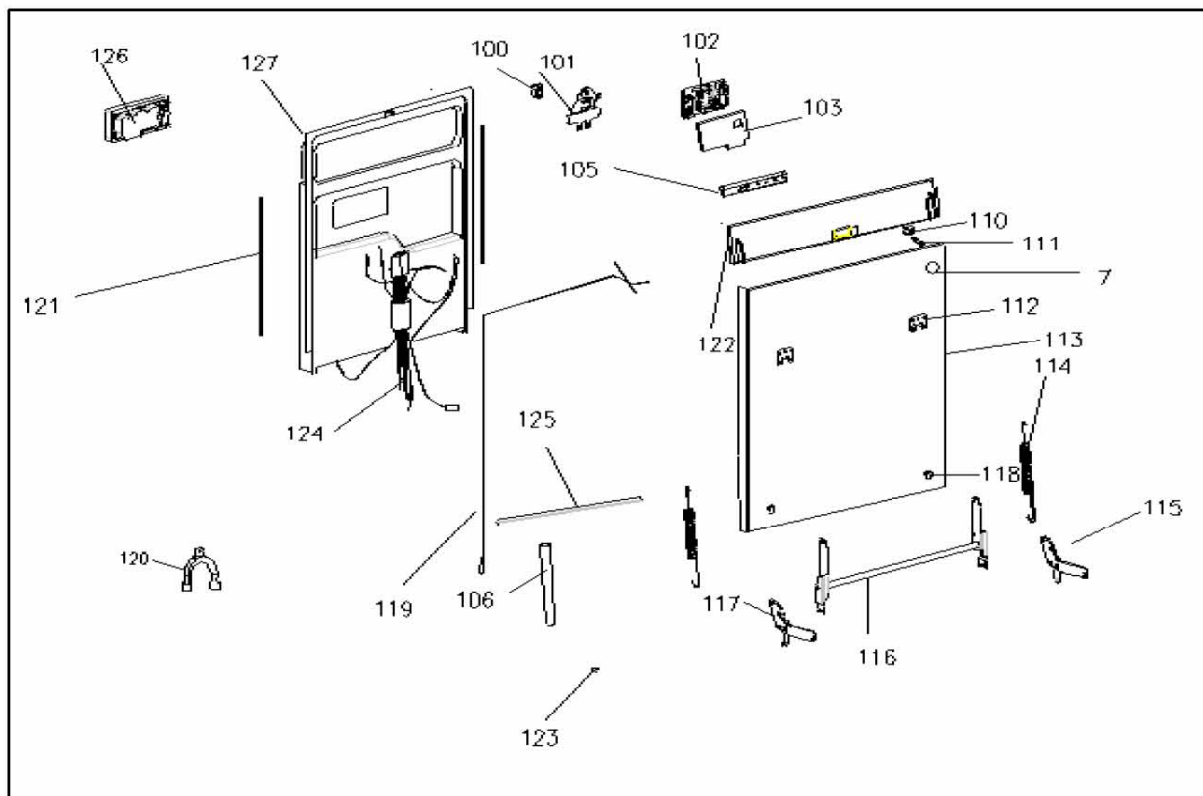



Dishwasher

Model:Di605DL

Parts List

NO.	Name of part	Part Specialized code	QTY.	Remark
1	Upper rear crosspiece	012G1310020	1	
2	Main screw for self threading screw 3.5	0120200057	3	
3	Upper front crosspiece	0120800225	1	
4	Right upright assembly	0120806567	1	
5	Painted right side pannel	0120106819	1	
6	Upper basket	0120106652	1	
7	Tilter for upper basket	0120201235	2	
8	Adjustable foot	0120600009	2	
9	Cutlery basket	0120801727	1	
10	Lower basket	0120106619	1	
11	Rear intermediate crosspiece	012G1310023	1	
12	Drain hose stop	012G2160204	1	
13	Lower rear crosspiece for acquostop	0120106294	1	
14	Insulated tub assembly	0120506932	1	
15	Wheel for lower basket	0120200964	8	
16	Wheel for upper basket	0120200963	8	
17	Wheel support pin	0120200965	16	
18	Basket rail stop	0120200967	4	
19	Mobile rail for basket	012G1020069	2	
20	Tub gasket	0120300248	1	
21	Support frame for tub gasket	012G1020082	1	
22	Upright small block	0120200124	2	
23	Hooking small block	012G2150037	1	
24	Tray	0120105715	1	
26	Rail support assembly	0120200966	4	
27	Left upright assembly	0120806566	1	
28	Cover for front crosspiece	0120200065	2	
29	Lower front crosspiece	012G1310027	1	
30	Painted left side pannel	0120106818	1	
31	Right threaded tapered gear	0120800223	1	
32	Left threaded tapered gear	0120800224	1	
33	Tie rod for foot adjusting	0120100051	2	
35	Rubber coupling	012G4050152	1	
36	knife rest	0120201260	1	
37	the net of the cutlery basket	0120201261	2	
40	Adjustable screw	0120600065	2	



Dishwasher

Model:Di605DL

Parts List

NO.	Name of part	Part Specialized code	QTY.	Remark
41	O-Ring	012G4050157	3	
44	Water diversion pipe	0120202778	1	
46	Upper sprayer assembly	0120801726	1	
47	Support for float	0120202056	1	
48	Float for Acquastop	0120503119	1	
49	Micro switch Elbi Type S3	012G6050040	1	
50	Power supply cable	0120400120	1	
51	Air outlet	012G2160197	1	
52	Thermo limiter assembly	0120800379	1	
53	Drain pump	012G5040004	1	
54	O-Ring	012G4050158	1	
55	Drain hose assembly	012G2140061	1	
56	Pressure switch tube	012G2140067	1	
57	Heater assembly	0120800355	1	
58	Water intake hose (heating element)	0120200220	1	
59	Coupling (column / heating element)	0120200225	1	
60	Water softener	012G9380537	1	
61	Washing pump assembly	012G9380538	1	
62	Vibration-proof ring motor	012G4050159	1	
63	Motor bracket assembly	012G9350006	1	
64	Breather assembly	012G2160196	1	
65	Ring nut for lower spayer fastening	0120201006	1	
66	Elasticity retainer	0120600060	2	
67	tube clamp	0120100437	1	
68	Breather ring nut	0120201008	1	
70	Lower sprayer	012G1020070	1	
71	Lower sprayer column	0120201005	1	
72	Lower sprayer base	0120201004	1	
73	O-type sealing ring	012G4050153	1	
74	Lower sprayer base fixing piece	012G2160193	1	
76	Softener ring nut	012G2150042	1	
77	Water softener sealing ring	012G4050154	1	
78	Cover of salt dispenser port assembly	0120802037	1	
79	Salt dispenser funnel	0120201753	1	
80	Connection pipe	012G4050244	1	
81	1-level pressure switch	012G6050031	1	



Dishwasher

Model:Di605DL

Parts List

NO.	Name of part	Part Specialized code	QTY.	Remark
82	Water gutter	012G2160191	1	
83	Rubber coupling	012G4050152	2	
84	Ring nut for cup fastening	0120201292	1	
85	Cup gasket	012G4050151	1	
86	Microfilter (polyesthere)	012G1040014	1	
87	Inside filter screen	0120200949	1	
88	Plane filter screen	012G1040012	1	
89	Filter	0120201009	1	
91	Water charge	012G9381036A	1	
92	tube clamp	0120100437	1	
99	Outer duct	012G2160236	1	
100	Door switch	0120800356	1	
101	Switch mechanism assembly	0120800357	1	
102	control panel	0124000631	1	
103	control cover	0120200244	1	
105	Left led card support	0120202929	1	
106	Door spring Cover	0120200048	2	
110	Springs adjusting small block	0120100042	2	
111	Spring adjusting screw	0120600197	2	
112	Block hooking bracket	0120100052	2	
113	Outer door	0120100043	1	
114	Door spring	0120100047	2	
115	Left hinge articulation	012G9380559	1	
116	Complete hinge assembly	0120800589	1	
117	Right hinge articulation	012G9380558	1	
118	Rubber	0120300014	2	
119	Adjusting cables	0120100053	2	
120	Drain hose support bracket	012G2130193	1	
121	Door gasket guard strip	012G2140094	2	
122	Dashboard	0120203343	1	
123	Hinge shaft	012G8080007	4	
124	Control cable	0120400313	1	
125	Door gasket	012G4050243	1	
126	Detergent dispenser	0124000213	1	
127	Inner Door	0120100776	1	



Domestic Dishwasher

SERVICE MANUAL



Models

Di605DL

● **Features**

- A grade for energy consumption of European standard
- Electronic control, delay washing
- Three-spraying, higher cleaning ratio
- Water softener for descaling
- Super-capacity for 12 settings

Contents

1. Features.....	3
2. Safety Precaution.....	4
3. Net Dimension.....	5
4. Installation and Accessory Parts.....	5
5. Parts and Functions.....	8
6. Function Schedule.....	11
7. Program Diagram.....	12
8. Maintenances Service and Trouble Shooting.....	13
9. Circuit Diagram.....	20

1.Features

1.1 A grade for energy consumption of European standard

1.2 Electronic control, delay washing

1.3 Half load washing

2.Safety Precaution

IMPORTANT

Carefully read the instructions contained in this manual, as it provides information that is essential to safe and proper installation, use and maintenance of this appliance.



This appliance complies with following EEC directives:

- 73/23/EEC of 19/02/73(Low Voltage)and subsequent modifications;
- 89/336/EEC of 03/05/89 (Electromagnetic Compatibility) and subsequent modifications.
- Carefully dispose of the packing material.
- After removing the packing, check to make sure that the appliance is not damaged. If in doubt, contact a qualified professional.
- The dishwasher must only be used by adults for the washing of household dishes and cooking utensils.
- Fundamental rules to follow when using the appliance:
 - * Never touch the dishwasher with wet hands;
 - * We discourage the use of extension cords and multiple sockets;
 - * During installation, the power supply cord must not be excessively or dangerously bent or flattened;
 - * If the appliance is not operating properly or requires maintenance, disconnect the appliance from the power supply.
- Keep detergents out of the reach of children. Also keep children away from the dishwasher when it is open to reduce the risk of injury.
- This appliance cannot be installed outdoors, not even if the area in which it is installed is covered by a roof. It is also very dangerous to leave it exposed to the rain and elements.
- Do not touch the heating element during or after a wash cycle.
- Do not lean or sit on the door when it is open, as this could overturn the dishwasher.
- If the appliance malfunctions, turn off water supply to the appliance and disconnect the plug from the wall socket. Then, refer to the "Troubleshooting" section on page 9.If you cannot resolve the problem, contact an authorised service agent.
- Only specialised personnel are authorised to make repairs.
- Appliances which are being discarded must be made inoperable by cutting the power supply cord and removing the door lock.
- The appliance must be positioned so that the plug is accessible.
- If installing this dishwasher on a carpeted floor, ensure the car pet does not obstruct the opening.
- If the supply cord is damaged, it must be replaced by the manufacturer or an authorised service agent.
- Always load the dishwasher as detailed in this instruction manual, loading knives and other utensils with sharp points with their points placed down or in a horizontal position.
- When connecting the appliance to the water mains always discard any old hose-sets and use new ones.

When not in use, keep the door of your dishwasher slightly ajar to allow air circulation however to prevent danger of tripping never leave the door down.

3.Net dimension

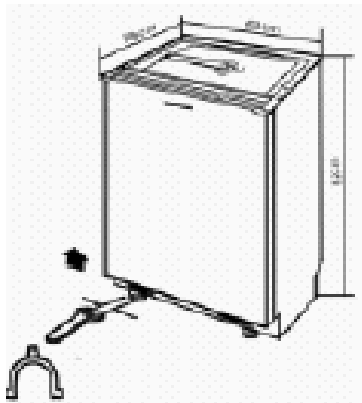

4.Installation and Accessory Parts

4.1 Mounting the Wooden Panel onto the Door and Sliding the Dishwasher into the Cabinet

During the preparatory stages for installing the dishwasher into the kitchen cabinet, holes must not be drilled in the sides, or door, in order to avoid compromising the performance and/or operation of the appliance. Before working on any internal components, the unit must be disconnected from the power supply. The maximum dimensions for the wood panel that can be installed on the door are: Height - 725 mm; Width – 598 mm; Thickness:20 mm.

The height dimension of 610 mm must be reduced if the height of the control panel is increased through the use of

4.2 Using the Drilling Template (Fig.3)

Align the top edge of the template (identified with the “A” arrow) with the top edge of the panel. On both sides of the template (top and bottom) are written the various dimensions that correspond to the different possible widths for the panel. Align the template with the side of the panel (left or right), making sure that the panel coincides with the appropriate dimensions. Mark the positions for the holes for the screws, using the tip of a drill or a pencil. The three holes closest to the side should be used(B). Repeat this step on the other side of the panel ,using the corresponding side of the template.

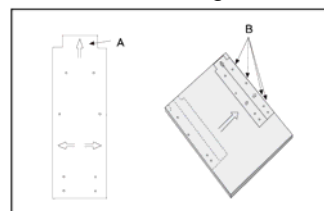

(Fig.3)

4.3 Fastening the Bracket to the Wooden Panel (Fig.5)

At the point marked, drill holes 2 mm in diameter. If the panel is made of chip board only drill through the veneer. If the panel is made of solid wood, the holes can be made deeper. Position the two brackets so that they are lined up with the holes made in the bottom part of the panel. The holes furthest to the outside should be used to fasten the brackets. The small fins should be turned downward. The hooks in the totally built-in version should be screwed into the two holes at the top.

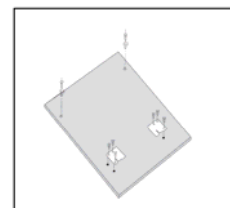

(Fig.5)

4.4 Mounting the Wood Door Panel onto the Dishwasher

Insert the top hooks into the appropriate slots in the dishwasher control panel. Then push the panel upwards until it stops. Afterwards, slide the panel downward again, moving the bottom of the panel toward the door so that the fins on the brackets slide into their slots (Fig.8).

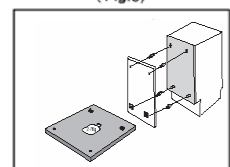

(Fig.8)

Open the doors of the dishwasher (the panel should stay in place by itself) and align the panel with the door, keeping it in contact with the control panel. Remove the small plastic plugs that cover the holes on the inside of the dishwasher panel and fasten the panel in place with the screws provided (Fig. 9).

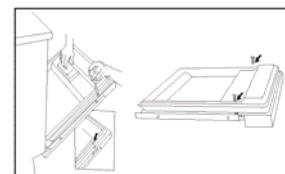

(Fig.9)

Remember to cover the two holes with the plastic plugs removed earlier.

4.5 Adjusting the Door Springs (Fig.10B)

The door must be perfectly balanced. In the factory, the tension of the springs is regulated to ensure that the door is perfectly balanced when light wood door panels are mounted on the door. If heavier, solid wood door panels are used, the door can be balanced by simply turning the two screws (both screws must be turned the same amount) located on the top part of the machine.

4.6 Installation of Continuous Base Moulding

Position the washing machine in the cut-out in the kitchen cabinet:

1. Install the continuous base moulding, following the manufacturer's instructions.
2. Slowly open the door of the dishwasher to check to see if the door strikes or rubs against the base moulding.
3. If so, rest the bottom edge of the panel on the base moulding and mark the part to be cut. Leave at least 3mm of the play between the panel and the base moulding to allow for the door to rotate freely (Fig.11)
4. Remove the base moulding and trim it as needed, protecting the surface that has been cut with a paint or similar wood finish (Fig.11)
5. Install the base moulding again (Fig.12).

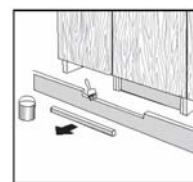
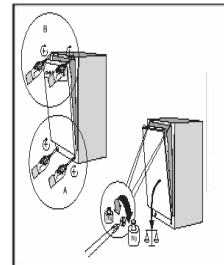

(Fig 11)

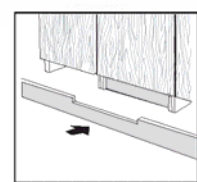

(Fig12)

4.7 How to use water-proof plastic

Firstly take off the water-proof plastic from the sticker with the appliance (see Fig.13). Secondly stick it on the bottom of the kitchen board (see Fig.13). All of this can avoid humidity in the kitchen.

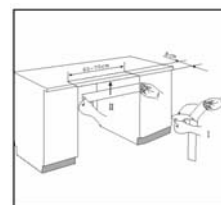

(Fig.13)

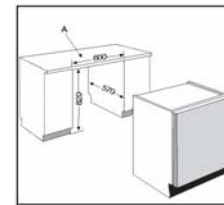

(Fig.14)

4.8 Positioning the Unit within the Cutout (Fig.14)

Push the dishwasher into the cutout opening and turn the feet to make it level and to adjust for height so that the crosspiece (A) for fastening it in place located on the top part of the machine (Fig.14) comes into contact with the counter. Align the door panel mounted on the dishwasher with the doors on the adjacent cabinet (2).

Important:

The dishwasher must absolutely be fastened to the counter top to prevent the machine from tipping when the loaded dish racks are pulled out.

4.9 Adjustment of Back Feet (Fig.10A)

Insert the appliance in the cutout and then adjust the height of the machine using the screws located at the bottom front. Use a screwdriver to turn the screws in a clockwise direction to raise the dishwasher and in an anticlockwise direction lower it.

Notice:

If power screwdrivers are used to make the adjustment, make the final adjustment manually with a normal screwdriver.

4.10 Positioning the Appliance

Position the appliance in the desired location. The back should rest against the wall behind it, and the sides, along the adjacent cabinets or wall. The dishwasher is equipped with water supply and drain hoses that can be positioned on the right or the left to facilitate proper installation.

4.11 Leveling the Appliance

Once the appliance is positioned, adjust the feet (screw them in or out) to level the dishwasher. In any case, the appliance should not be inclined more than 2°. If the appliance is level, it will help ensure proper performance.

4.12 Cold Water Connection

Connect the cold water supply hose to a threaded 3/4(gas) connector and make sure that it is fastened tightly in place (see Fig 1).

If the water pipes are new or have not been used for an extended period of time, let the water run to make sure that the water is clear and free of impurities. If this precaution is not taken, there is a risk that the water inlet can get blocked and damage the appliance.

4.13 Hot Water Connection

The water supply to the appliance can also be connected to the house's hot water line (centralised system, heating system), as long as it does not exceed a temperature of 60°.

In this case, the wash cycle time will be shortened by about 15 minutes and the wash efficiency slightly reduced.

The connection must be made to the hot water line following the same procedures as those for the connection to the cold water line.

4.14 Anti-Flooding Protection

The dishwasher is equipped with a system that stops the supply of water in the event of a problem with the water supply hose, or leaks within the unit, in order to prevent damage to your home. If for any reason the box containing the electrical components happens to get damaged, remove the plug for the appliance from the socket immediately. In order to guarantee that the anti-flooding feature operates properly, the "A" box with water supply hose must be attached to the water supply tap as shown in Fig .1.No other type of connection is acceptable. The water supply hose must not, under any circumstances, be cut, as it contains electrical parts which are live. If the length of the hose is not adequate to make a proper connection, the hose must be replaced with one which is long enough. This hose is available upon request from specialized retailers and service centers.

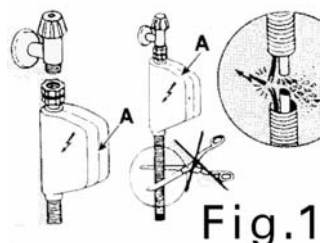

4.15 Drain Hose Connection

Insert the drain hose into a drain pipe with a minimum diameter of 4cm, or let it run into the sink, making sure to avoid bending or crimping it. Use the special plastic support that comes with the appliance (see Fig.2). The free end of the hose must be at a height between 40 and 100 cm and must not be immersed in water.

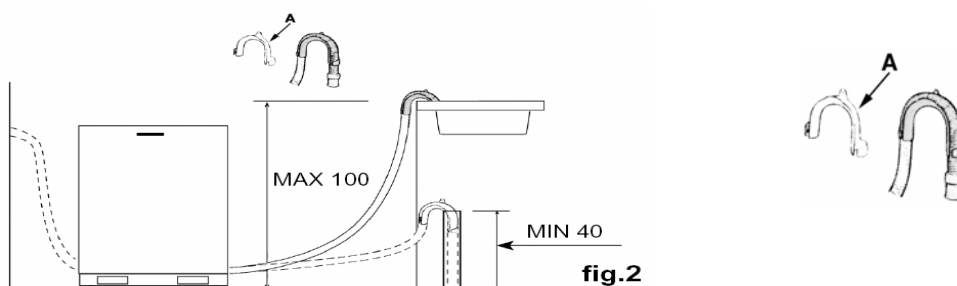

4.16 Electrical Connection

After making sure that the voltage and frequency values for the current in the home correspond to those on the rating plate (located on the stainless steel inner door of the appliance) and that the electrical system is correct for the maximum voltage on the rating plate, insert the plug into an electrical socket which is earthed properly (the earthing of the appliance is a safety requirement mandated by law). If the electrical socket to which the appliance must be connected is not appropriate for the plug, replace the plug, rather than using adaptors or the like as they could cause overheating and burns.

5.Parts and Functions

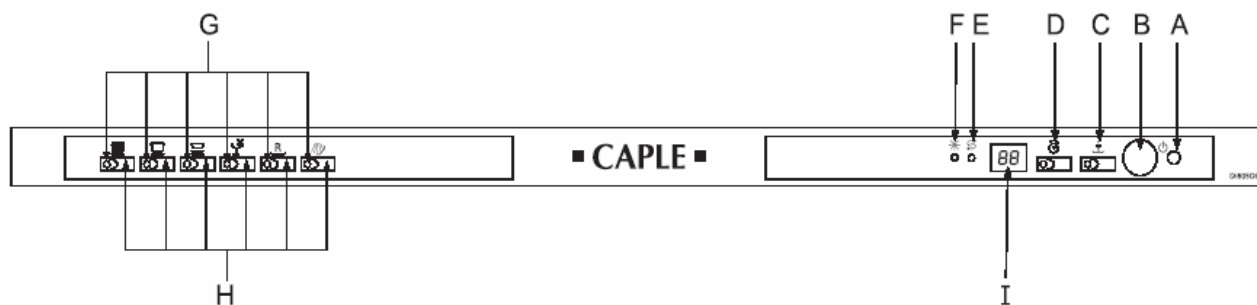

- | | | | |
|---|--------------------------|---|---|
| A | Power indicator light | F | Low rinse aid indicator light |
| B | Power button | G | Cycle indicator light |
| C | 1/2 load button | H | Cycle select button |
| D | Delay select button | I | Display delay time and programme running time |
| E | Low salt indicator light | | |



- | | |
|---|-----------------------------------|
| A | Upper Rack |
| B | Rack Height Adjustor |
| C | Top Spray Arm |
| D | Lower Rack |
| E | Bottom Spray Arm |
| F | Washing Filter |
| G | Detergent and Rinse Aid Dispenser |
| H | Salt Container Cap |
| I | Third Sprayer |

Salt

The hardness of the water varies from place to place. If hard water is used in the shwasher,deposits will form on the dishes utensils.

The appliance is equipped with a special softener that uses a salt specifically designed to eliminate lime and minerals from the water.

Loading the Salt into the Softener

Always use salt intended for use with dishwashers.

The salt container is located beneath the lower rack and should be filled as follow:

- Remove the lower rack and then unscrew and remove the cap from the salt cont
- If you are filling the container for the first time, fill it with water;
- Place the end of the funnel(supplied) into the hole and introduce about 2 kg o small amount of water to come out of the salt container.
- Carefully screw the cap back on.



Adjusting Salt Consumption

The dishwasher is designed to allow for adjusting the amount of salt consumed based on the hardness of the water used. This is intended to optimize and customize the level of salt consumption so that it remains at a minimum.

To adjust salt consumption, proceed as follows:

- Unscrew the cap from the salt container;
- There is a ring on the container with an arrow on it (see figure to the side), If necessary, rotate the ring in the anticlockwise direction from the "-" setting towards the "+" sign, based on the hardness of the water being used.

It is recommended that adjustments be made in accordance with the following scheme:

Water Hardness					
Clarke degrees	'dH	mmol/l	Selector position	Salt consumption (Grams/cycle)	Autonomy (cycles/2kg)
0 ÷ 14	0 ÷ 17	0 ÷ 1,7	/	0	/
14 ÷ 36	18 ÷ 44	1,8 ÷ 4,4	"L"	20	60
36 ÷ 71	45 ÷ 89	4,5 ÷ 8,9	MED	40	40
>71	>89	>8,9	"H"	60	25

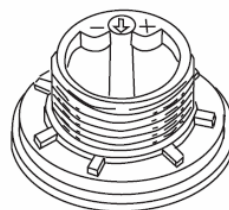

Detergent

Detergent specifically intended for use with dishwashers must be used. The dispenser must be refilled before the start of each wash cycle following the instructions provided in the "Wash Cycle Table." The detergent dispenser is located on the inside panel the door.

Loading the detergent

To open the "A" cover on the dispenser, press the "B" button. The detergent for the wash cycle should be poured into the "C" compartment.

After the detergent has been placed in the dispenser, close the cover and press down until it clicks in place.

Notice: To facilitate closing the cover, remove any excess detergent on the edges of the dispenser.

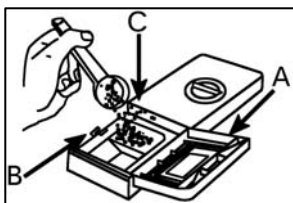

Rinse Aid

This product makes dishes sparkle and helps them to dry without spotting. The dispenser is located on the inside panel of the door and should be filled after every 80 wash cycle (or when the rinse aid indicator light comes on for those models with this feature).

Loading The Rinse Aid

To open the dispenser, turn the "C" cap in the anti-clockwise direction and then pour in the rinse aid, making sure not to overfill. The amount of rinse aid used for each cycle can be regulated by turning the "F" dose adjuster, located beneath the "C" cap, with a screwdriver. here are 6 different settings; the normal dosage setting is 3.

Important

Proper dosage of the rinse aid improves drying.

If drops of water remain on the dishes or spotting occurs, the dosage adjuster should be turned to a higher setting.

If the dishes have white streaks, turn the dosage adjuster to a lower setting.

Before placing the dishes in the dishwasher, remove the larger food debris to prevent the filter from becoming clogged, which results in reduced performance.

If the pots and pans have baked-on food that is extremely hard to remove, we recommend that they be allowed to soak before they are washed. This will eliminate the need for extra wash cycles. Pull out the rack to facilitate loading the dishwasher.

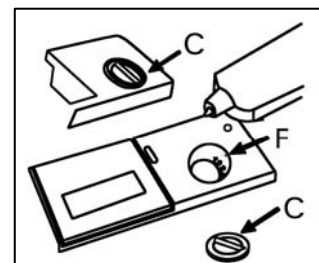

How to Use the Lower Rack

We recommend that you place the most difficult to clean items on the lower rack: pots, lids, serving dishes and bowls, as shown in the figure to the right. It is preferable to place serving dishes and lids on the sides of the racks in order to avoid blocking the rotation of the top spray arm.

- Pots, serving bowls, etc. must always be placed face down.
- Deep pots should be slanted to allow the water to flow out.
- The cutlery basket can be doubled (see fig.A) so that only one section may be used when the cutlery ware load is light. This also makes space for Additional pots and pans, and it can also be placed in the upper rack.
- Cutlery should be placed in the cutlery basket with the handles at the bottom; if the rack has side baskets, the spoons should be placed individually into the appropriate slots. Especially long utensils should be placed in the horizontal position at the front of the upper rack.

How to Use the Upper Rack

The upper rack is designed to hold more delicate and lighter dishware, such as glasses, coffee and tea cups and saucers, as well as plates, small bowls and shallow pans (as long as they are not too dirty).

- Position the dishes and cookware so that they do not get moved by the spray of water.
- The upper rack can be adjusted for height by using the knobs located on the sides of the rack itself (see fig.C).

Shelf

Lean tall glasses and those with long stems against the shelf-not against other items to be washed. Place glasses, cups and small bowls on the additional cup rack. The additional cup rack can be swivelled in or out as required (see fig.D)

Load for 12 Standard Settings

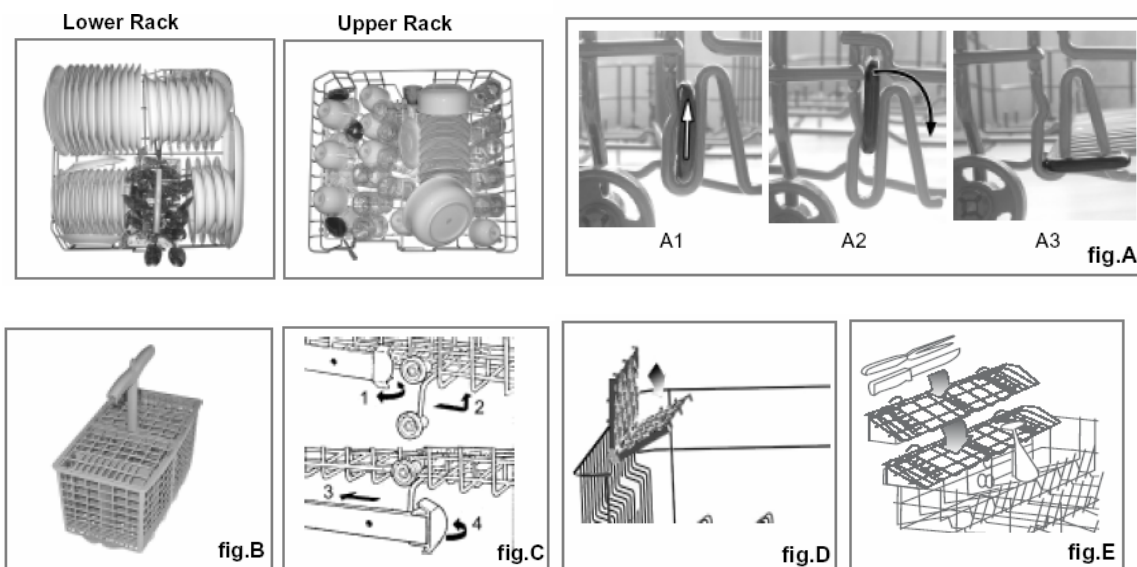

6. Function Schedule

1. Intensive wash

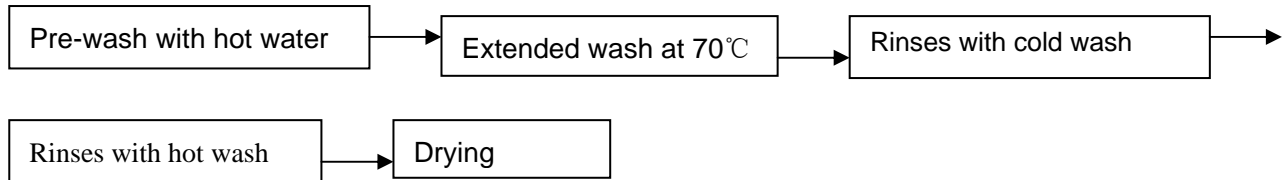

2. Normal wash

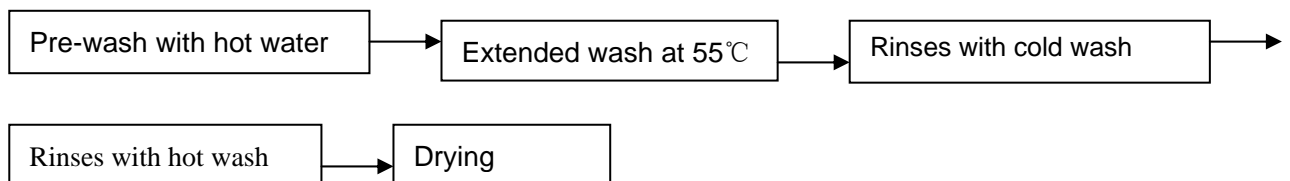

3. Light wash

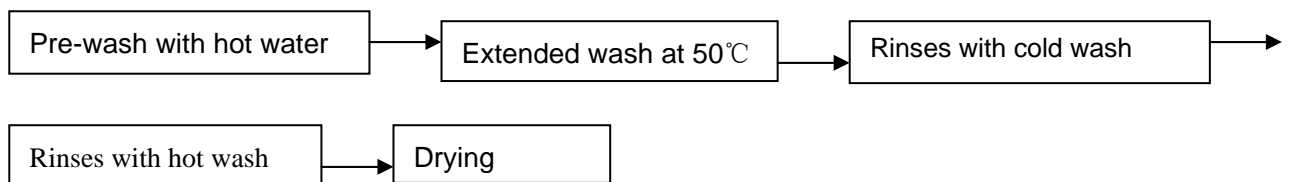

4. Glasses wash

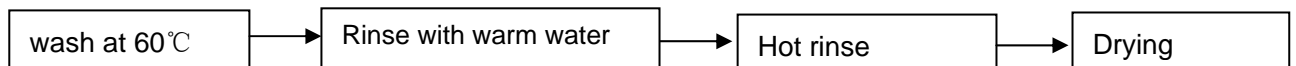



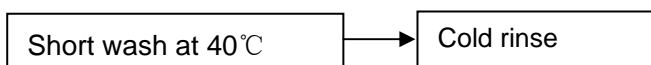

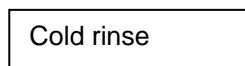

5. Rapid wash



6. Soak



7.Program Diagram

Cycle	Cycle Selection Information	Description of Cycle	Detergent	Rinse Aid
 Heavy Duty	Very dirty dishes, pots and pans. (Not to be used with delicate items)	Pre-wash with hot water. Extended wash at 70°C. Rinses with cold water. Rinse with hot water Drying.	30g	★
 Normal Wash	Normal dirty dishes, pots and pans. Standard daily cycle.	Pre-wash with cold water. Extended wash at 55°C. Rinse with cold water. Rinse with hot water. Drying.	30g	★
 Light Wash (EN50242)	Normal dirty dishes, pots and pans without dried on residue.	Pre-wash with cold water. Extended wash at 50°C. Rinse with cold water. Rinse with hot water Drying.	25+5g	(5) ★
 Glassware	Economic, fast cycle to be used for items which are sensitive to higher. Run immediately after dishes are used.	Wash at 60°C. Rinse with warm water. Hot rinse. Drying.	15g	★
 Rapid Wash	Economic, fast cycle to be used to on not very dirty dishes right after they are used. No drying cycle.	Short wash at 40°C. Cold rinse.	15g	
 Soak	Pre-wash of dishes, pots and pans while waiting for the load to be completed after the subsequent meal.	Short cold wash to prevent food residue from drying on the dishes.		

8.Maintenances Services and Trouble Shooting

8.1 Maintenances Services

It may occur that the dishwasher does not function or does not function properly Before calling for assistance, let us see what can be done first: have you forgotten to press one of the buttons or to perform an essential operation?

8.2 Trouble Shooting

Trouble Shooting Table

Phenome non	Door switch trouble	Water supply trouble	Drain pump trouble	Sensor open circuit	Water overflow trouble
LED2	1	1	1	0	1
LED3	1	1	0	1	1
LED4	1	1	1	1	1
LED5	1	0	1	0	1
LED6	1	0	0	0	0
LED7	1	0	0	0	0
LED8	1	0	0	0	0
beam	√	√	√	√	√

Analysis of the common breakdowns.

Door switch trouble

Phenomenon: the dishwasher does not work

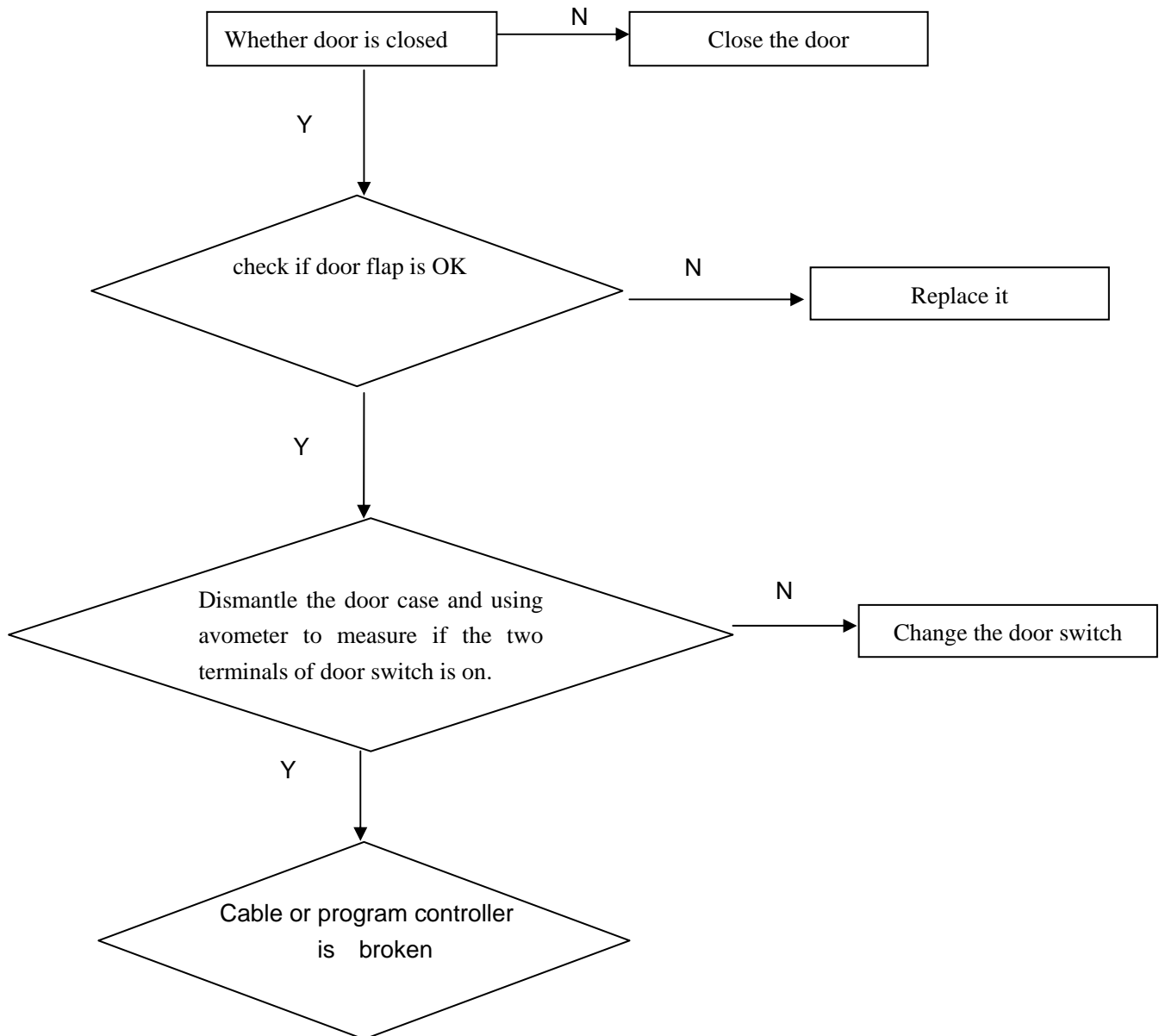

water supply trouble

Phenomenon: water level cannot reach the required location

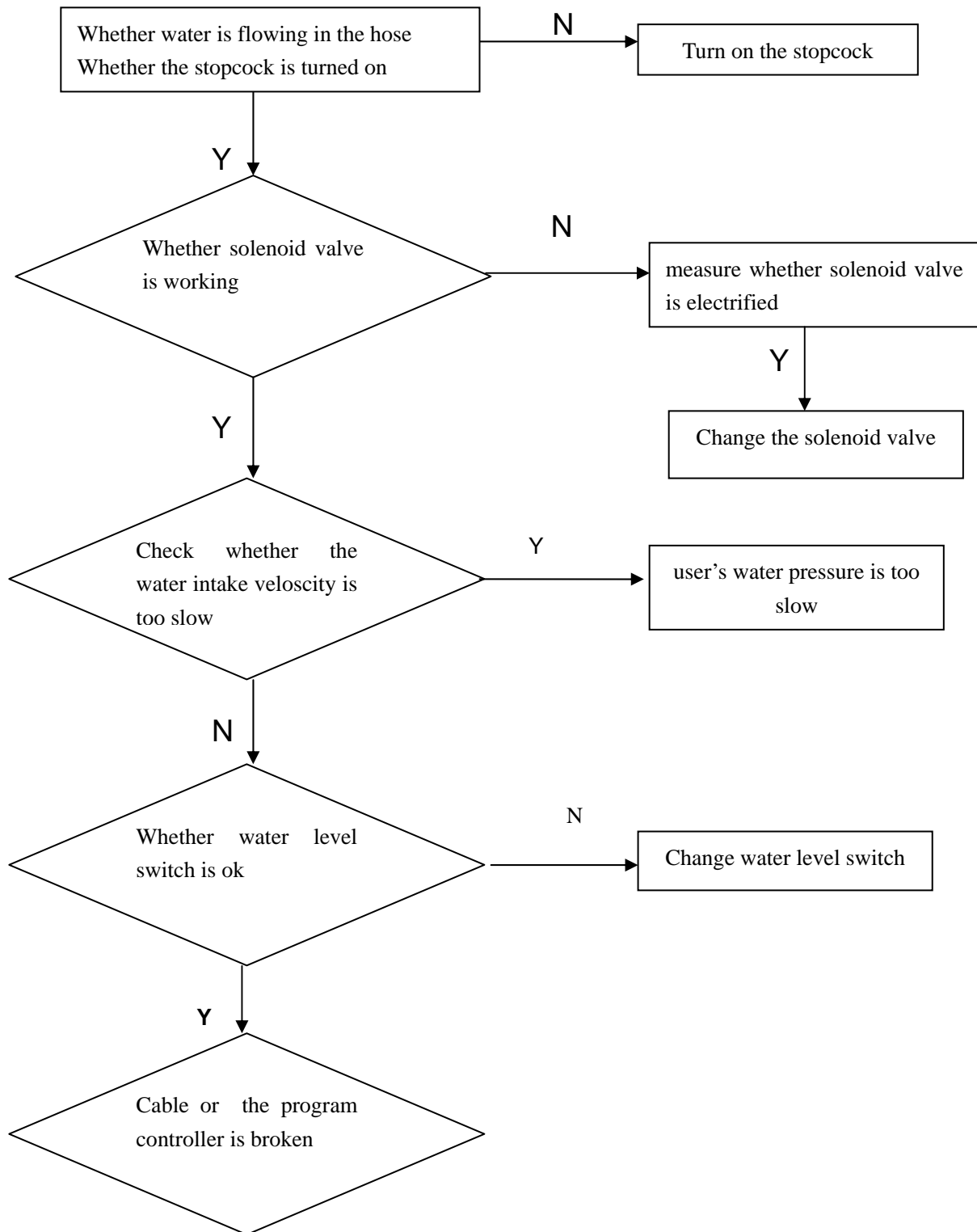

Drain pump trouble

Phenomenon: water cannot be drained

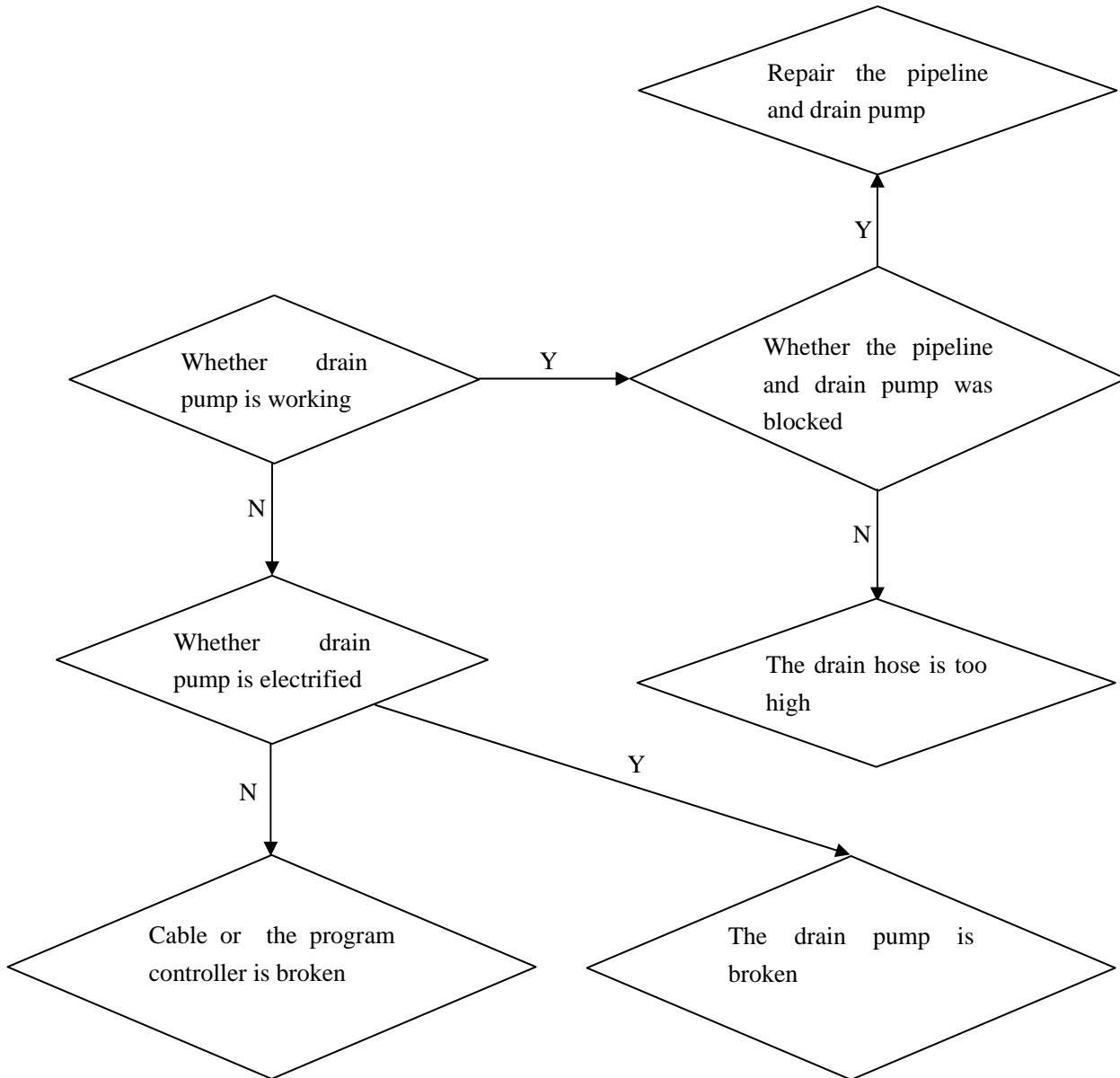

Heating trouble

Phenomenon: program controller stop turning

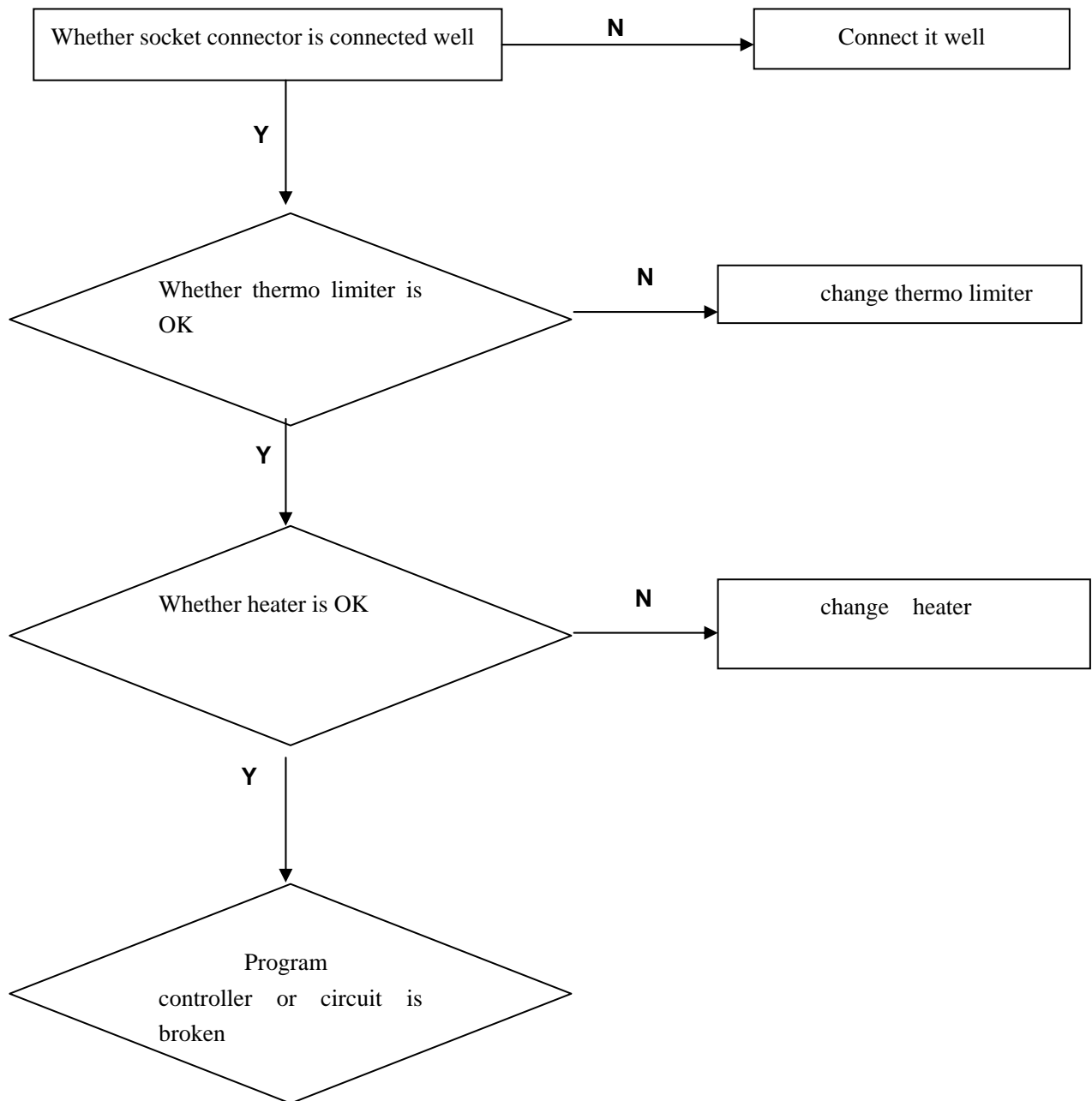

Water overflow trouble

Phenomenon: drain pump keep on working

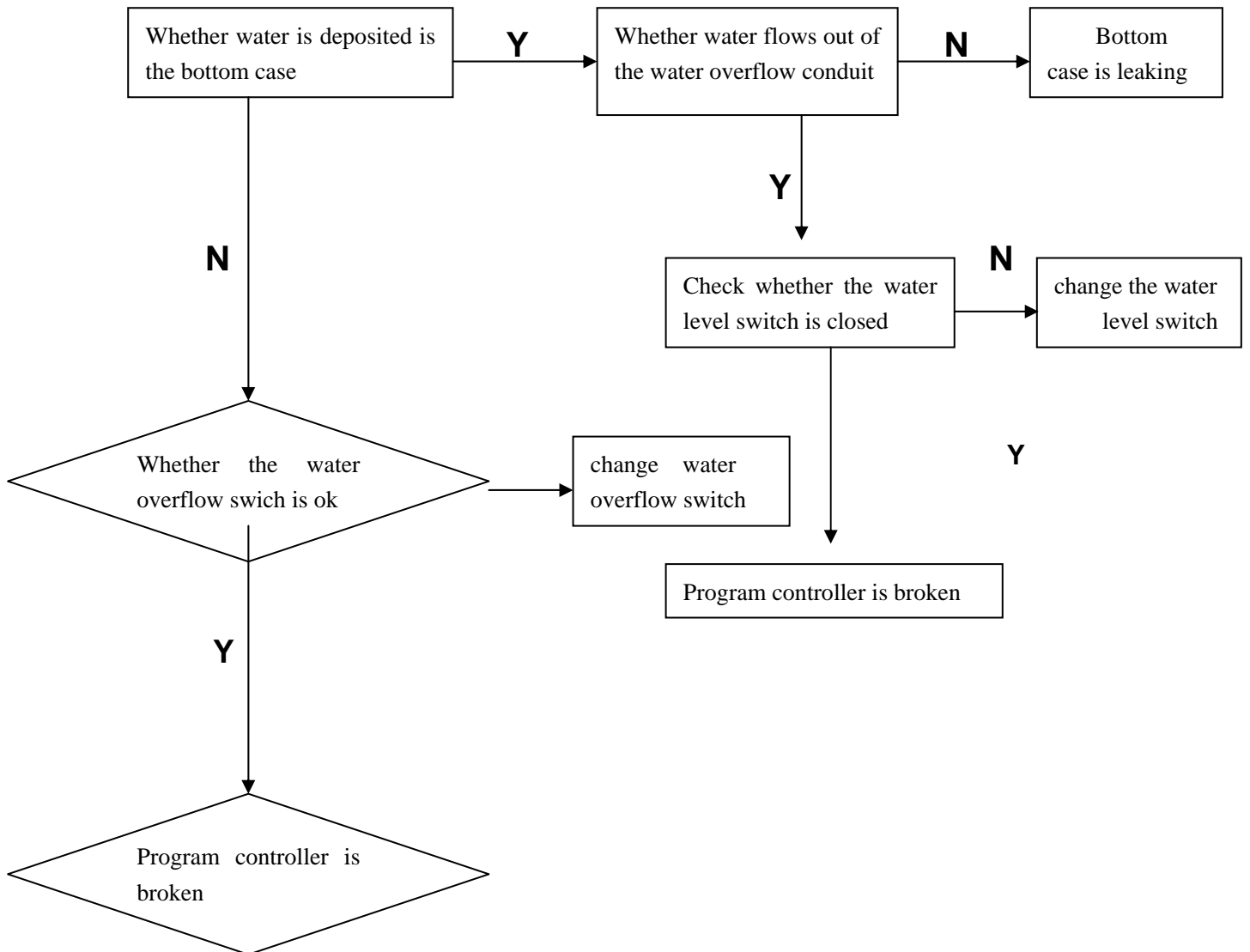

Power supply trouble

Phenomenon: dashwaser cannot work

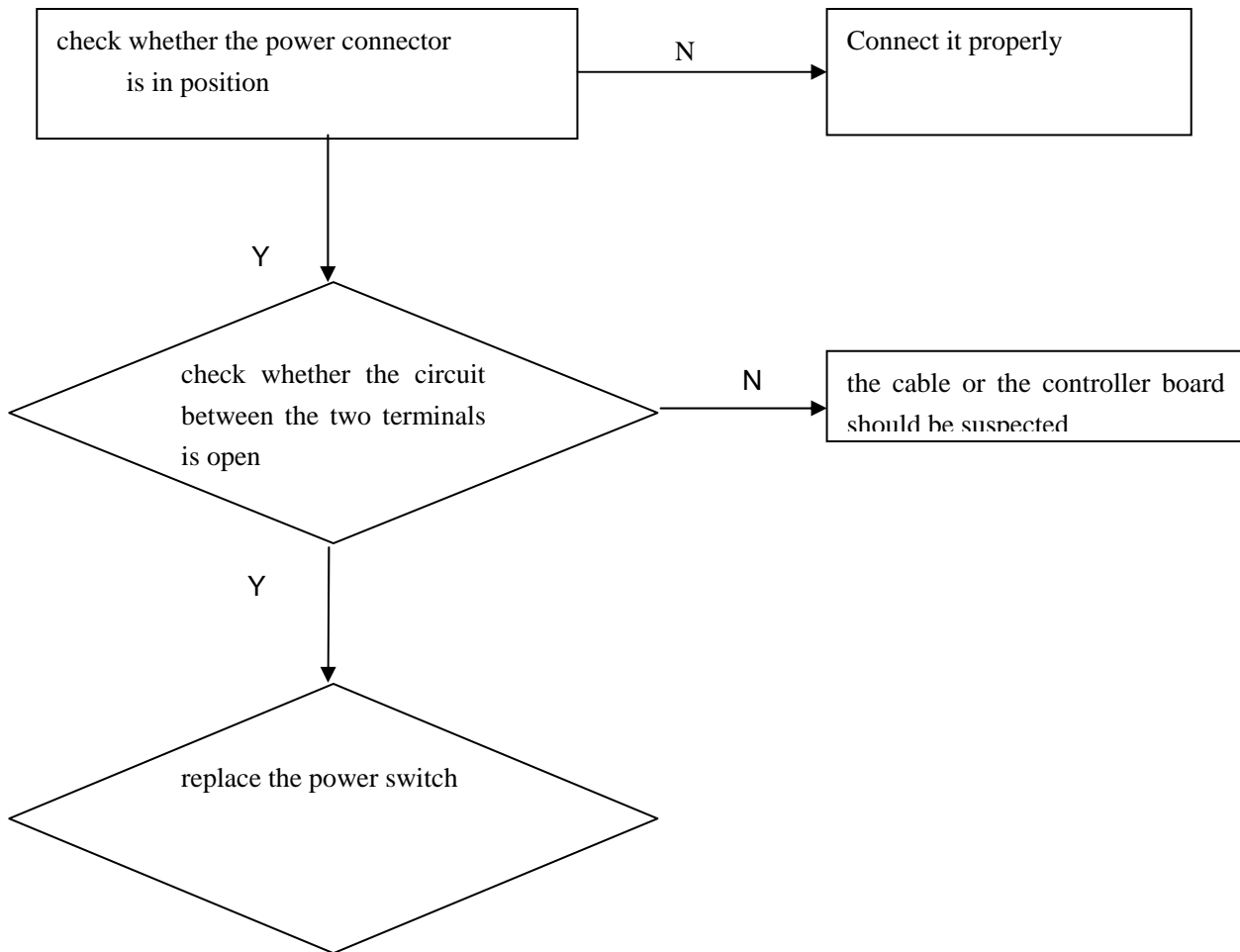

9.Circuit Diagram

