



SO108

Caple Steam Oven 450mm



TECHNICAL INFORMATION



SO108

Caple Steam Oven 450mm

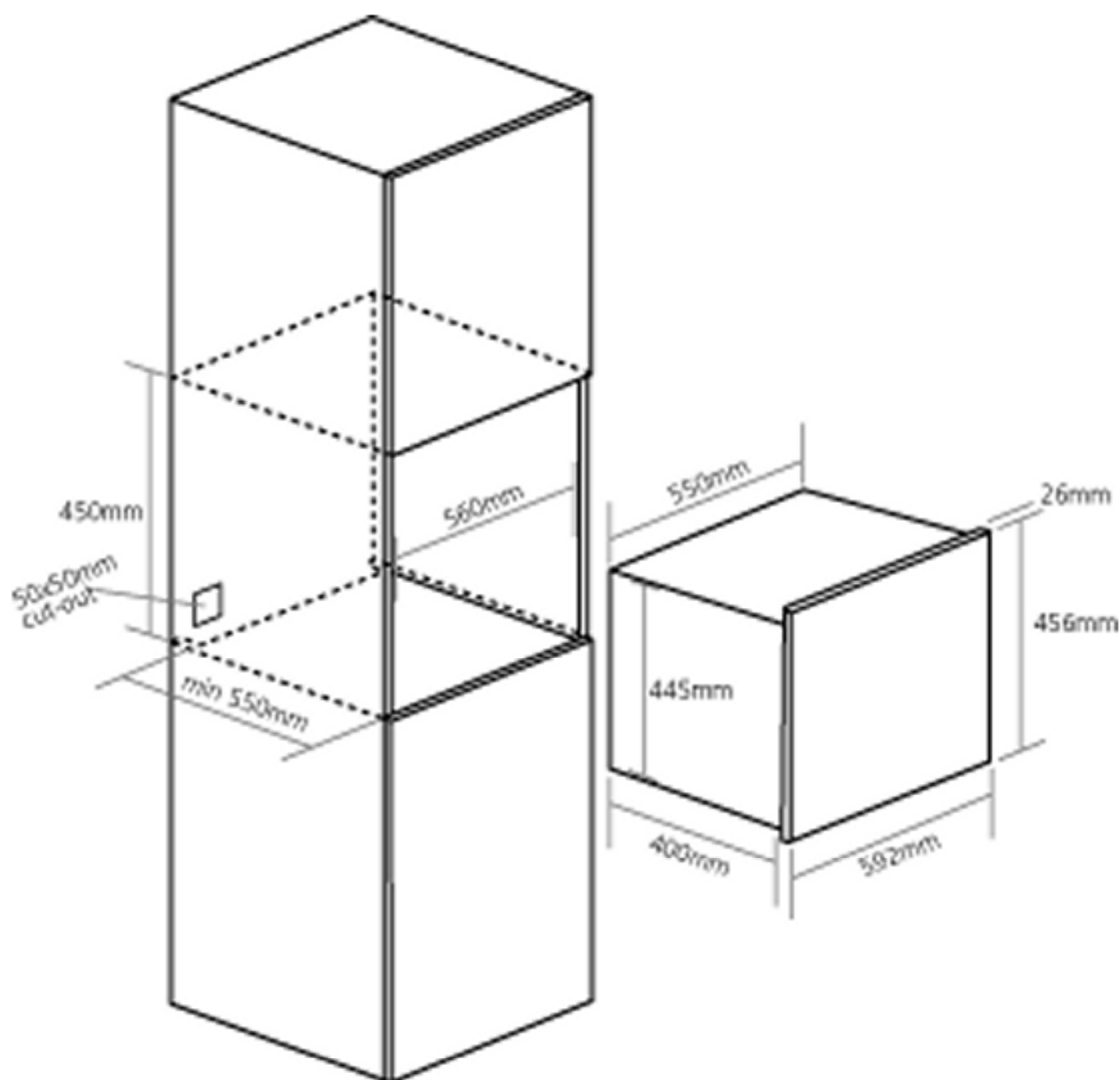

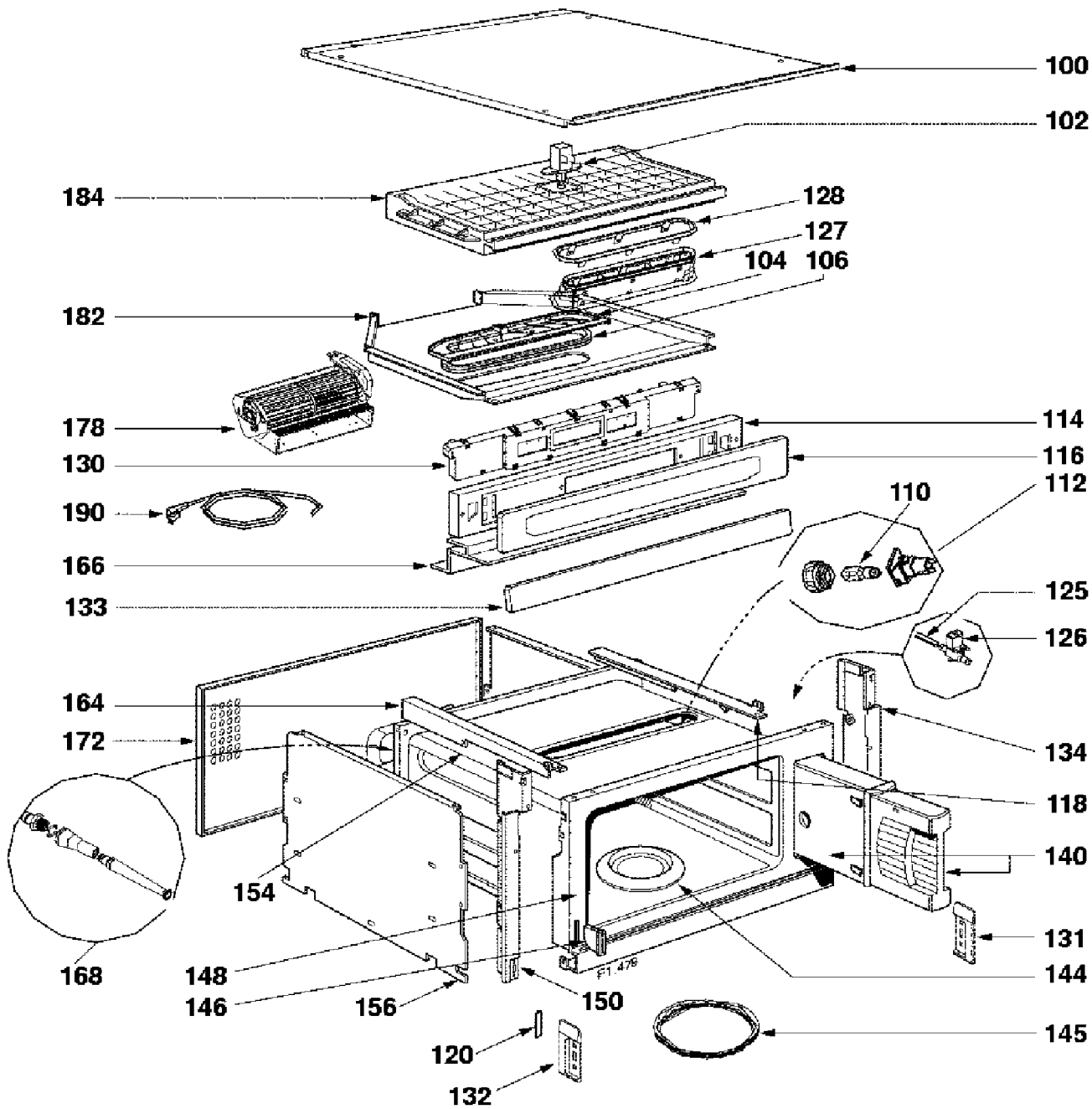

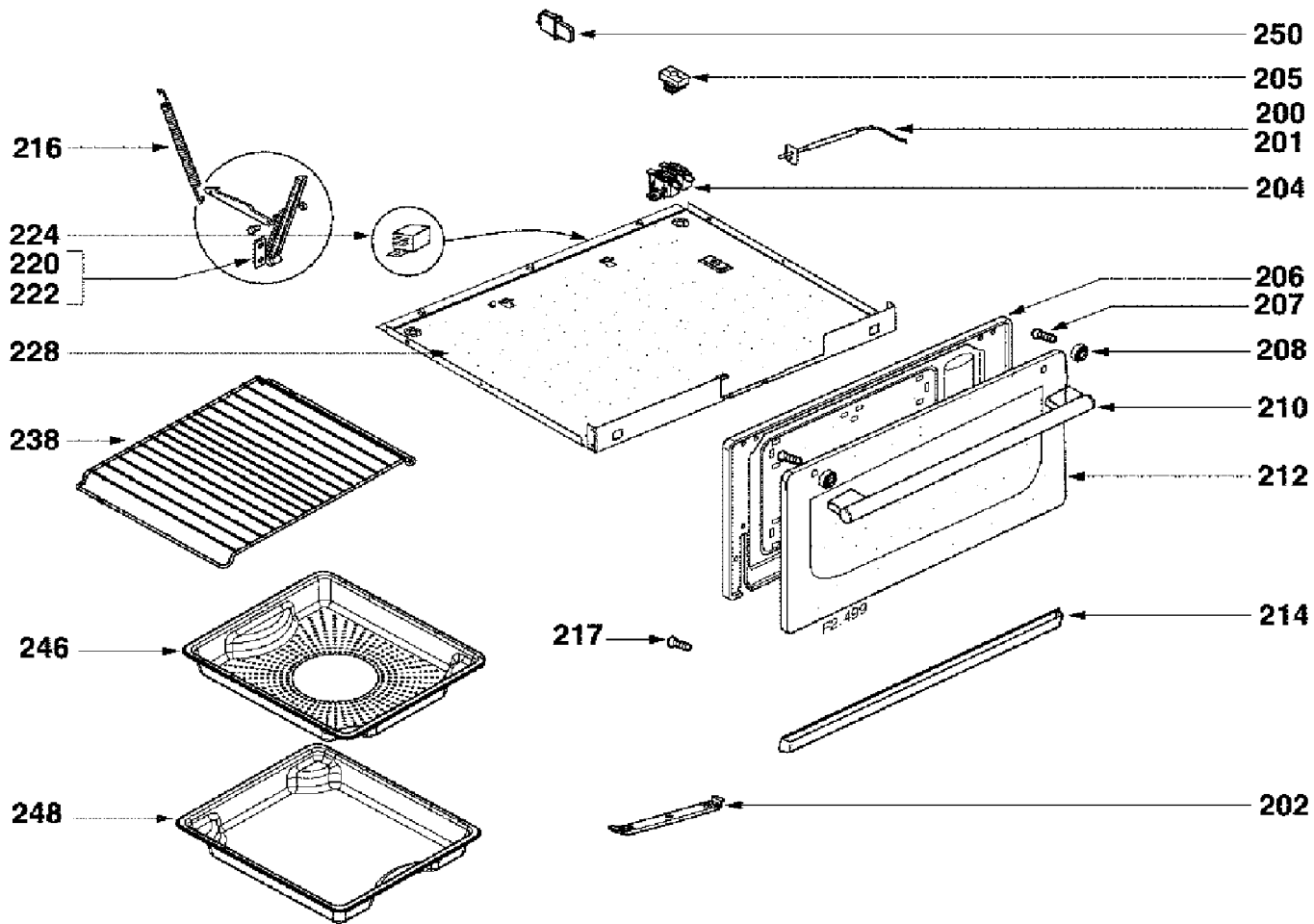



SO108 - Caple Steam Oven 450mm

| Item | Part Code | Description |
|------|-----------|----------------------|
| - | 70X0623 | CIRCUITRY |
| - | 71X0475 | SPRING |
| 100 | 72X6300 | UPPER COVER |
| 102 | 77X3570 | THERMO-ELECT.ACTIVAT |
| 104 | 71X1123 | VALVE |
| 106 | 77X3535 | SEAL, VALVE STEM |
| 110 | 75X1493 | BULB |
| 112 | 77X3573 | LAMP--25W |
| 114 | 72X8128 | STRIP SPT |
| 116 | 70X0782 | STAINLESS STEEL FASC |
| 118 | 74X4870 | RIGHT JACK SUPPORT |
| 120 | 74X9189 | COVER |
| 125 | 74X9204 | PIPE |
| 126 | 74X9199 | SOLENOID VALVE |
| 127 | 72X8132 | FLUE |
| 128 | 72X8133 | COVER |
| 130 | 72X2862 | DISPLAY CARD |
| 131 | 72X8134 | RIGHT HUBCAP |
| 132 | 72X8135 | LEFT HUBCAP |
| 133 | 72X8148 | RAISED SECTION |
| 134 | 72X8131 | RIGHT COLUMN |
| 140 | 74X9200 | TANK |
| 144 | 74X9197 | GENERATOR |
| 145 | 74X9201 | GENERATOR SEAL |
| 146 | 76X5147 | GUIDE |
| 148 | 74X9195 | ST STEEL OVEN-LINER |
| 150 | 72X8130 | LEFT COLUMN |
| 154 | 74X9196 | HEATER MAT |
| 156 | 71X0275 | SIDE, CLADDING |
| 164 | 74X4871 | UPPER LEFT SUPPORT |
| 166 | 72X6306 | DEFLECTOR |
| 168 | 71X2738 | UNION |
| 172 | 71X0274 | REAR COVER |
| 178 | 72X6307 | FASCIA TURBINE |
| 182 | 72X6308 | AIR GUIDE |
| 184 | 72X6309 | AIR GUIDE |



SO108 - Caple Steam Oven 450mm

| Item | Part Code | Description |
|------|-----------|---------------------|
| 190 | 74X0260 | CORD, MAINS |
| 200 | 74X9226 | PROBE, TEMPERATURE |
| 201 | 74X9227 | PROBE, TEMPERATURE |
| 202 | 74X9198 | ATTACHING CLAMP |
| 204 | 74X9240 | LIMITER |
| 205 | 76X7871 | CABLE GRIP |
| 206 | 72X8139 | SHIELD |
| 207 | 74X0901 | HANDLE ATTACH SCREW |
| 208 | 72X9128 | WASHER |
| 210 | 72X6781 | HANDLE |
| 212 | 70X0784 | OUTER DOOR GLASS |
| 214 | 74X8144 | GUTTER |
| 216 | 74X6824 | HOOK SPRING |
| 217 | 94X3588 | SCREW |
| 220 | 74X5557 | LH HINGE |
| 222 | 74X5555 | RH HINGE |
| 224 | 74X9733 | FILTER NOISE |
| 228 | 70X0761 | BOTTOM PANEL |
| 238 | 79X6094 | CAMBERED GRID |
| 246 | 72X5155 | DISH |
| 248 | 72X5154 | DISH |
| 250 | 74X9190 | MICROSWITCH |

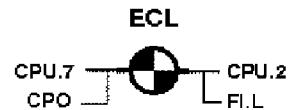
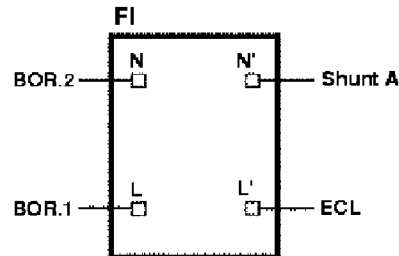
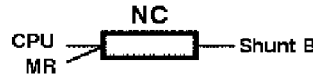
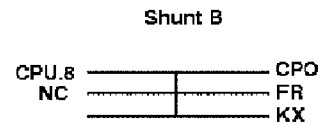
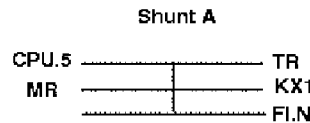
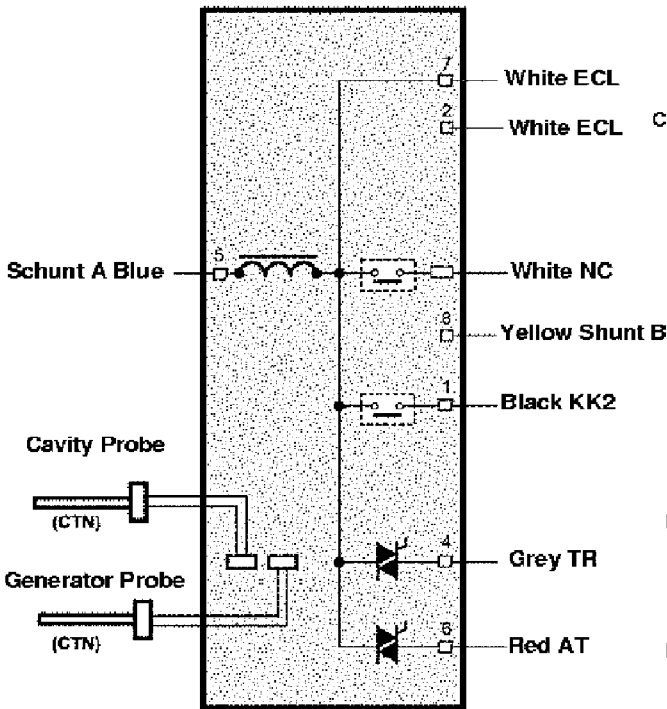
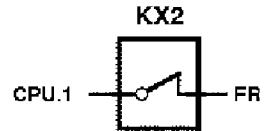
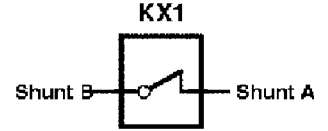
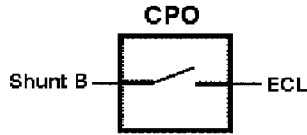
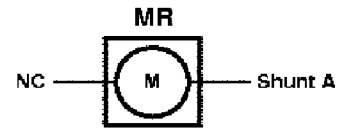
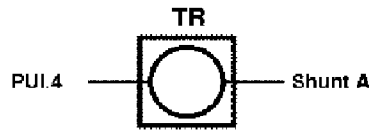
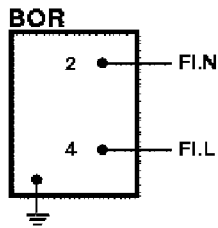

LEGEND

- AT : THERMO-ELECT. ACTIVATOR
- BOR : TERMINAL
- CPU : ELECTRONIC CARD
- CPO : MICROSWITCH
- ECL : LIGHT
- FI : FILTER NOISE
- FR : GENERATOR
- KX : KLIXON
- MR : TURBINE
- NC : HEATING MAT
- TR : SOLENOID VALVE