



WDI2201

Caple Integrated Washer Dryer



TECHNICAL INFORMATION



WDI2201

Caple Integrated Washer Dryer

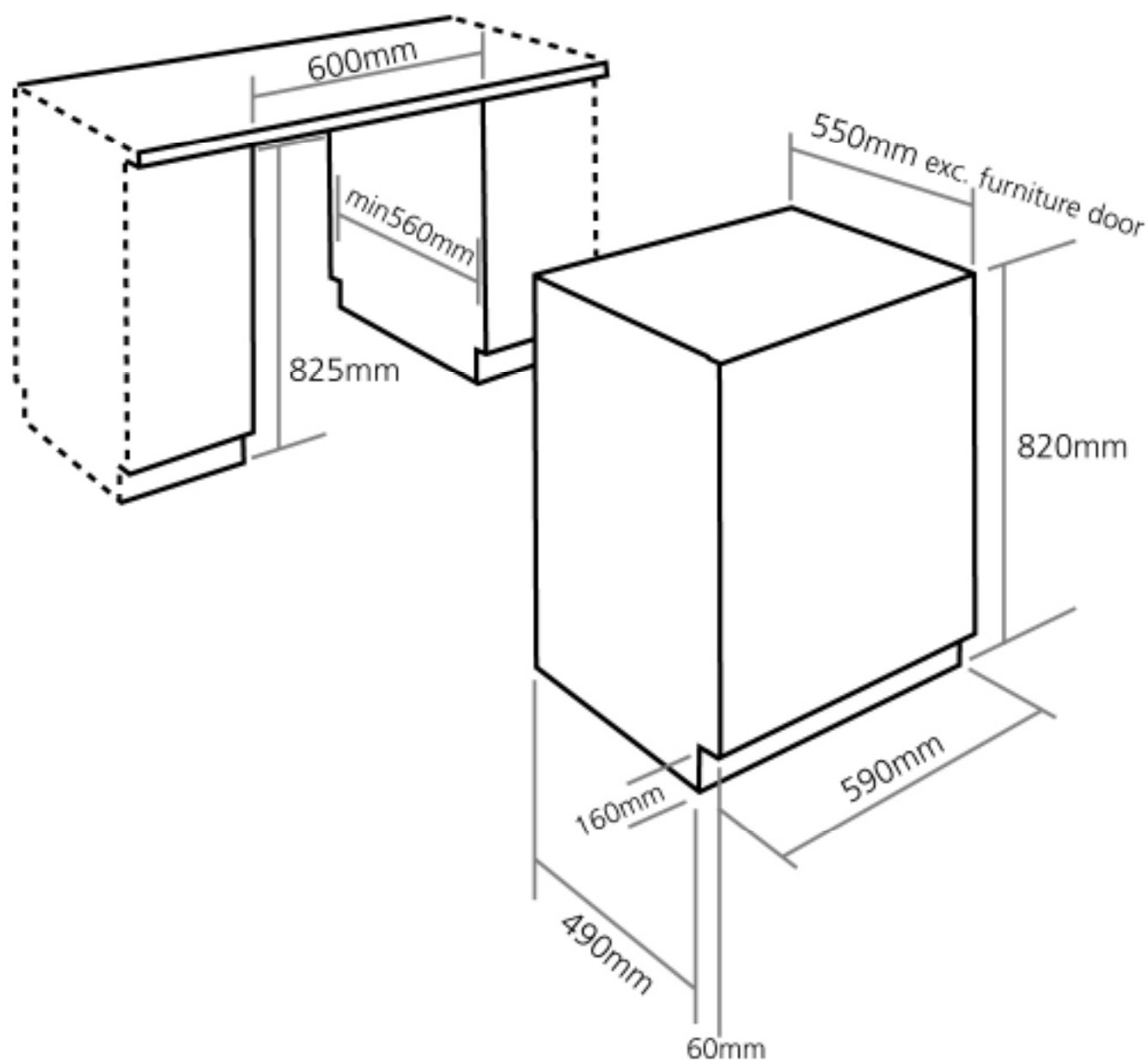

WASHER-DRYER**WDI2201****905473892****CAPLE****TECHNICAL
FEATURES****AFTER SALES SERVICE DATA**

- Operating instructions : -

OVERALL DESCRIPTION

- Date of manufacture : 10/2006
- Standards : CE
- Base frame :
- Capacity : 6 kg
- Colour : White
- Width : 590 mm
- Net weight : 67 kg
- Gross weight : 69 kg
- Drum rotation speed : 50 t/mn
- Spinning : 1100 t/mn

ELECTRICAL DATA

- Supply voltage : 220-240 V
- Frequency : 50 Hz
- Maximum current density : 10 A
- Total electrical power : 3250 W

WATER SUPPLY

- 3 way solenoid valve.

	V1	V2	V3	V4	V5
Flow rate (l/mn)	6,7	6,7			
Ohmic value (Ω)	3700	3700			

DRAIN PUMP

- Electrical power : 30 W
- Flow rate : 16 l/mn
- Ohmic value at 20 °C : 165 Ω

HEATING

- Immersion heater
 - Power : 1850 W
 - Ohmic value at 20 °C : 25,4 Ω

PROGRAMMING

- Power PCB type :
- Programming type :
- Test programme :

DRIVE

- Induction motor : No
 - HS winding value : -
 - Main Auxiliary : -
 - LS winding value : -
 - Brown and yellow : -
 - Green and Yellow : -
 - Brown and Green : -
 - Starting capacitor : -
- Synchronous motor : yes
 - Stator winding value : -
 - Rotor winding value : -
 - Tacho generator :

TEMPERATURE CONTROL

- By a probe temperature > 40 Ω for 20 °C
= 4k Ω for 90 °C

SECURITIES

- Heating
 - thermostat 96°C/-24 °C : Yes
 - A thermal device locks the door during the washing cycle. Its action extends about 2 minutes after the machine has stopped.

PERFORMANCE

Temperatures	Water (l)	Time (mn)	Power (kW)
At 60°C	49	140	-

WDI2201
905473892

CAPLE

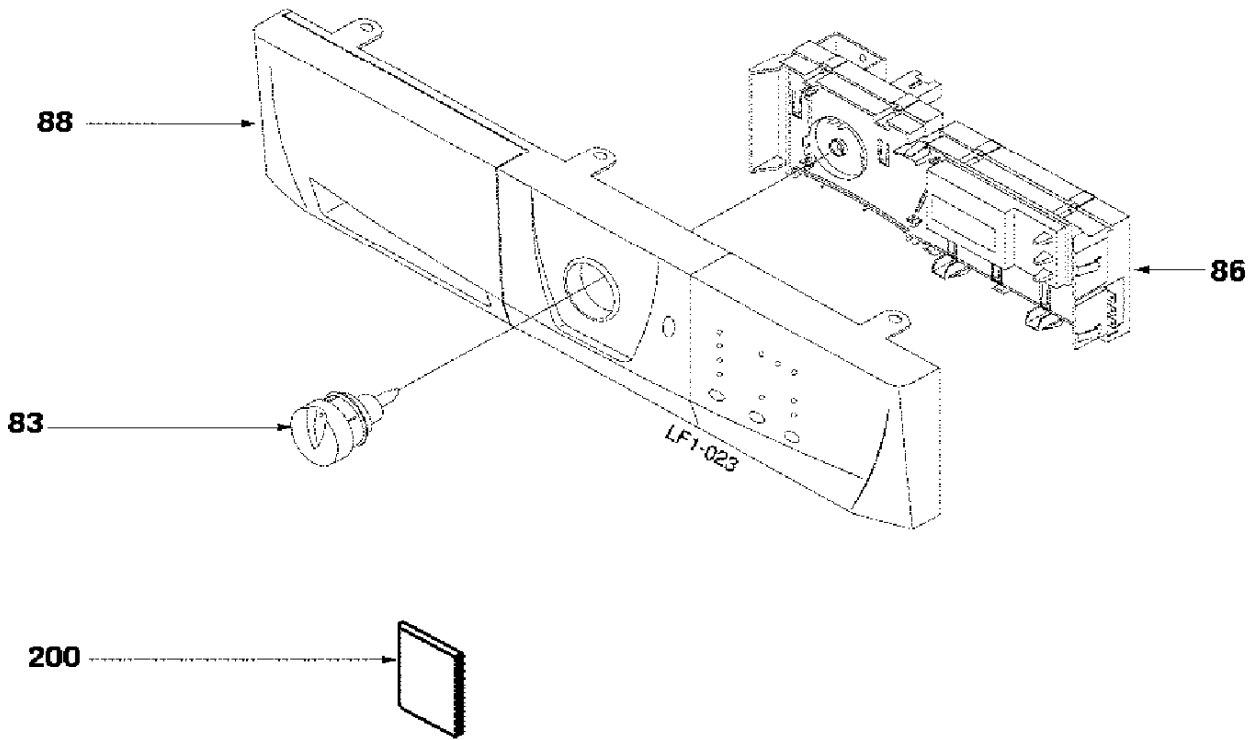

LF1-023

WDI2201
905473892

CAPLE

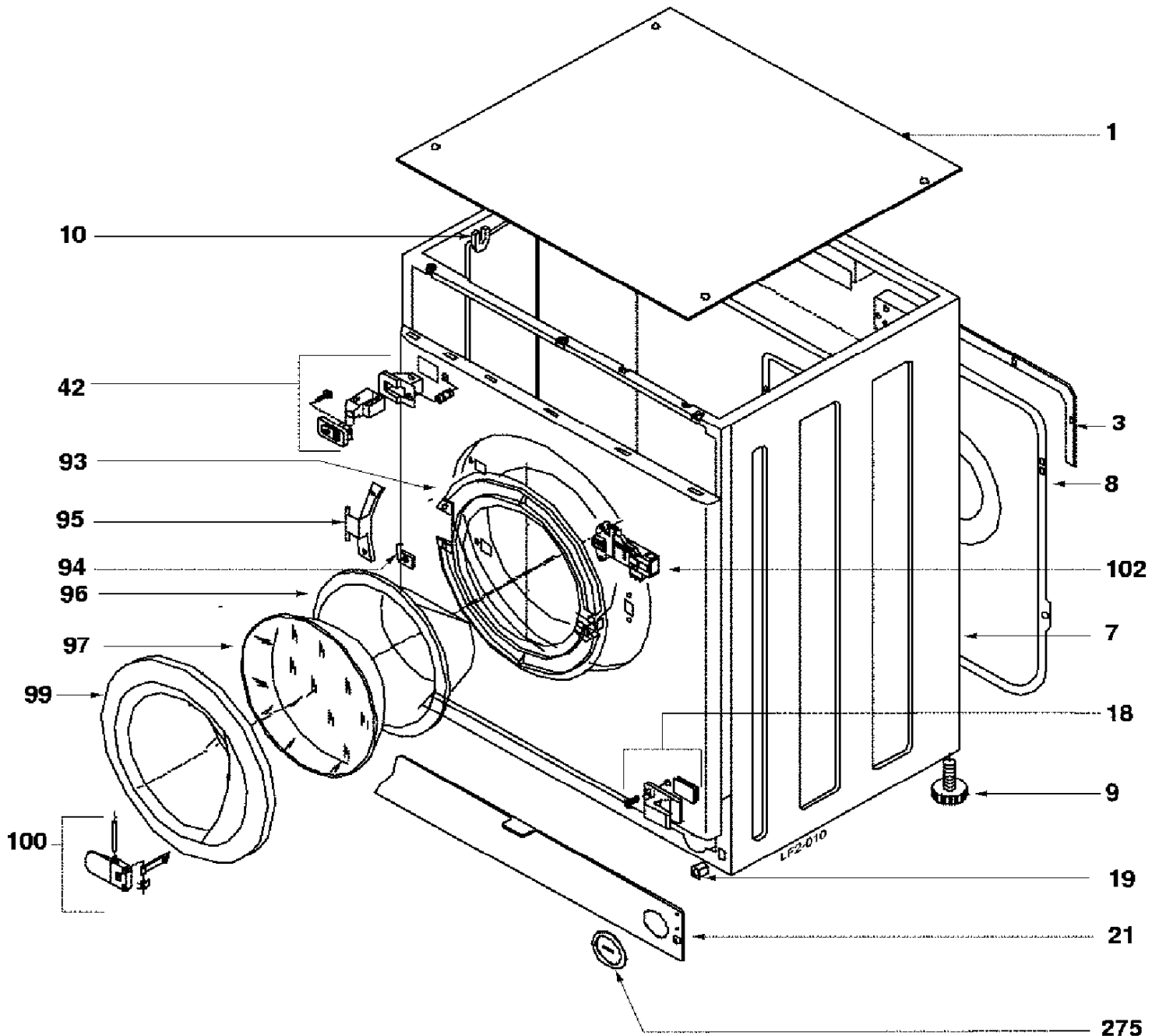

LF2-010

WDI2201
905473892

CAPLE

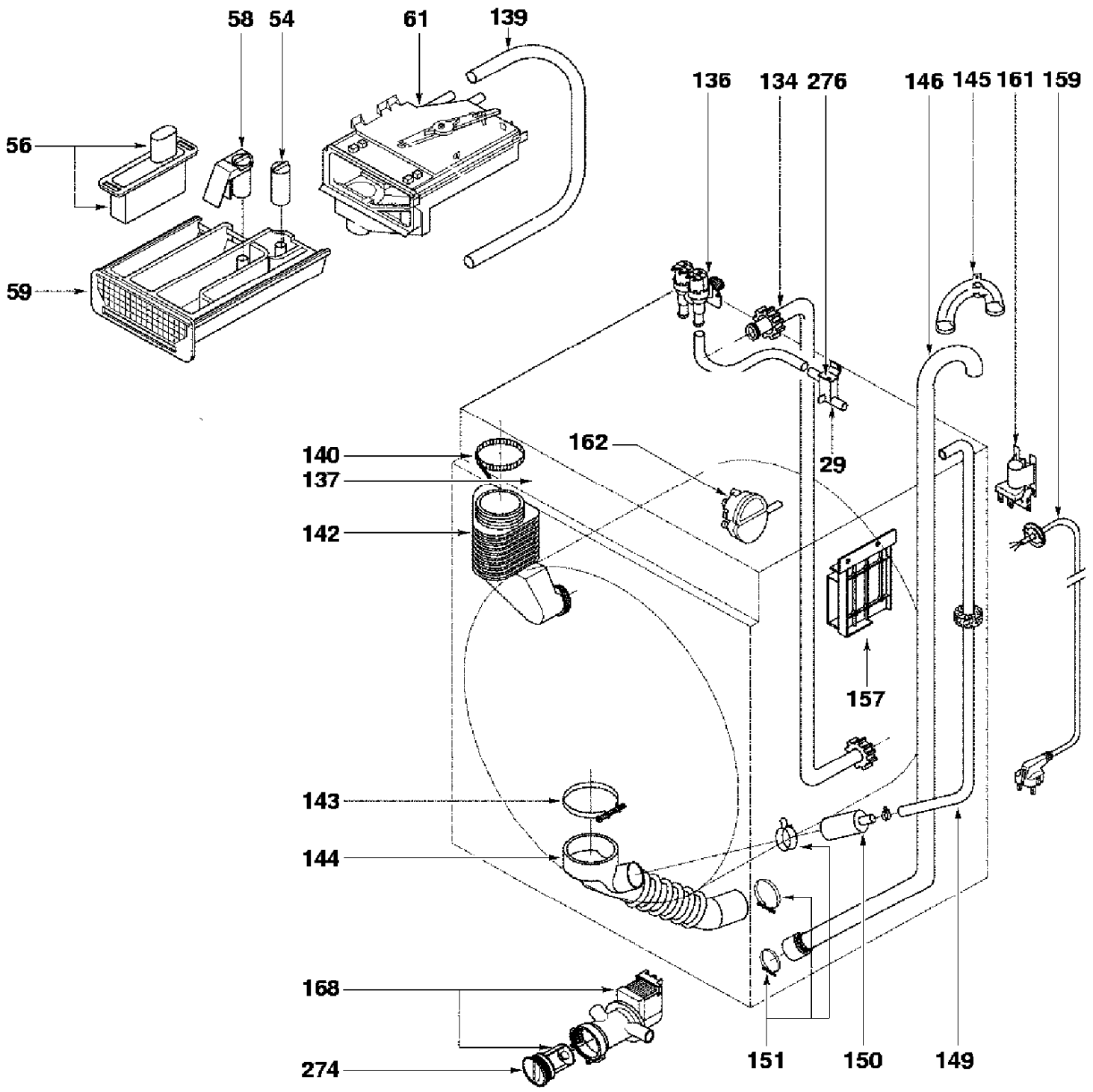

WDI2201
905473892

CAPLE

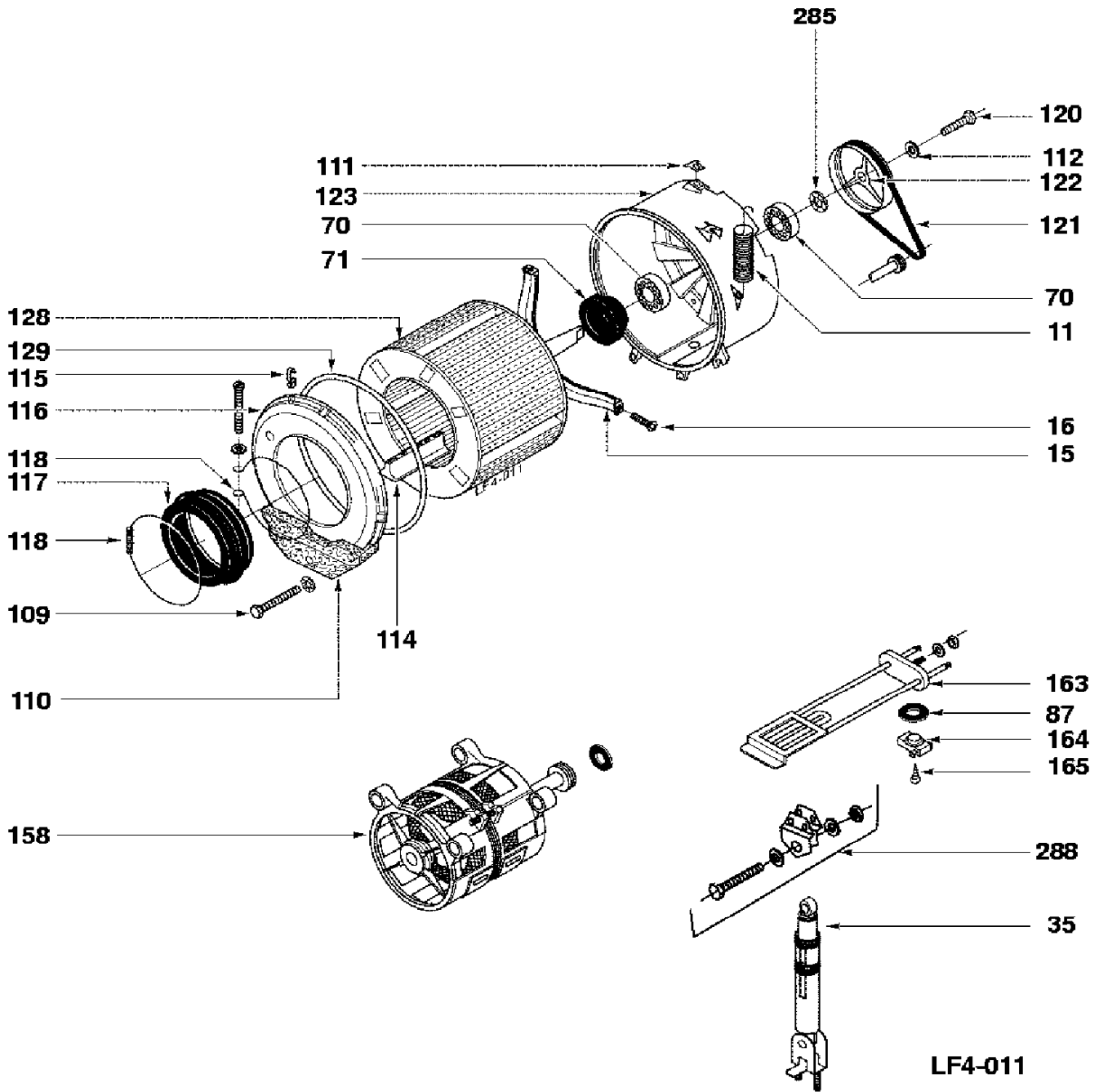

WDI2201
905473892

CAPLE

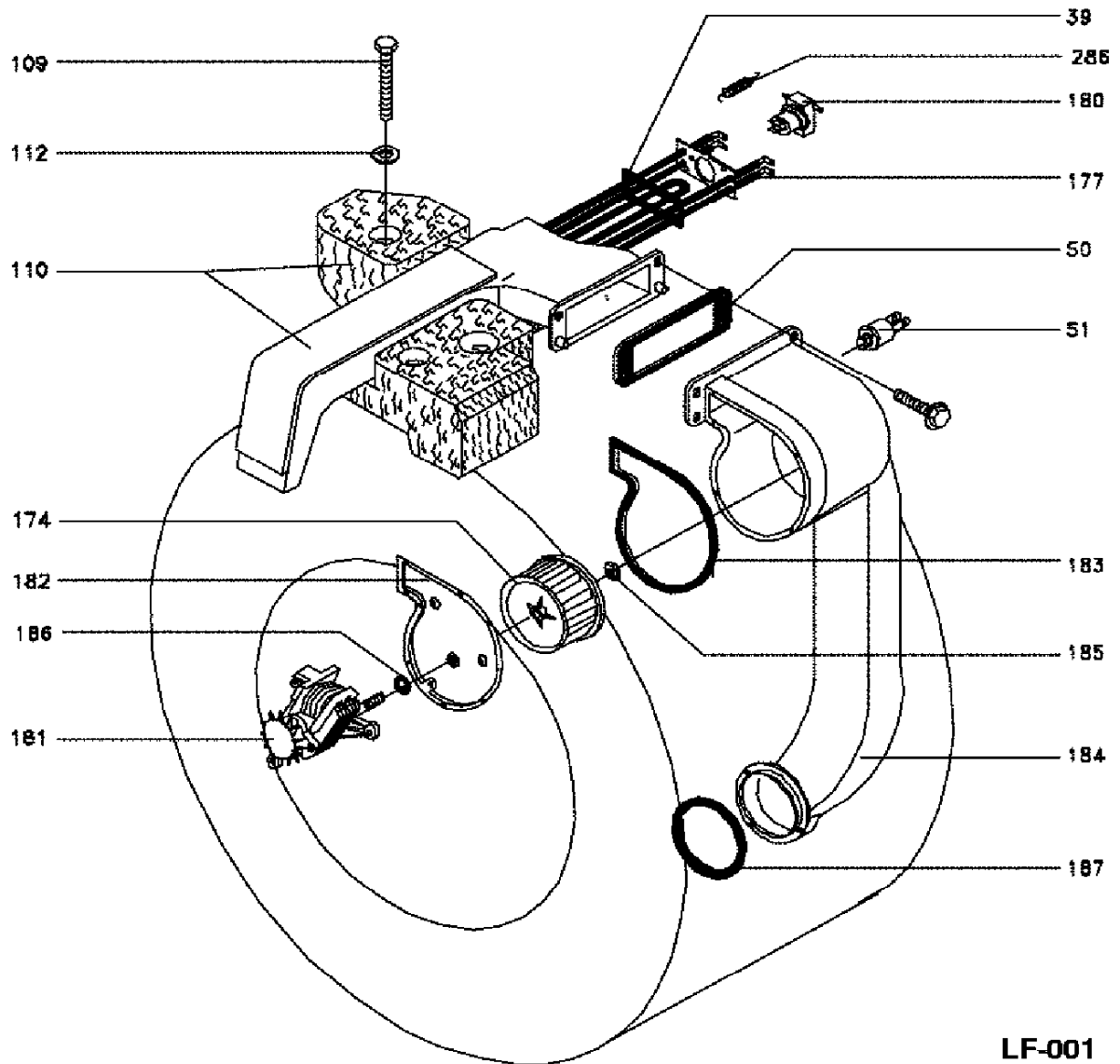

WDI2201
905473892

CAPLE



REP.	REF. SAV	DESIGNATION	REP.	REF. SAV	DESIGNATION
SR	52X2181	GABARIT DE MONTAGE ASSEMBLY JIG	86	52X4622	CARTE DE COMMANDE CONTROL CARD
SR	52X4810	ADAPTATEUR ADAPTER	88	52X5066	BANDEAU DE COMMANDE CONTROL PANEL
83	52X4675	BOUTON PROGRAMMATEUR PROGRAMMER KNOB	200	85X1015	NOTICE D'UTILISATION INSTRUCTIONS FOR USE

WDI2201
905473892

CAPLE



REP.	REF. SAV	DESIGNATION	REP.	REF. SAV	DESIGNATION
1	52X5032	TOLE SUPERIEURE UPPER PANEL	93	52X2170	CONTRE PORTE DOOR BACK
3	55X9888	ENJOLIVEUR ARRIERE REAR TRIM	94	52X1711	RENFORT CHARNIERE R'FORCEMENT, HINGE
7	52X2196	HABILLAGE BLANC WHITE CASING	95	52X2171	CHARNIERE DE HUBLLOT WINDOW HINGE
8	55X9889	TOLE ARRIERE REAR PLATE	96	55X9900	HUBLLOT WINDOW
9	52X0077	PIED REGLABLE ADJUSTABLE LEG	97	52X0207	PROTECTEUR PROTECTOR
10	55X9895	EMBOUT END	99	52X2172	CADRE DE HUBLLOT WINDOW SURROUND
18	52X2153	CHARNIERE DE PORTE DOOR HINGE	100	96X1004	MANETTE CONTROL KNOB
19	52X5064	TAQUET DOG	102	52X0984	SECURITE DE PORTE DOOR SAFETY DEVICE
21	96X1020	PLINTHE PLINTH	275	52X0861	BOUCHON PLUG
42	52X2167	SUPPORT VERROU LOCK SUPPORT			

WDI2201
905473892

CAPLE



REP.	REF. SAV	DESIGNATION	REP.	REF. SAV	DESIGNATION
29	52X0392	CLAPET ANTI-RETOUR VALVE, NON-RETURN	145	32X2912	COUDE BEND
56	52X0010	KIT LESSIVE LIQUIDE KIT, LIQUID DETERGE	146	41X0115	TUYAU DE VIDANGE DRAIN PIPE
58	55X9916	SYPHON SYPHON	149	55X9910	TUYAU PRESSOSTAT PRESSURE SWITCH PIP
59	52X0094	TIROIR A LESSIVE WASHING POWDER DRAWE	150	55X9911	CHAMBRE COMPRESSION COMPRESSION CHAMBER
61	52X0095	BOITE A PRODUITS DETERGENT BOX	151	55X9981	ENS.BLOCAGE TUYAU PIPE LOCKING ASSEMBL
134	55X9904	TUYAU D'ALIMENTATION SUPPLY PIPE	157	52X3665	CARTE DE PUISSANCE POWER CARD
136	52X3664	ELECTROVANNE SOLENOID VALVE	159	52X1971	CORDON SECTEUR CORD, MAINS
137	52X0882	COLLIER FIXATION SKIRT, ATTACHING	161	52X3571	FILTRE ANTIPARASITES FILTER NOISE
139	52X0103	TUYAU ANTI CONDENS. ANTI CONDENSATION PI	162	95X6637	PRESSOSTAT PRESSURE SWITCH
140	96X1722	BRIDE CLAMP	168	52X3572	POMPE DE VIDANGE PUMP, DRAIN
142	52X0206	DURIT BOITE CUVE FLEX HOSE, TUB BOX	274	52X3871	FILTRE FILTER
143	55X9907	COLLIER FIXATION SKIRT, ATTACHING	276	52X0531	CLAPET ANTI-RETOUR VALVE, NON-RETURN
144	52X1120	DURIT CUVE/POMPE PUMP TANK HOSE			

WDI2201
905473892

CAPLE



REP.	REF. SAV	DESIGNATION	REP.	REF. SAV	DESIGNATION
11	55X9941	RESSORT SUSPENSION TANK SUSPENS.SPRING	117	96X0349	JOINT HUBLOT SEAL, WINDOW
15	52X2601	CROISILLON AVEC AXE SPIDER WITH PIN	118	55X9946	COLLIER FIXATION SKIRT, ATTACHING
16	55X9969	VIS FIX.CROISILLON TORX 8X39 CROOS BAR FIX. SCREW TORX 8X39	120	55X9954	ECROU NUT
35	52X0093	AMORTISSEUR 120 SHOCK ABSORBER 120	121	52X0032	COURROIE 1184J5 BELT 1184J5
70	52X0883	ROULEMENT BEARING	122	52X0033	POULIE TAMBOUR DRUM PULLEY
71	55X9980	BAGUE D'ETANCHEITE 800/1000 SEALING BUSH 800/1000	123	52X0217	CUVE TUB
87	55X9930	JOINT DE THERMOSTAT THERMOSTAT SEAL	128	52X1299	TAMBOUR DRUM
109	52X0210	VIS FIX.LEST BALLAST FIX. SCREW	129	55X9987	JOINT FLANC DE CUVE SEAL TUB SIDE
109	55X9970	VIS LEST SUPERIEUR UPPER BALLAST SCREW	158	52X0035	MOTEUR 1250RPM MOTOR 1250RPM
110	55X9936	LEST FRONTAL FRONT-END BALLAST	163	52X2180	THERMOPLONGEUR IMMERSION HEATER
111	55X9939	PLAQUE DE FIXATION ATTACHMENT PLATE	164	52X1684	SONDE DE TEMPERATURE 96°C/50°C PROBE, TEMPERATURE 96°C/50°C
112	57X1833	RONDELLE WASHER	165	57X1832	VIS SCREW
114	52X1298	OMEGA 22 CM OMEGA BRACKET 22 CM	285	52X0864	RONDELLE 45L WASHER 45L
115	55X9953	CLIPS = X1 CLIP = X1	288	52X1300	ETRIER BRACKET
116	52X1311	COUVERCLE DE CUVE COVER, TANK			

WDI2201
905473892

CAPLE



REP.	REF. SAV	DESIGNATION	REP.	REF. SAV	DESIGNATION
39	52X0363	JOINT RESIST. VOUTE HEATING ELEM. GASKET	180	52X3877	THERMOSTAT THERMOSTAT
50	52X0364	JOINT RAMPE DE SECH. SEAL, DRYING RAMP	181	52X1312	MOTEUR MOTOR
51	52X0365	THERMOSTAT SECHAGE 80° DRYING THERMOSTAT 80°	182	52X0357	PLAQUE DE FIXATION ATTACHMENT PLATE
109	52X0210	VIS FIX.LEST BALLAST FIX. SCREW	183	52X0359	JOINT CONDUIT D'AIR AIR DUCT SEAL
109	55X9970	VIS LEST SUPERIEUR UPPER BALLAST SCREW	184	52X0358	CONDUIT D'AIR VENTILATION SHAFT
110	52X1707	LEST SUPERIEUR C'WT., UPPER	185	52X0360	ECROU DE TURBINE NUT, TURBINE
112	57X1833	RONDELLE WASHER	186	52X0361	BAGUE RING
174	52X0353	TURBINE VENTILATION TURBINE	187	52X0362	JOINT CONDUIT D'AIR AIR DUCT SEAL
177	52X0354	RESISTANCE SECHAGE DRYING RESISTOR	286	52X0366	RESSORT DE FIXATION FIXING SPRING

This document is intended for all persons rendering technical support services (T.S.S.). It is designed to facilitate the repair of the product described. It provides documentary support for technical consultations.

This manual contains notes warning about safety issues:

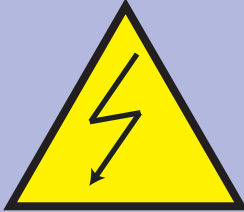

Electrical hazard: This identifies potential risks for the product. Such risks may cause permanent damage to the product



Warning: This identifies information or circumstances that may cause personal injuries or death.



Important: This identifies information that is critical for a correct understanding of the product.

© Copyright by Fagor Electrodomésticos S.Coop. 2006. All rights reserved. The total or partial reproduction of this document, by any procedure and on any type of media, is prohibited without written authorisation from the holder of the usage rights. Breach of this copyright will be pursued in conformity with applicable legislation and may lead to criminal charges.

FAGOR ELECTRODOMESTICOS reserves the right to introduce, without prior notification, any modifications to the characteristics of its manufactured products.

1.- Warnings and precautions	1
2.- Features	2
3.- Description of operation.....	4
3.1.- General description	4
3.1.1.- Start-up	5
3.1.2.- Locking.....	6
3.1.3.- Extra rinse	6
3.1.4.- Flot/Anti-crease	7
3.1.5.- Programme progress	7
3.1.6.- Power failure	8
3.2.- Diagram of drying function	9
3.3.- Programme table.....	10
3.4.- Components.....	11
3.5.- Circuit configuration	14
3.6.- Troubleshooting.....	16
3.6.1.- T.S.S. Programme.....	16
3.6.2.- Safety mechanisms and criteria	17
3.6.3.- Imbalance detection	18
3.6.4.- Operation in case of imbalance	19
3.7.- Assembly and disassembly instructions.....	23
3.8.- Diagrams and drawings	25

1.- Warnings and precautions

The maximum recommended amount of clothes to be dried is the equivalent of 1.5 kg dry weight of delicate fabrics, and 2.5 kg dry weight of other fabrics. Therefore, if a full load of clothes is washed, and is then to be dried, this load must be divided into two loads for drying.

Putting in excessively delicate articles such as curtains, woollens, silk, or items which contain materials such as foam rubber or similar materials is not recommended.

To prevent drying after the wash, set the drying timer in the Stop position.

Drying

The drying is carried out by hot air circulating in a closed circuit system and steam condensation by mains water cooling.

It is therefore important that the water inlet tap remains open.

Simultaneously, the drainage pump starts up at regular intervals throughout the whole of the drying process to remove the cooling water together with that resulting from condensation.

For the last few minutes of the drying cycle, the circulating air is not heated. This allows temperatures inside to balance out, thus preventing wrinkle formation. Interrupting this final timing is not recommended.

The time required for drying depends on the size and type of fabric, and the size of the load.

3.- Description of operation

3.1.- General description

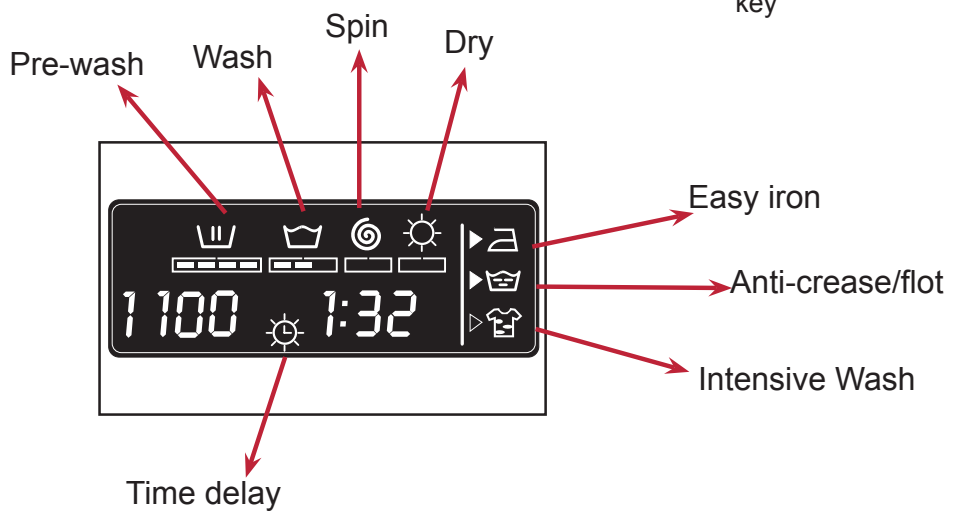
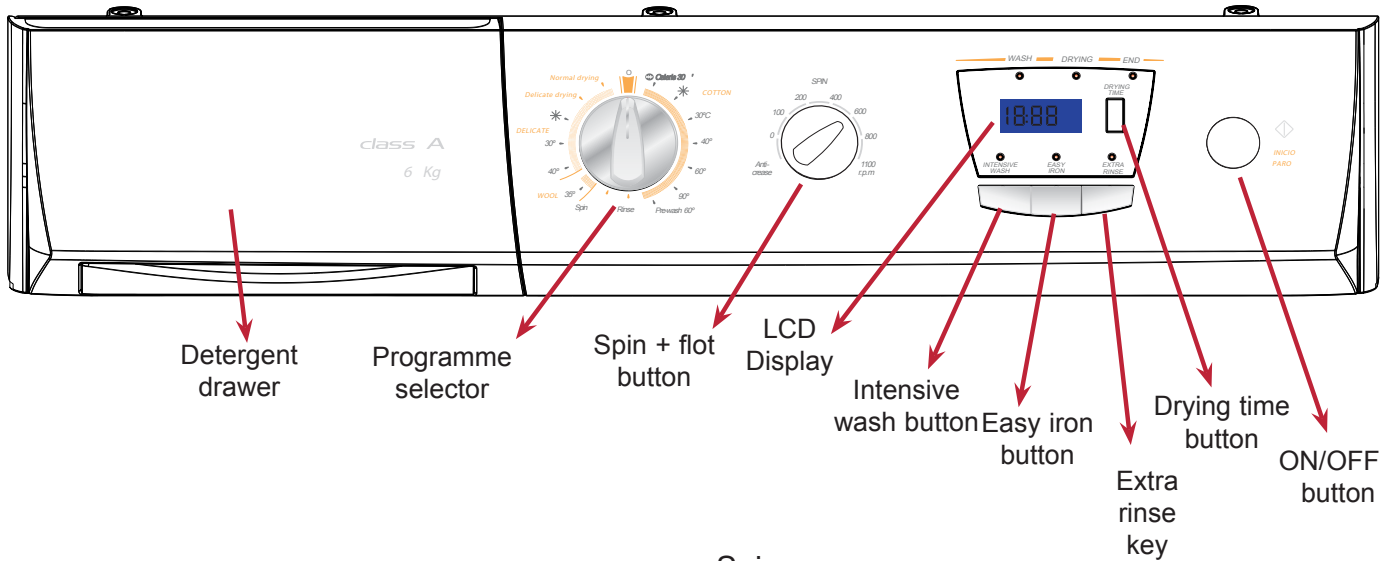
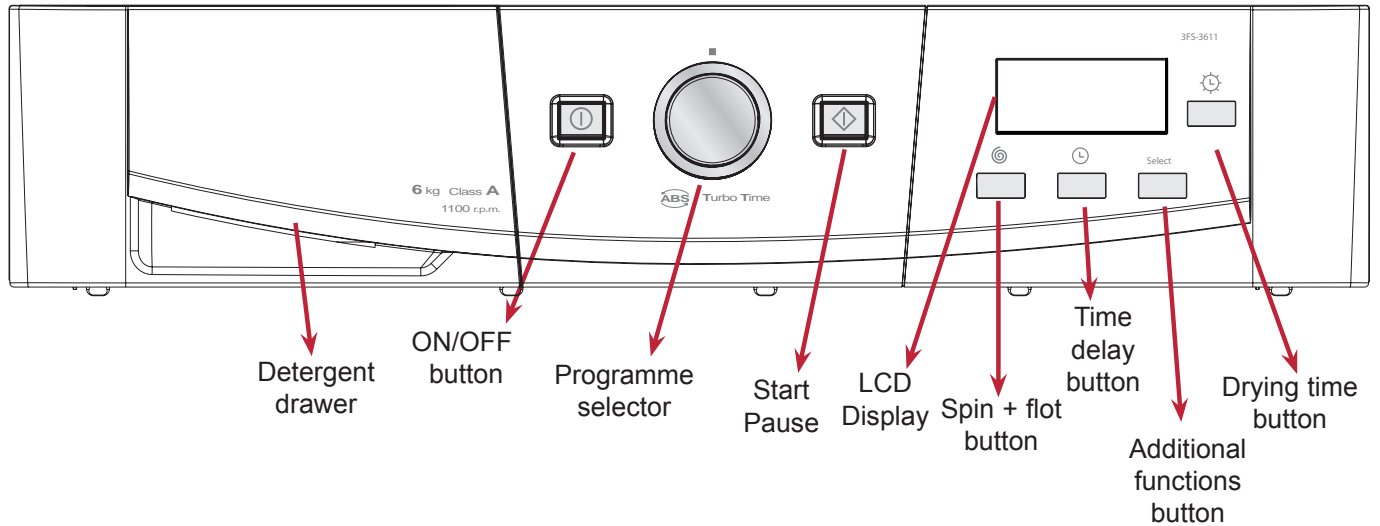

2.- Features

The wash options must always be selected after selecting the wash programme. Any change of programme during the selection annuls the options which were previously selected.

- a) Spin selection and anti-crease (flot) button. The selected programme has an associated spin speed.
- b) This can be modified by pressing the spin button repeatedly - the spin speed in revolutions will decrease by 100 each time until 400 is reached.
- c) Skip spin option. Press the spin button once more to reach the skip spin option. This programme, without a final spin, is used to prevent creases from forming when washing special fabrics
- d) Option: flot/anti-crease. This stops at the final rinse, leaving the clothing floating in water. When the function is deactivated, the washer continues the programme, draining and spinning. This is used when you are not at home, for example, to delay the spin until you have arrived so that creases are not caused by the clothes being spun and then left in the drum.

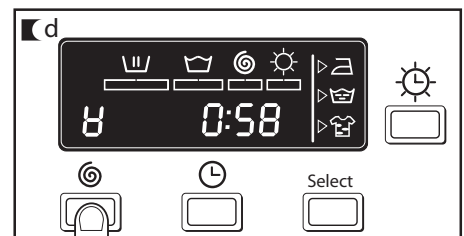
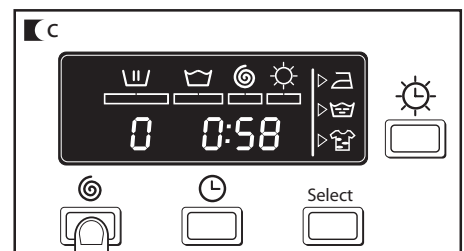
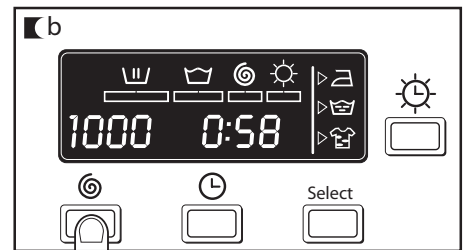
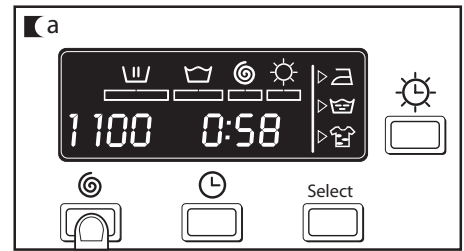

Time delay

Time delay selection. A delay of up to 24 hours may be selected. The delay must be selected after choosing the wash programme.

To select the time delay in hours press the clock button. Each time the button is pressed delays the start time by one hour. Cancel time delay To cancel time delay press the clock button repeatedly. The delay will be cancelled by reaching 24 hours and then pressing once more. Changing to another programme also cancels the delay.

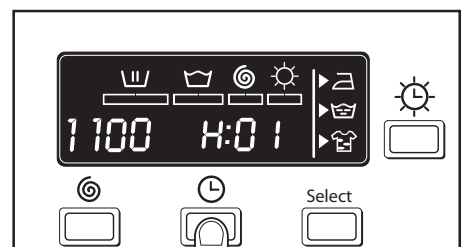



Additional functions

Button for selecting additional functions according to programmes.

a) There are 3 options: easy iron, intensive wash, extra rinse. Press the button to display the required option.

b) By clicking several times you can choose between various combinations, of one, two, and even three additional functions at the same time, depending on the chosen programme.

- Button: Easy iron.  This option reduces the formation of creases in garments by performing a special programme with special movements to fluff up the garments after the spin and make ironing easier.

- Button: Extra rinse.  This increases the intensity of the final rinse applied to the clothing. This is recommended for large loads and garments belonging to users with sensitive skin. Increases water consumption!

- Button: Intensive Wash.  This option, specially recommended for very dirty or stained garments, gives better results by lengthening the wash cycle.

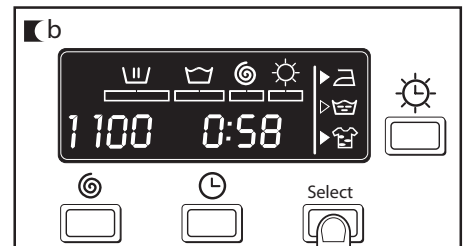
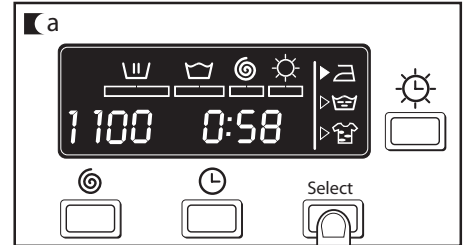

Important: If the ON/OFF button is pressed or there is any change of programme during the selection, all the options which were previously selected are cancelled.

DEMO programme

The DEMO programme is a special exhibition programme which allows the operation of Innova washing machines in shops without faults due to water inlet, emptying, door open, etc, being displayed.

To select or annul this programme, press the spin and select buttons simultaneously for 8 seconds.

3.1.1.- Start-up

To select the wash and dry programme, follow these steps:

- a) Turn the machine on with the ON / OFF button.
- b) Pull the programme selector out to activate it.
- c) Select the wash programme by turning the programme selector control (see programme table).

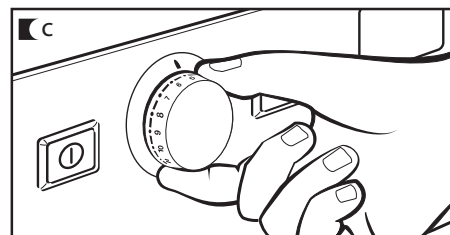
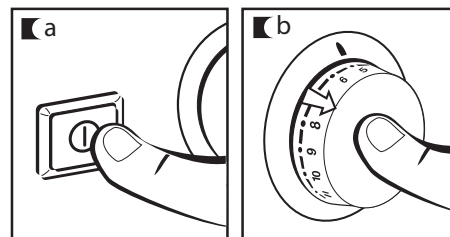

To select the drying time, follow these steps:

- a) Press the drying time button to select the drying time. The screen will display the time, which is increased each time the drying time button is pressed.

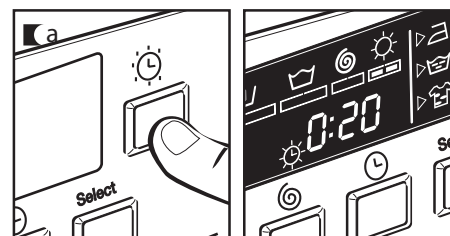

Important: If a wash + dry option is selected, the load may not be greater than 4 kg. (1.5 kg for delicate wash programmes).

When the programme is selected, the following information will be displayed:

1- Phases of the wash and dry programme

Wash

Rinse

Spin

Dry

2- Spin speed in revolutions/min

3- Programme number (for a few seconds), and then its duration.

4- Additional functions

Easy iron

Extra rinse

Intensive Wash:

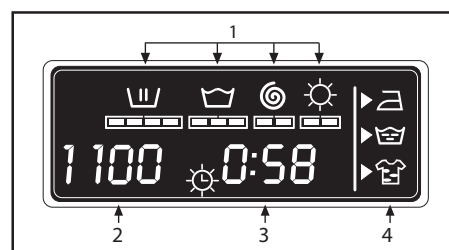

There are 4 types of programme available

Normal programmes

Delicate programmes.

Additional programmes

Drying programmes

PROGRAMMES			
Normal	Delicate	Additional	Drying
1 Normal cold	8 Delicate cold	12 Rinses	14 Normal drying
2 Fast 30°C	9 Delicate 30°C	13 Spin	15 Delicate drying
3 Normal 30°C	10 Delicate 40°C		16 Empty/End
4 Normal 40°C	11 Delicate 60°C		
5 Normal 60°C			
6 Normal 90°C			
7 Pre-wash 60°C			

3.1.2.- Locking

a) The Lock function is activated by holding down the Start/Pause button for 3 sec. The lock must be activated after having selected the wash programmes and all related options, as well as the delay required.

Once the lock has been activated, the machine will not respond to any button, not even the Start button or the wash programme selector.

In these circumstances, the only button which will affect the washer is the OFF button, which will, logically, stop the programme. However when it is turned ON again, the programme will continue from the point where it stopped, i.e., pressing OFF does not cancel the childproof lock.

b) The locking mechanism is only deactivated when the wash programme ends.

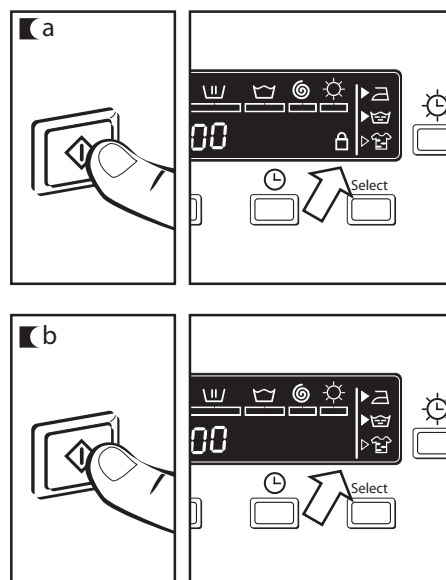

3.1.3.- Extra Rinse Option

- Adds one rinse to the selected programme, at the start of the rinse phase
- The washer has three rinses, the first two with water intake through the wash tray and the last with intake through the softener tray.
- Skip Spin Option: This option eliminates the spins the washing machine would normally carry out in the selected programme

3.1.4.- Flot/Anti-crease Option

- With this option the programme stops before emptying the last rinse; for the programme to continue, the Flot option must be unlocked

Note: The wash options must always be selected after selecting the wash programme. A change of programme during the selection, or after the wash has been started, cancels the options which were previously selected, and only the new programme's spin speed is lit up.

3.1.5.- Programme progress

When the programme has started, the screen can display the current wash phase, as well as the remaining time. As the programme continues, the active phases will be displayed successively in the upper part of the screen. The remaining programme time is also displayed in the screen. It is updated periodically, but not minute-by-minute.



Any option button may be selected, as long as the wash phase in which it takes effect has not passed, and when the programme permits that option. Pressing the delay button during the wash has no effect on the washer-dryer. Pressing the Start/Pause button during the wash puts the washer in the PAUSE state.

Important: If during the wash and dry cycle the programme is changed using the selector, the washer-dryer is left in the PAUSE state, and the programme is annulled. To add or remove an article, press the start/pause button and make sure that the water is not above the door overflow level, and that the interior temperature is not high. Press the start/pause button again to re-start the washer from the same phase of the cycle in which it was stopped.

3.1.6.- Power failure

When the supply returns after a power failure, the washer continues to work as normal, from the point at which it stopped (its memory lasts a few hours). The same thing happens if the ON/OFF button is pressed.

3.2.- Diagram of drying function

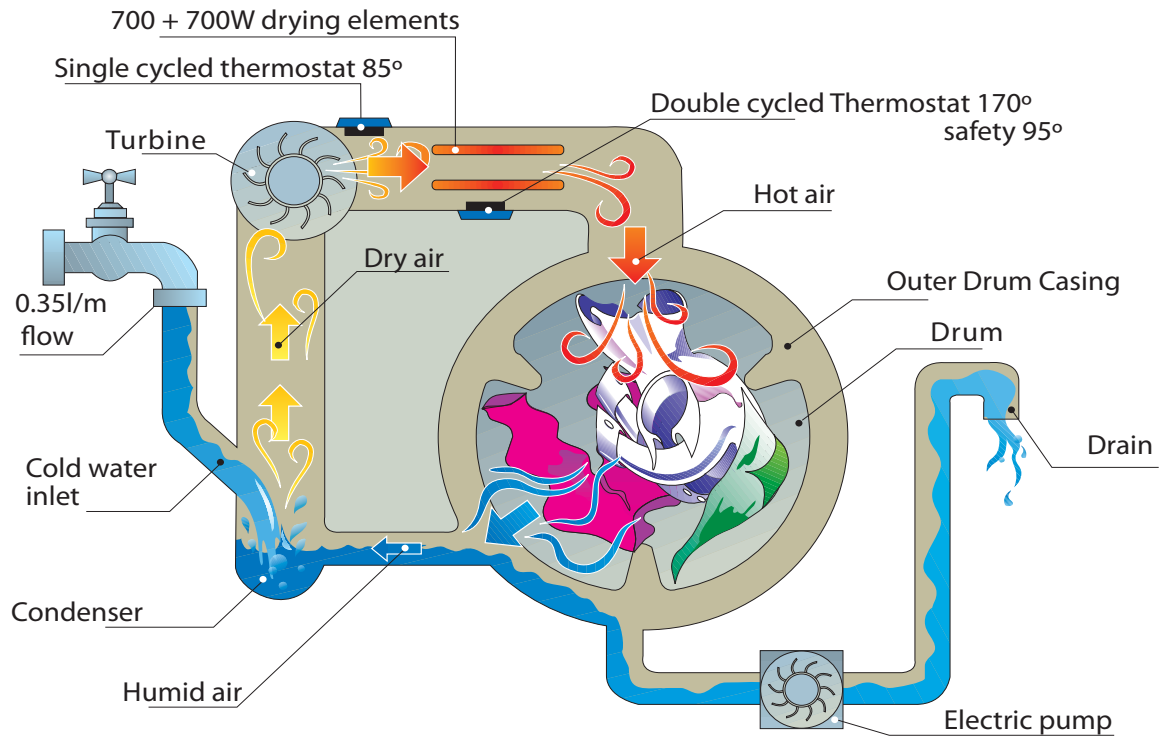

Programme No.	Wash load	Time	Consumption in Kw	Water consumption
14 normal	4 Kg	180 min	2,9 Kw	48 L
15 delicate	3 Kg	180 min	1,8 Kw	27 L

The vibration when drying is movement for 57 sec, then stopped for 3 sec.

The water inlet of the electrically operated valve for drying is activated 20 minutes into the selected programme.

During the drying process, the drainage pump works in cycles of 5 sec. on, then 55 stopped.

At the start of the drying programme, water comes in for 3 sec through the detergent tray. This is to prevent steam leaving through the detergent tray.

The drying programme can take from a minimum of 20 minutes up to a maximum of 180 minutes, in 10-minute increments.

If the cold water intake is greater than 0.35 litres per minute when the drying process is complete the clothes will be damp and hot.

3.3.- Programme table:

Programme	Recommended temperature	Type of material	Buttons for possible options						Max. load (kg)	Wash products compartment	Programme description	TURBO TIME PLUS	
			Extra Rinse	Intensive Wash	Easy Ironing	Select Spin	Skip Spin	AntiCrease				Total wash load (kWh/litres)	Approx. duration (minutes)
1 Normal cold	Cold	Cotton/Linen delicate colours very slightly soiled		YES	YES			6		Normal wash, rinses, automatic additive absorption if required, and long final spin	0,15/49	60	
2 Fast 30 °C		Cotton/Linen white/coloured very slightly soiled	YES	NO	YES		1,5			SHORT wash, rinses, automatic additive absorption if required, and long final spin	0,20/30	30	
3 Normal 30 °C		Cotton/Linen delicate colours slightly soiled		YES	YES		6				0,40/49	82	
4 Normal 40 °C		Cotton/Linen Solid colours Slightly soiled		YES	YES		6			Normal wash, rinses, automatic additive absorption if required, and long final spin	0,65/49	87	
5 (*) Normal 60 °C		Cotton/Linen Solid colours Normal soiling		YES	YES		6				1,02/49	91	
6 Normal 90 °C		Cotton/Linen White Very dirty		YES	YES		6				1,90/55	110	
7 Pre-wash 60°C		Cotton/Linen White/solid colours Very dirty		YES	YES		6			Pre-wash, normal wash, rinses, automatic additive absorption if required, and long final spin	1,45/60	105	
8 Delicate cold	Cold	Synthetic/mix Cotton delicate colours Very slightly soiled		YES	YES		3				0,15/55	50	
9 Delicate 30 °C		Synthetic/mix Cotton delicate colours Slightly soiled		YES	YES		3			Delicate wash, rinses, automatic additive absorption if required, and gentle final spin	0,35/55	50	
10 Delicate 40 °C		Synthetic/mix Cotton delicate colours Normal soiling		YES	YES		3				0,60/55	55	
11 Delicate 60 °C		Synthetic/mix Cotton white/solid colours Normal soiling		YES	YES		3				1,00/55	70	
12 Rinses	—	Cotton/mix cotton Synthetic/Delicate Wool/wool mix	YES	NO	YES		6			Rinses, automatic additive absorption if required, and long final spin	0,05/30	23	
13 Spin	—	Cotton/mix cotton Synthetic/Delicate Wool/wool mix		NO	YES		6	—		Emptying and long final spin	0,05/0	10	
14 Normal drying	—	Cotton/linen		—	—		4	—		Normal drying	2,8/48	160	
15 Delicate drying	—	Synthetic/mixed		—	—		1,5	—		Delicate drying	1,2/26	95	
16 Drainage/End	—	Cotton/mix cotton Synthetic/Delicate Wool/wool mix		NO	NO		6	—		Emptying and end of programme. Takes the programme to the final position	0,00/0	2	

Normal programme

Delicate programmes

Addit. progr.

Drying programmes

3.4.- Components

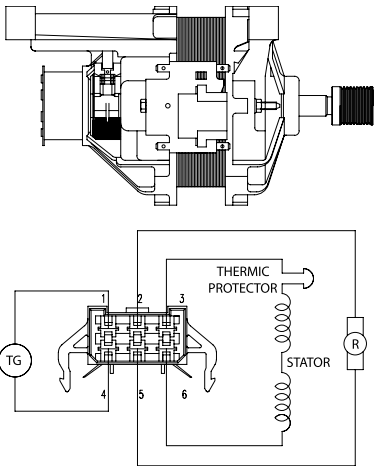
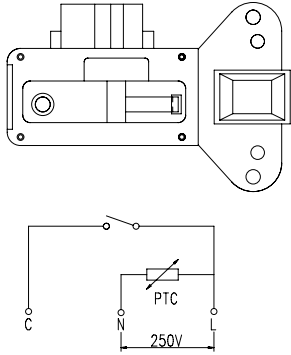
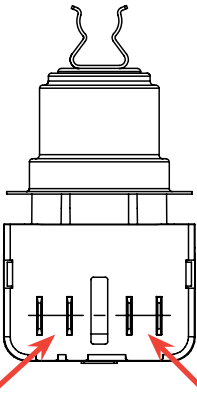
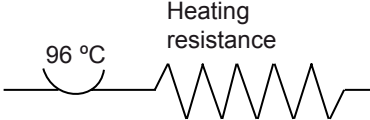
Component	Function	Features
<p style="text-align: center;">Motor</p> 	<p>Used in machines with variable spin and makes rotating movements when washing and spinning.</p> <p>Motor power supply:</p> <ul style="list-style-type: none"> - Clockwise, power 220V. , contacts 2 and 3. Bridge between contacts 5 and 6. - Anti-clockwise, power 220V. , contacts 3 and 5. Bridge between contacts 2 and 6. 	<p>Voltage: 220V / 50 Hz</p> <p>Stator resistance: 1.3 Ω</p> <p>Rotor resistance: 1.7 Ω</p> <p>Tachogenerator resistance: 184 Ω</p> <p>Tachogenerator voltage: 1.2 V / 1,000 rpm</p>
<p style="text-align: center;">Door lock</p> 	<p>Opens hatch lock</p>	<p>Voltage: 220 V / 50 Hz 16 Amp.</p> <p>Between 40 and 75 second delay</p>
<p style="text-align: center;">Component NTC Safety Thermostat</p>  <p style="text-align: center;">NTC Resistance Safety thermostat</p>	<p>The electronic card reads the NTC (variable resistance), and determines whether the water temperature has reached the selected temperature in the programme to complete the heating phase</p>	<p>NTC (see values in the table)</p> <p>Safety thermostat</p>  <p>96°C Contact normally closed</p> <p>-20°C Thermostat resets</p>

NTC Temperature / Resistance values

Temperature(°C)	<30	30	35	40	57	60	80	90
Resistance (K Ω)	>40	39	31	26	13	11	5	4

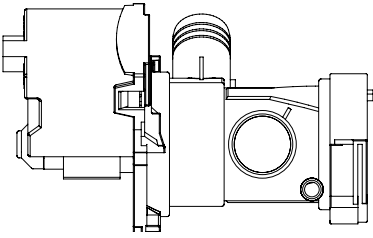
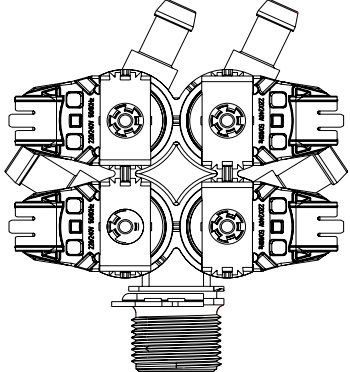
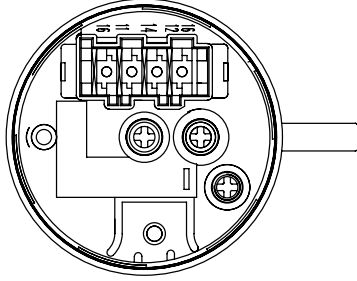
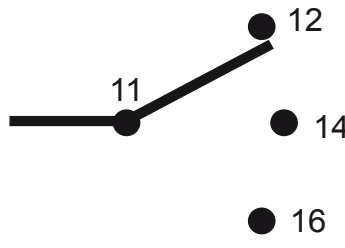

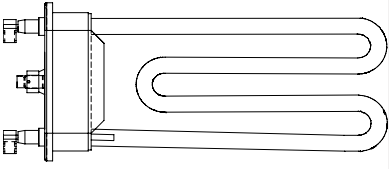
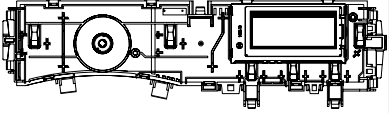
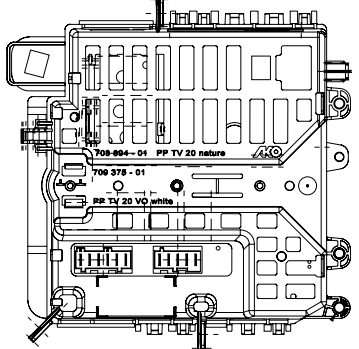

Component	Function	Features
<p>Drainage pump</p> 	Drains the water from inside the drum	<p>Voltage: 220 v / 50 Hz</p> <p>Drainage rate: 16 litres/ minute</p> <p>Maximum drainage height: 1 metre</p> <p>Winding resistance: 163.4 Ω</p> <p>Power 30 Watt.</p>
<p>Quadruple valve</p> 	Water input during pre-wash, wash and softener.	<p>Voltage 220 V/50 Hz</p> <p>Electrically operated valve flow for pre-wash, wash and softener is 7 litres per minute.</p> <p>Electrically operated valve flow for drying is 0.35 litres per minute.</p> <p>Value: 3,750 Ω</p>
<p>Presostato</p> 	<p>The pressure switch is activated in the following conditions:</p> <p>When the level reaches 12 litres, the wash level. (11-12)</p> <p>- When the level exceeds 33 litres (overflow), the drainage pump is activated (safety). (11-16)</p> <p>- The rinse level is performed according to the time of the microprocessor of the electronic card.</p>	<p>Level 1 102 / 72 ± 3</p> <p>Overflow safety 310 ± 10</p>  <p>11 Common 12 Water outlet 14 Heating 16 Overflow</p>

Component	Function	Features
<p data-bbox="323 331 611 365">Heating resistance</p> 	<p data-bbox="722 331 954 365">Heating element</p>	<p data-bbox="1121 331 1417 454">Resistance: 25,4 Ω Material: Real stainless steel</p> <p data-bbox="1121 477 1337 510">Power: 1850w</p> <p data-bbox="1121 533 1337 566">Voltage: 220 v</p>
<p data-bbox="395 712 619 745">Display circuit</p> 	<p data-bbox="754 723 866 790">Display Circuit</p>	<p data-bbox="1106 723 1433 757">Voltage: 220 v / 50 Hz</p>
<p data-bbox="435 1003 635 1037">Power circuit</p> 	<p data-bbox="754 1003 938 1037">Power circuit</p>	<p data-bbox="1121 1003 1449 1037">Voltage: 220 v / 50 Hz</p> <p data-bbox="1121 1037 1481 1249">Important: It is necessary to configure the circuit before starting the machine. (follow configuration instructions)</p>

3.5.- Fagor circuit configuration:

3.1.3.- Fagor circuit configuration:

If the circuit is not configured, it will go into **A** status as soon as it is plugged in (go to step no. 7). If the circuit is configured it enters the current configuration. To change the configuration, follow these steps:

- 1.- Turn the machine off
- 2.- Press the start / pause button  and keep it pressed (until step 5)
- 3.- Press the  button for 1 second until the LCD screen lights up
- 4.- Press the spin button  and wait 2 seconds until the letter **A** is displayed on the LCD screen
- 5.- Release all keys simultaneously
- 6.- The door lock will be locked
- 7.- Press the spin button  and the configuration digits are displayed (the last digit of the LCD will flash).
- 8.- Pressing the Time Delay button changes the parameter to be adjusted, starting with the KG digit and following the sequence:
KG – RPM – RECIRCULATION – COLD WATER – DOOR OPENING– KG -

Pressing the SPIN button changes the value of the parameter; the possible values are limited to the circuit's hardware reference and the selected KGs. If the KGs are changed after having selected the RPM, and the previous RPM value is not permitted for the newly selected KGs, the RPM will re-adjust to the value closest for the newly selected KGs.

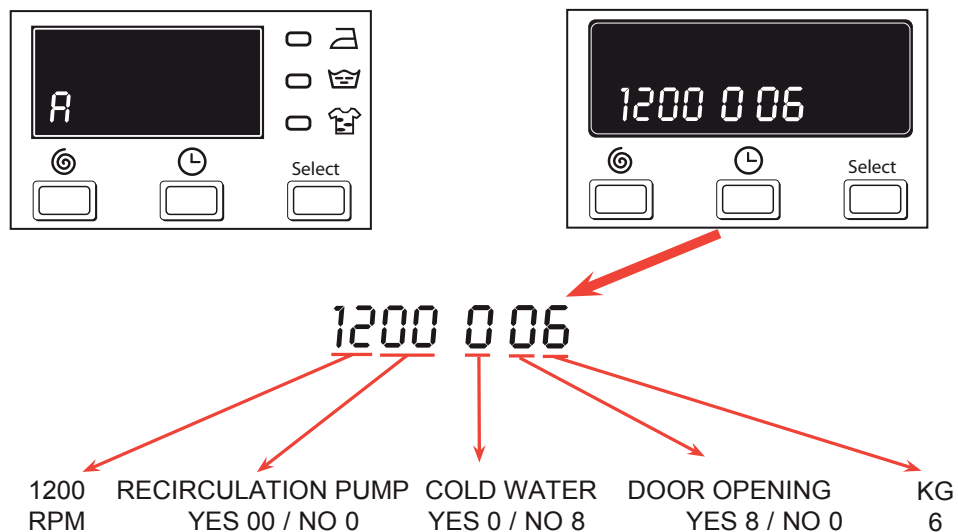

Configuring an Edesa Circuit:

When a circuit is replaced or changed, it must be configured.

To configure the circuit, follow these steps.

1.- Move the function selector knob to position 0.

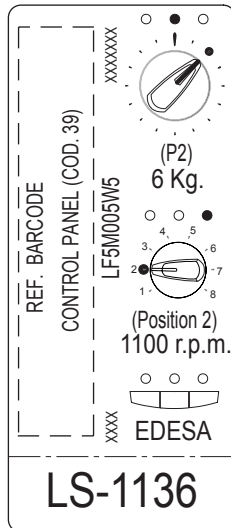

2.- Set the r.p.m. selector to position 2 (0 r.p.m.)

3.- Press the Start/Pause key and keep it pressed.

4.- Keeping the Start/Pause button pressed, set the selector to programme nº 2 (cold position *), and the end LED comes on.

5.- Keeping the Start/Pause button pressed, press the intensive wash button, and the phase LEDs for the wash, rinse, and end come on. The LCD screen displays the letter A, and we release the Start/Pause button and intensive wash button simultaneously.

6.- Press the intensive wash button and the rinse LED flashes, and E00 is displayed in the LCD screen. If it has no LCD screen, the configuration LEDs come on.

7.- Check that the LEDS which are lit correspond to the ones indicated in the label stuck on the body of the washer's tray.

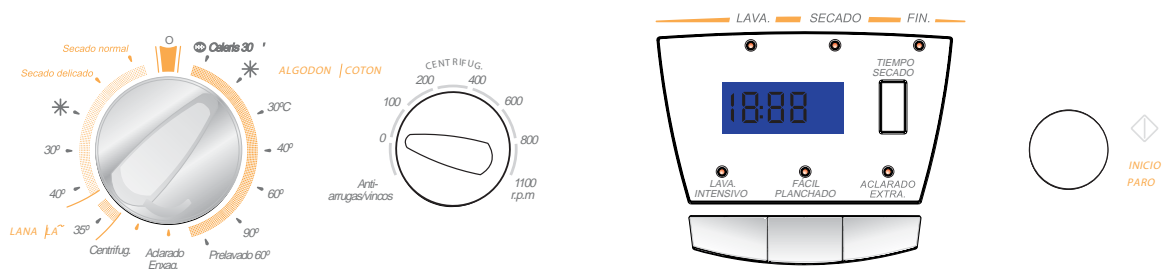

8.- Validate the configuration by pressing the start/stop button until the intensive wash, extra rinse and easy iron flash; the TSS test programme is then activated.



<p>KG - Drum capacity 1</p> <p>6: 6 kg KG options depending on circuit references / washing machine model.</p>	<p>HOT WATER 4</p> <p>0: Cold water 8: Hot water If the circuit does not have this option it will always be 0.</p>
<p>R.P.M. (Revolutions per minute). 2</p> <p>These values depend on the hardware reference and the KGs selected. 1400, 1300, 1200, 1100, 900, 800 ...</p>	<p>DOOR OPENING 5</p> <p>0: WITHOUT door opening 8: WITH instant door opening If the circuit does not have this option it will always be 0.</p>
<p>RECIRCULATION 3</p> <p>0: WITHOUT Recirculation Pump 00: WITH Recirculation Pump If the circuit does not have this option it will always be 0.</p>	<p>Circuit checking (see table 1) 6</p> <p>Once the circuit has been configured, it is checked by pressing the start/pause button for 3 sec. until the digits stop flashing. After 3 sec. it exits the configuration process, entering the TSS programme entrando en el programa SAT (See table 1)</p>

• **Fagor T.S.S. Programme:**

In order to check the operation of the washing machine's electric components, the T.S.S. programme can be activated by following these steps:

- 1.- General ON / OFF switch (LCD off)
- 2.- Press the start / pause button and keep it pressed 
- 3.- Hold down the ON/OFF switch until the LCD screen lights up.
- 4.- Press and hold down the select spin button and wait approx. 2/ 3 sec., until the letter **R** is displayed on the screen
- 5.- Release all buttons simultaneously
- 6.- Press the spin button and wait until the digits on the screen (LCD) appear (the last button on the right flashes).
- 7.- Press and hold down the start / pause button  until all the digits on the screen are flashing.
- 8.- The number 1 will be displayed on the screen – then follow the instructions in table 1, below.

3.6.- Troubleshooting

3.6.1.- T.S.S. Programme

PROGRAMME	SELECTION MODE	TIME (approx)
1	Drying Motor Power supply + Resistance 1 (3.6 Amp)	5 seconds
2	Drying Motor Power supply + Resistance 1 and 2 (7 Amp)	5 seconds
1	Water input via Pre-wash electrically operated valve + Movement of wash motor with inversion	15 sec.
2	Emptying + Spin	6 min.
3	Water inlet via the electrically operated valve for washing until wash level is reached	pressure switch level
4	Heating resistance activated until 40 °C is reached	10 min.
5	Water intake through the three electrically operated valves	5 sec.
	Emptying + movement of wash motor with inversion	1.5 min.
STOP	The programme ends and the selected wash programme is displayed	

Note: Whenever it is necessary to go on to the next step, press the start/pause button or turn the programme selector one position towards the right or left.

Once the TSS programme has ended, the programme may be repeated by pressing the START button.

3.6.2.- Seguridades criterios

SAFETY MECHANISMS	FAULT CONDITION	WASHER ACTION	RESET (End of safety)
FILLING F01	EV ON 8 min. and PN OFF (empty) (except in reliability programme)	It remains on pause with door lock ON	Any of these conditions resets the safety: 1. – Power is lost (supply or ON/OFF switch). 2.- Change of programme selector position.
UNBALANCED F03	Detects imbalance in 18 attempts (15 min) of low imbalance level (see spin table)	It performs 2 attempts with the high imbalance level, limiting the speed to C1. Even if it spins at this speed, it will indicate the fault (see spin table).	
NTC F05	NTC in short circuit or open circuit	It performs the selected programme but without heating	
NO HEATING F06	B < 5° C / 15 min. (excepto en programa fiabilidad)		
EMPTYING F02	EB ON 6 min. and PN ON (full)	STOP (End of programme)	
OVERFULL F07	Drainage pump cuts out or loses electricity supply		
F07	Electronic operated valve cuts out		
DOOR LOCK F04	Door lock ON and also detects failure of both control triacs of the door lock (both open)		
PROGRAMME SELECTOR F08	Selector in short circuit or open circuit	Performs DELICATE cold programme (only in User Mode)	
MOTOR F09	Tachogenerator motor lock fault (three consecutive attempts)	STOP	
INVERSION WITH MOTOR STOPPED F10	Does not invert the direction until the motor stops (Max. time (1 min.)	End of programme Door lock always closed	The fault indicator disappears, as in previous cases but the door lock is kept closed. To unlock it, keep it OFF.

B= pending increase in temperature when heating

3.6.3.- Imbalance Detection

DETECTION LEVEL WHEN WASHING	650 gr.
DETECTION LEVEL FOR LOW SPIN	750 gr.
DETECTION LEVEL FOR HIGH SPIN	1520 gr.

Note: These data are for a belt tension of 120 Hz and a SELNI motor

Function in the stop programme end

While PN is kept off (empty)	Door lock OFF & Pump OFF. Power failure: It is ready to start a new programme (pause status). It is in PAUSE status. When Start is pressed: restarts a new programme
While PN is kept on (full)	Door lock OFF & Pump in cycles: (1 minute On , 1 minute OFF) In case of overflow, the first pump cycle is: (6 minutes On , 1 minute OFF) Power failure: stays in the same situation. It is always in START status. When Start is pressed: stays in the same situation. Will show fault F2 while this condition exists.

Memory function for power cuts

Maintains programme memory for at least 2 hours.

When spinning, the step times are always reset

Changes in the programme selector

A programme change means that the programme will start again from the starting position.

3.6.4.- Imbalance Operation

1. - Spin attempts

If an imbalance is detected, the present phase will restart at second 25.

The number of attempts is limited to 18 (15 minutes).

After 18 spin attempts, it checks whether the imbalance level is lower than the high imbalance level (1520 g).

If it is lower, follow the spin sequence but limit the speed to C1 (minimum spin speed position on the rpm selector).

The number of attempts here is 2. If it also fails to start after these two attempts, move to the next programme step.

The spin time indicated in the steps of the electronic programmer is not reduced by the spin attempts in which an imbalance is detected.

2. - Reading the pressure switch

If the pressure switch is activated when the spin peak between imbalance readings 1, 2 and 3 is reached, the machine continues to spin normally until the next imbalance reading.

If the pressure switch is activated during any other spin, the motor stops and wait until you read "empty" on the pressure switch. The current phase will then restart.

The spin time indicated in the steps of the electronic programmer is not reduced by waiting to read "empty" on the pressure switch

3.- Spinning in the TSS programme

Spinning in the TSS programme does not include the first 42 seconds of the spin cycle.

4. – Skip spin

It will perform a Very Delicate Spin for 60 seconds.

Normal spin diagram

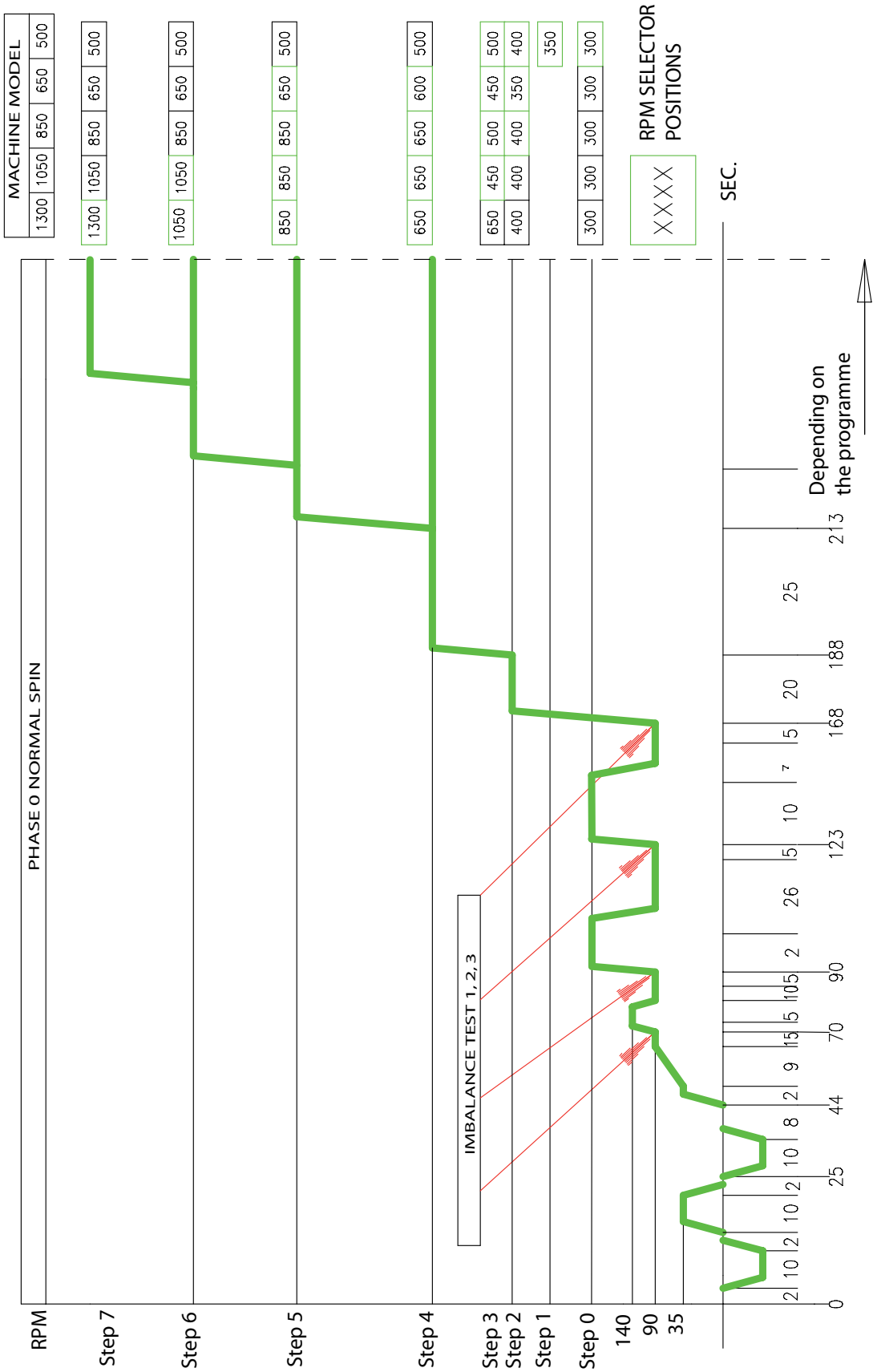

3.7.- Assembly and disassembly instructions

(A) Disassembly of the Evoluta Condensation Chamber

Undo the three screws that fix the condensation chamber to the drum (Thor screws)

Disconnect thermostat cables

Disconnect fan motor cables

Loosen the 2 screws which hold the Evoluta to the Muffler Duct

Remove the anti-return duct (bracket)

(B) Changing the Fan Motor

Remove the Evoluta condensation chamber (A)

Undo the 5 fixing screws

Remove the fan (take care, as the central bolt has a left-hand thread)

Undo the three screws which fix the fan to the evoluta cover

(C) Changing the single cycled Thermostat

Remove the Evoluta condensation chamber (A)

Remove the fan motor

Undo the thermostat fixing bolt (this bolt is inside the Condensation chamber)

N/C 85 degrees

(D) Change Element – Double Thermostat

Remove the Evoluta Condensation chamber (A)

Undo the three fixing screws for the upper counterweight

Loosen the two screws which hold the Evoluta to the Muffler Duct

Put a wedge support in between the unit and the base of the upper counterweight to raise up the Counterweight-Chamber

Loosen the two screws which hold the double thermostat

Loosen the two screws which hold the element

It is advisable to fit a new seal to the newly installed element

(F) Changing the Muffler Duct

Loosen the screws which hold the Counterweight to the Muffler Duct

Loosen the two screws which hold the Chamber-Evoluta to the Muffler Duct

Undo the three fixing screws for the counterweight

Disconnect the electric cables

3.8.- Drawings and diagrams

