

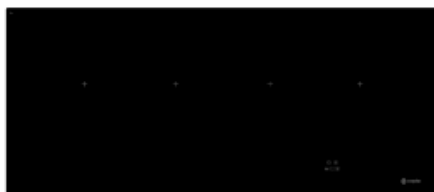

C875I

Caple induction hob



Technical information

C875I

Cable induction hob

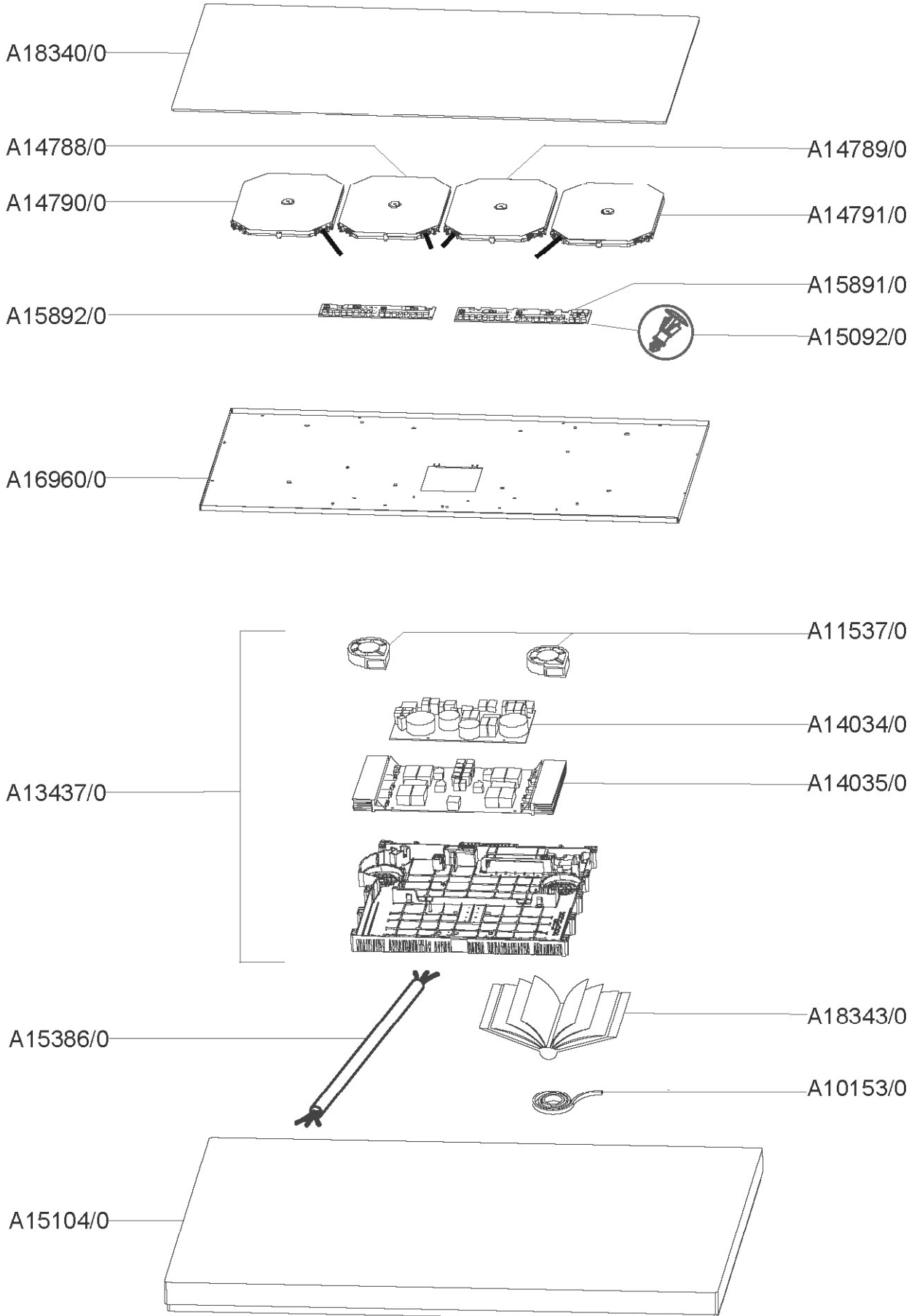



C875I - Caple induction hob ribbon

Item	Part Code	Description
1	A10153/0	GASKET FOR WORKTOP
2	A11537/0	COOLING FAN DOMINO
3	A13437/0	MODULE 4Z G5 4x3.7kW
4	A14034/0	PCB FILTER+CONNEXION
5	A14035/0	PCB POWER G5
6	A14788/0	INDUCTOR G5 OCTA L=100
7	A14789/0	INDUCTOR G5 OCTA L=100
8	A14790/0	INDUCTOR G5 OCTA L=250
9	A14791/0	INDUCTOR G5 OCTA L=250
10	A15092/0	HOLDING CLIP TC
11	A15104/0	PACKAGING
12	A15386/0	POWER CORD
13	A15891/0	TOUCH CONTROL G5
14	A15892/0	TOUCH CONTROL G5
15	A16960/0	CASING
16	A18340/0	GLASS COVER
17	A18343/0	INSTRUCTION MANUAL

PROCEDURE OF CONFIGURATION (ER31) - TC FLEX SLIDER

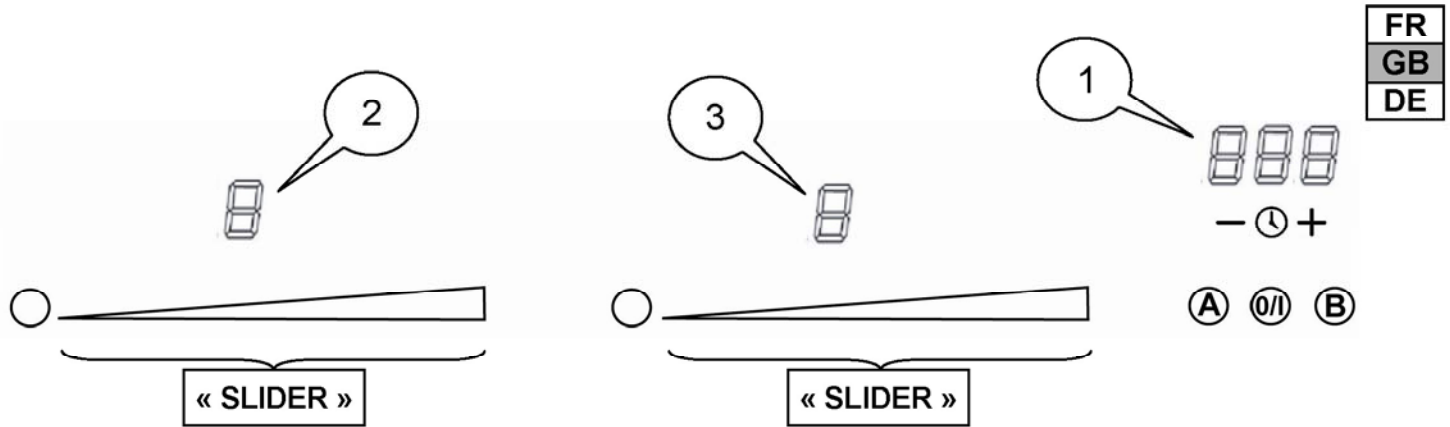

- A. Disconnect the hob from **the electrical network**.
- B. Connect the network and take into account that the configuration setting has to be made in a **maximum time of 2 minutes** (If the time goes over, the procedure must be begun again from stage A).
- C. **Do not switch on** the hob by pressing key (0/I).
- D. **Press and keep the finger** on keys [A] and [B] until you hear a "Beep".
- E. Then, **press and keep the finger** on each "SLIDER" until you hear a "Beep" and "CF6" appears on the timer (1).
- F. The configuration code appears in display (2).
- G. Choose the adapted configuration with the "SLIDER" situated under the code by pressing the beginning to decrease or the end to increase.
- H. Then, **press and keep the finger** on keys [A] and [B] until the display segments (2) and (3) move clockwise for a few seconds

The hob is now ready to be used.

Error Report TC Slider Lite – Display for Ind G5 Standard

GB
DE
FR
ES

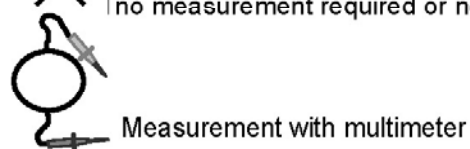

Legend:









 Decisions have to be realized step by step.
 The following step only has to be Executed, if the prior one was not successful.

TC = Touch Control panel PTC = Temperature probe (center of inductor) LIN cable = White Cable 0.25 mm ² (ex : connexion between TC and Filter Board)

Error display	Description	Possible reason for failure	Measurement	Decision
ER 03 + cont. tone or	Cont. key activation, Control switches off after 10s.	Liquid or cookware on glass above control		⇒ clean glass ceramics
U 400	Wrong connection	Input voltage >300V		⇒ inspection mains connection ⇒ replace filter (incl. internal wiring) ⇒ replace power unit
ER 20	Flash error Data not plausible Flash Rom check sum wrong Programming options wrong	Component part error Touch control Transmission of wrong configuration data Configuration data not plausible		⇒ replace touch control ⇒ programming of the correct configuration data (see doc. 42222/0)

Error display	Description	Possible reason for failure	Measurement	Decision
Er22	Key evaluation defect Touch control switches off after 3.5-7.5s.	Short circuit or interruption near the key evaluation		⇒ replace touch control
Er 31	Configuration data wrong TC assignment to induction series wrong No or partial functions	Automatic configuration of filter boards caused by wrong TC type Component part error on TC or filter board		⇒ activate configuration of TC with service menu and start ⇒ replace TC cable ⇒ check, if correct TC type was used ⇒ replace power unit.
Er 47	Communication error between TC und induction	Configuration error One induction generator without voltage (hobs with multiple generators) TC cable not correctly plugged on or defect TC defect Power unit defect Bad electrical connection		⇒ activate configuration of TC with service menu and start ⇒ check mains voltage ⇒ check TC cable reg. tight seat ⇒ replace TC and TC cable ⇒ replace power unit ⇒ Check the power connection

Error display	Description	Possible reason for failure	Measurement	Decision
EA	Cooling body temperature sensor not plausible One control pulse recognized on switched-off cooktop AD converter defect	Component part error on power unit or TC		⇒ replace power unit ⇒ replace TC
E 2	Over-temperature cooktop	Cooktop overheated (cooking with empty pan) Return heat on coil sensors > switch-off threshold		⇒ cooling down of cooktop required Error display disappears after cooling down. ⇒ replace inductor with sensor if E2 reappears after complete cooling down of cooktop. ⇒ replace power unit
E4	Incompatible configuration	The spare part is not the good one		⇒ Reconfigure the generator ⇒ replace TC ⇒ replace power unit

Error display	Description	Possible reason for failure	Measurement	Decision
E 5 E 6	Mains voltage signal invalid Power unit Cable Filter board	Permanent sub-voltage Power unit defect Picoflex or tube not correctly plugged on or cable defect Filter board defect		⇒ See doc. 42219/0
E 8	Fan rotation too quick or too slow	Enter of air is butcher fan defect Component part error		<input type="checkbox"/> Check the air inlet fan <input type="checkbox"/> replace fan <input type="checkbox"/> replace power unit <input type="checkbox"/> replace filter
E 9	PT sensor mechanically or Electrically defect	Mechanic rupture of PT sensor Resistance value drifting off Power unit defect	 approx. 47kΩ	<input type="checkbox"/> replace inductor with sensor <input type="checkbox"/> replace power unit

C875I

Caple induction hob

Synoptic breakdown E5-E6

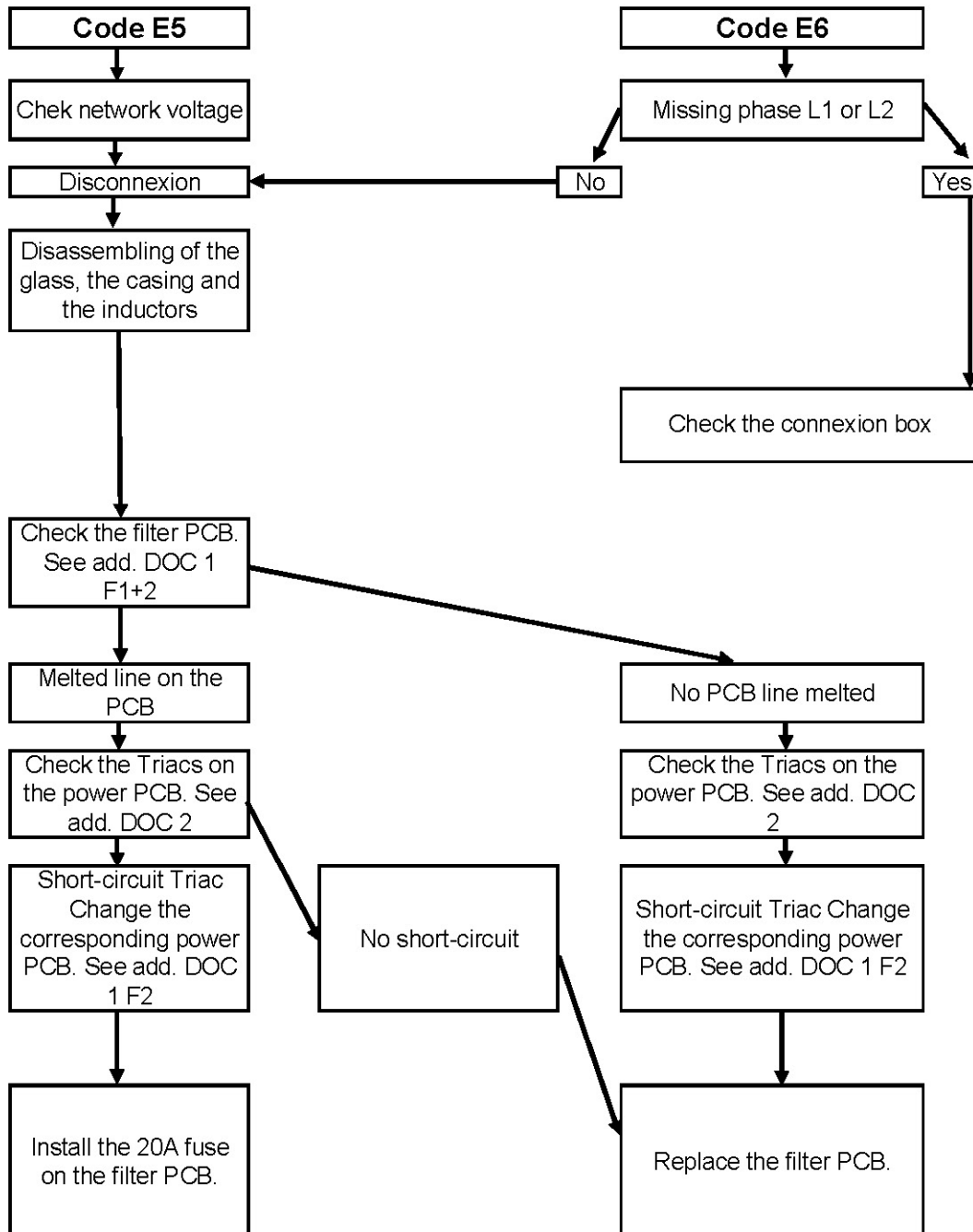

C875I

Caple induction hob

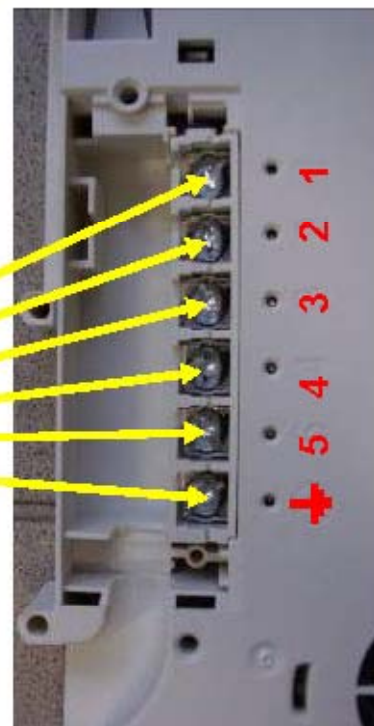
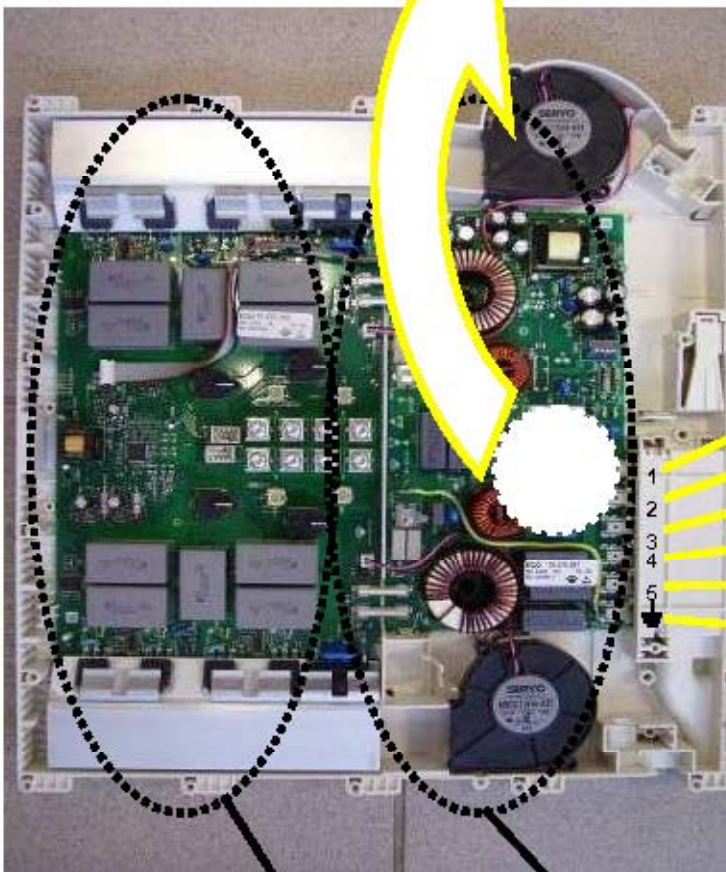
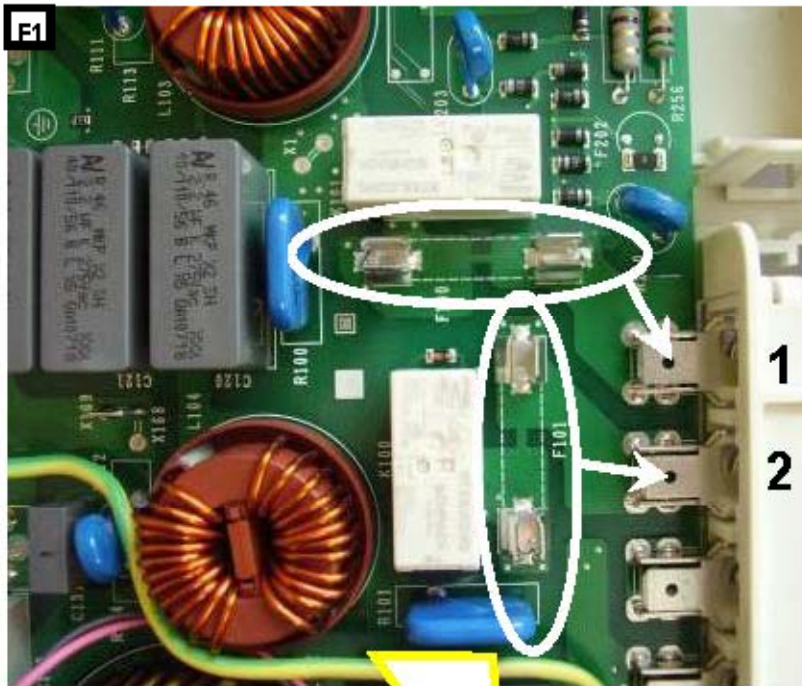

Puissance
Power
Leistungsteil
Potencia

Filtre
Filter
Filter
Filtro

C875I

Caple induction hob

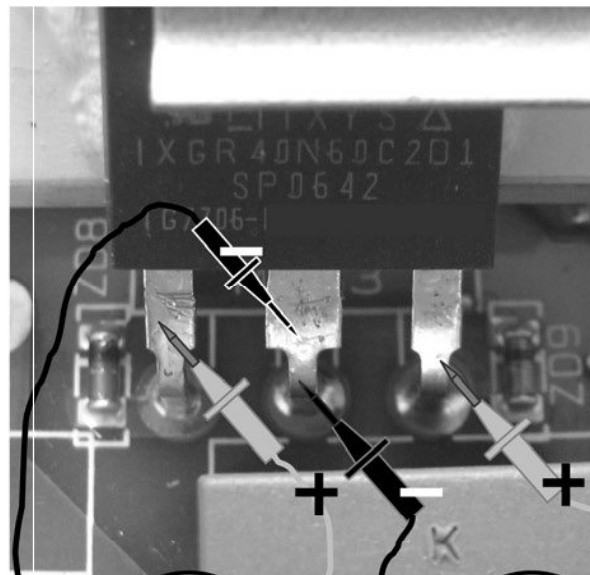
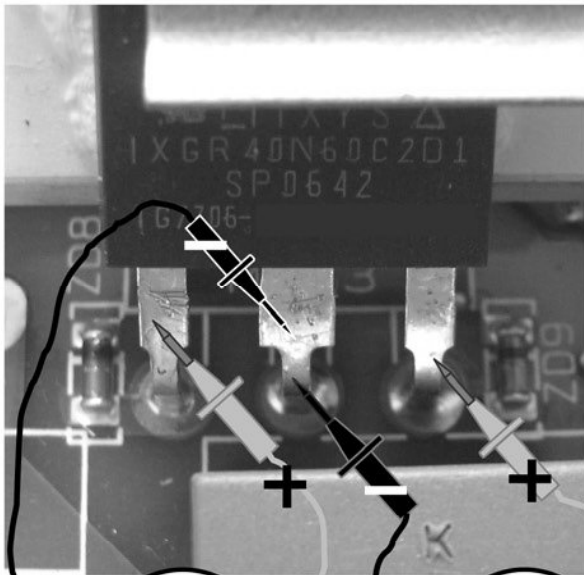
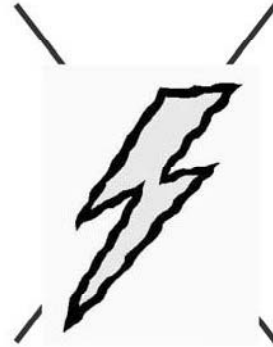
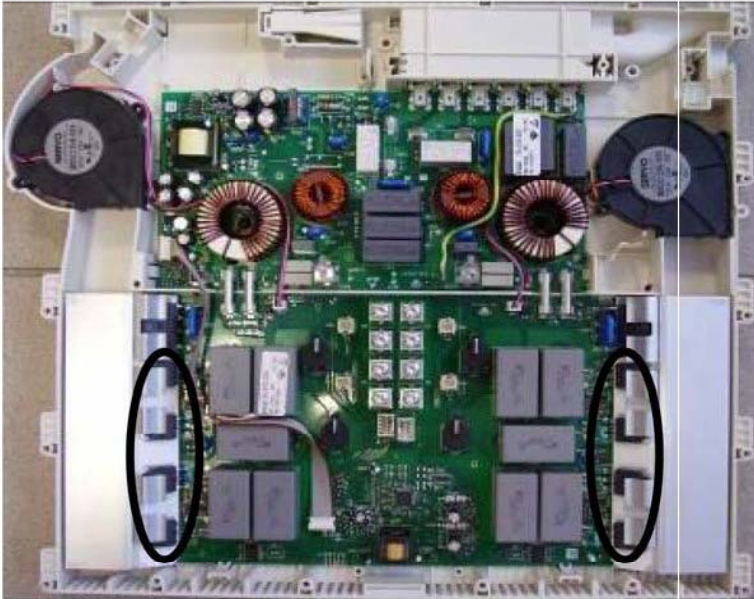

>10KW

>10KW

C



INDUCTION HOB G5 – TC FLEX SLIDER

1. To detect the wrong breakdowns :

1-1 Connection to the electric network:

- Control the tightening of the screws of the connection box
- Control the section of the cables used (see manual of use)
- Control if the earth wire (green/yellow) is connected

1+2 = phase

4+5 = neutral

3 = no connection

earth = obligatory

alimantation cable: advised with fasten terminal wires

tightening of the screws: either with torx N°20 (highly advised), or with a big and punt screwdriver.

The control of the connection and of the tightening must be done before any intervention in the hob.

A wrong tightening can be at the origin of a breakdown.

If a bridge is not made correctly or if a screw is wrong tightened, the following symptoms can occur:

- either none « 8 » appears at the electric connection,
- or the « 8 » appear and then the error « E6 », that indicates a problem to the connection box.

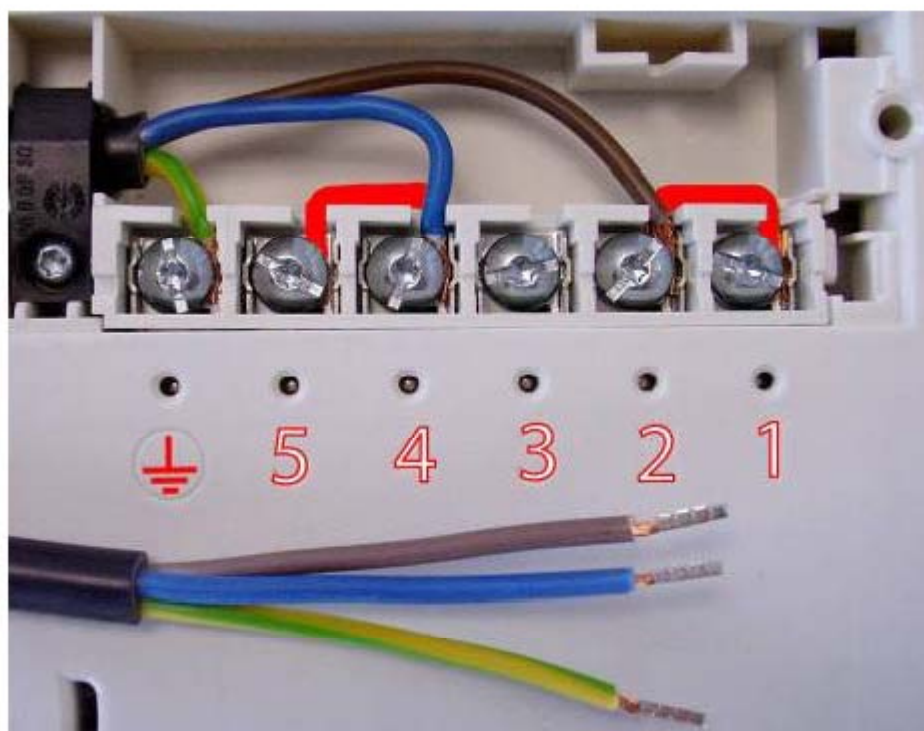

1-2 Installation :

- Control the installation of the gasket under the glass.
- If the glass is glued with silicone and in case of an after sales service: leave the glass in place and dismount the steel case under the work plan.
- Control the ventilation of the air coming in of the ventilator (minimum 20 mm of space).

1-3 Quality of the pans :

- Control if the pan is compatible with induction.
 - either a „magnet“ must remain hung on the bottom of the pan
 - or put a little water that must quickly boil at the power level „9“.
- The functioning of an induction generates a certain sonority. This one depends on the pans used.
- **Use only pans with flat bottoms. Others risk damaging the hob.**

FR
GB
DE
ES

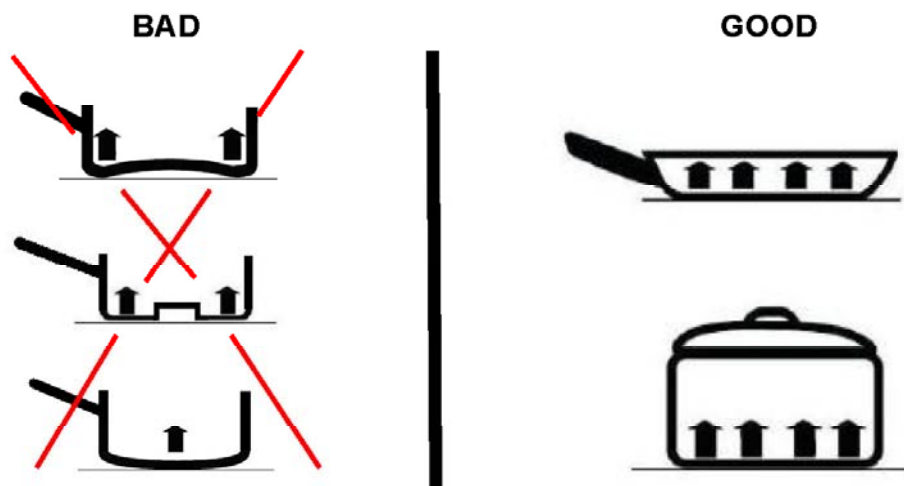
**1-4 Use :**

- To start the hob it is necessary to press the key [0/I] during 2 to 3 seconds.
- During the first times of use, the cooking appliance will release an smell of „new“.

1-5 Ventilation :

- The ventilation starts as soon as two heating zones are switched on.
- This ventilation goes on cooling the heating zones even after the stop of cooking.

1-6 Securities :

- In case of overflow, the hob stops as soon as 2 keys at least of the control panel are covered.
- In case of overheating of the heating zones, an automatic and progressive reduction of the power takes place.

2. To determine the breakdown according to the indications of the control panel.

2-1 Normal Display (according to the models)

<u>Display</u>	<u>Designation</u>	<u>Description</u>
0.	Zero	The heating zone is activated.
1...9	Power level	Selection of the cooking level.
U	No Pan detection	No pan or inadequate pan.
A	Heat accelerator	Automatic cooking.
H	Residual heat	The heating zone is hot.
P	Booster	The booster is activated.
	Double booster	The double booster is activated.
U	Keep warm	Maintain automatically of 42, 70, or 94°C.
	Pause	The hob is in pause.



2-2 Display of an error message :

<u>Display</u>	<u>Designation</u>	<u>Description</u>
E	Error message	Electronic hardware failure.
Er	Error message	Electronic software or TC failure.

Example of error display 31 : "Er" blinks with "31"



2-3 Fast starting :

When the hob is connected to the electric network, the displays' segments scroll clockwise.

After that, press the key [0/I] (On/Off), « 0 » appears.



If no handling is made within 20 seconds, everything switches off.

So, slide on the « slider » to regulate gradually from 1 to 9, or press the selected level for a direct access before 20 seconds (First put a pan with a little water. The bottom of the pan has to be cleaned to avoid from any scratching).

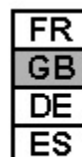

If no pan is put on the selected cooking zone, or if the pan is taken away during the cooking, or if the pan is not adapted to induction, you will have the following display:

